

NEW MEXICO OIL CONSERVATION COMMISSION
WELL LOCATION AND ACREAGE DEDICATION PLAT

Form C-102
Supersedes C-128
Effective 1-1-65

All distances must be from the outer boundaries of the section.

HOBBS OFFICE N. M. C. C.
MAY 22 3 37 PM '68

| | | | | |
|-------------------------------------------------------------------------------------------------------------------------------|------------------------------------------|-----------------------------|---------------------------------|--------------------------|
| Operator WARREN PETROLEUM CORP. | | Lease No. NO. 161 | | Well No. SWD-1 |
| Unit Letter H | Section 3 | Township 22 SOUTH | Range 37 EAST | County LEA |
| Actual Footage Location of Well: 2255 feet from the NORTH line and 908 feet from the EAST line | | | | |
| Ground Level Elev. 5242 | Producing Formation San Andres | Foot | Dedicated Acreage: Acres | |

1. Outline the acreage dedicated to the subject well by colored pencil or hatchure marks on the plat below.
2. If more than one lease is dedicated to the well, outline each and identify the ownership thereof (both as to working interest and royalty).
3. If more than one lease of different ownership is dedicated to the well, have the interests of all owners been consolidated by communitization, unitization, force-pooling, etc?

☐ Yes ☐ No If answer is "yes" type of consolidation _____

If answer is "no" list the owners and tract descriptions which have actually been consolidated. (Use reverse side of this form if necessary.) _____

No allowable will be assigned to the well until all interests have been consolidated (by communitization, unitization, forced-pooling, or otherwise) or until a non-standard unit, eliminating such interests, has been approved by the Commission.

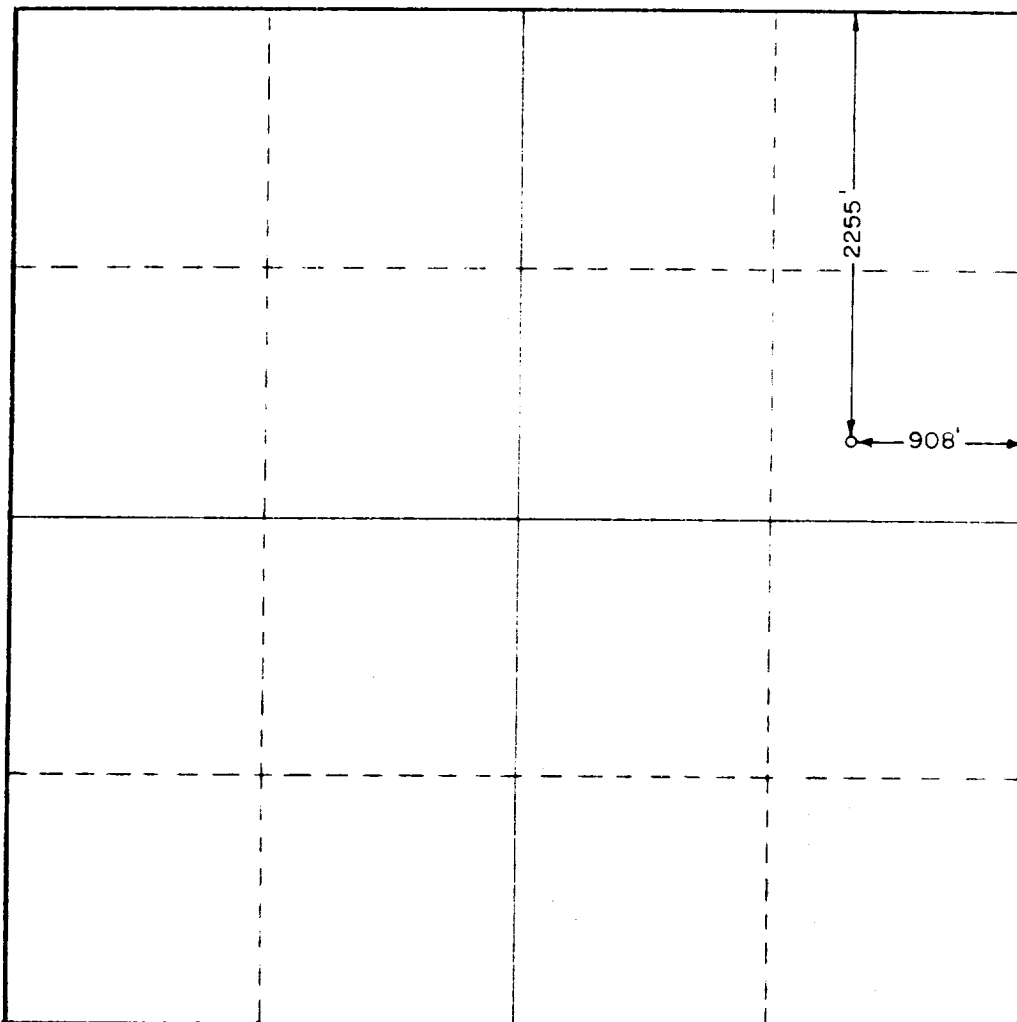

CERTIFICATION

I hereby certify that the information contained herein is true and complete to the best of my knowledge and belief.

ORIGINAL SIGNED BY

Name **C. E. MACE**

E. STATE

Area Pet. Engineer, Gulf Oil

Agent for Warren Petroleum Corp.

May 22, 1968

I hereby certify that the well location shown on this plat was plotted from field notes of actual surveys made by me or under my supervision, and that the same is true and correct to the best of my knowledge and belief.

Date Surveyed

MAY 16, 1968

Registered Professional Engineer
and/or Land Surveyor

John W. West

Certificate No.

676

0 330 660 990 1320 1650 1980 2310 2640 2970 3300 3630 3960 4290 4620 4950 5280 5610 5940 6270 6600

| | | | | |
|-----------------------------------------------------|----------------------|---------------------------|-------|-----------------------|
| COUNTY | LEA | FIELD Salt Water Disposal | | STATE NM 30-025-22583 |
| OPR | WARREN PETROLEUM CO. | | | MAP |
| SWD-1 Eunice Plant No. 161 | | | | |
| Sec. 3, T-22-S, R-37-E | | | | CO-ORD |
| 2255' FNL, 908' FEL of Sec. | | | | |
| Spd 7-19-68 | | | | |
| Cmp 8-1-68 | | | | |
| | | CLASS | EL | |
| | | FORMATION | DATUM | FORMATION DATUM |
| CSG & SX - TUBING | | | | |
| 9 5/8" | 1198' | 550 | | |
| 7" | 4131' | 226 | | |
| | | | | |
| | | | | |
| LOGS EL GR RA IND HC A | | | | |
| | | TD 4900' | | |
| San Andres OH 4131-4900' - SALT WATER DISPOSAL WELL | | | | |

Distribution limited and publication prohibited by subscribers' agreement.
Reproduction rights reserved by Williams & Lee Scouting Service, Inc.

| | | |
|--------------|------------------|---------|
| CONT. Cactus | PROP DEPTH 4900' | TYPE RT |
| DATE | | |

F.R. 5-31-68
 PD 4900' - SA
 Contr. - Cactus
 8-5-68 TD 4900', COMPLETE
 Acid (OH 4131-4900') 10,000 gals.