

NEW MEXICO OIL CONSERVATION COMMISSION

SANTA FE, NEW MEXICO

5-1-61

APPLICATION FOR MULTIPLE COMPLETION

Operator Bruce A. Wilbanks		County Lea		Date 3/27/74
Address Box 763, Midland, Texas 79701		Lease Baker		Well No. 2
Location or Well A	Unit A	Section 26	Township 22-S	Range 37-E

1. Has the New Mexico Oil Conservation Commission heretofore authorized the multiple completion of a well in these same pools or in the same zones within one mile of the subject well? YES ☒ NO ☐ **John H. Hendrix**
2. If answer is yes, identify one such instance: Order No. **M 2009**; Operator, Lease, and Well No.: **Cossatot "C" # 3**

3. The following facts are submitted:	Upper Zone	Intermediate Zone	Lower Zone
a. Name of Pool and Formation	Drinkard		Wants Granite Wash
b. Top and Bottom of Pay Section (Perforations)	6375'-6418'		7251'-7340'
c. Type of production (Oil or Gas)	Gas		Oil
d. Method of Production (Flowing or Artificial Lift)	Flowing		Flowing

4. The following are attached. (Please mark YES or NO)

- ☒ **yes** a. Diagrammatic Sketch of the Multiple Completion, showing all casing strings, including diameters and setting depths, centralizers and/or turbolizers and location thereof, quantities used and top of cement, perforated intervals, tubing strings, including diameters and setting depth, location and type of packers and side door chokes, and such other information as may be pertinent.
- ☒ **yes** b. Plat showing the location of all wells on applicant's lease, all offset wells on offset leases, and the names and addresses of operators of all leases offsetting applicant's lease.
- ☐ c. Waivers consenting to such multiple completion from each offset operator, or in lieu thereof, evidence that said offset operators have been furnished copies of the application.*
- ☒ **yes** d. Electrical log of the well or other acceptable log with tops and bottoms of producing zones and intervals of perforation indicated thereon. (If such log is not available at the time application is filed, it shall be submitted as provided by Rule 112-A.)

5. List all offset operators to the lease on which this well is located together with their correct mailing address.

Texas Pacific Oil Co, Inc. 1509 West Wall, Midland, Texas 79701

Phillips Petroleum Co., 417 W. 4th, Odessa, Texas 79760

Union Texas Petroleum Corp., Wilco Bldg., Midland, Texas 79701

Skelly Oil Company, Wall Towers Bldg., Midland, Texas 79701

Coquina Oil Corp., Building of Southwest, Midland, Texas 79701

Gulf Oil Corporation, P. O. Box 1150, Midland, Texas 79701

6. Were all operators listed in Item 5 above notified and furnished a copy of this application? YES ☒ NO ☐ . If answer is yes, give date of such notification **March 27, 1974**

CERTIFICATE: I, the undersigned, state that I am the **Operator** of the **Bruce A. Wilbanks** (company), and that I am authorized by said company to make this report; and that this report was prepared under my supervision and direction and that the facts stated therein are true, correct and complete to the best of my knowledge.

[Signature]
Signature

- * Should waivers from all offset operators not accompany an application for administrative approval, the New Mexico Oil Conservation Commission will hold the application for a period of twenty (20) days from date of receipt by the Commission's Santa Fe office. If, after said twenty-day period, no protest nor request for hearing is received by the Santa Fe office, the application will then be processed.
- NOTE: If the proposed multiple completion will result in an unorthodox well location and/or a non-standard proration unit in either or both of the producing zones, then separate application for approval of the same should be filed simultaneously with this application.

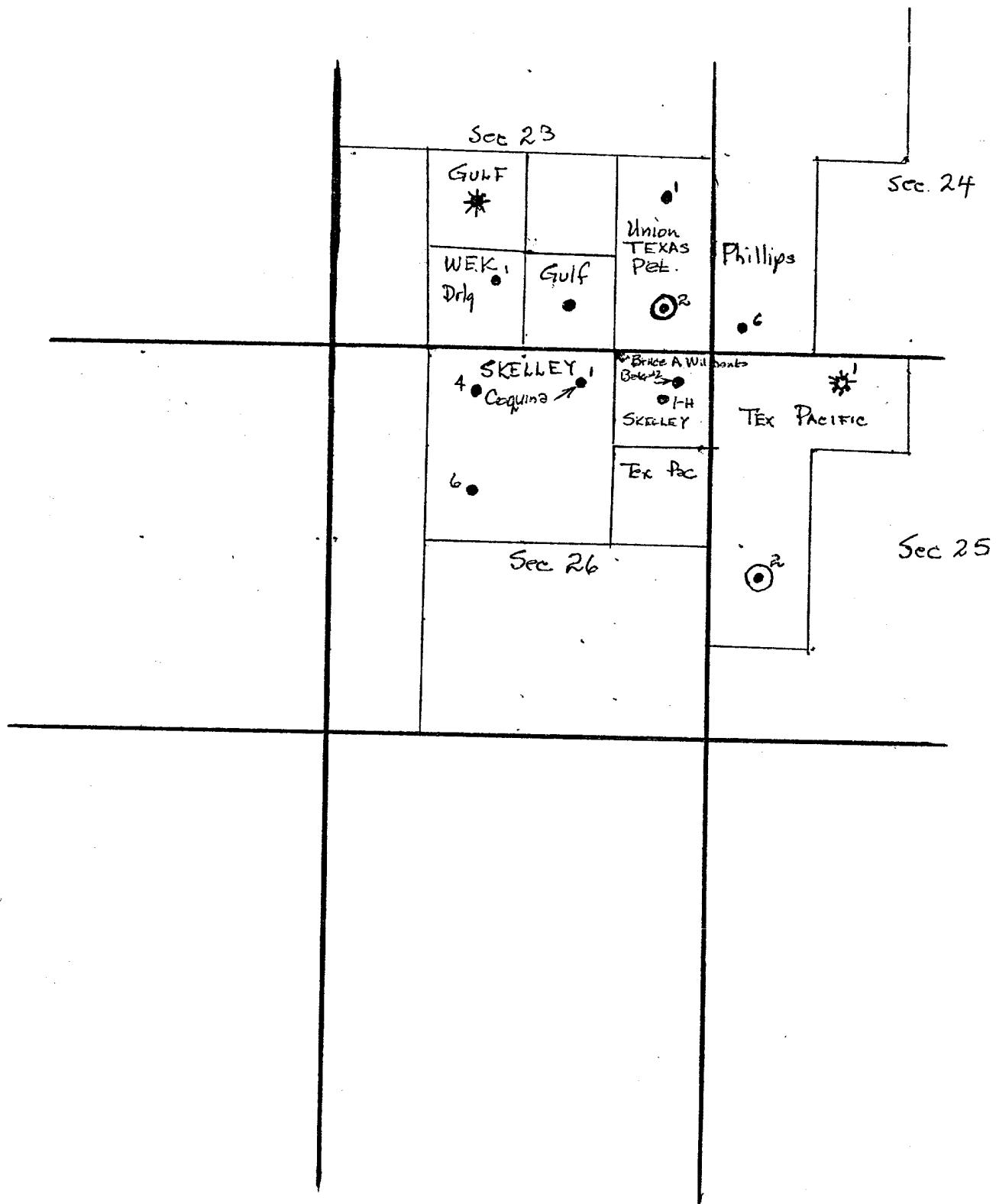

PLAT
 BRUCE A. Wilbanks
 BAKER No 2
 NE/4 of NE/4 Sec 26
 R2-S, 37E, Lea Co, NM

Diagrammatic sketch of dual completion

By: Bruce A. Wilbanks

Baker # 2

Lea County, New Mexico

