

Humble Lse.No. 37721

NEW MEXICO OIL CONSERVATION COMMISSION

Form C-102  
Supersedes C-128  
Effective 1-1-65State Lse.No. B-934

WELL LOCATION AND ACREAGE DEDICATION PLAT

Federal Lse.No. \_\_\_\_\_

All distances must be from the outer boundaries of the Section.

Operator Humble Oil & Refining Co.		Lease New Mexico, State "S" 1745 11' 69"		Well No. 26
Unit Letter L	Section 2	Township 22 South	Range 37 East	County Lea
Actual Footage Location of Well: 2310 feet from the South line and 400 feet from the West line				
Ground Level Elev. Later	Producing Formation San Andres	Pool South Eunice San Andres	Dedicated Acreage: 80 Acres	

1. Outline the acreage dedicated to the subject well by colored pencil or hachure marks on the plat below.
2. If more than one lease is dedicated to the well, outline each and identify the ownership thereof (both as to working interest and royalty).
3. If more than one lease of different ownership is dedicated to the well, have the interests of all owners been consolidated by communitization, unitization, force-pooling, etc?

☐ Yes ☐ No If answer is "yes," type of consolidation \_\_\_\_\_

If answer is "no," list the owners and tract descriptions which have actually been consolidated. (Use reverse side of this form if necessary.) \_\_\_\_\_

No allowable will be assigned to the well until all interests have been consolidated (by communitization, unitization, forced-pooling, or otherwise) or until a non-standard unit, eliminating such interests, has been approved by the Commission.

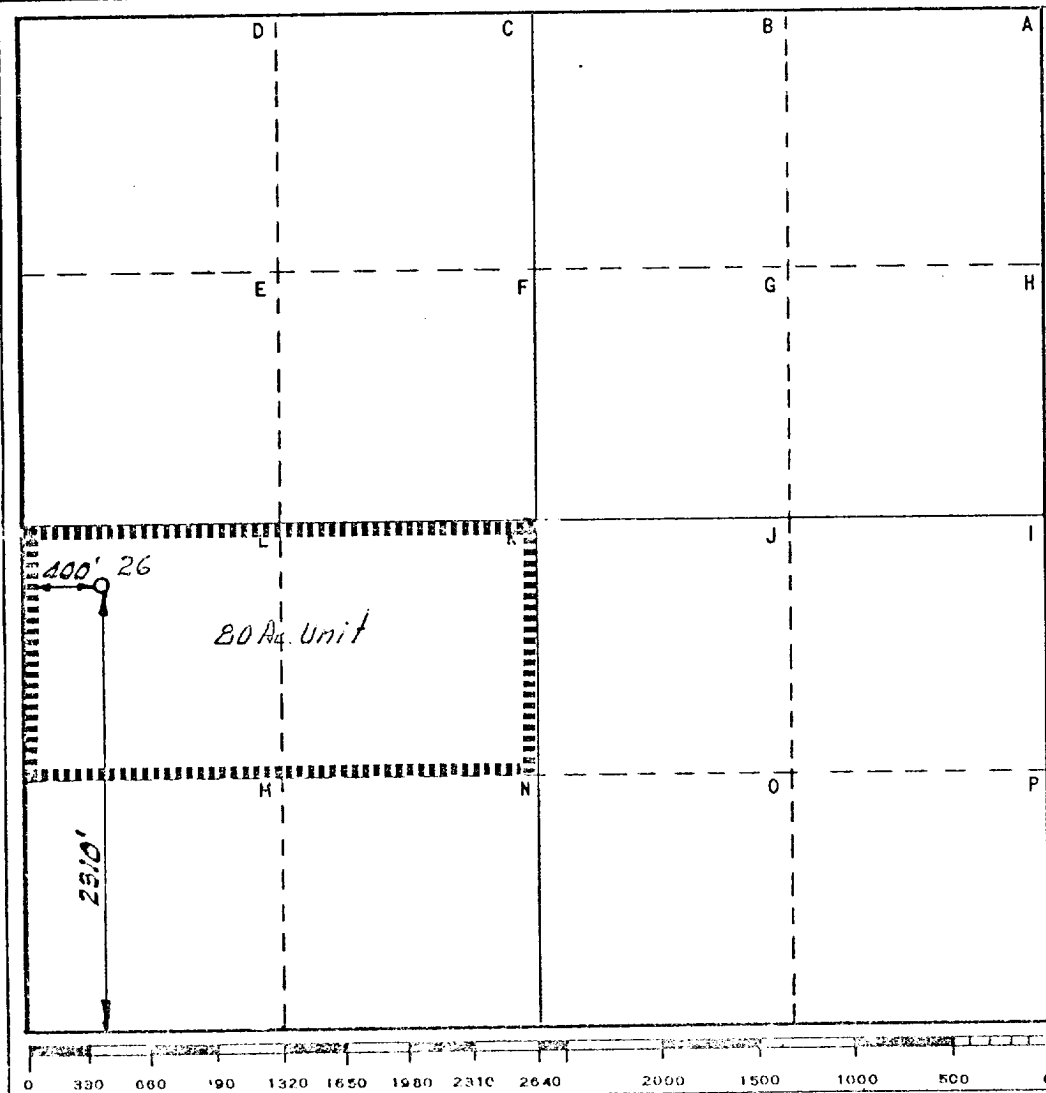

## CERTIFICATION

I hereby certify that the information contained herein is true and complete to the best of my knowledge and belief.

Name J.E. Piskerton  
Position Protraction Supervisor  
Company Humble Oil & Refining Co.  
Box 1600 Midland, Texas

Date June 24, 1969

I hereby certify that the well location shown on this plat was plotted from field notes of actual surveys made by me or under my supervision, and that the same is true and correct to the best of my knowledge and belief.

Date Surveyed  
June 16, 1969

Registered Professional Engineer  
and/or Land Surveyor

H.S. McTighe  
Certificate No. 1382

C.F. Sec. file # A-417