

RECEIVED

MAR - 8 1973

OIL CONSERVATION COMM.
110329

**NEW MEXICO OIL CONSERVATION COMMISSION
WELL LOCATION AND ACREAGE DEDICATION PLAT**

Form C-102
Supersedes C-128
Effective 1-1-65

All distances must be from the outer boundaries of the Section.

Operator TEXAS PACIFIC OIL CO.			Lease WILL CARY		Well No. 9
Unit Letter E	Section 22	Township 22 SOUTH	Range 37 EAST	County LEA	
Actual Footage Location of Well: 1650 feet from the NORTH line and 660 feet from the WEST line					
Ground Level Elev. 3364.5	Producing Formation Silurian		Pool South McCormack		Dedicated Acreage: 40 Acres

1. Outline the acreage dedicated to the subject well by colored pencil or hatchure marks on the plat below.
2. If more than one lease is dedicated to the well, outline each and identify the ownership thereof (both as to working interest and royalty).
3. If more than one lease of different ownership is dedicated to the well, have the interests of all owners been consolidated by communitization, unitization, force-pooling, etc?

☐ Yes ☐ No If answer is "yes," type of consolidation _____

If answer is "no," list the owners and tract descriptions which have actually been consolidated. (Use reverse side of this form if necessary.) _____

No allowable will be assigned to the well until all interests have been consolidated (by communitization, unitization, forced-pooling, or otherwise) or until a non-standard unit, eliminating such interests, has been approved by the Commission.

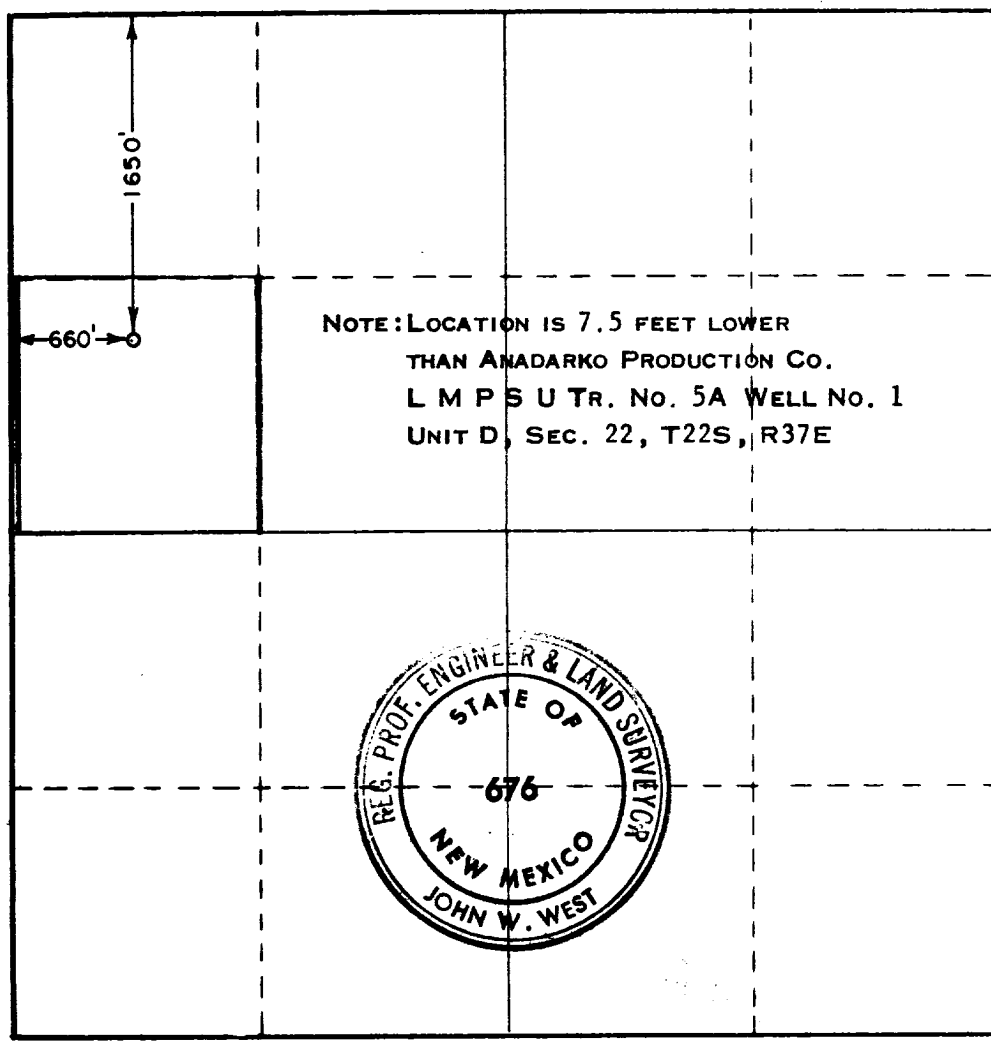

CERTIFICATION

I hereby certify that the information contained herein is true and complete to the best of my knowledge and belief.

Sheldon Ward
Name

Sheldon Ward
Position

Area Superintendent

Company
Texas Pacific Oil Company, Inc.

Date
March 8, 1971

I hereby certify that the well location shown on this plat was plotted from field notes of actual surveys made by me or under my supervision, and that the same is true and correct to the best of my knowledge and belief.

Date Surveyed
MARCH 4, 1971

Registered Professional Engineer and/or Land Surveyor

John W. West
Certificate No.

114

RECEIVED

MAY 10 1971

OIL CONSERVATION COM. PL.
MOBILE, AL.

COUNTY LEA FIELD McCormack, S. STATE NM 30-025-23724
 OPR TEXAS PACIFIC OIL CO. MAP
9 Cary, Will
Sec 22, T-22-S, R-37-E CO-ORD
1650' FNL, 660' FWL of Sec
Spd 3-18-71 CLASS
Cmp 4-29-71 EL 33752

FORMATION	DATUM	FORMATION	DATUM
CSG & SX - TUBING			
8 5/8" at 1140' w/695 sx			
4 1/2" at 7303' w/750 sx.			
LOGS EL GR RA IND HC A			
	TD 7303';	PDD 7260'	

IP (Silurian) Perfs 7203-49' P 60 EOPD + 70 BW. Pot based on 24 hr test. GOR 1016; Grav NR.

Distribution limited and publication prohibited by subscribers' agreement.
 Reproduction rights reserved by Williams & Lee Scouting Service, Inc.

CONT. Moran PROP DEPTH 7300' TYPE RC
 DATE

F.R. 3-16-71; Opr's Elev. 3364' CI
 PD 7300' RT (Silurian)
 Contractor - Moran
 3-22-71 Drlg. 3270' 1m
 3-29-71 Drlg. 5710' 1m
 4-5-71 Coring @ 7135' 1m
 4-12-71 TD 7303'; WOC
 Cored 7133-89', rec 54', no description
 Cored 7189-7224', rec 35', no description
 SP DST (Fusselman) 7195-7218', open 1 hr
 30 mins, rec 105' GCM & sul wtr, 1 hr ESIF
 2252#, FP 51-645#, 2 hr 30 min ESIF 2688#

LEA

TEXAS PACIFIC OIL CO.

McCormack, S.

9 Cary, Will

NM Sec 22, T22S, R37E

Page #2

4-19-71 TD 7303'; PBD 7227'; Swbg
Perf (Fusselman) @ 7233', 7237', 7243',
7245', 7249' w/1 SPI
Acid (7233-49') 500 gals
Swbd Dry (7233-49')
BP @ 7227'
Perf (Silurian) @ 7203', 7206', 7211', 7215'
Acid (7203-15') 1500 gals
Swbd 72 BF (10% oil) in 11 hrs (7203-15')
4-26-71 TD 7303'; PBD 7260'; Swbg
Swbd 3 BO + 21 BW in 10 hrs (7203-15')
Pulled BP @ 7227'
Acid (7233-49') 2000 gals
Swbd 390 BLW in 24 hrs (7233-49')
Swbd 29 BNO + 53 BLW in 10 hrs (7203-15')

5-3-71 TD 7303'; PBD 7260'; TO Pmp
Ppd 48 BNO + 62 BFW in 24 hrs
5-10-71 TD 7303'; PBD 7260'; COMPLETE
LOG TOPS: Anhydrite 1122', Queen 3357',
Grayburg 3625', San Andres 3914', Glorieta
5050', Blinbry 5516', Drinkard 6296',
Abo 6566', Silurian 7188'
5-13-71 COMPLETION REPORTED