

NO. OF COPIES RECEIVED

DISTRIBUTION		
SANTA FE		
FILE		
U.S.G.S.		
LAND OFFICE		
OPERATOR		

NEW MEXICO OIL CONSERVATION COMMISSION

Form C-101
Revised 1-1-65

5A. Indicate Type of Lease ☒ STATE ☐ FEE ☒

5. State Oil & Gas Lease No.

APPLICATION FOR PERMIT TO DRILL, DEEPEN, OR PLUG BACK

1a. Type of Work ☒ DRILL ☐ DEEPEN ☐ PLUG BACK ☐

b. Type of Well ☒ OIL WELL ☐ GAS WELL ☐ OTHER ☐ SINGLE ZONE ☒ MULTIPLE ZONE ☐

2. Name of Operator
Anadarko Production Company

3. Address of Operator
P. O. Box 247, Hobbs, New Mexico

4. Location of Well UNIT LETTER **E** LOCATED **1940** FEET FROM THE **North** LINE
660 FEET FROM THE **West** LINE OF SEC. **35** TWP. **22S** RGE. **37E** NMMPM

7. Unit Agreement Name

8. Farm or Lease Name
Me-Tex Supply "A"

9. Well No.
2

10. Field and Pool, or Wildcat
Langlie Mattix

12. County
Lea

19. Proposed Depth
3750'

19A. Formation
Queen

20. Rotary or C.T.
Rotary

21. Elevations (Show whether DF, RT, etc.)
3318' GL

21A. Kind & Status Plug, Bond
Blanket on file

21B. Drilling Contractor
Leatherwood Drllg. Co.

22. Approx. Date Work will start
11-27-72

23.

PROPOSED CASING AND CEMENT PROGRAM

SIZE OF HOLE	SIZE OF CASING	WEIGHT PER FOOT	SETTING DEPTH	SACKS OF CEMENT	EST. TOP
11 1/2"	8-5/8"	24.00#	325'	200 sks	Circulate
7-7/8"	5 1/2"	14.00#	3750'	400 sks	2300'-Base of Salt Section

Feb. 13, 1973

IN ABOVE SPACE DESCRIBE PROPOSED PROGRAM; IF PROPOSAL IS TO DEEPEN OR PLUG BACK, GIVE DATA ON PRESENT PRODUCTIVE ZONE AND PROPOSED NEW PRODUCTIVE ZONE. GIVE BLOWOUT PREVENTER PROGRAM, IF ANY.

I hereby certify that the information above is true and complete to the best of my knowledge and belief.

Signed John Runyan Title Area Supervisor Date 11-3-72

(This space for State Use)

Orig. Signed by

John Runyan

Geologist

APPROVED BY _____ DATE _____

CONDITIONS OF APPROVAL, IF ANY:

NOV 13 1972

RECEIVED

MAY 16 1972

OIL CONSERVATION COMM.
HOBBS, N. M.

**NEW ICO OIL CONSERVATION COMMISSION
WELL LOCATION AND ACREAGE DEDICATION PLAT**

Form O-102
Supersedes O-178
Effective 1-1-67

All distances must be from the outer boundaries of the Section.

Operator ANALARKO PRODUCTION COMPANY			Lease Me-Tex Supply "A"		Well No. 2
Section E	Section 35	Township 22 South	Range 37 East	County Lea	
Actual Footage Location of Well: 1940 feet from the North line and 660 feet from the West line Ground Level Elev. 3318.0 Producing Formation Queen Pool Langlie Mattix Dedicated Acreage: 40 Acres					

- 1 Outline the acreage dedicated to the subject well by colored pencil or hatchure marks on the plat below.
- 2 If more than one lease is dedicated to the well, outline each and identify the ownership thereof (both as to working interest and royalty).
- 3 If more than one lease of different ownership is dedicated to the well, have the interests of all owners been consolidated by communitization, unitization, force-pooling, etc?

☐ Yes ☐ No If answer is "yes," type of consolidation _____

If answer is "no," list the owners and tract descriptions which have actually been consolidated. (Use reverse side of this form if necessary.) _____

No allowable will be assigned to the well until all interests have been consolidated (by communitization, unitization, forced-pooling, or otherwise) or until a non-standard unit, eliminating such interests, has been approved by the Commission.

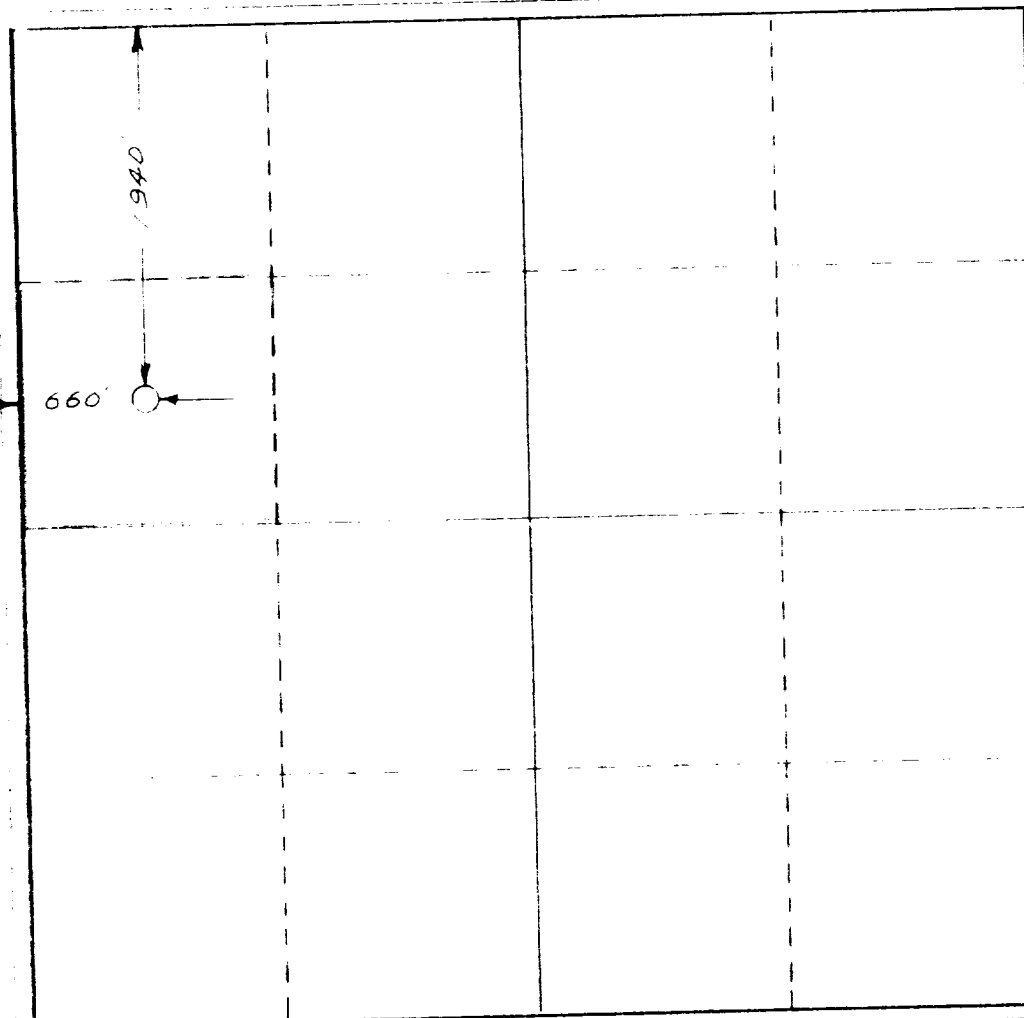

CERTIFICATION

I hereby certify that the information contained herein is true and complete to the best of my knowledge and belief.

Name M. J. Nelson
 Position District Superintendent
 Company Anadarko Production Co.
 Date November 2, 1972

I hereby certify that the well location shown on this plat was plotted from field notes of actual surveys made by me or under my supervision, and that the same is true and correct to the best of my knowledge and belief.

Date Surveyed Oct 1972
 Registered Professional Engineer and/or Surveyor
HERSCHEL JONES
 No. 23840
 State of OKLAHOMA
 Registered Land Surveyor

0 330 660 990 1320 1650 1980 2310 2640 2000 1500 1000 500 0

113

RECEIVED
JUN 13 1972
OIL CONSERVATION COMM.
HOBBS, N. M.

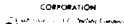

Prohibited

CLASS							GL		
SPD	12-3-72		CMP	12-21-72		FORMATION	DATUM	FORMATION	DATUM
CSG & SX									
8 5/8" at 344' w/250 SX									
5 1/2" at 3800' w/475 SX									
LOGS EL GR RA IND HC A						TD 3800'		PBD	

1P (Queen) Perfs 3579-3709' F 45 ROPD + 585 BW. Pot based on
24 hr test thru 3/4" chk. GOR 444; Grav 36.9; CP 600#; TP 25#

CONTR	Leatherwood	OPRS ELEV	3318	GL PD	3750'	TYPE	RT
-------	-------------	-----------	------	-------	-------	------	----

FR 11-20-72
(Queen)
12-5-72 Dr1.g. 1137'
12-12-72 TD 3800'; Rng Csg
12-18-72 TD 3800'; WO Comp Unit
1-2-73 TD 3800'; Flwg load
Perf 3579-3709' w/45 shots (overall)
Acid (3579-3709') 500 gals
Frac (3579-3709') 60,000 gals wtr + 110,000# sd
1-8-73 TD 3800'; COMPLETE
LOG TOPS: Anhydrite 1160', Salt 1258', Base
Salt 2432', Yates 2657', Seven Rivers 2860',
Queen 3377'
1-13-73 COMPLETION REPORTED