

NO. OF COPIES RECEIVED	
DISTRIBUTION	
SANTA FE	
FILE	
U.S.G.S.	
LAND OFFICE	
OPERATOR	

NEW MEXICO OIL CONSERVATION COMMISSION

Form C-101
Revised 1-1-65

AMENDED

5A. Indicate Type of Lease	
STATE <input type="checkbox"/>	FEE <input type="checkbox"/>
5. State Oil & Gas Lease No.	

APPLICATION FOR PERMIT TO DRILL, DEEPEN, OR PLUG BACK

1a. Type of Work		7. Unit Agreement Name	
b. Type of Well DRILL <input checked="" type="checkbox"/> DEEPEN <input type="checkbox"/> PLUG BACK <input type="checkbox"/> OIL WELL <input checked="" type="checkbox"/> GAS WELL <input type="checkbox"/> OTHER <input type="checkbox"/> SINGLE ZONE <input checked="" type="checkbox"/> MULTIPLE ZONE <input type="checkbox"/>		8. Farm or Lease Name HINTON	
2. Name of Operator Sohio Petroleum Company		9. Well No. 12	
3. Address of Operator P. O. Box 3167, Midland, Texas 79701		10. Field and Pool, or Wildcat Drinkard Pool	
4. Location of Well UNIT LETTER K LOCATED 2310 FEET FROM THE South LINE AND 2310 FEET FROM THE West LINE OF SEC. 12 TWP. 22-S RGE. 37-E NMPM		12. County Lea	
19. Proposed Depth 7500		19A. Formation Granite Wash * *	
20. Rotary or C.T. Rotary		21. Elevations (Show whether DF, RT, etc.) 3339' Gr.	
21A. Kind & Status Plug. Bond \$10,000 Blanket		21B. Drilling Contractor * Unknown	
22. Approx. Date Work will start February 14, 1973			

PROPOSED CASING AND CEMENT PROGRAM

SIZE OF HOLE	SIZE OF CASING	WEIGHT PER FOOT	SETTING DEPTH	SACKS OF CEMENT	EST. TOP
11"	8-5/8"	20# & 24#	1250	380	Circulate
7-7/8"	5-1/2"	15.5 and 17#	7500	630	3000'

- * Contractor will be designated on first C-103.
 ** Well will be drilled and cased thru the Granite Wash and completed in the Drinkard formation in the Drinkard Pool.

8-5/8" will be tested w/minimum of 600 psi for 30 minutes.

5-1/2" will be tested w/minimum of 1500 psi for 30 minutes.

APPROVAL VALID
FOR 90 DAYS UNLESS
DRILLING COMMENCED,

EXPIRES **2-9-73**

IN ABOVE SPACE DESCRIBE PROPOSED PROGRAM: IF PROPOSAL IS TO DEEPEN OR PLUG BACK, GIVE DATA ON PRESENT PRODUCTIVE ZONE AND PROPOSED NEW PRODUCTIVE ZONE. GIVE BLOWOUT PREVENTER PROGRAM, IF ANY.

I hereby certify that the information above is true and complete to the best of my knowledge and belief.

Signed **Burton Whiteley** Title **District Superintendent** Date **February 7, 1973**

(This space for State Use)

APPROVED BY **[Signature]** TITLE **SUPERVISOR DISTRICT** DATE **FEB 9 1973**

CONDITIONS OF APPROVAL, IF ANY:

**MEXICO OIL CONSERVATION COMMISSION
WELL LOCATION AND ACREAGE DEDICATION PLAT**

Form C-102
Supersedes C-128
Effective 1-1-65

All distances must be from the outer boundaries of the Section.

Operator SOHIO PETROLEUM CO.			Lease HINTON		Well No. 12
Unit Letter "K"	Section 12	Township 22-S	Range 37-E	County LEA	
Actual Footage Location of Well: <div style="display: flex; justify-content: space-between;"> 2310 feet from the SOUTH line and 2310 UNDETERMINED feet from the WEST line </div>					
Ground Level Elev. 3339	Producing Formation GRANITE WASH *	Pool WANTZ GRANITE WASH *	Dedicated Acreage: 40 Acres		

1. Outline the acreage dedicated to the subject well by colored pencil or hachure marks on the plat below.
2. If more than one lease is dedicated to the well, outline each and identify the ownership thereof (both as to working interest and royalty).
3. If more than one lease of different ownership is dedicated to the well, have the interests of all owners been consolidated by communitization, unitization, force-pooling, etc?

☐ Yes ☐ No If answer is "yes," type of consolidation _____

If answer is "no," list the owners and tract descriptions which have actually been consolidated. (Use reverse side of this form if necessary.) _____

No allowable will be assigned to the well until all interests have been consolidated (by communitization, unitization, forced-pooling, or otherwise) or until a non-standard unit, eliminating such interests, has been approved by the Commission. *** Will be completed in Drinkard Formation in the Drinkard Pool.**

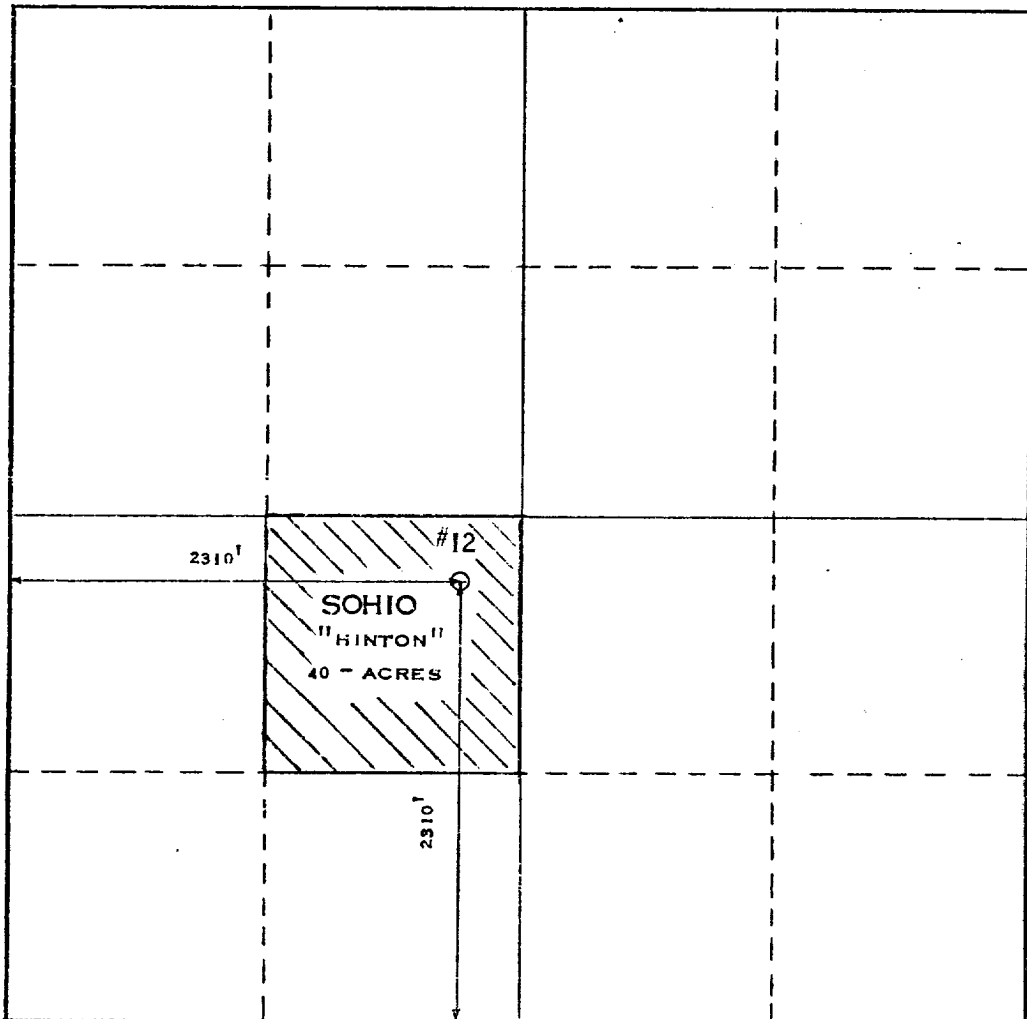

CERTIFICATION

I hereby certify that the information contained herein is true and complete to the best of my knowledge and belief.

Burton Whiteley
Name **BURTON WHITELEY**
District Superintendent

Position
Sohio Petroleum Company

Company
February 7, 1973

Date

I hereby certify that the well location shown on this plat was plotted from field notes of actual surveys made by me or under my supervision, and that the same is true and correct to the best of my knowledge and belief.

Date Surveyed
FEBRUARY 5, 1973

Registered Professional Engineer
and/or Land Surveyor

Max A. Schumann Jr.
MAX A. SCHUMANN JR.

Certificate No. **1510**

