

NO. OF COPIES RECEIVED	
DISTRIBUTION	
SANTA FE	
FILL	
U.S.G.S.	
LAND OFFICE	
OPERATOR	

API NO. 30-025-24380

APPLICATION FOR PERMIT TO DRILL, DEEPEN, OR PLUG BACK

1a. Type of Work DRILL <input type="checkbox"/> DEEPEN <input checked="" type="checkbox"/> PLUG BACK <input type="checkbox"/>		5a. Indicate Type of Lease STATE <input checked="" type="checkbox"/> FEDERAL <input type="checkbox"/>
b. Type of Well OIL WELL <input checked="" type="checkbox"/> GAS WELL <input type="checkbox"/> OTHER <input type="checkbox"/> SINGLE ZONE <input type="checkbox"/> MULTIPLE ZONE <input type="checkbox"/>		5. State Oil & Gas Lease No. P-33440
2. Name of Operator Phillips Petroleum Company		7. Unit Agreement Name
3. Address of Operator Room 401, 4001 Penbrook, Odessa, TX 79762		8. Farm or Lease Name Sims
4. Location of Well UNIT LETTER C LOCATED 380 FEET FROM THE north LINE AND 2310 FEET FROM THE west LINE OF SEC. 24 TWP. 22-S RGE. 37-E NMPM		9. Well No. 7
		10. Field and Pool, or Wildcat Undesignated
		12. County Lea
19. Proposed Depth 7,900		19a. Formation Granite Wash
20. Rotary or C.T. Rotary		
11. Elevations (Show whether DF, RT, etc.) 3326' GR, 3337' RKB,	21A. Kind & Status Plug. Bond Blanket	21B. Drilling Contractor later
		22. Approx. Date Work will start upon approval

23.

ORIGINAL COMPLETION CASING AND CEMENT PROGRAM

SIZE OF HOLE	SIZE OF CASING	WEIGHT PER FOOT	SETTING DEPTH	SACKS OF CEMENT	TOP
11"	8-5/8"	24#	1161'	200 sx TRLW	w/10% DD,
(10% salt followed by		200 sx Class H	w/2% CaCl ₂		Surface
7 7/8"	5-1/2"	14#, 15.5#	7478'	1000 sx TRLW &	300 sx Class H.
					2330'

4" Liner: ABC FL4S, 11.6#/ft., N-80, tied into 5-1/2" csg and set at TD.

Use mud additives as required for control.

BOP Equipment: 3000 psi WP/PPCo. BOP Standard Figure No. 7

IN ABOVE SPACE DESCRIBE PROPOSED PROGRAM: IF PROPOSAL IS TO DEEPEN OR PLUG BACK, GIVE DATA ON PRESENT PRODUCTIVE ZONE AND PROPOSED NEW PRODUCTIVE ZONE. GIVE BLOWOUT PREVENTER PROGRAM, IF ANY.

I hereby certify that the information above is true and complete to the best of my knowledge and belief.

Signed [Signature] W. J. Mueller Title Senior Engineering Specialist Date November 4, 1982

(This space for State Use)

ORIGINAL SIGNED BY

APPROVED BY JERRY SEXTON TITLE DATE NOV 10 1982

CONDITIONS OF APPROVAL

**MEXICO OIL CONSERVATION COMMISSION
WELL LOCATION AND ACREAGE DEDICATION PLAT**

Form C-102
Supersedes C-128
Effective 1-1-65

All distances must be from the outer boundaries of the Section.

Operator PHILLIPS PETROLEUM COMPANY		Lease SIMS		Well No. 7
Unit Letter C	Section 24	Township 22 SOUTH	Range 37 EAST	County LEA
Actual Footage Location of Well: 2310 feet from the WEST line and 380 feet from the NORTH line				
Ground Level Elev. 3321'	Producing Formation Precambrian	Pool Undesignated	Dedicated Acreage: 40 Acres	

1. Outline the acreage dedicated to the subject well by colored pencil or hachure marks on the plat below.
2. If more than one lease is dedicated to the well, outline each and identify the ownership thereof (both as to working interest and royalty).
3. If more than one lease of different ownership is dedicated to the well, have the interests of all owners been consolidated by communitization, unitization, force-pooling, etc?

☐ Yes ☐ No If answer is "yes," type of consolidation N/A

If answer is "no," list the owners and tract descriptions which have actually been consolidated. (Use reverse side of this form if necessary.) _____

No allowable will be assigned to the well until all interests have been consolidated (by communitization, unitization, forced-pooling, or otherwise) or until a non-standard unit, eliminating such interests, has been approved by the Commission.

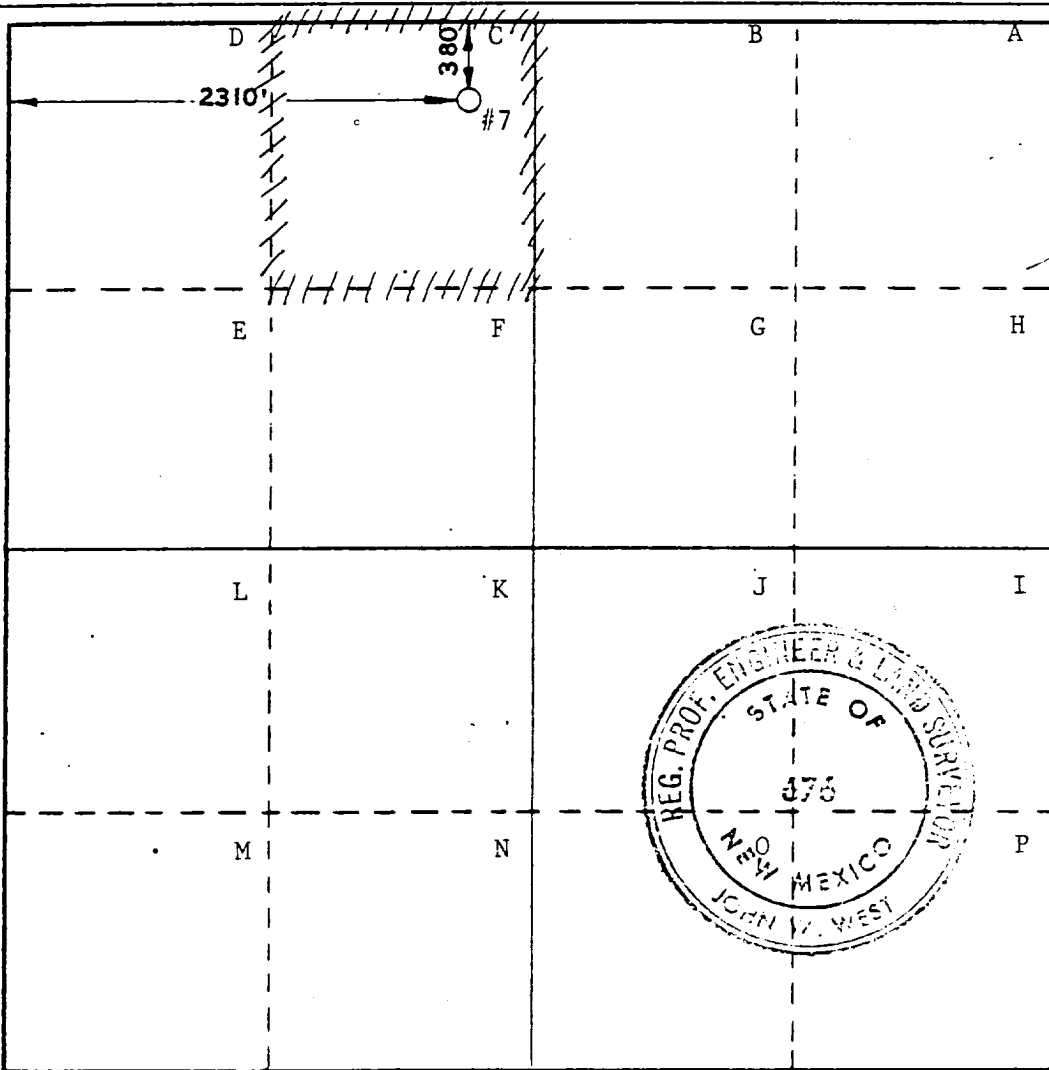

CERTIFICATION

I hereby certify that the information contained herein is true and complete to the best of my knowledge and belief.

Name W. J. Mueller
Position Senior Engineering Specialist

Company Phillips Petroleum

Date November 4, 1982

I hereby certify that the well location shown on this plat was plotted from field notes of actual surveys made by me or under my supervision, and that the same is true and correct to the best of my knowledge and belief.

Date Surveyed
FEBRUARY 21, 1973

Registered Professional Engineer
and/or Land Surveyor

John W. West

Certificate No. _____

