



PHILLIPS PETROLEUM COMPANY

ODESSA, TEXAS 79761
PHILLIPS BUILDING

NATURAL RESOURCES GROUP
Exploration and Production

April 27, 1977

Sims Well No. 7--
Unorthodox Location--
Tubb Gas Pool,
Lea County

File: W4-Ta-212-77

New Mexico Oil Conservation Commission
P. O. Box 2088
Santa Fe, New Mexico 87501

Attention: Mr. Joe D. Ramey, (3)
Secretary-Director

Gentlemen:

We respectfully request administrative approval of the unorthodox location of the Sims Well No. 7 for a completion in the Tubb Gas Pool. This well was originally drilled and completed in the Drinkard Pool with its location being orthodox for that completion. It locates in Unit C, 380 feet from north, 330 feet from east, and 2310 feet from west lines of the northwest quarter Section 24, T-22-S, R-37-E, Lea County, which location does not meet the minimum of 660 feet from the outer boundaries of the Tubb Gas proration unit. We enclose a proration dedication plat reflecting the well location as well as a separate plat reflecting offset operators and well completions.

Offset operators per the attached list have been notified by certified mail of this application. Further, it is understood that assignment of allowable to this well, which will share the proration unit with Well No. 3, is subject to the Commission's approval of its completion reports and our dual completion application. Those forms are being submitted through regular channels under separate cover.

Your consideration and approval, subject to the waiting period as provided under Rule 104, Paragraph F, will be appreciated.

Very truly yours,

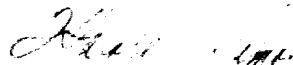
T. Harold McLemore
PHILLIPS PETROLEUM COMPANY

THM:db

Attachments

cc: New Mexico Oil Conservation Commission, Hobbs ✓
Addressee List Attached

RECEIVED

1968 FEB

COMM. DIV.

Sims Well No. 7--Attachment
To: NMOCC--Santa Fe, New Mexico
From: T. Harold McLemore
Date: April 27, 1977

OFFSET OPERATORS

Coquina Oil Corporation
Box 2960
Midland, Texas 79701

Crown Central Petroleum Corporation
Suite 1002, Wilco Building
Midland, Texas 79701

Gulf Energy and Minerals, Inc.
Box 1150
Midland, Texas 79701

John H. Hendrix Corporation
525 Midland Tower
Midland, Texas 79701

Marathon Oil Company
Box 552
Midland, Texas 79701

Samedan Oil Corporation
2207 Wilco Building
Midland, Texas 79701

Texas Pacific Oil Company, Inc.
1700 One Main Place
Dallas, Texas 75250

Union Texas Petroleum
1413 Wilco Building
Midland, Texas 79701

Mr. Bruce A. Wilbanks
Box 763
Midland, Texas 79701

RECEIVED

APR 21 1977

LIBRARY OF THE JAMA
615 N. Dearborn St., Chicago, Ill. 60610

NEW MEXICO OIL CONSERVATION COMMISSION
WELL LOCATION AND ACREAGE DEDICATION PLAT

Form C-102
Supersedes C-128
Effective 1-1-65

All distances must be from the outer boundaries of the Section.

Operator Phillips Petroleum Company		Lease Sims		Well No. 7	
Unit Letter C	Section 24	Township 22-S	Range 37-E	County Lea	
Actual Footage Location of Well: 380 feet from the north line and 2310 feet from the west line					
Ground Level Elev. 3326' Gr, 3337' RKB	Producing Formation Tubb-Gas	Pool Tubb-Gas	Dedicated Acreage: *160 Acres		

1. Outline the acreage dedicated to the subject well by colored pencil or hachure marks on the plat below.
2. If more than one lease is dedicated to the well, outline each and identify the ownership thereof (both as to working interest and royalty).
3. If more than one lease of different ownership is dedicated to the well, have the interests of all owners been consolidated by communitization, unitization, force-pooling, etc?

☐ Yes ☐ No If answer is "yes," type of consolidation _____

If answer is "no," list the owners and tract descriptions which have actually been consolidated. (Use reverse side of this form if necessary.) _____

No allowable will be assigned to the well until all interests have been consolidated (by communitization, unitization, forced-pooling, or otherwise) or until a non-standard unit, eliminating such interests, has been approved by the Commission.

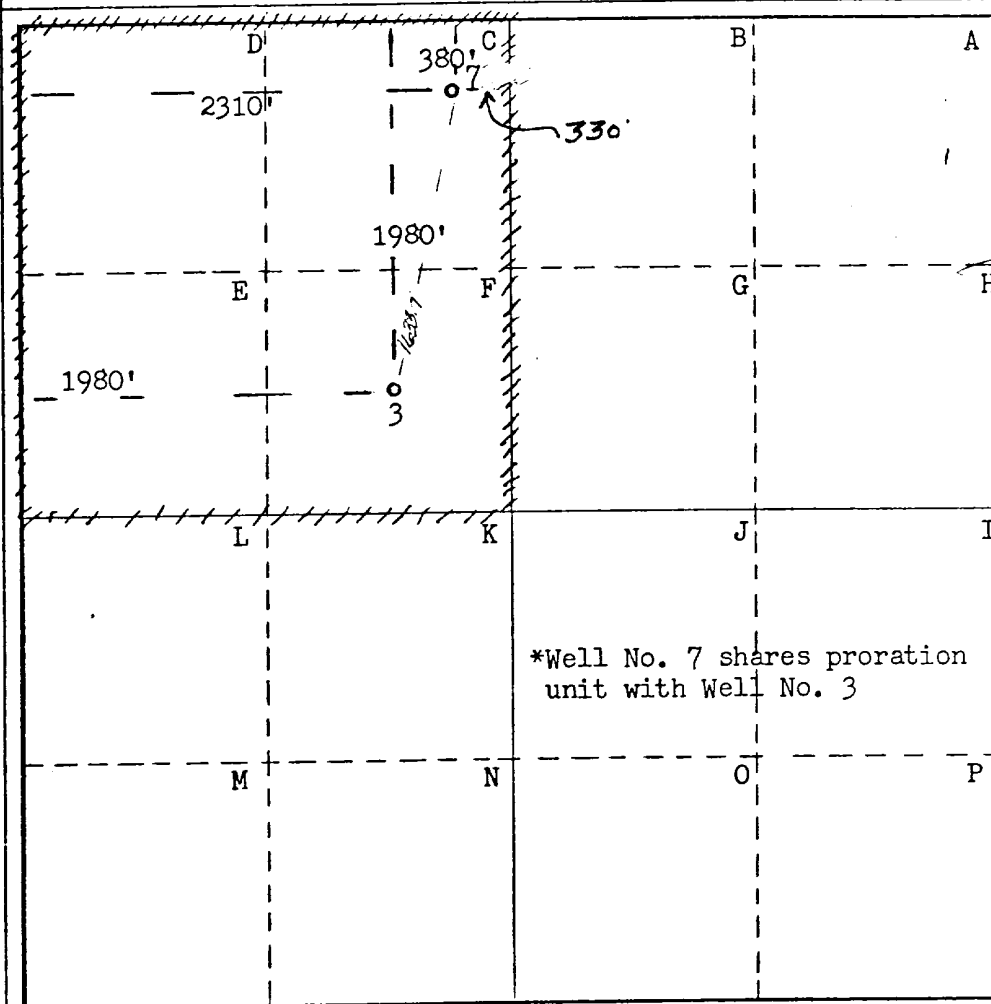

CERTIFICATION

I hereby certify that the information contained herein is true and complete to the best of my knowledge and belief.

[Signature]
Name
W. J. Mueller
Position
Engineering Advisor
Company
Phillips Petroleum Co.
Date
April 20, 1977

I hereby certify that the well location shown on this plat was plotted from field notes of actual surveys made by me or under my supervision, and that the same is true and correct to the best of my knowledge and belief.

Date Surveyed
2-21-73
Registered Professional Engineer and/or Land Surveyor

John W. West
Certificate No.

676

0 330 660 990 1320 1650 1980 2310 2640 2000 1500 1000 500 0

RECEIVED
APR 21 1957
U.S. AIR FORCE COMM.
WASH. D.C.

RECEIVED

APR 21 1977

U.S. COMM. ON INT. COMM.
HOBBES, L. L.