



KENNETH D. REYNOLDS - ARTESIA
LESLIE K. EVERTSON - ROSWELL

DRILLING CO., INC. - OIL WELL DRILLING CONTRACTORS

P. O. BOX 2055 ROSWELL, NEW MEXICO 88201
TELEPHONES: ARTESIA 746-6757
ROSWELL 623-5070

July 6, 1973

Armer Oil Company
2110 Continental National Bank Bldg.
Ft. Worth, Texas

Re: Fluor #1

Gentlemen:

The following is a Deviation Survey of the above well:

396'	-	1 $\frac{1}{4}$
838'	-	3/4
1341'	-	1
1807'	-	1 $\frac{1}{4}$
2278'	-	1 $\frac{1}{4}$
2675'	-	1 $\frac{1}{4}$
3058'	-	1 $\frac{1}{4}$
3357'	-	1
3844'	-	3/4
4320'	-	3/4
4500'	-	3/4

Yours very truly,

WEK DRILLING CO., INC

Kenneth D. Reynolds

STATE OF NEW MEXICO }
COUNTY OF CHAVES }

The foregoing was acknowledged before me this 6th
day of July, 1973, by Kenneth D. Reynolds.

My Commission Expires:

11-23-75

Notary Public

NO. OF COPIES RECEIVED	
DISTRIBUTION	
SANTA FE	
FILE	
U.S.G.S.	
LAND OFFICE	
OPERATOR	

NEW MEXICO OIL CONSERVATION COMMISSION

Form C-103
Supersedes Old
C-102 and C-103
Effective 1-1-65

5a. Indicate Type of Lease	
State <input type="checkbox"/>	Fee <input checked="" type="checkbox"/>
5. State Oil & Gas Lease No.	
--	

SUNDRY NOTICES AND REPORTS ON WELLS (DO NOT USE THIS FORM FOR PROPOSALS TO DRILL OR TO DEEPEN OR PLUG BACK TO A DIFFERENT RESERVOIR. USE "APPLICATION FOR PERMIT --" (FORM C-101) FOR SUCH PROPOSALS.)

1. <input checked="" type="checkbox"/> OIL WELL <input type="checkbox"/> GAS WELL <input type="checkbox"/> OTHER-		7. Unit Agreement Name
2. Name of Operator Armer Oil Company		8. Farm or Lease Name Fluor
3. Address of Operator 2110 Continental National Bank Bldg., Ft. Worth, Texas 76102		9. Well No. 1
4. Location of Well UNIT LETTER <u>M</u> <u>660</u> FEET FROM THE <u>South</u> LINE AND <u>660</u> FEET FROM THE <u>West</u> LINE, SECTION <u>35</u> TOWNSHIP <u>22S</u> RANGE <u>37E</u> NMPM.		10. Field and Pool, or Wildcat Langlie-Mattix S.R-Queen
15. Elevation (Show whether DF, RT, GR, etc.) 3319' KBM		12. County Lea

Check Appropriate Box To Indicate Nature of Notice, Report or Other Data NOTICE OF INTENTION TO:

PERFORM REMEDIAL WORK <input type="checkbox"/>	PLUG AND ABANDON <input type="checkbox"/>
TEMPORARILY ABANDON <input type="checkbox"/>	CHANGE PLANS <input type="checkbox"/>
PULL OR ALTER CASING <input type="checkbox"/>	OTHER <input type="checkbox"/>

SUBSEQUENT REPORT OF:

REMEDIAL WORK <input type="checkbox"/>	ALTERING CASING <input type="checkbox"/>
COMMENCE DRILLING OPNS. <input checked="" type="checkbox"/>	PLUG AND ABANDONMENT <input type="checkbox"/>
CASING TEST AND CEMENT JOB <input checked="" type="checkbox"/>	OTHER <input type="checkbox"/>

17. Describe Proposed or Completed Operations (Clearly state all pertinent details, and give pertinent dates, including estimated date of starting any proposed work) SEE RULE 1103.

- Commenced drilling operations with rotary tools on June 17, 1973.
- Set 8-5/8" OD, 24# surface casing @ 392' KBM and cemented with 250 sacks Class C cement with 2% Calcium Chloride on 6/17/73. Waited on cement 8 hours, pressure tested casing to 1000 psi before drilling plug.
- Set 5-1/2" O.D. 15.5# oil string at 3640' KBM on full flow packer shoe. Cemented casing above packer shoe with 150 sacks Class C cement and 200 sacks Class H on 6/27/73. Pumped plug through packer shoe. Top cement behind casing 2390' KBM as per GO International Cement Bond Log.
- Set cement retainer in 5-1/2" OD casing at 3631' KBM and cemented open hole 3640-4500' with 50 sacks Class C cement on July 5, 1973. Pressure tested casing to 2500 psi before perforating.

18. I hereby certify that the information above is true and complete to the best of my knowledge and belief.

SIGNED CDK Suley TITLE Production Manager DATE August 16, 1973

APPROVED BY _____ TITLE _____ DATE _____

CONDITIONS OF APPROVAL, IF ANY:

NO. OF COPIES RECEIVED		
DISTRIBUTION		
SANTA FE		
FILE		
U.S.G.S.		
LAND OFFICE		
OPERATOR		

NEW MEXICO OIL CONSERVATION COMMISSION

Form C-101
Revised 1-1-65

APPLICATION FOR PERMIT TO DRILL, DEEPEN, OR PLUG BACK		5A. Indicate Type of Lease STATE <input type="checkbox"/> FEE <input type="checkbox"/>
1a. Type of Work b. Type of Well OIL WELL <input checked="" type="checkbox"/> GAS WELL <input type="checkbox"/> OTHER <input type="checkbox"/> SINGLE ZONE <input checked="" type="checkbox"/> MULTIPLE ZONE <input type="checkbox"/>		5. State Oil & Gas Lease No. -
2. Name of Operator Armer Oil Company		7. Unit Agreement Name -
3. Address of Operator 2110 Continental National Bank Bldg., Ft. Worth, Texas 76102		8. Farm or Lease Name Fluor
4. Location of Well UNIT LETTER M LOCATED 660 FEET FROM THE S LINE AND 660 FEET FROM THE W LINE OF SEC. 35 TWP. 22S RGE. 37E NMPM		9. Well No. 1
		10. Field and Pool, or Wildcat Langlie Mattix
		12. County Lea
		19. Proposed Depth 4500'
		19A. Formation San Andres - test Penrose Sd. Comp. Rotary
		20. Rotary or C.T. Rotary
21. Elevations (Show whether DF, RT, etc.) 21A. Kind & Status Plug. Bond Blanket Bond #919A5228		21B. Drilling Contractor WEK Drilling Co., Inc.
		22. Approx. Date Work will start 6-18-73

PROPOSED CASING AND CEMENT PROGRAM

SIZE OF HOLE	SIZE OF CASING	WEIGHT PER FOOT	SETTING DEPTH	SACKS OF CEMENT	EST. TOP
11"	8-5/8" OD	20#	400'	250	Circulate
7-7/8"	5-1/2" OD	15.5#	3750'	350	2500'

Armer Oil Company proposes to drill Fluor #1 to a depth of approximately 4500' to test the San Andres formation. The well will be completed in the Penrose Sand of the Langlie Mattix Field, the top of which is anticipated at a depth of 3550'. Completion will be thru perforations with stimulation by acid and hydraulic fracture.

IN ABOVE SPACE DESCRIBE PROPOSED PROGRAM; IF PROPOSAL IS TO DEEPEN OR PLUG BACK, GIVE DATA ON PRESENT PRODUCTIVE ZONE AND PROPOSED NEW PRODUCTIVE ZONE. GIVE BLOWOUT PREVENTER PROGRAM, IF ANY.

I hereby certify that the information above is true and complete to the best of my knowledge and belief.

Signed John W. Seely Title Production Manager Date 6-13-73

(This space for State Use)

APPROVED BY John W. Seely TITLE Production Manager DATE 6-13-73
CONDITIONS OF APPROVAL, IF ANY:

**NEW MEXICO OIL CONSERVATION COMMISSION
WELL LOCATION AND ACREAGE DEDICATION PLAT**

Form C-102
Supersedes C-128
Effective 1-1-65

All distances must be from the outer boundaries of the Section.

Operator ARMER OIL Co.			Lease FLUOR		Well No. 1
Unit Letter M	Section 35	Township 22 SOUTH	Range 37 EAST	County LEA	
Actual Footage Location of Well: <div style="display: flex; justify-content: space-between;"> 660 feet from the SOUTH line and 660 feet from the WEST line </div>					
Ground Level Elev. 3309	Producing Formation PENROSE	Pool LANGLIE-MADDOX		Dedicated Acreage: 40 Acres	

1. Outline the acreage dedicated to the subject well by colored pencil or hachure marks on the plat below.
2. If more than one lease is dedicated to the well, outline each and identify the ownership thereof (both as to working interest and royalty).
3. If more than one lease of different ownership is dedicated to the well, have the interests of all owners been consolidated by communitization, unitization, force-pooling, etc?

☐ Yes ☐ No If answer is "yes," type of consolidation _____

If answer is "no," list the owners and tract descriptions which have actually been consolidated. (Use reverse side of this form if necessary.) _____

No allowable will be assigned to the well until all interests have been consolidated (by communitization, unitization, forced-pooling, or otherwise) or until a non-standard unit, eliminating such interests, has been approved by the Commission.

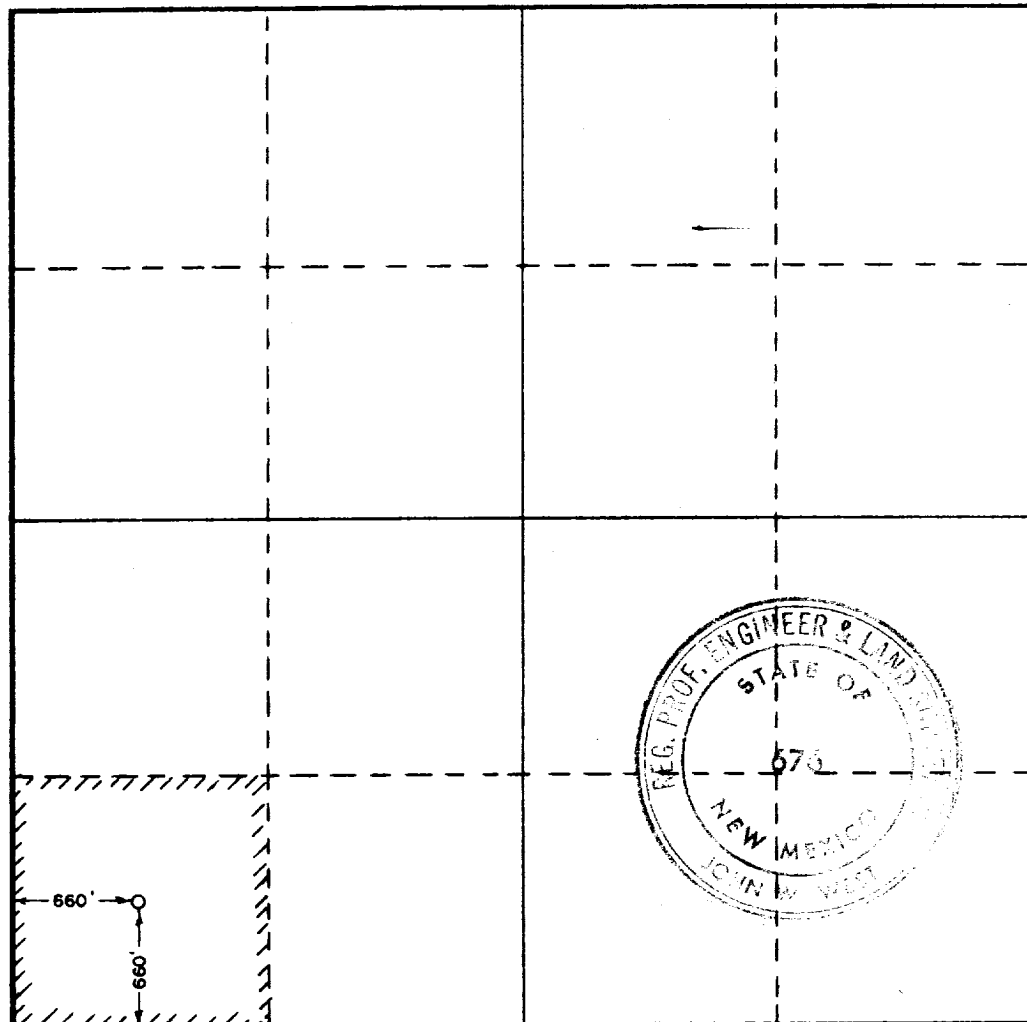

CERTIFICATION

I hereby certify that the information contained herein is true and complete to the best of my knowledge and belief.

C. W. Sealy
Name **C. W. SEALY**

Position **SUPT.**

Company **ARMER OIL Co.**

Date **JUNE 14, 1973**

I hereby certify that the well location shown on this plat was plotted from field notes of actual surveys made by me or under my supervision, and that the same is true and correct to the best of my knowledge and belief.

Date Surveyed **JUNE 13, 1973**

Registered Professional Engineer and/or Land Surveyor

John W. West
Certificate No. **676**



RECEIVED

JUN 14 1973

OIL CONSERVATION COMM.
HOBBS, N. M.

173