

UNITED STATES  
DEPARTMENT OF THE INTERIOR  
GEOLOGICAL SURVEY

## APPLICATION FOR PERMIT TO DRILL, DEEPEN, OR PLUG BACK

1a. TYPE OF WORK DRILL <input checked="" type="checkbox"/> DEEPEN <input type="checkbox"/> PLUG BACK <input type="checkbox"/>		5. LEASE DESIGNATION AND SERIAL NO. LC 064427		
b. TYPE OF WELL OIL WELL <input checked="" type="checkbox"/> GAS WELL <input type="checkbox"/> OTHER <input type="checkbox"/> SINGLE ZONE <input checked="" type="checkbox"/> MULTIPLE ZONE <input type="checkbox"/>		6. IF INDIAN, ALLOTTEE OR TRIBE NAME		
2. NAME OF OPERATOR SONIO PETROLEUM COMPANY		7. UNIT AGREEMENT NAME		
3. ADDRESS OF OPERATOR P. O. Box 3167, Midland, Texas 79701		8. FARM OR LEASE NAME Elliott B-12-2		
4. LOCATION OF WELL (Report location clearly and in accordance with any State requirements.)* At surface 2310' FWL, 660' FWL, Sec. 12, T-22-S, R-37-E, NPM. At proposed prod. zone Drinkard.		9. WELL NO. 3		
14. DISTANCE IN MILES AND DIRECTION FROM NEAREST TOWN OR POST OFFICE* 3 1/2 Miles South of Eunice, New Mexico.		10. FIELD AND POOL, OR WILDCAT Drinkard		
15. DISTANCE FROM PROPOSED* LOCATION TO NEAREST PROPERTY OR LEASE LINE, FT. (Also to nearest drlg. unit line, if any) 660'		11. SEC., T., R., M., OR BLK. AND SURVEY OR AREA Unit E, Sec. 12, T-22-S, R-37-E		
16. NO. OF ACRES IN LEASE 40		12. COUNTY OR PARISH Leon		
17. NO. OF ACRES ASSIGNED TO THIS WELL 40		13. STATE New Mexico		
18. DISTANCE FROM PROPOSED LOCATION* TO NEAREST WELL, DRILLING, COMPLETED, OR APPLIED FOR, ON THIS LEASE, FT. 330'		19. PROPOSED DEPTH 7400'		
20. ROTARY OR CABLE TOOLS Rotary		21. APPROX. DATE WORK WILL START* August 25, 1973		
22. ELEVATIONS (Show whether DF, RT, GR, etc.) 3343' G. R.		23. PROPOSED CASING AND CEMENTING PROGRAM		
SIZE OF HOLE 11" 7-7/8"	SIZE OF CASING 8-5/8" 5-1/2"	WEIGHT PER FOOT 23# 15.5# 4/or 17#	SETTING DEPTH 1262 7400'	QUANTITY OF CEMENT 300 Class C; 130 Neat. 630

Propose to drill to Granite Wash and complete in Drinkard.

Contractor: Leatherwood Drilling Company. 8-5/8" will be cemented with 360 sacks Class C cement with 4% gel and 130 sacks neat cement with 2% cc. Cement will be circulated to surface. 8-5/8" will be tested with minimum of 600 psi for 30 minutes; 5-1/2" will be tested with minimum of 1500 psi for 30 minutes.

Mud Program: From 1265' to 6200' drill with native mud and brine water. From 6200' to 7400' drill with 10# mud, salt gel, 40 viscosity, 20 cc water loss. Will use 10" double Shaffer Type B, Series 900, with Paine closing device, 10,000#.

Plan to penetrate the Drinkard zone, and acidize with 6,000 to 10,000 gallons of 15% NE acid.

IN ABOVE SPACE DESCRIBE PROPOSED PROGRAM: If proposal is to deepen or plug back, give data on present productive zone and proposed new productive zone. If proposal is to drill or deepen directionally, give pertinent data on subsurface locations and measured and true vertical depths. Give blowout preventer program, if any.

24.  District Superintendent  
SIGNED Burton W. Whiteley TITLE Midland District DATE September 4, 1973  
(This space for Federal or State office use)

PERMIT NO. \_\_\_\_\_

APPROVED BY \_\_\_\_\_

CONDITIONS OF APPROVAL, IF ANY: \_\_\_\_\_

TITLE \_\_\_\_\_

APPROVED

SEP 10 1973

ARTHUR R. BROWN  
DISTRICT ENGINEER

DATE \_\_\_\_\_

## Instructions

**General:** This form is designed for submitting proposals to perform certain well operations, as indicated, on all types of lands and leases for appropriate action by either a Federal or a State agency, or both, pursuant to applicable Federal and/or State laws and regulations. Any necessary special instructions concerning the use of this form and the number of copies to be submitted, particularly with regard to local, area, or regional procedures and practices, either are shown below or will be issued by, or may be obtained from, the local Federal and/or State office.

**Item 1:** If the proposal is to redrill to the same reservoir at a different subsurface location or to a new reservoir, use this form with appropriate notations. Consult applicable State or Federal regulations concerning subsequent work proposals or reports on the well.

**Item 4:** If there are no applicable State requirements, locations on Federal or Indian land should be described in accordance with Federal requirements. Consult local State or Federal office for specific instructions.

**Item 14:** Needed only when location of well cannot readily be found by road from the land or lease description. A plat, or plats, separate or on this reverse side, showing the roads to, and the surveyed location of, the well, and any other required information, should be furnished when required by Federal or State agency offices.

**Items 15 and 18:** If well is to be, or has been directionally drilled, give distances for subsurface location of hole in any present or objective production zone.

**Item 22:** Consult applicable Federal or State regulations, or appropriate officials, concerning approval of the proposal before operations are started.

U.S. GOVERNMENT PRINTING OFFICE : 1963-O-711-396

839-171

RECEIVED

DEC 11 1963

U.S. GOVERNMENT PRINTING OFFICE

**N MEXICO OIL CONSERVATION COMMISS**  
**WELL LOCATION AND ACREAGE DEDICATION PL**

Form C-102  
 Supersedes C-128  
 Effective 1-1-65

All distances must be from the outer boundaries of the Section.

Operator <b>SOHIO PETROLEUM COMPANY</b>			Lease <b>ELLIOTT B-12-2</b>		Well No. <b>3</b>
Unit Letter <b>"E"</b>	Section <b>12</b>	Township <b>22-S</b>	Range <b>37-E</b>	County <b>LEA</b>	
Actual Footage Location of Well: <b>2310</b> feet from the <b>NORTH</b> line and <b>660</b> feet from the <b>WEST</b> line					
Ground Level Elev: <b>3343</b>	Producing Formation <b>DRINKARD</b>		Pool <b>DRINKARD</b>		Dedicated Acreage: <b>40</b> Acres

1. Outline the acreage dedicated to the subject well by colored pencil or hachure marks on the plat below.
2. If more than one lease is dedicated to the well, outline each and identify the ownership thereof (both as to working interest and royalty).
3. If more than one lease of different ownership is dedicated to the well, have the interests of all owners been consolidated by communitization, unitization, force-pooling, etc?

☐ Yes    ☐ No    If answer is "yes," type of consolidation \_\_\_\_\_

If answer is "no," list the owners and tract descriptions which have actually been consolidated. (Use reverse side of this form if necessary.) \_\_\_\_\_

No allowable will be assigned to the well until all interests have been consolidated (by communitization, unitization, forced-pooling, or otherwise) or until a non-standard unit, eliminating such interests, has been approved by the Commission.

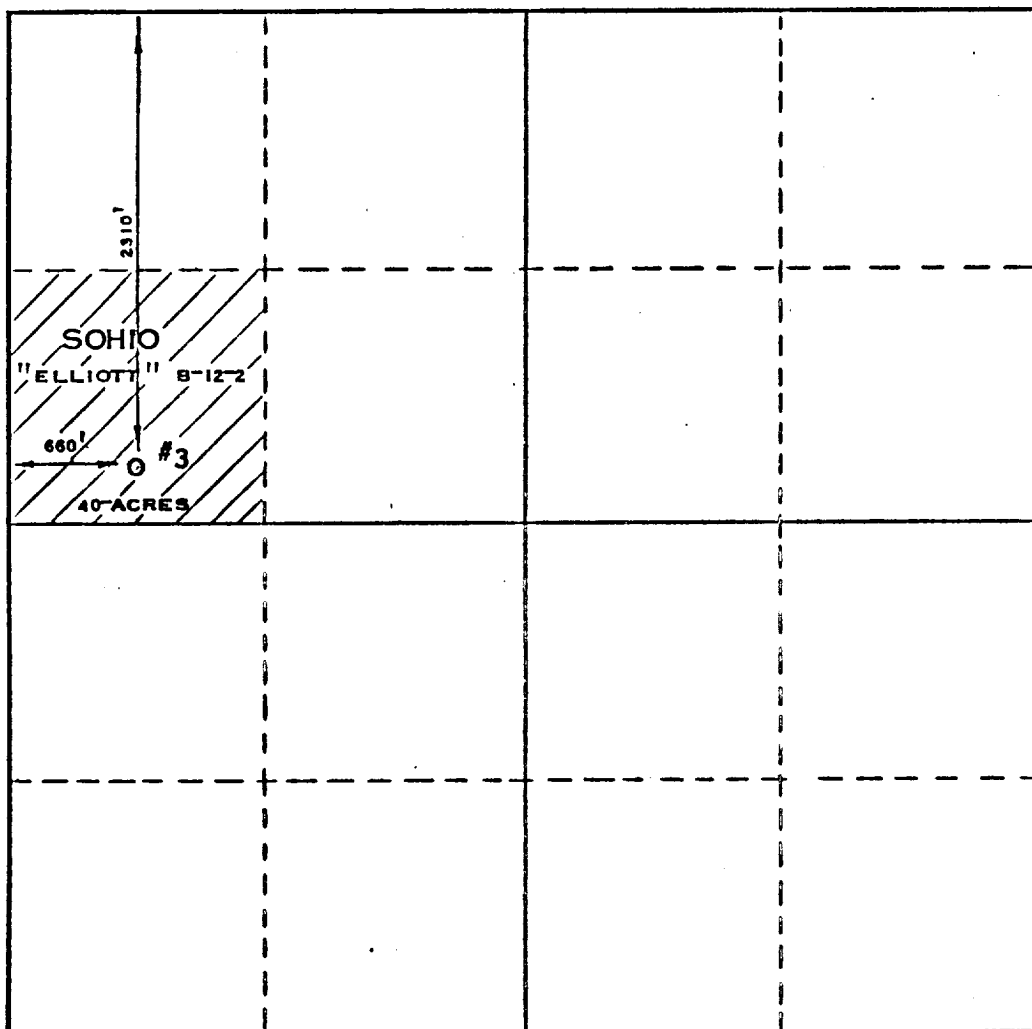

**CERTIFICATION**

I hereby certify that the information contained herein is true and complete to the best of my knowledge and belief.

Name Richard H. Whiteley  
 Midland District Supt.

Position SOHIO PETROLEUM COMPANY

Company  
 August 21, 1973

Date

I hereby certify that the well location shown on this plat was plotted from field notes of actual surveys made by me or under my supervision, and that the same is true and correct to the best of my knowledge and belief.

Date Surveyed  
 AUGUST 15, 1973

Registered Professional Engineer  
 and/or Land Surveyor

MAX A. SCHUMANN, JR.

Certificate No. **1510**



SOHIO PETROLEUM COMPANY  
EXPLORATION AND PRODUCTION

MIDLAND, TEXAS 79701  
P. O. BOX 3167

September 4, 1973

MIDLAND DISTRICT

United States Department of the Interior  
P. O. Box 1157  
Hobbs, New Mexico 88240

Gentlemen:

Enclosed are six (6) copies of our Application for Permit to Drill the Elliott B-12-2 Well No. 3, together with six (6) location plats.

Our Development Plan for surface use is as follows:

1. A U. S. G. S. topographic map of the area showing existing roads, access road and location of the well and tank batteries.
2. A plat showing all wells within a one-mile radius of the proposed developmental well.
3. A plat showing the location lay-out of the drilling pad, rig, mud tanks, reserve and burn pits and pipe racks.
4. Methods of handling waste disposal:  
Drill cuttings will be caught and collected in the reserve mud pit. Upon completion of this well, the pit will be closed thereby burying the drill cuttings. The trash, garbage, and other debris, will be cleaned up from the lease and also buried in the bottom of the reserve mud pit.
5. Plans for restoration of the surface:  
The drill site area is presently covered mainly by a growth of mesquite. The drill site will be cleaned up of any trash and debris; however, there are no plans for reseedling.
6. Other information about drill site:  
The drill site area is virtually flat terrain with no pronounced physical features such as streams, gullies, etc. The vegetation, as noted above, is primarily mesquite.

Yours very truly,

SOHIO PETROLEUM COMPANY

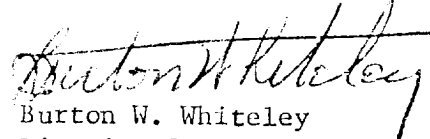
  
Burton W. Whiteley  
District Superintendent  
Midland District

JHC/BWW:lsm  
Attachs.

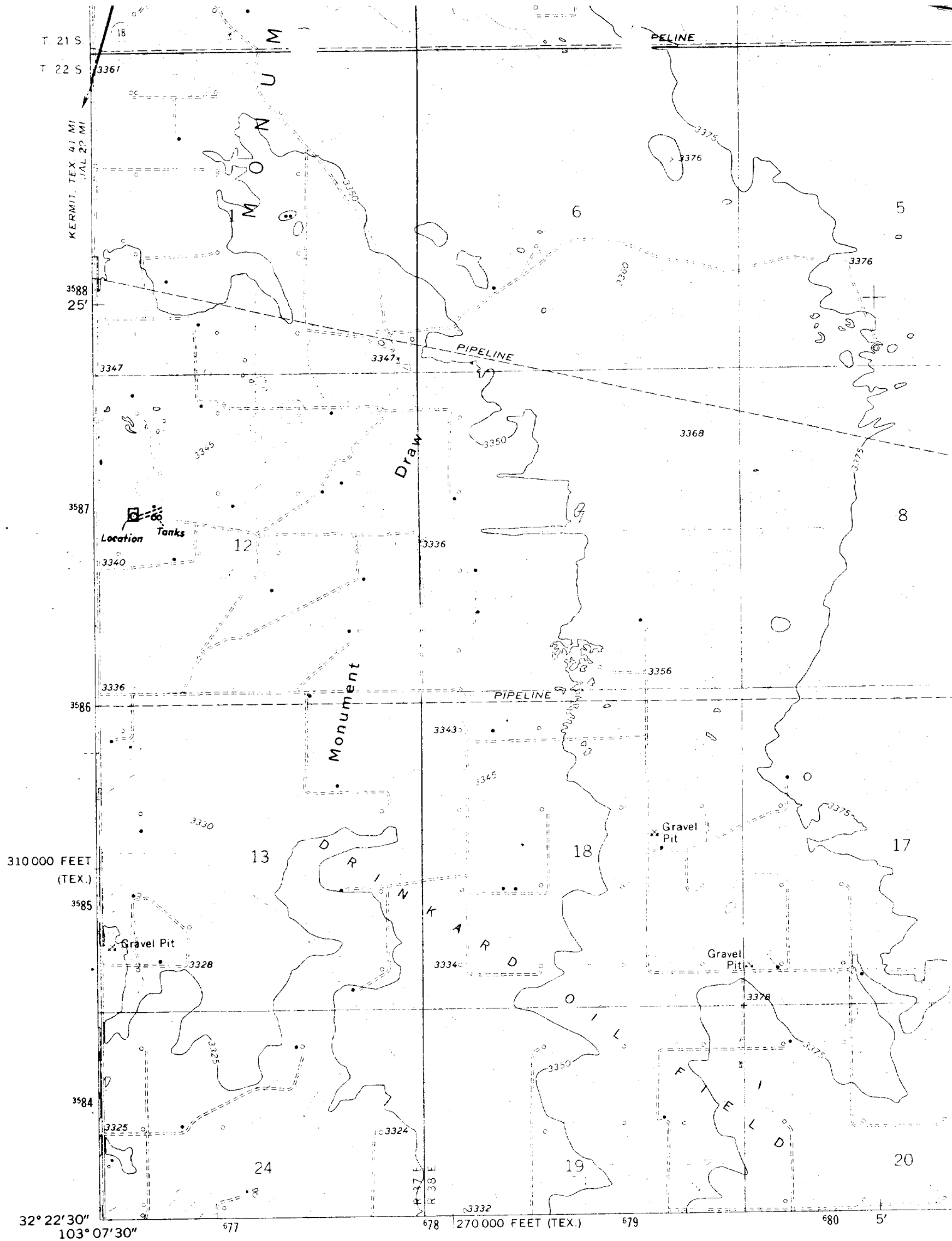

Mapped, edited, and published by the Geological Survey

Control by USGS and USC&GS

68 1 SW  
ESNAKE  
ON

★  
MN