

NO. OF COPIES RECEIVED	
DISTRIBUTION	
SANTA FE	
FILE	
U.S.G.S.	
LAND OFFICE	
OPERATOR	

# NEW MEXICO OIL CONSERVATION COMMISSION

Form C-101  
Revised 1-1-65

5A. Indicate Type of Lease	
STATE <input type="checkbox"/>	FEE <input checked="" type="checkbox"/>

5. State Oil & Gas Lease No.

## APPLICATION FOR PERMIT TO DRILL, DEEPEN, OR PLUG BACK

1a. Type of Work		7. Unit Agreement Name	
b. Type of Well DRILL <input checked="" type="checkbox"/> DEEPEN <input type="checkbox"/> PLUG BACK <input type="checkbox"/> OIL WELL <input checked="" type="checkbox"/> GAS WELL <input type="checkbox"/> OTHER <input type="checkbox"/> SINGLE ZONE <input checked="" type="checkbox"/> MULTIPLE ZONE <input type="checkbox"/>		8. Farm or Lease Name <b>E. W. Walden</b>	
2. Name of Operator <b>Anadarko Production Company</b>		9. Well No. <b>11</b>	
3. Address of Operator <b>P. O. Box 247, Hobbs, New Mexico 88240</b>		10. Field and Pool, or Wildcat <b>Undesignated</b>	
4. Location of Well UNIT LETTER <b>M</b> LOCATED <b>660'</b> FEET FROM THE <b>West</b> LINE AND <b>990</b> FEET FROM THE <b>South</b> LINE OF SEC. <b>15</b> TWP. <b>22S</b> RGE. <b>37E</b> NMPM		12. County <b>Lea</b>	
19. Proposed Depth <b>4600'</b>		19A. Formation <b>San Andres</b>	
20. Rotary or C.T. <b>Rotary</b>		21. Elevations (Show whether DF, RT, etc.) <b>3397' GL</b>	
21A. Kind & Status Plug. Bond <b>Blanket on File</b>		21B. Drilling Contractor <b>WEK Drlg. Co.</b>	
22. Approx. Date Work will start <b>12-3-73</b>			

23. PROPOSED CASING AND CEMENT PROGRAM					
SIZE OF HOLE	SIZE OF CASING	WEIGHT PER FOOT	SETTING DEPTH	SACKS OF CEMENT	EST. TOP
11"	8-5/8"	24#	325'	150	Circulate
7-7/8"	5 1/2"	14#	4600'	200	Base of Salt

APPROVAL VALID  
FOR 90 DAYS UNLESS  
DRILLING COMMENCED,  
EXPIRES 2-29-74

IN ABOVE SPACE DESCRIBE PROPOSED PROGRAM: IF PROPOSAL IS TO DEEPEN OR PLUG BACK, GIVE DATA ON PRESENT PRODUCTIVE ZONE AND PROPOSED NEW PRODUCTIVE ZONE. GIVE BLOWOUT PREVENTER PROGRAM, IF ANY.

I hereby certify that the information above is true and complete to the best of my knowledge and belief.

Signed M. J. Johnson Title Area Supervisor Date 11-27-73

(This space for State Use)

APPROVED BY [Signature] TITLE  DATE

CONDITIONS OF APPROVAL, IF ANY: No allowable will be assigned for this well until either a standard 80 acre unit is formed, or a Non-Standard Unit Order is obtained.

**NEW MEXICO OIL CONSERVATION COMMISSION  
WELL LOCATION AND ACREAGE DEDICATION PLAT**

Form C-102  
Supersedes C-128  
Effective 1-1-65

All distances must be from the outer boundaries of the Section

Operator <b>ANADARKO PRODUCTION COMPANY</b>			Lease <b>E.W. WALDEN</b>		Well No. <b>11</b>
Unit Letter <b>M</b>	Section <b>15</b>	Township <b>22 SOUTH</b>	Range <b>37 EAST</b>	County <b>LEA</b>	
Actual Footage Location of Well: <b>990</b> feet from the <b>SOUTH</b> line and <b>660</b> feet from the <b>WEST</b> line					
Ground Level Elev. <b>3397</b>	Producing Formation <b>Grayburg-San Andres</b>		Pool <b>Undesignated</b>		Dedicated Acreage: <b>40</b> Acres

1. Outline the acreage dedicated to the subject well by colored pencil or hachure marks on the plat below.
2. If more than one lease is dedicated to the well, outline each and identify the ownership thereof (both as to working interest and royalty).
3. If more than one lease of different ownership is dedicated to the well, have the interests of all owners been consolidated by communitization, unitization, force-pooling, etc?

☐ Yes ☐ No If answer is "yes," type of consolidation \_\_\_\_\_

If answer is "no," list the owners and tract descriptions which have actually been consolidated. (Use reverse side of this form if necessary.) \_\_\_\_\_

No allowable will be assigned to the well until all interests have been consolidated (by communitization, unitization, forced-pooling, or otherwise) or until a non-standard unit, eliminating such interests, has been approved by the Commission.

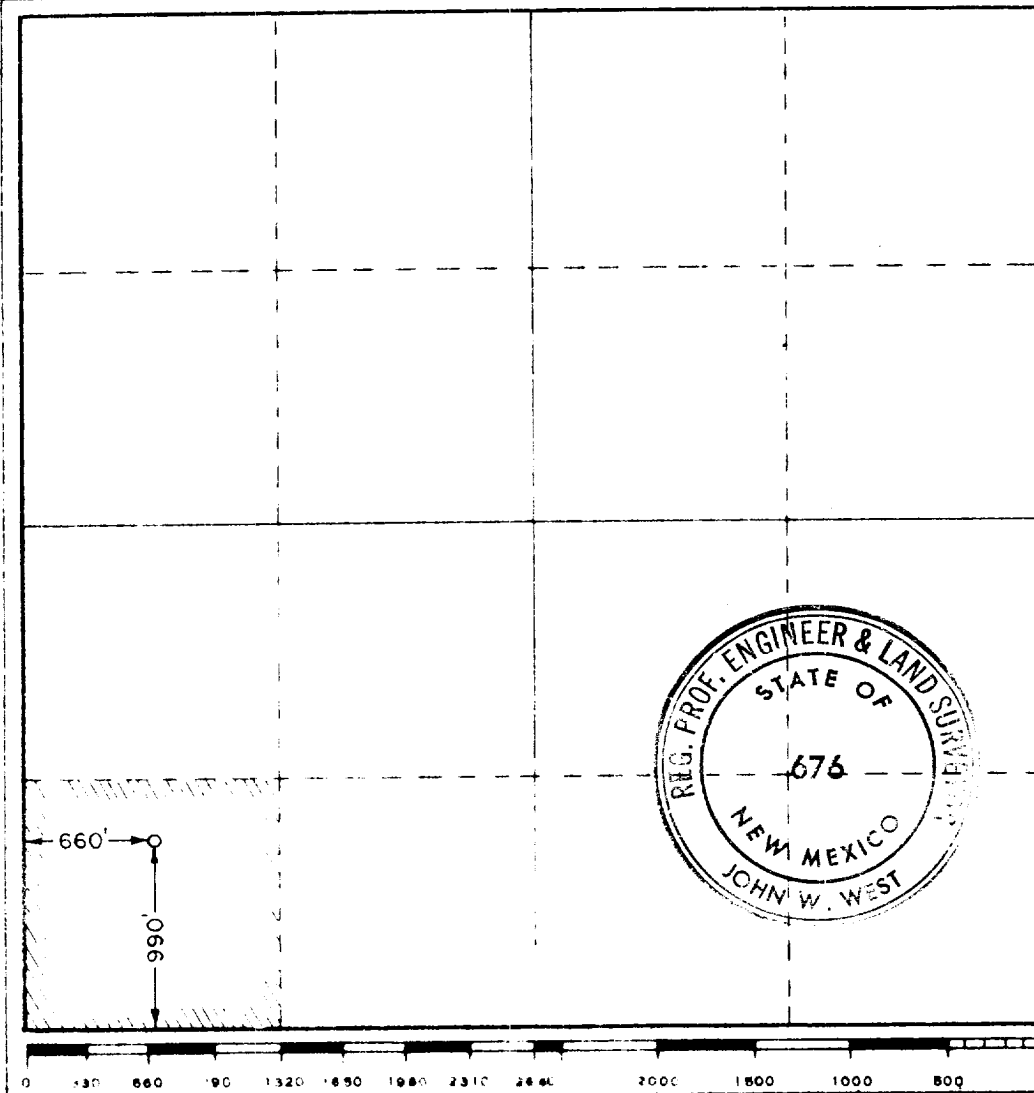

**CERTIFICATION**

I hereby certify that the information contained herein is true and complete to the best of my knowledge and belief.

Name *M. J. Nelson*  
Position  
**Area Supervisor**  
Company  
**Anadarko Production Co.**  
Date \_\_\_\_\_

I hereby certify that the well location shown on this plat was plotted from field notes of actual surveys made by me or under my supervision, and that the same is true and correct to the best of my knowledge and belief.

Date Surveyed  
**November 28, 1973**  
Registered Professional Engineer  
and/or Land Surveyor

*John W. West*  
Certificate No. **676**

990' FSL, 660' FWE CL

8 5/8" at 351' w/150 SX  
5 1/2" at 4600' w/315 SX

[illegible]

IP (Grayburg) Perfs 3735-5885' P 160 BOPD + 275 BW. Pot based  
on 24 hr test. GOR 2187; Grav 32.8

CONTR W.E.K. OPRS ELEV 3408' GL PD 4600' TYPE RE

12-10-73

F.R. 12-3-73  
(San Andres)  
TD 4600'; Prop Test  
Perf 4307-4528' (overall)  
Acid (4307-4528') 3000 gals  
Swbd 100% sulf wtr  
Sqzd 4307-4528' w/400 sx  
Perf 4207-4226' (overall)  
Swbd 100% sulf wtr  
Sqzd 4207-4226' w/275 sx  
Perf 4070-4128' (overall)  
Swbd 100% sulf wtr  
Sqzd 4070-4128' w/110 sx

LEA  
ANADARKO PROD. CO.

Ennis, S.  
11. Walden, H. W.  
Sec 15, T11S, R10E

NM  
Page #2

12-29-73

TD 4600'; FB 3900'; T-12  
Perf 3735-3885' w/14 slots (overall)  
Area (3735-3885') 60,000 gals + 62,000# sd

2-11-74

TD 4600'; FB 3900'; COMPLETE

2-16-74

LOG TOPS: Yates 2565', Santa Rivers 2782',  
Ozona 3336', Grayburg 3630', San Andres 3905'  
COMPLETION REPORTED