

COUNTY	LEA	FIELD	Jalmat	STATE	NM
OPR	ARCO OIL & GAS CO.			API	30-025-24652
NO	24	LEASE	McDonald "WN" State	MAP	
	Sec 25, T22S, R36E			CO-ORD	
	1780 FNL, 660 FWL of Sec			1-5-38 NM	
	6 mi SW/Eunice			Re PD 8-10-81 Re MP 8-18-81	
CSC	7 5/8-428-275 sx 4 1/2-3385-300 sx 2 3/8-3225			WELL CLASS: INIT DX FIN DG LSE CODE	
	FORMATION		DATUM	FORMATION DATUM	
	ID 3385 (YTES)		PBD	3353	

IP (Yates) Perfs 3055-3282 P 124 MCFGPD + 12 BW. Pot based
on 24 hr test. GOR Dry; gty (Gas) NR

CONTR	OPRS LUV	3459 GL	sub-s
-------	----------	---------	-------

F.R.C. 1-30-82 OWWO
PD 3353 WO (Yates)
(Orig. Atlantic Richfield Co., #24 McDonald
State "WN", cmp 5-11-74 thru (Yates) Perfs
3125-3282, OTD 3385, OPB 3353)
1-25-82 TD 3385; PBD 3353; Complete
Perf (Yates) 3055-89 (overall)
Acid (3055-89) 1000 gals
Frac (3055-89) 20,000 gals CO₂ + 48,000# sd
1-30-82 COMPLETION ISSUED
1-5-38 NM
IC 30-025-70063-82

IP (Yates) Perfs 3125-3282' CAOF 3089 MCFGPD. GOR
(dry); Grav (gas) .658; SIWHP 548#; SIBHP 561#

F.R. 2-4-74
(Yates)
4-29-74 Drlg 2871'
5-7-74 TD 3385'; WOC
5-13-74 TD 3385'; Prep Perf
5-20-74 TD 3385'; PBD 3353'; Tstg
Perf 3125-3282' w/22 shots
Acid (3125-3282') 4000 gals (7½% HCL)
Flwd 1064 MCFGPD, 20/64" chk, FTP 210#,
(3125-3282')
5-29-74 TD 3385'; PBD 3353'; WO CAOF (Final)
7-8-74 TD 3385'; PBD 3353'; WO Pipeline Conn
CAOF 3089 MCFGPD

LEA

ATLANTIC RICHFIELD CO.

Jalmat

#24 McDonald "WN"
Sec 25, T22S, R36E

NM

Page #2

74

TD 3385'; PBD 3353'; COMPLETE

(Yates) FOUR POINT GAUGES:

Flwd 713 MCFGPD, 2.25" Orifice, 1 hr, TP 489#

Flwd 1070 MCFGPD, 2.25" Orifice, 1 hr, TP 431#

Flwd 1368 MCFGPD, 2.25" Orifice, 1 hr, TP 383#

Flwd 1704 MCFGPD, 2.25" Orifice, 1 hr, TP 325#

LOG TOPS: Base Salt 3020', Yates 3240'

7-20-74

COMPLETION REPORTED

OIL CONSERVATION DIVISION

STATE OF NEW MEXICO
ENERGY AND MINERALS DEPARTMENTP. O. BOX 2088
SANTA FE, NEW MEXICO 87501Form C-102
Revised 10-1-78

All distances must be from the outer boundaries of the Section.

Operator ARCO Oil and Gas Company Division of Atlantic Richfield Company			Lease McDonald WN State		Well No. 24
Unit Letter E	Section 25	Township 22S	Range 36E	County Lea	
Actual Footage Location of Well: 1780 feet from the North line and 660 feet from the West line					
Ground Level Elev. 3458'	Producing Formation Yates 7 Rivers		Pool Jalmat Yates Gas		Dedicated Acreage: 160 Acres

1. Outline the acreage dedicated to the subject well by colored pencil or hatchure marks on the plat below.
2. If more than one lease is dedicated to the well, outline each and identify the ownership thereof (both as to working interest and royalty).
3. If more than one lease of different ownership is dedicated to the well, have the interests of all owners been consolidated by communitization, unitization, force-pooling, etc?

☐ Yes ☐ No If answer is "yes," type of consolidation _____

If answer is "no," list the owners and tract descriptions which have actually been consolidated. (Use reverse side of this form if necessary.) _____

No allowable will be assigned to the well until all interests have been consolidated (by communitization, unitization, forced-pooling, or otherwise) or until a non-standard unit, eliminating such interests, has been approved by the Division.

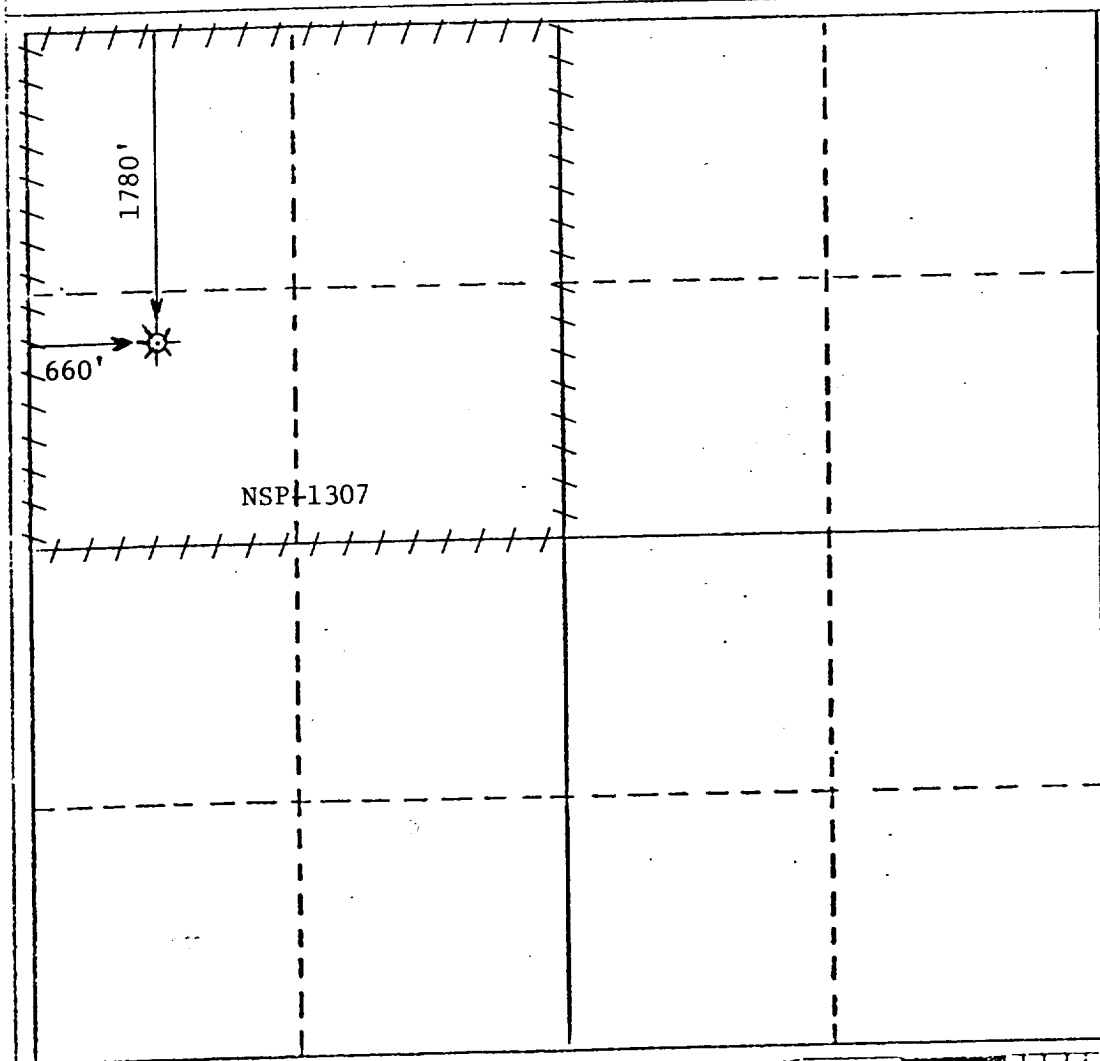

CERTIFICATION

I hereby certify that the information contained herein is true and complete to the best of my knowledge and belief.

Name R. L. Shackelford
Position
Engrg. Tech. Spec
Company ARCO Oil & Gas Company
Div of Atlantic Richfield Co.
Date
10/29/82

I hereby certify that the well location shown on this plat was plotted from field notes of actual surveys made by me or under my supervision, and that the same is true and correct to the best of my knowledge and belief.

Date Surveyed

Registered Professional Engineer
and/or Land Surveyor

Certificate No.

0 330 660 990 1320 1650 1980 2310 2640 2970 3300 3630 3960 4290 4620 4950 5280 5610 5940 6270 6600

RECEIVED

NOV 1 1982

C.C.D.
HOBBS OFFICE

**NEW MEXICO OIL CONSERVATION COMMISSION
WELL LOCATION AND ACREAGE DEDICATION PLAT**

Form C-102
Supersedes C-128
Effective 1-1-65

All distances must be from the outer boundaries of the Section.

Operator Atlantic Richfield Company			Lease McDonald State WN		Well No. 24
Unit Letter E	Section 25	Township 22S	Range 36E	County Lea	
Actual Postage Location of Well: 1780 feet from the North line and 660 feet from the West line					
Ground Level Elev. 3458'	Producing Formation Yates		Pool Jalmat Gas		Dedicated Acreage: 640 Acres

1. Outline the acreage dedicated to the subject well by colored pencil or hachure marks on the plat below.
2. If more than one lease is dedicated to the well, outline each and identify the ownership thereof (both as to working interest and royalty).
3. If more than one lease of different ownership is dedicated to the well, have the interests of all owners been consolidated by communitization, unitization, force-pooling, etc?

☐ Yes ☐ No If answer is "yes," type of consolidation _____

If answer is "no," list the owners and tract descriptions which have actually been consolidated. (Use reverse side of this form if necessary.) _____

No allowable will be assigned to the well until all interests have been consolidated (by communitization, unitization, forced-pooling, or otherwise) or until a non-standard unit, eliminating such interests, has been approved by the Commission.

R 36 E

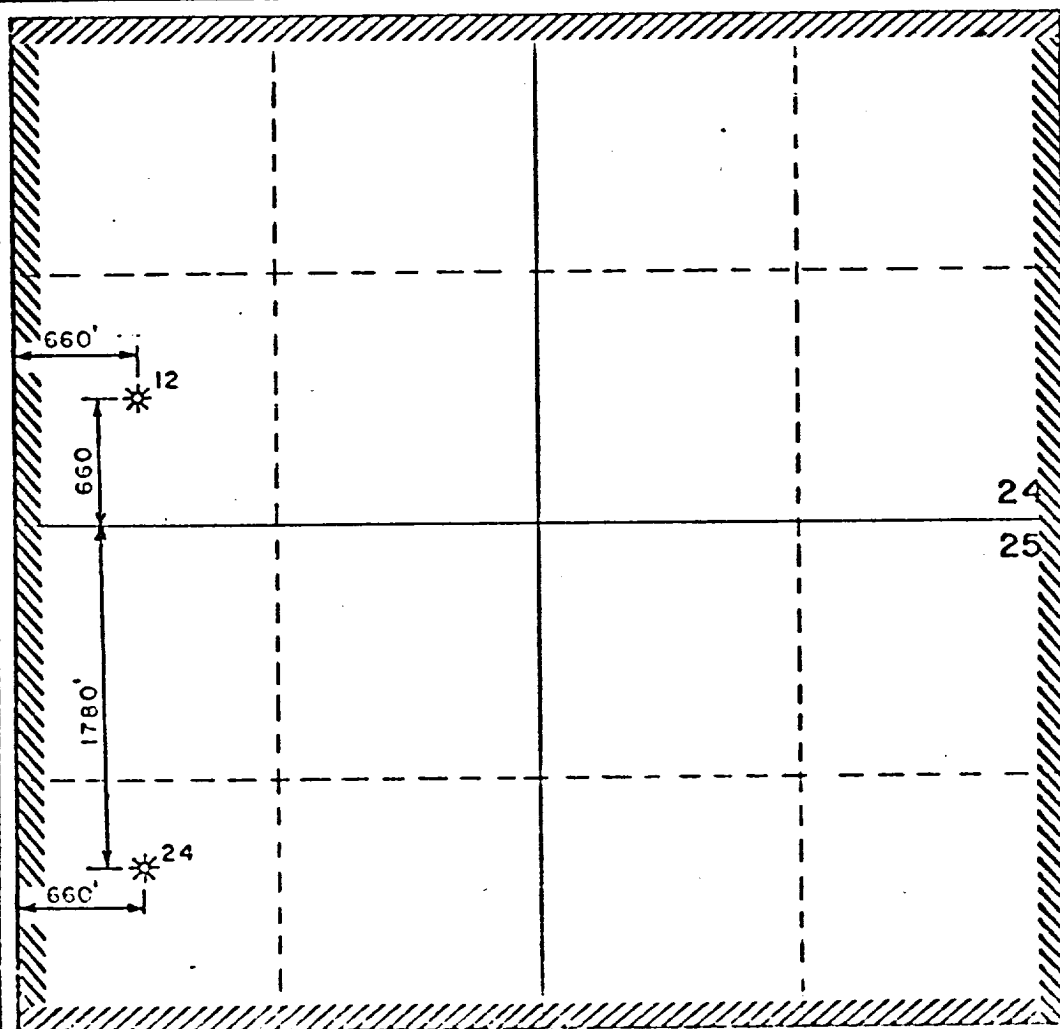

CERTIFICATION

I hereby certify that the information contained herein is true and complete to the best of my knowledge and belief.

L. C. Soileau IV
L. C. Soileau IV

Position
Operations Engineer

Company
Atlantic Richfield Co.

Date
January 16, 1975

I hereby certify that the well location shown on this plat was plotted from field notes of actual surveys made by me or under my supervision, and that the same is true and correct to the best of my knowledge and belief.

Date Surveyed _____

Registered Professional Engineer and/or Land Surveyor

Certificate No. _____

0 330 660 990 1320 1650 1980 2310 2640 2970 3300 3630 3960 4290 4620 4950 5280 5610 5940 6270 6600

RECEIVED

MAY 1 1975

U.S. CONSERVATION COMM.
HOES, R. M.

**NEW MEXICO OIL CONSERVATION COMMISSION
WELL LOCATION AND ACREAGE DEDICATION PLAT**

Form C-102
Supersedes C-128
Effective 1-1-65

All distances must be from the outer boundaries of the Section.

Operator Atlantic Richfield Company			Lease McDonald WN State		Well No. 24
Unit Letter E	Section 25	Township 22S	Range 36E	County Lea	
Actual Footage Location of Well:					
1780		feet from the North	line and	660	feet from the West line
Ground Level Elev. 3472'	Producing Formation Yates Gas		Pool Jalmat		Dedicated Acreage: 320 Acres

1. Outline the acreage dedicated to the subject well by colored pencil or hachure marks on the plat below.
2. If more than one lease is dedicated to the well, outline each and identify the ownership thereof (both as to working interest and royalty).
3. If more than one lease of different ownership is dedicated to the well, have the interests of all owners been consolidated by communitization, unitization, force-pooling, etc?

☐ Yes ☐ No If answer is "yes," type of consolidation _____

If answer is "no," list the owners and tract descriptions which have actually been consolidated. (Use reverse side of this form if necessary.) _____

No allowable will be assigned to the well until all interests have been consolidated (by communitization, unitization, forced-pooling, or otherwise) or until a non-standard unit, eliminating such interests, has been approved by the Commission.

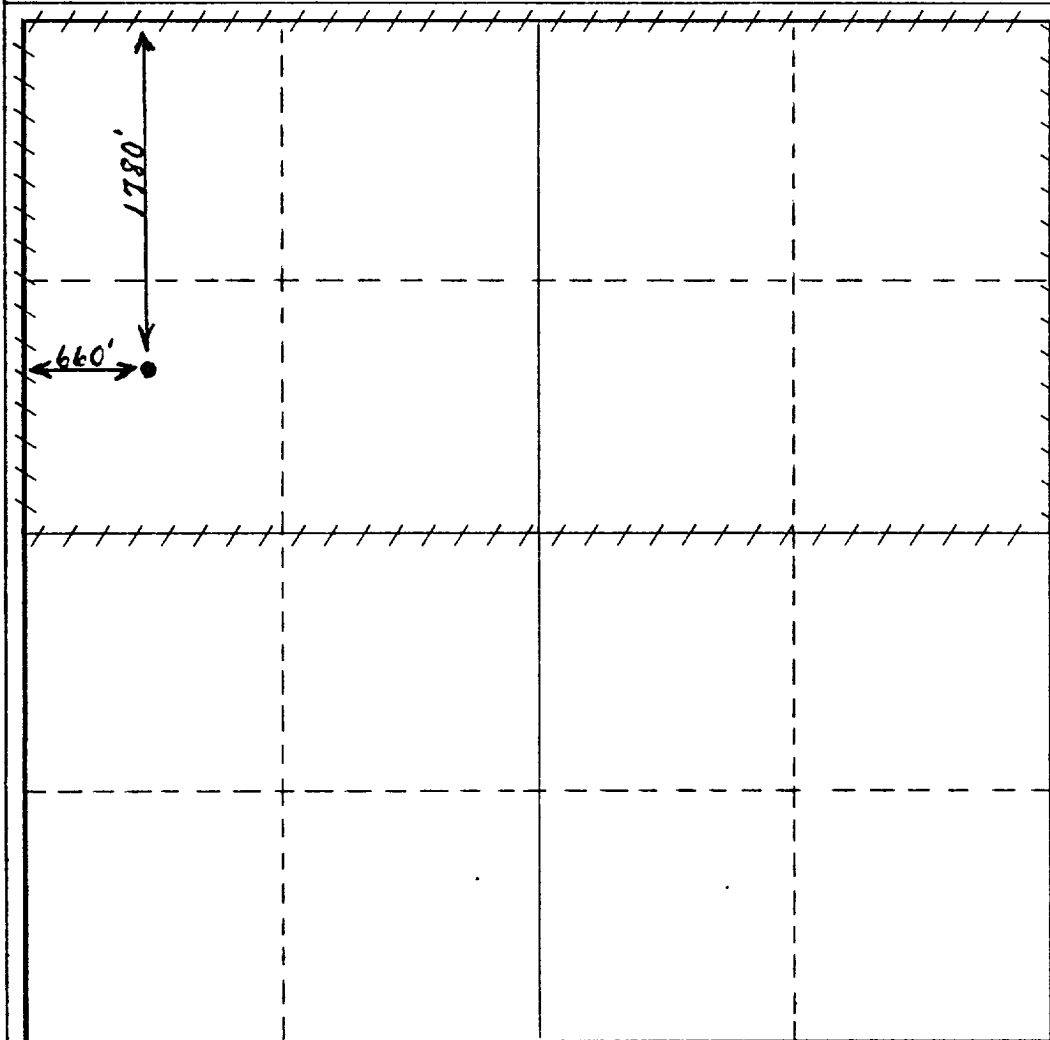

CERTIFICATION

I hereby certify that the information contained herein is true and complete to the best of my knowledge and belief.

Name _____
Position _____
Dist. Drlg. Supv.

Company
Atlantic Richfield Company

Date
June 3, 1974

I hereby certify that the well location shown on this plat was plotted from field notes of actual surveys made by me or under my supervision, and that the same is true and correct to the best of my knowledge and belief.

Date Surveyed _____

Registered Professional Engineer
and/or Land Surveyor

Certificate No. _____

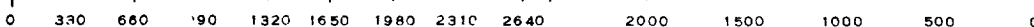

**NEW MEXICO OIL CONSERVATION COMMISSION
WELL LOCATION AND ACREAGE DEDICATION PLAT**

Form C-102
Supersedes C-128
Effective 1-1-65

All distances must be from the outer boundaries of the Section.

Operator Atlantic Richfield Company			Lease McDonald WN State		Well No. 24
Unit Letter E	Section 25	Township 22S	Range 36E	County Lea	
Actual Footage Location of Well: <div style="display: flex; justify-content: space-between; align-items: center;"> 1780 feet from the North line and 660 feet from the West line </div>					
Ground Level Elev. 3472'	Producing Formation Yates Gas		Pool Jalmat		Dedicated Acreage: 160 Acres

1. Outline the acreage dedicated to the subject well by colored pencil or hachure marks on the plat below.
2. If more than one lease is dedicated to the well, outline each and identify the ownership thereof (both as to working interest and royalty).
3. If more than one lease of different ownership is dedicated to the well, have the interests of all owners been consolidated by communitization, unitization, force-pooling, etc?

☐ Yes ☐ No If answer is "yes," type of consolidation _____

If answer is "no," list the owners and tract descriptions which have actually been consolidated. (Use reverse side of this form if necessary.) _____

No allowable will be assigned to the well until all interests have been consolidated (by communitization, unitization, forced-pooling, or otherwise) or until a non-standard unit, eliminating such interests, has been approved by the Commission.

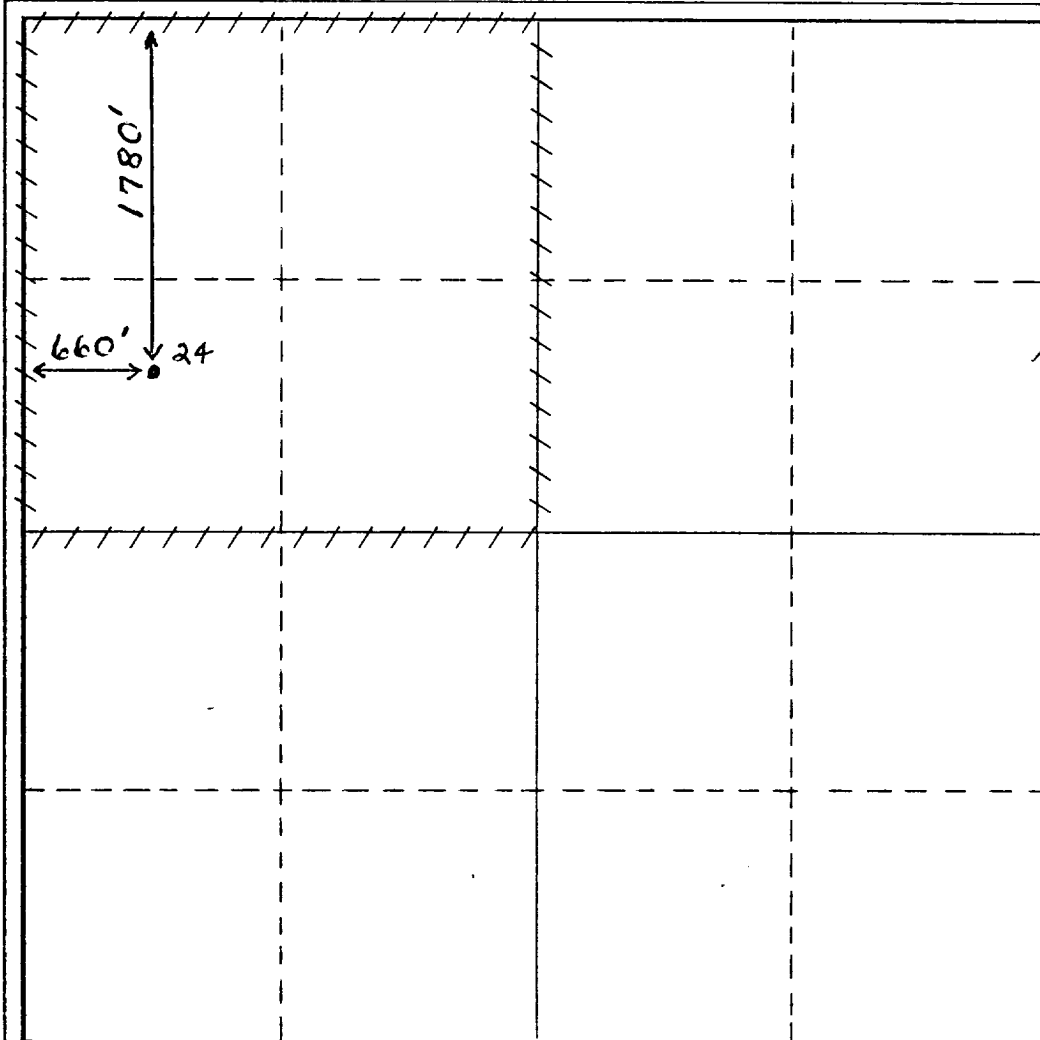

CERTIFICATION

I hereby certify that the information contained herein is true and complete to the best of my knowledge and belief.

Name *H. J. Bernard*
 Position
Dist. Drlg. Supv.

Company
Atlantic Richfield Company

Date
May 21, 1974

I hereby certify that the well location shown on this plat was plotted from field notes of actual surveys made by me or under my supervision, and that the same is true and correct to the best of my knowledge and belief.

Date Surveyed _____

Registered Professional Engineer
and/or Land Surveyor

Certificate No. _____

0 330 660 990 1320 1650 1980 2310 2640 2000 1500 1000 500 0

RECEIVED

MAY 22 1974

U.S. CONSTITUTION COMM.
WASH. D. C.