

NO. OF COPIES RECEIVED	
DISTRIBUTION	
SANTA FE	
FILE	
U.S.G.S.	
LAND OFFICE	
OPERATOR	

NEW MEXICO OIL CONSERVATION COMMISSION

Form C-101
Revised 1-1-65

5A. Indicate Type of Lease	
STATE <input type="checkbox"/>	FEE <input checked="" type="checkbox"/>
5. State Oil & Gas Lease No.	

APPLICATION FOR PERMIT TO DRILL, DEEPEN, OR PLUG BACK

1a. Type of Work		7. Unit Agreement Name	
b. Type of Well OIL WELL <input checked="" type="checkbox"/> GAS WELL <input type="checkbox"/> OTHER <input type="checkbox"/>		8. Farm or Lease Name Mark	
2. Name of Operator Gulf Oil Corporation		9. Well No. 10	
3. Address of Operator Box 670, Hobbs, New Mexico 88240		10. Field and Pool, or Wildcat Penrose Skelly	
4. Location of Well UNIT LETTER <u>II</u> LOCATED <u>1961</u> FEET FROM THE <u>North</u> LINE AND <u>423</u> FEET FROM THE <u>East</u> LINE OF SEC. <u>3</u> TWP. <u>22-S</u> RGE. <u>37-E</u> NMPM		12. County Lea	
19. Proposed Depth 3950'		19A. Formation Grayburg	
20. Rotary or C.T. Rotary		21. Elevations (Show whether DF, RT, etc.)	
21A. Kind & Status Plug. Bond Blanket		21B. Drilling Contractor	
22. Approx. Date Work will start April 1, 1974			

23.

PROPOSED CASING AND CEMENT PROGRAM

SIZE OF HOLE	SIZE OF CASING	WEIGHT PER FOOT	SETTING DEPTH	SACKS OF CEMENT	EST. TOP
11"	8-5/8"	24#	300'	Circulate	
7-7/8"	5-1/2"	14#	3950'	300 sacks (Base of Salt)	

APPROVAL VALID
FOR 90 DAYS UNLESS
DRILLING COMMENCED,

EXPIRES June 18, 1974

IN ABOVE SPACE DESCRIBE PROPOSED PROGRAM; IF PROPOSAL IS TO DEEPEN OR PLUG BACK, GIVE DATA ON PRESENT PRODUCTIVE ZONE AND PROPOSED NEW PRODUCTIVE ZONE. GIVE BLOWOUT PREVENTER PROGRAM, IF ANY.

I hereby certify that the information above is true and complete to the best of my knowledge and belief.

Signed W. B. Bland Title Area Production Manager Date March 18, 1974

(This space for State Use)

APPROVED BY John W. Runyan TITLE _____ DATE _____

CONDITIONS OF APPROVAL, IF ANY:

NEW MEXICO OIL CONSERVATION COMMISSION
WELL LOCATION AND ACREAGE DEDICATION PLAT

Form O-112
Supersedes O-128
Effective 1-1-67

All distances must be from the outer boundaries of the Section

GULF OIL CORPORATION			MARK		10
H	3	22 SOUTH	37 EAST	LEA	
Actual Well Location of Well:					
1961	feet from the	NORTH	line and	423	feet from the
Ground Level Elev	Producing Formation		Pool	Dedicated Acreage	
	Grayburg		Penrose Skelly	40	

1. Outline the acreage dedicated to the subject well by colored pencil or hatchure marks on the plat below.
2. If more than one lease is dedicated to the well; outline each and identify the ownership thereof (both as to working interest and royalty).
3. If more than one lease of different ownership is dedicated to the well, have the interests of all owners been consolidated by communitization, unitization, force-pooling, etc?

☐ Yes ☐ No If answer is "yes" type of consolidation _____

If answer is "no" list the owners and tract descriptions which have actually been consolidated. (Use reverse side of this form if necessary.) _____

No allowable will be assigned to the well until all interests have been consolidated (by communitization, unitization, forced-pooling, or otherwise) or until a non-standard unit, eliminating such interests, has been approved by the Commission.

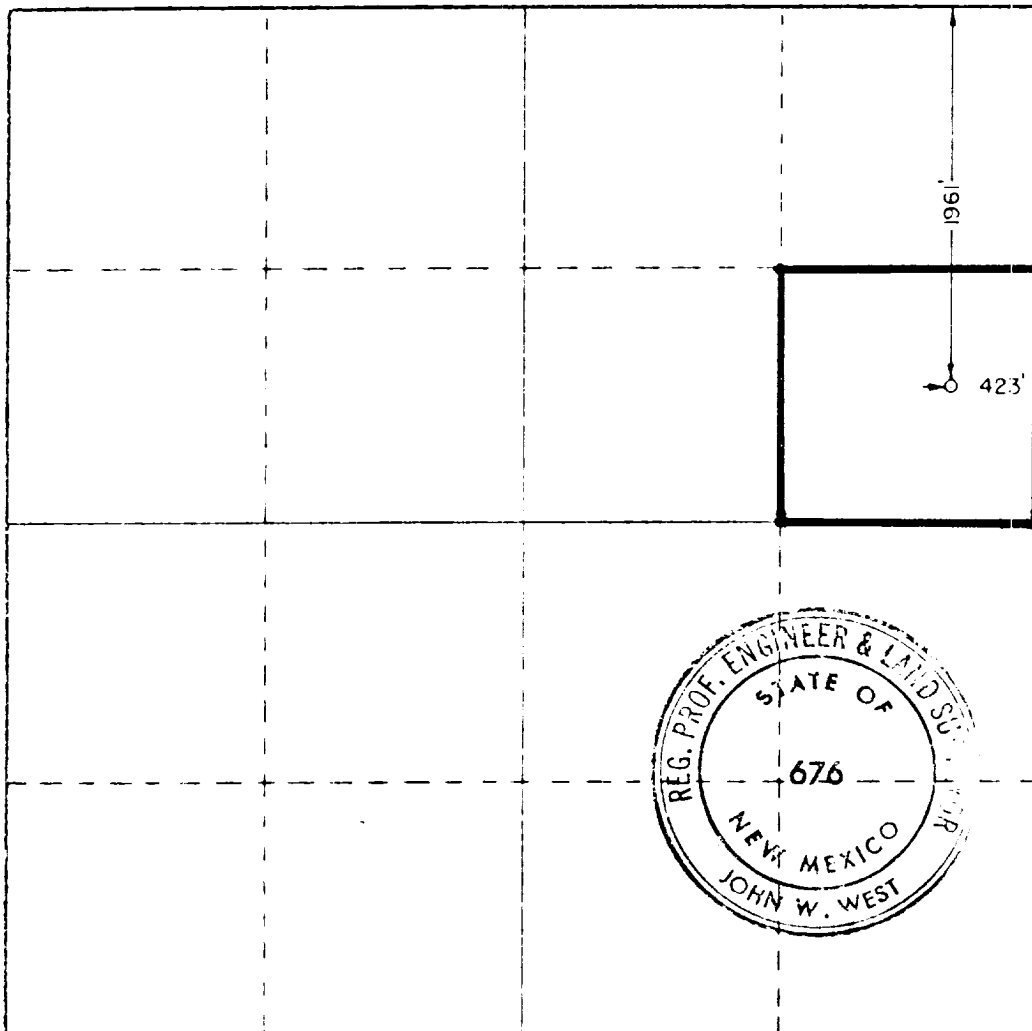

CERTIFICATION

I hereby certify that the information contained herein is true and complete to the best of my knowledge and belief.

C. D. Borland

Name

C. D. BORLAND

Position

Area Production Manager

Company

Gulf Oil Corporation

Date

March 18, 1974

I hereby certify that the well location shown on this plat was plotted from field notes of actual surveys made by me or under my supervision, and that the same is true and correct to the best of my knowledge and belief.

Date Surveyed

MARCH 15, 1974

Registered Professional Engineer and or Land Surveyor

John W. West
Certificate No. 676

0 330 660 990 1320 1650 1980 2310 2640 2970 3300 3630 3960 4290 4620 4950 5280 5610 5940 6270 6600