

UNITED STATES  
DEPARTMENT OF THE INTERIOR  
GEOLOGICAL SURVEY

APPLICATION FOR PERMIT TO DRILL, DEEPEN, OR PLUG BACK

1a. TYPE OF WORK  
 DRILL  DEEPEN  PLUG BACK

b. TYPE OF WELL  
 OIL WELL  GAS WELL  OTHER   
 SINGLE ZONE  MULTIPLE ZONE

2. NAME OF OPERATOR  
 CONTINENTAL OIL COMPANY

3. ADDRESS OF OPERATOR  
 P. O. Box 460, Hobbs, N.M. 88240

4. LOCATION OF WELL (Report location clearly and in accordance with any State requirements.\*)  
 At surface  
 1,930' FSL & 660' FWL of Sec. 6  
 At proposed prod. zone  
 Same

14. DISTANCE IN MILES AND DIRECTION FROM NEAREST TOWN OR POST OFFICE\*

15. DISTANCE FROM PROPOSED\* LOCATION TO NEAREST PROPERTY OR LEASE LINE, FT. (Also to nearest drlg. line, if any)

16. NO. OF ACRES IN LEASE  
 1993.4

17. NO. OF ACRES ASSIGNED TO THIS WELL

18. DISTANCE FROM PROPOSED LOCATION\* TO NEAREST WELL, DRILLING, COMPLETED, OR APPLIED FOR, ON THIS LEASE, FT.

19. PROPOSED DEPTH  
 5,300'

20. ROTARY OR CABLE TOOLS  
 Rotary

21. ELEVATIONS (Show whether DF, RT, GR, etc.)  
 3,495.7 GR

22. APPROX. DATE WORK WILL START\*  
 4-8-74

23. PROPOSED CASING AND CEMENTING PROGRAM

SIZE OF HOLE	SIZE OF CASING	WEIGHT PER FOOT	SETTING DEPTH	QUANTITY OF CEMENT
20"	16"	65# H-40	600'	Cement - 550 sacks
14 3/4"	11 3/4"	47# J-55	2,000' 2	Subsided Slurry - 500 sacks - to base of well section.
12 1/4"	9 3/4"	36# J-55	1,950'	
8 3/4"	5 1/2" (400' MIN)	15.5# J-55	5,300'	1000 Sacks

It is proposed to drill a straight hole to a TD of 5,300' and test for oil or gas in Yates and Wolf sections. Mud program; 0'-660' 8.5"-9.0" Spud Mud; 660'-5,300' 9.0"-10.0" Salt Sol. See attached for Blowout Preventer Program.

IN ABOVE SPACE DESCRIBE PROPOSED PROGRAM: If proposal is to deepen or plug back, give data on present productive zone and proposed new productive zone. If proposal is to drill or deepen directionally, give pertinent data on subsurface locations and measured and true vertical depths. Give blowout preventer program, if any.

24. SIGNED Robert Gault III TITLE Division Office Manager DATE 4-5-74

(This space for Federal or State office use)

PERMIT NO. \_\_\_\_\_ APPROVAL DATE \_\_\_\_\_

APPROVED BY \_\_\_\_\_ TITLE \_\_\_\_\_ DATE \_\_\_\_\_

CONDITIONS OF APPROVAL, IF ANY:

USGS/G, Partners-16, File \*See Instructions On Reverse Side

5. LEASE DESIGNATION AND SERIAL NO.  
 LC-029864 (6)  
 6. IF INDIAN, ALLOTTEE OR TRIBE NAME  
 7. UNIT AGREEMENT NAME  
 8. FARM OR LEASE NAME  
 9. WELL NO.  
 10. FIELD AND POOL, OR WILDCAT  
 11. SEC., T., R., M., OR BLK. AND SURVEY OR AREA  
 12. COUNTY OR PARISH  
 13. STATE

MEXICO OIL CONSERVATION COMMISSION  
WELL LOCATION AND ACREAGE DEDICATION PLAT

Form O-17  
Supersedes O-17  
Effective 10-1-73

All distances must be from the outer boundaries of the Section

CONTINENTAL OIL COMPANY			Lease DANCIGER B		Well No. 2
Section L	Range 6	Meridian 23 SOUTH	Range 36 EAST	County LEA	
Acres of Section 1 Area 1980		feet from the SOUTH	Line and 660	feet from the WEST	Line
Ground Level Survey 3495.7	Formal Survey Location <i>Capitan Reef</i>		Well <i>Wildcat</i>	Dedicated Acreage <i>AD</i>	

- Outline the acreage dedicated to the subject well by colored pencil or hatchure marks on the plat below.
- If more than one lease is dedicated to the well, outline each and identify the ownership thereof (both as to working interest and royalty).
- If more than one lease of different ownership is dedicated to the well, have the interests of all owners been consolidated by communitization, unitization, force-pooling, etc?

Yes  No If answer is "yes," type of consolidation \_\_\_\_\_

If answer is "no," list the owners and tract descriptions which have actually been consolidated. (Use reverse side of this form if necessary.) \_\_\_\_\_

No allowable will be assigned to the well until all interests have been consolidated (by communitization, unitization, forced-pooling, or otherwise) or until a non-standard unit, eliminating such interests, has been approved by the Commission.

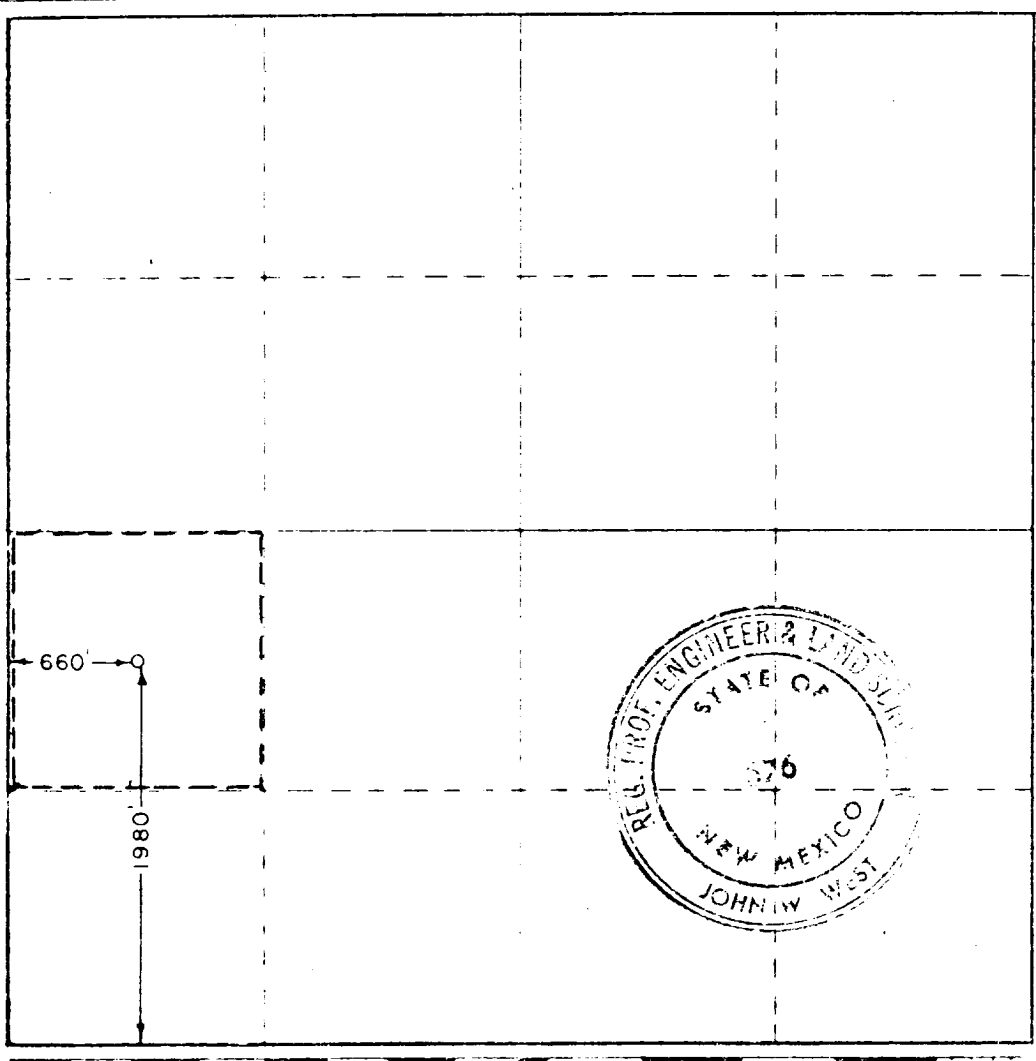

CERTIFICATION

I hereby certify that the information contained herein is true and complete to the best of my knowledge and belief.

*Robert Gault*  
Division Office Manager

*Continental Oil Company*

*April 5, 1974*

I hereby certify that the well location shown on this plat was plotted from field notes of actual surveys made by me or under my supervision, and that the same is true and correct to the best of my knowledge and belief.

Date Surveyed

FEBRUARY 8, 1974

Registered Professional Engineer and Land Surveyor

*John W. West*

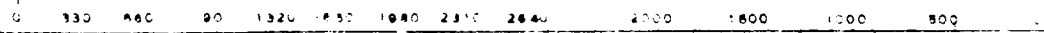

CONTINENTAL OIL COMPANY  
Blow-out Preventer Specifica ns

*Design 6 No. 2*

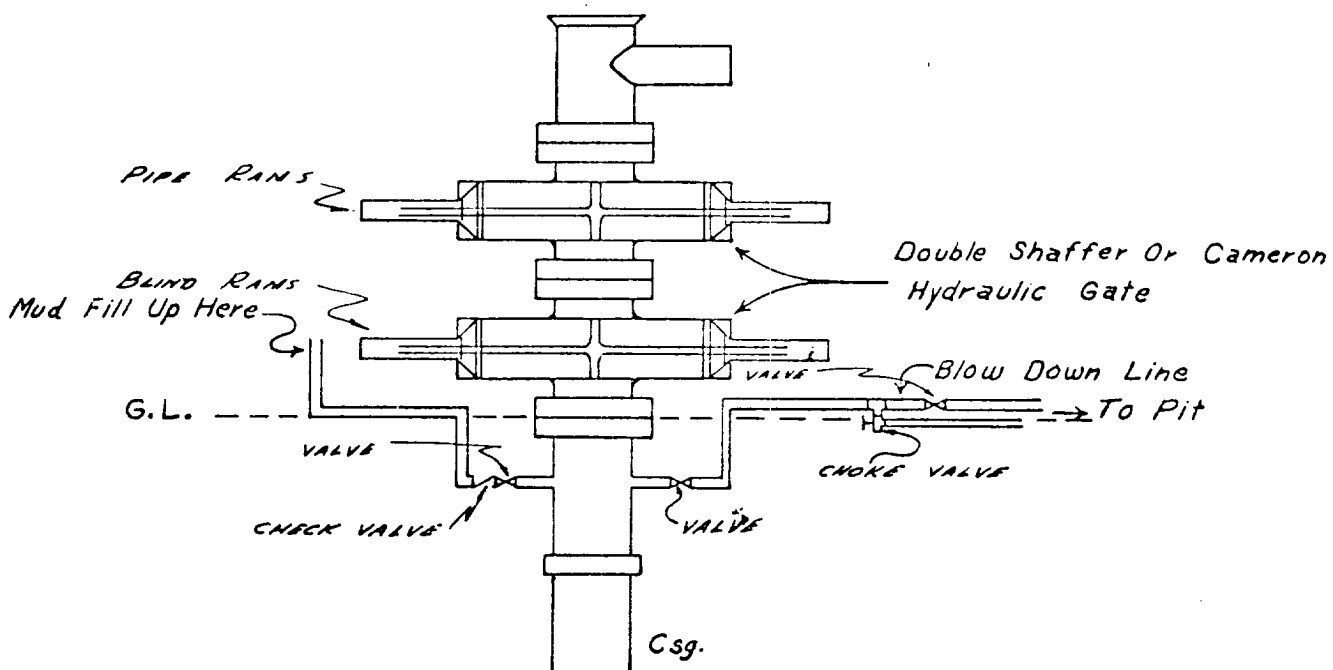

NOTE:

Manual and hydraulic controls with closing unit no less than 75' from well head.

Development Plan For Surface Use

*Denoiger B No. 2*

1. Existing roads including location of the exit from the main highway  
See Attached Map
2. Planned access roads  
See Below and Attached Map
  - (a) Length and width of new road *12' X 550'*
  - (b) Roads will be compacted ~~or surfaced~~
3. Location of existing wells  
See Attached Map
4. Lateral roads to well location  
See Attached Map
5. Location of tank batteries and flowlines - *To be located on drilling pad.*  
See Attached Map
6. Location and type of water supply
  - ( ) Water will be hauled to location
  - (X) See attached map for location of proposed water lines
7. Methods for handling waste disposal  

All litter and scrap material will be disposed of by burying in a trash pit with a minimum cover of 24 inches of dirt.
8. and 9. Location of camps and airstrips  

There are no camps or airstrips contemplated to serve this lease.
10. Location of layout to include position of the rig, mud tanks, reserve pits, burn pits, pipe racks, etc.  
See Below and Attached plan
  - (a) Size of drilling pad
  - (b) Drilling pad compacted ~~or surfaced~~
11. Plans for restoration of the surface  

Surface will be levelled and properly conditioned.
12. Other information that may be used in evaluating the impact on environment  

The terrain in this area is generally flat with very little vegetation. No streams or other major water sheds are located in this area.

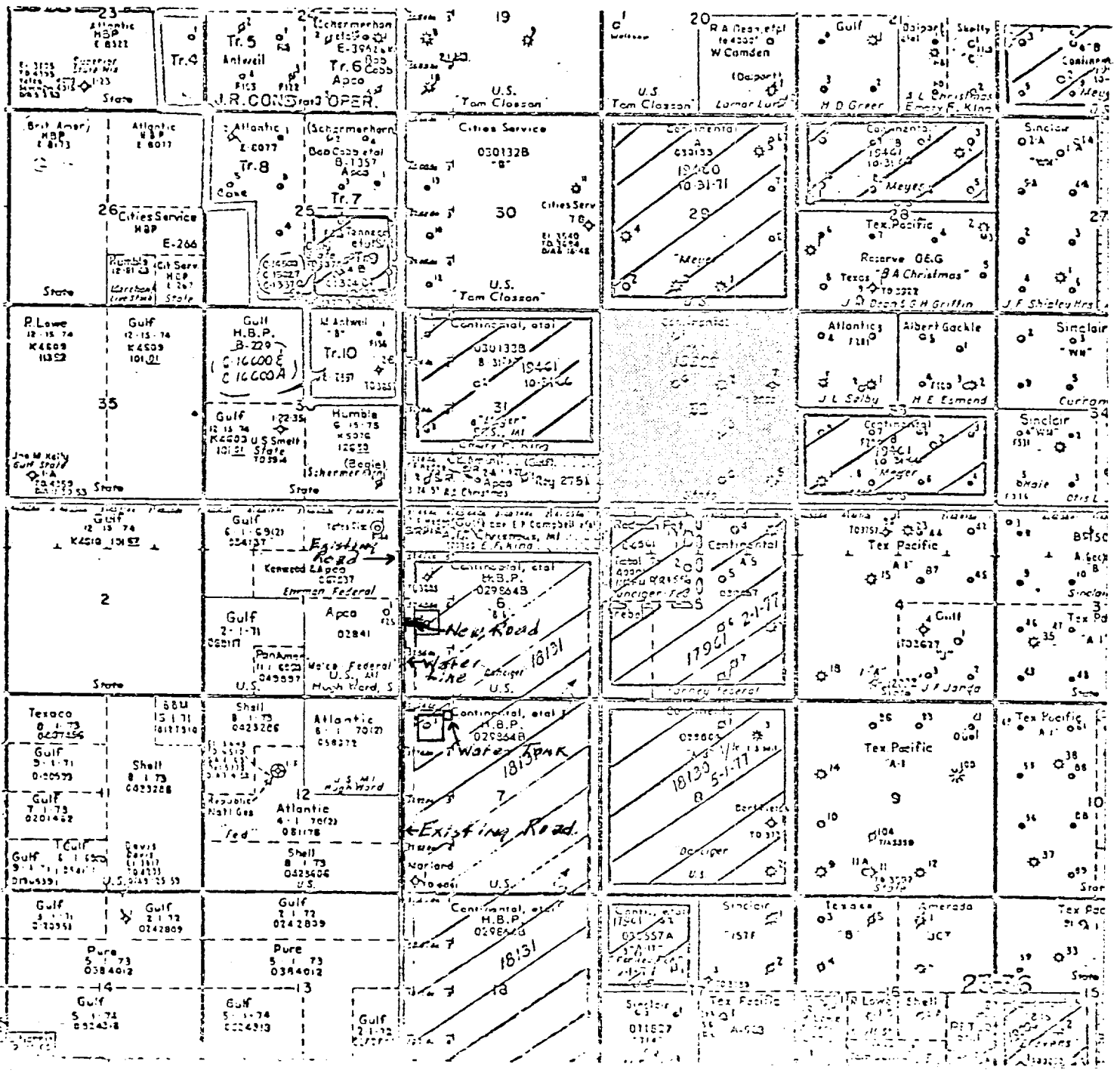

Danciger B No. 2

CONTINENTAL OIL COMPANY  
 PRODUCTION DEPARTMENT  
 HOBBS DIVISION

DANCIGER LEASE AREA

SCALE: 1"=4000'

Managers B No. 2

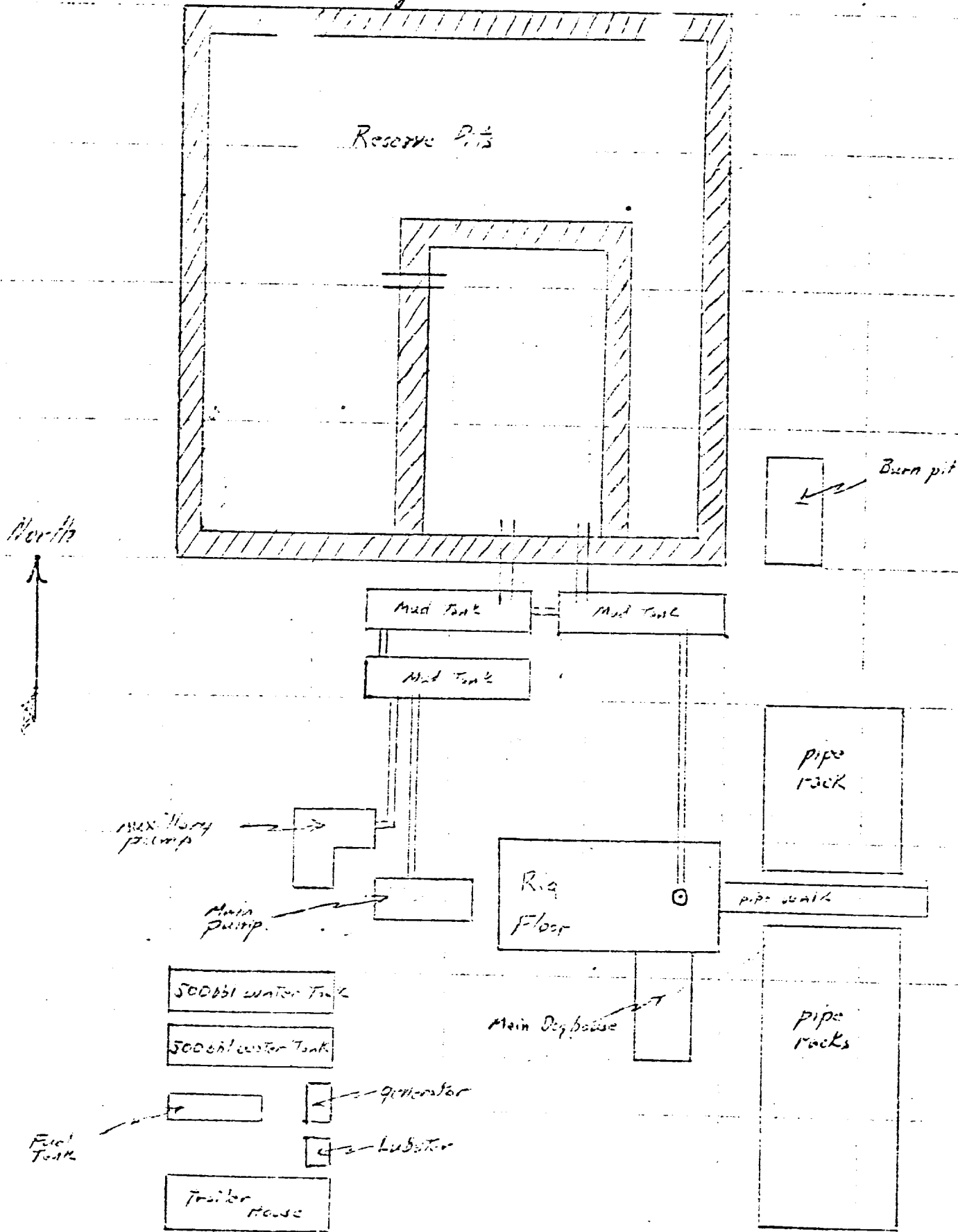

Robinson Bros. Drilling Co.  
 Rig No. 3  
 Scale 1" = 25 feet.