

NO. OF COPIES RECEIVED	
DISTRIBUTION	
SANTA FE	
FILE	
U.S.G.S.	
LAND OFFICE	
OPERATOR	

NEW MEXICO OIL CONSERVATION COMMISSION

Form C-101  
Revised 1-1-65 20-125-14771

5A. Indicate Type of Lease
STATE <input checked="" type="checkbox"/> FEE <input type="checkbox"/>
5. State Oil & Gas Lease No.
E-9458

APPLICATION FOR PERMIT TO DRILL, DEEPEN, OR PLUG BACK

1a. Type of Work		7. Unit Agreement Name	
b. Type of Well OIL WELL <input type="checkbox"/> GAS WELL <input checked="" type="checkbox"/> OTHER <input type="checkbox"/>		Bell Lake	
DRILL <input checked="" type="checkbox"/> DEEPEN <input type="checkbox"/> PLUG BACK <input type="checkbox"/>		8. Farm or Lease Name	
SINGLE ZONE <input checked="" type="checkbox"/> MULTIPLE ZONE <input type="checkbox"/>		Bell Lake Unit 3	
2. Name of Operator		9. Well No.	
Continental Oil Company		15	
3. Address of Operator		10. Field and Pool, or Wildcat	
Box 460, Hobbs, N.M. 88240		North Bell Lake - Pool	
4. Location of Well		12. County	
UNIT LETTER K LOCATED 1980 FEET FROM THE South LINE		Lea	
AND 1980 FEET FROM THE West LINE OF SEC. 8 TWP. 23-S RGE. 34-E NMPM			
19. Proposed Depth		19A. Formation	
13.700		Morrow	
20. Rotary or C.T.		Rotary	
21. Elevations (Show whether DF, RT, etc.)		22. Approx. Date Work will start	
3445' Gr.		6-20-74	
21A. Kind & Status Plug. Bond		21B. Drilling Contractor	
Blanket Bond on File			

PROPOSED CASING AND CEMENT PROGRAM

SIZE OF HOLE	SIZE OF CASING	WEIGHT PER FOOT	SETTING DEPTH	SACKS OF CEMENT	EST. TOP
20"	16" H-40	65#	500'	500	Circ.
14 3/4"	10 3/4" K-55	45.5#	4950'	2250	Circ.
9 1/2"	7 5/8" N-80	33.7#	11,900'	1250	4800'
6 1/2"	5" N-80	18#	13,700	300	11,700'

It is proposed to drill a straight hole to a TD of 13,700' and complete as a Morrow gas well.

APPROVAL VALID  
FOR 90 DAYS UNLESS  
DRILLING COMMENCED,  
EXPIRES 9-6-74

IN ABOVE SPACE DESCRIBE PROPOSED PROGRAM: IF PROPOSAL IS TO DEEPEN OR PLUG BACK, GIVE DATA ON PRESENT PRODUCTIVE ZONE AND PROPOSED NEW PRODUCTIVE ZONE. GIVE BLOWOUT PREVENTER PROGRAM, IF ANY.

I hereby certify that the information above is true and complete to the best of my knowledge and belief.

Signed [Signature] Title Sr. Analyst Date 6-5-74

(This space for State Use)

APPROVED BY [Signature] TITLE SUPERVISOR DISTRICT I DATE JUN 6 1974

CONDITIONS OF APPROVAL, IF ANY:

NMCC-1. File

NEW MEXICO OIL CONSERVATION COMMISSION  
WELL LOCATION AND ACREAGE DEDICATION PLAT

Form O-102  
Supersedes O-128  
Effective 1-1-65

All distances must be from the outer boundaries of the Section

Operator <b>CONTINENTAL OIL COMPANY</b>			Lease <b>BELL LAKE UNIT 3</b>		Well No. <b>15</b>
Tract Letter <b>K</b>	Section <b>8</b>	Township <b>23 SOUTH</b>	Range <b>34 EAST</b>	County <b>LEA</b>	
Actual Forfeiture Location of Wells: <b>1980</b> feet from the <b>SOUTH</b> line and <b>1980</b> feet from the <b>WEST</b> line					
Ground Level Elev. <b>3445</b>	Producing Formation <b>Morrow</b>		Pool <b>Undesignated</b>	Dedicated Acreage <b>320</b>	

1. Outline the acreage dedicated to the subject well by colored pencil or hatchure marks on the plat below.
2. If more than one lease is dedicated to the well, outline each and identify the ownership thereof (both as to working interest and royalty).
3. If more than one lease of different ownership is dedicated to the well, have the interests of all owners been consolidated by communitization, unitization, force-pooling, etc?

☐ Yes ☐ No If answer is "yes," type of consolidation \_\_\_\_\_

If answer is "no," list the owners and tract descriptions which have actually been consolidated. (Use reverse side of this form if necessary.) \_\_\_\_\_

No allowable will be assigned to the well until all interests have been consolidated (by communitization, unitization, forced-pooling, or otherwise) or until a non-standard unit, eliminating such interests, has been approved by the Commission.

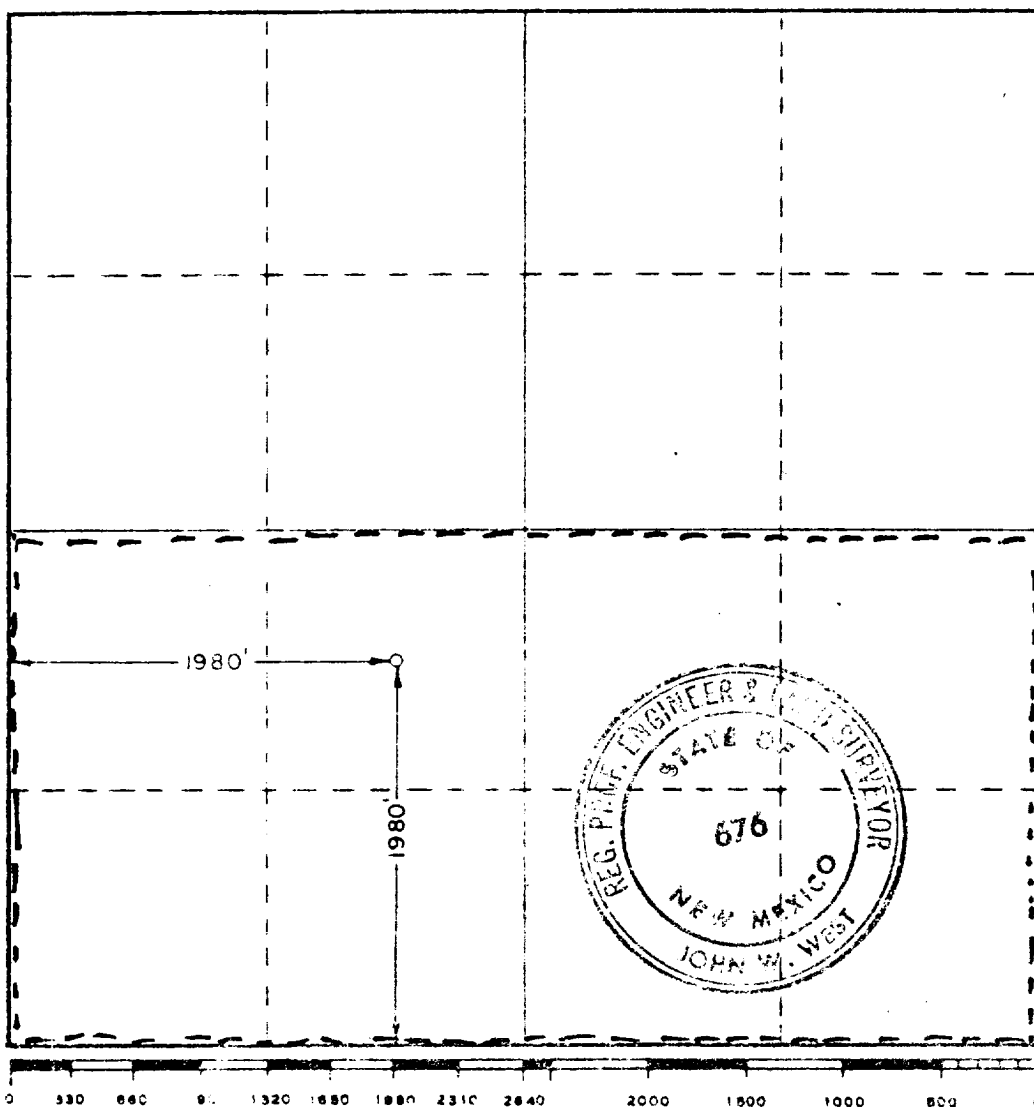

**CERTIFICATION**

I hereby certify that the information contained herein is true and complete to the best of my knowledge and belief.

Name *John W. West*  
 Title *Sr. Analyst*  
 Company *Continental Oil Co.*  
 Date *6-5-74*

I hereby certify that the well location shown on this plat was plotted from field notes of actual surveys made by me or under my supervision, and that the same is true and correct to the best of my knowledge and belief.

Date Surveyed

**JUNE 1, 1974**

Registered Professional Engineer  
and/or Land Surveyor

*John W. West*  
 Certificate No. **676**

11

12

13

14