



STATE OF NEW MEXICO
ENERGY, MINERALS AND NATURAL RESOURCES DEPARTMENT

OIL CONSERVATION DIVISION
HOBBS DISTRICT OFFICE

11 / 5 / 98

GOVERNOR

POST OFFICE BOX 1980
HOBBS, NEW MEXICO 88241-1980
(505) 393-6161

OIL CONSERVATION DIVISION
P. O. BOX 2088
SANTA FE, NEW MEXICO 87501

RE: Proposed:

MC _____
DHC _____
NSL X _____
NSP _____
SWD _____
WFX _____
PMX _____

Gentlemen:

I have examined the application for the:

JC Williamson Triple A Federal #1-F 10-23s-34e
Operator Lease & Well No. Unit S-T-R

and my recommendations are as follows:

Recommend approval.

Yours very truly,

Chris Williams
Supervisor, District 1

/ed

State of New Mexico
Energy, Minerals and Natural Resources Department
OIL CONSERVATION DIVISION
HOBBS DISTRICT

File:unloc3a1.wpd

ATT: Mr. Chris Williams, District Supervisor
1000 W. Broadway, Hobbs, New Mexico 88240

APPLICATION FOR UNORTHODOX LOCATION

APPLICANT: J. C. WILLIAMSON
P. O. Box 16
Midland, Texas 79701

SUBJECT WELL: J. C. WILLIAMSON, Triple "A" Federal, Well No. 1
LOCATION: 1580' FNL & 2614' FWL, Sec. 10, T23S, R34E,
Antelope Ridge Field, Lea County, New Mexico.

OBJECTIVE: To plug off the Wolfcamp perforations, drill out cement plugs in the top of the Pennsylvanian and run a liner through the Strawn Formation in order to attempt a completion in either the Atoka-Strawn or the Morrow formations that are currently producing in the Antelope Ridge Field. This well is currently completed as a Wolfcamp gas well on an unorthodox 320 Acre unit but uneconomic. The proposed unit is a standard unit, but is on an unorthodox location for Pennsylvanian production.

PLEA:

Comes now J. C. Williamson, Operator and owner of interest, requesting Administrative Approval of a location of an existing well on a standard 320 Acre proration unit consisting of the N/2 of Section 10, T23S, R34E, Lea County, New Mexico. In support of this application, the following stipulations are offered:

A. This well was originally drilled by Adobe Oil & Gas Company as their Federal "AA" No. 1-x as a wildcat Devonian test, but was plugged and abandoned in 1975. In 1980 the well was re-entered and completed as a Wolfcamp gas well. The well was cleaned out to a depth of 12,276' and completed in open hole after setting a cement plug, the top of which is 12,010'. The well is no longer commercial and the working interest owners wish to test the Pennsylvanian for gas production.

B. The North half of Section 10 comprises two tracts, the NW/4 and E/2 NE/4 (280 Acres) and the E/2 NE/4 (40 Acres) to comprise a standard 320 Acre proration unit. The acreage is currently under communitization procedures with a majority of owners already committed and is expected to be completed prior to November 1, 1998.

C. All offset Operators have been notified by registered letter and a copy of this application. The offset Operators notified, as shown on EXHIBIT "A", a plat of the area and hereto attached, are

Page 2,

listed below with their addresses by which they were notified:

BTA Oil Producers, 104 S. Pecos, Midland, Texas 79701

Mid-Continent Energy Operating Co., 100 W. 5th St., Suite 450, Tulsa, OK 74103-4287

Phillips Petroleum, 4001 Penbrook St., Odessa, Texas 79762

D. This well was previously approved for the Wolfcamp proration unit by Order No. R-6738-A and, by its location does not infringe on offset correlative rights and its approval will prevent waste by eliminating the necessity of drilling a new well. The projected reservoir volume of gas to be recovered will not support the drilling of a new well and, without the use of the subject well, the remaining gas will not be recovered.

E. A new C-101 Form is attached along with EXHIBIT "B", the corrected survey plat of the well showing its correct location.

J. C. Williamson, as Operator of the Subject Well, hereby requests that the District Supervisor grant Administrative Approval for the unorthodox location of the Subject Well as provided in Rule 104 F.I without notice and hearing based on the completion of this well requires the recompletion of formations above the objective of an old well originally drilled to a deeper horizon.

Respectfully Submitted,

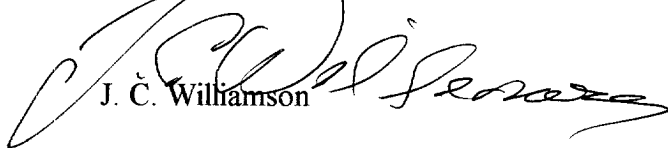
J. C. Williamson



UNITED STATES
DEPARTMENT OF THE INTERIOR
BUREAU OF LAND MANAGEMENT

APPLICATION FOR PERMIT TO DRILL, DEEPEN, OR PLUG BACK

1a. TYPE OF WORK

DRILL ☐

DEEPEN ☒

PLUG BACK ☐

b. TYPE OF WELL

OIL WELL ☐

GAS WELL ☒

OTHER

SINGLE ZONE ☒

MULTIPLE ZONE ☐

2. NAME OF OPERATOR

J. C. Williamson

3. ADDRESS OF OPERATOR

P. O. Box 16 Midland, Texas 79701

4. LOCATION OF WELL (Report location clearly and in accordance with any State requirements.)*

At surface

1580' FNL & 2614' FWL Sec. 10, T23S, R34E

At proposed prod. zone

14. DISTANCE IN MILES AND DIRECTION FROM NEAREST TOWN OR POST OFFICE*

26 Miles SW Eunice NM

10. DISTANCE FROM PROPOSED* LOCATION TO NEAREST PROPERTY OR LEASE LINE, FT.
(Also to nearest drilg. unit)
1580' From N Lease Line
1060' From S Unit Line

16. NO. OF ACRES IN LEASE

360 Acres in Penn Unit

17. NO. OF ACRES ASSIGNED TO THIS WELL

360

18. DISTANCE FROM PROPOSED LOCATION* TO NEAREST WELL, DRILLING, COMPLETED, OR APPLIED FOR, ON THIS LEASE, FT.
1628' F nearest Penn Well

19. PROPOSED DEPTH

D/ out to 12,250'

20. ROTARY OR CABLE TOOLS

REVERSE UNIT

21. ELEVATIONS (Show whether DF, RT, GR, etc.)

3365 GL

22. APPROX. DATE WORK WILL START*

4 SEP

23. PROPOSED CASING AND CEMENTING PROGRAM

SIZE OF HOLE	SIZE OF CASING	WEIGHT PER FOOT	SETTING DEPTH	QUANTITY OF CEMENT
EXISTING CASING W/ 7-5/8" OD CSG. (CEMENTED TO SURF.)				
SET 5-1/2" OD LINER AT 12,250' AND HANG @ 11,488' AND CIRCULATE EXCESS CLASS H CEMENT TO LINER TOP.				all casing Cement Circ.

PROGNOSIS OF OPERATIONS

This well is currently completed in the Wolfcamp formation and is no longer commercial. The objective of this project is to drill out the cement plug from 12,010' to a depth of 12,250'. A 5-1/2" OD liner will be run to total depth and hung at 11,488', which is 400' overlap above the 7-5/8" OD casing seat. The well will be perforated, acidized and tested in the Strawn formation through perforations over the interval 12,180-12,200'. Gas and condensate are the projected recoverable hydrocarbons. A large pulling unit and reverse circulation equipment will be used to drill out the cement plug. A double ram blow out preventer and a hydril drilling head will be used in the operation.

IN ABOVE SPACE DESCRIBE PROPOSED PROGRAM: If proposal is to deepen or plug back, give data on present productive zone and proposed new productive zone. If proposal is to drill or deepen directionally, give pertinent data on subsurface locations and measured and true vertical depths. Give blowout preventer program, if any.

24.

SIGNED

TITLE

Agent

DATE

10-28-98

(This space for Federal or State office use)

PERMIT NO.

APPROVAL DATE

APPROVED BY

TITLE

DATE

CONDITIONS OF APPROVAL, IF ANY:

*See Instructions On Reverse Side

Title 18 U.S.C. Section 1001, makes it a crime for any person knowingly and willfully to make to any department or agency of the United States any false, fictitious or fraudulent statements or representations as to any matter within its jurisdiction.

MEXICO OIL CONSERVATION COMM
WELL LOCATION AND ACREAGE DEDICATION PLAT

Form C-102
 Supersedes C-128
 Effective 1-1-55

All distances must be from the outer boundaries of the Section.

Operator J.C. WILLIAMSON			Lease Triple "A" Federal		Well No. 1
Unit Letter F	Section 10	Township 23 South	Range 34 East	County Lea	
Actual Footage Location of Well: 1580 feet from the North line and 2614 feet from the West line					
Ground Level Elev. 3365 GL	Producing Formation Pennsylvanian		Pool Antelope Ridge	Dedicated Acreage: N/2 Sec 360 Acres	

1. Outline the acreage dedicated to the subject well by colored pencil or hachure marks on the plat below.
2. If more than one lease is dedicated to the well, outline each and identify the ownership thereof (both as to working interest and royalty).
3. If more than one lease of different ownership is dedicated to the well, have the interests of all owners been consolidated by communitization, unitization, force-pooling, etc?

☐ Yes ☐ No If answer is "yes," type of consolidation _____

If answer is "no," list the owners and tract descriptions which have actually been consolidated. (Use reverse side of this form if necessary.) _____

No allowable will be assigned to the well until all interests have been consolidated (by communitization, unitization, forced-pooling, or otherwise) or until a non-standard unit, eliminating such interests, has been approved by the Commission.

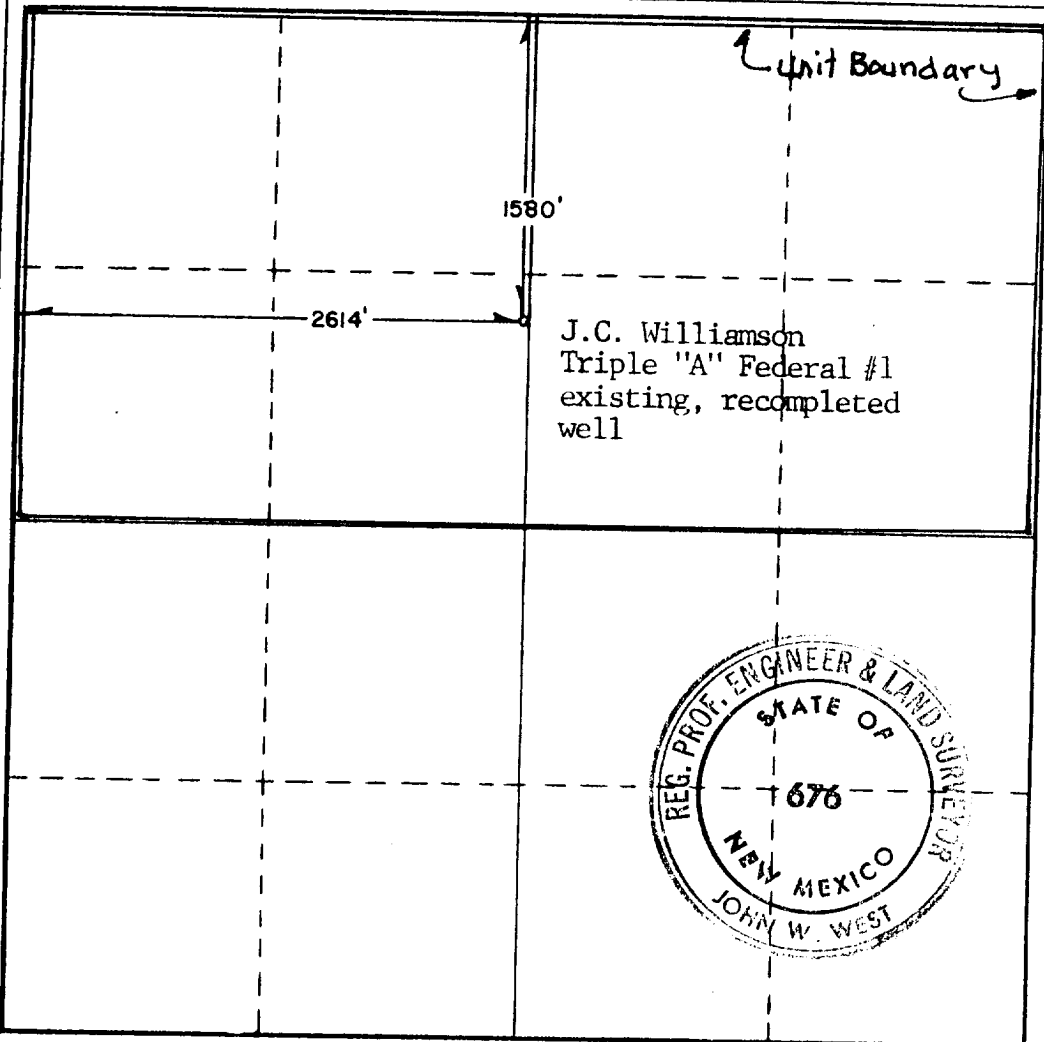

CERTIFICATION

I hereby certify that the information contained herein is true and complete to the best of my knowledge and belief.

Name _____

Position _____

Company _____

Date _____

I hereby certify that the well location shown on this plat was plotted from field notes of actual surveys made by me or under my supervision, and that the same is true and correct to the best of my knowledge and belief.

Date Surveyed

8/28/81

Registered Professional Engineer and/or Land Surveyor

John W. West

Certificate No. **JOHN W. WEST 676**
PATRICK A. ROMERO 6863
Ronald J. Eldson 3239

0 330 660 990 1320 1650 1980 2310 2640 2970 3300 3630 3960 4290 4620 4950 5280 5610 5940

BTA OIL PRODUCERS

PHILLIPS PETROLEUM

J. C. WILLIAMSON

Unit Boundary.

BTA OIL PRODUCERS

1580'

J. C. Williamson
Triple "A" Federal
Well No. 1

2614'

"State Surface"

TRACT "A"
LEASE No. Nm-15035

TRACT "B"
LEASE No. 35164

USA

USA

10

MID-CONTINENT

Mid-Continent Energy
Belco Federal
Well No. 2

USA

J. C. WILLIAMSON TRIPLE "A" FEDERAL WELL No. 1
ANTELOPE RIDGE FIELD AREA, SEC. 10, T23S, R34E, LEA CO. NM

SCALE:

APPROVED BY:

EXHIBIT "A"

DRAWN BY

DATE:

REVISED 10/28/98

OIL AND GAS OPERATORS

CURRY ENGINEERING

DRAWING NUMBER