

NEW MEXICO OIL CONSERVATION COMMISSION

Form O-101
Revised 1-14-65

1. A. In Route Type of Loc.

STATE ☐

2. State Oil & Gas Lease No.

APPLICATION FOR PERMIT TO DRILL, DEEPEN, OR PLUG BACK

3a. Type of Work

DRILL ☒DEEPEN ☐PLUG BACK ☐

3b. Type of Well

OIL WELL ☒GAS WELL ☐OTHER ☐SINGLE ZONE ☐MULTIPLE ZONE ☐

4. Name of Operator

Gulf Oil Corporation

5. Address of Operator

Box 670, Hobbs, New Mexico 88240

6. Location of Well

UNIT LETTER C

LOCATED 950

FEET FROM THE North

LINE

7. 2290

FEET FROM THE West

LINE OF SEC. 14

TWP. 22-S

RGE. 37-E

NMPM

7. Unit Agreement Name

8. Firm or Lease Name

Hugh

9. Well No.

10

10. Field and Pool, or Well No. 10
Wantz Granite Wash

12. County

Lea

19. Proposed Depth

7400'

19A. Formation

Granite Wash

20. Rotary or C.P.

Rotary

21. Elevations (Show whether DF, RT, etc.)

3341' GL

21A. Kind & Status Plug. Bond

Blanket

21B. Drilling Contractor

22. Approx. Date Work will start

April 15, 1975

PROPOSED CASING AND CEMENT PROGRAM

SIZE OF HOLE	SIZE OF CASING	WEIGHT PER FOOT	SETTING DEPTH	SACKS OF CEMENT	EST. TOP
12-1/4"	9-5/8"	36#	1150'	Circulate	
8-3/4"	7"	23#	7400'	Base of Salt	

BOP: See Drawing No. 3 attached.

IN ABOVE SPACE DESCRIBE PROPOSED PROGRAM: IF PROPOSAL IS TO DEEPEN OR PLUG BACK, GIVE DATA ON PRESENT PRODUCTIVE ZONE AND PROPOSED NEW PRODUCTION ZONE. GIVE BLOWOUT PREVENTER PROGRAM, IF ANY.

I hereby certify that the information above is true and complete to the best of my knowledge and belief.

Signed B. J. Barber Title Area EngineerDate April 3, 1975

(This space for State Use)

APPROVED BY J. R. [Signature] TITLE _____

DATE _____

CONDITIONS OF APPROVAL, IF ANY:

7-4-75

NEW MEXICO OIL CONSERVATION COMMISSION
WELL LOCATION AND ACREAGE DEDICATION PLAT

Form No. 1
Superseded by Form No. 1A
Effective 1-1-68

All distances must be from the outer boundaries of the Section

Gulf Oil Corporation		Hughes		West		10
C	14	22 South	37 East	Lea		
North		line and	2290	West		line
33-11-1	Granite Wash		Wantz Granite Wash		40	

Outline the acreage dedicated to the subject well by colored pencil or hachure marks on the plat below.

Where more than one lease is dedicated to the well, outline each and identify the ownership thereof (both as to working interest and royalty).

Where more than one lease of different ownership is dedicated to the well, have the interests of all owners been consolidated by communitization, unitization, force-pooling, etc?

Yes ☐ No ☐ If answer is "yes," type of consolidation _____

If answer is "no" list the owners and tract descriptions which have actually been consolidated. (Use reverse side of this form if necessary.) _____

No acreage will be assigned to the well until all interests have been consolidated (by communitization, unitization, force-pooling, or otherwise) or until a non-standard unit, eliminating such interests, has been approved by the Commission.

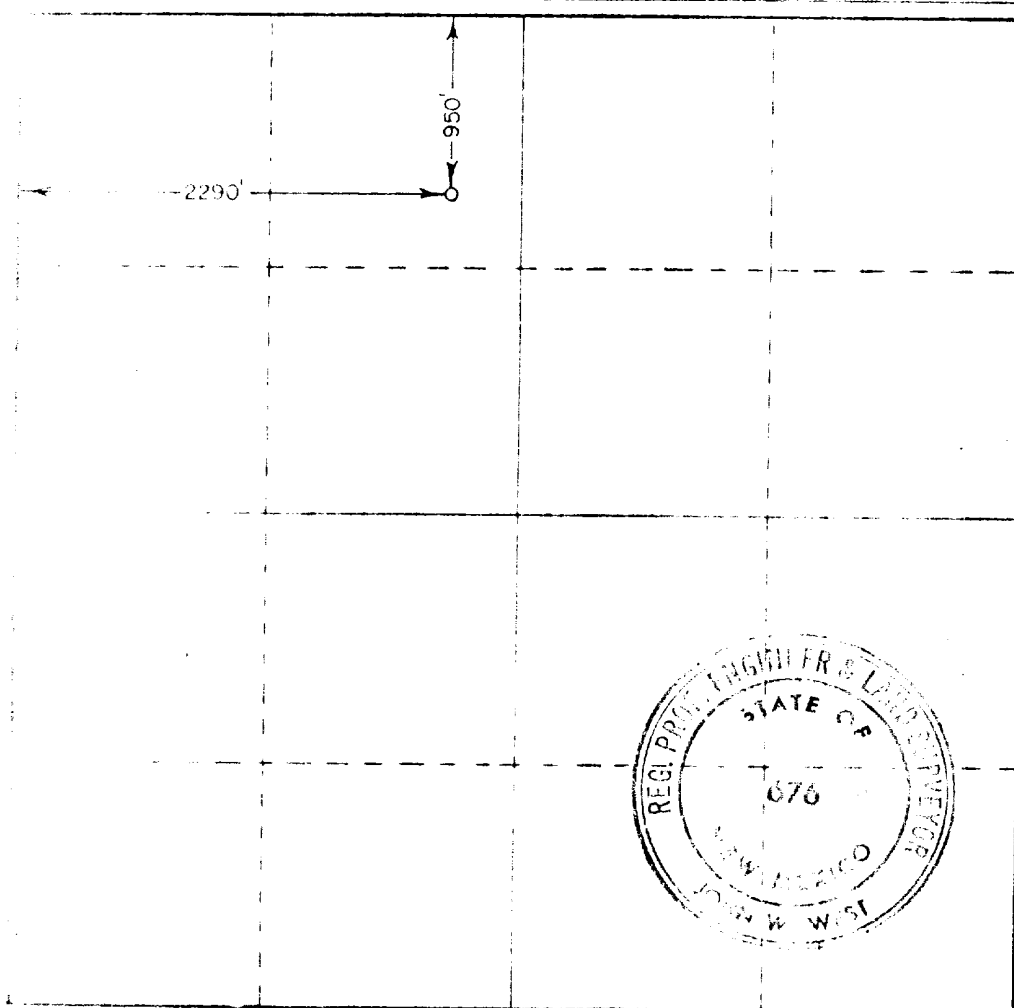

CERTIFICATION

I hereby certify that the information contained herein is true and complete to the best of my knowledge and belief.

B. J. Pankratz

B. J. PANKRATZ

Area Engineer

Gulf Oil Corporation

Date
April 3, 1975

I hereby certify that the well location shown on this plat was plotted from field notes of actual surveys made by me or under my supervision, and that the same is true and correct to the best of my knowledge and belief.

Date Surveyed
April 1, 1975

Registered Professional Engineer and/or Land Surveyor

John W. West

Certificate No. 676

CHANGES

If a Hydril "GX" each size of drill in preventer may be used. If shall be sufficient by a continuous measure within mutators with in the 1000 PSI with the above of closed positions, a ram preventer, at as possible the edge of