

**NEW MEXICO OIL CONSERVATION COMMISSION
WELL LOCATION AND ACREAGE DEDICATION P**

Form C-102
Supersedes C-128
Effective 1-1-65

All distances must be from the outer boundaries of the Section

Operator Skelly Oil Company			Lease Federal Sand 18		Well No. 1
Section H	Section 18	Township 23 South	Range 32 East	County Lea	
Actual Well Location of Well: 1980 feet from the North line and 660 feet from the East line					
Ground Level Elev. 3601	Producing Formation Atoka & Morrow	Pool Undesignated		Dedicated Acreage: 320-Atoka 320-Morrow Acres	

- 1 Outline the acreage dedicated to the subject well by colored pencil or hatchure marks on the plat below.
- 2 If more than one lease is dedicated to the well, outline each and identify the ownership thereof (both as to working interest and royalty).
- 3 If more than one lease of different ownership is dedicated to the well, have the interests of all owners been consolidated by communitization, unitization, force-pooling, etc?

☐ Yes ☒ No If answer is "yes," type of consolidation **Communitization pending**

If answer is "no," list the owners and tract descriptions which have actually been consolidated. (Use reverse side of this form if necessary.) _____

No allowable will be assigned to the well until all interests have been consolidated (by communitization, unitization, forced-pooling, or otherwise) or until a non-standard unit, eliminating such interests, has been approved by the Commission.

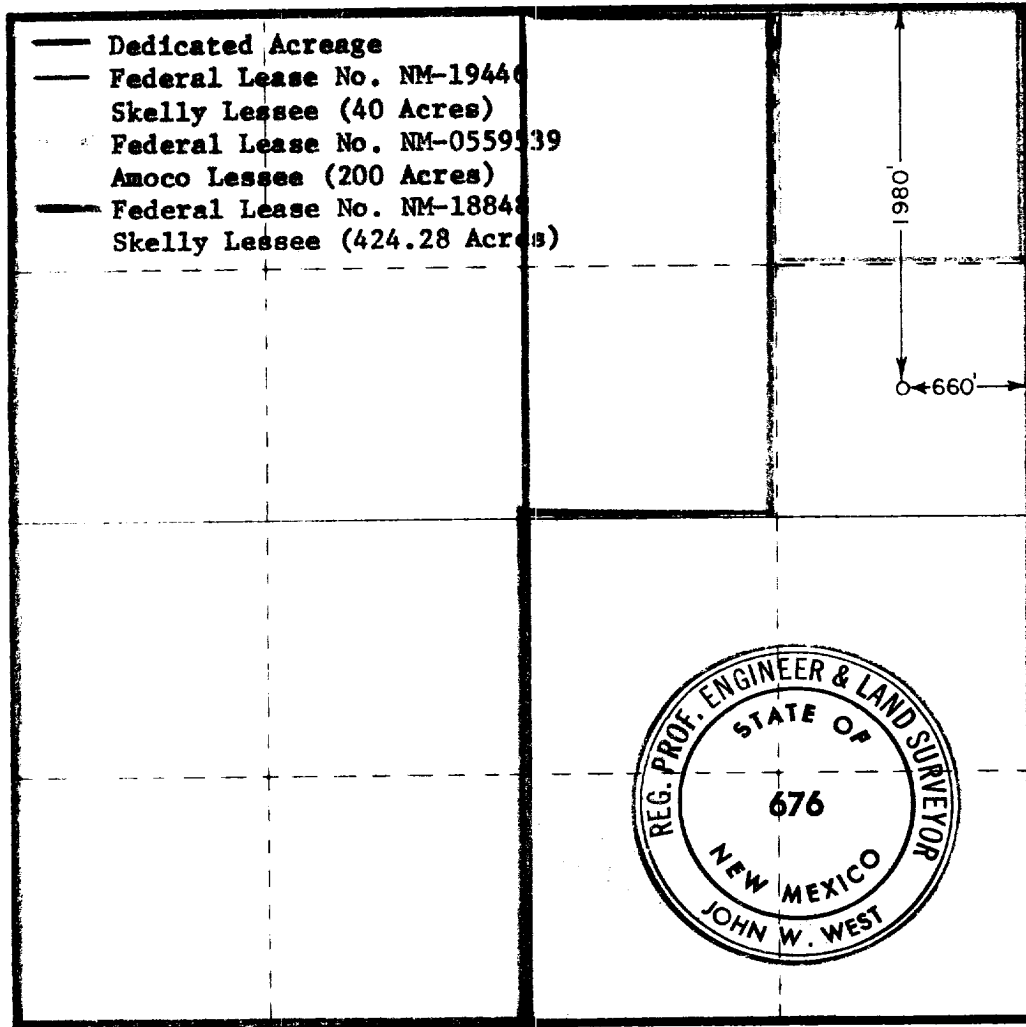

CERTIFICATION

I hereby certify that the information contained herein is true and complete to the best of my knowledge and belief.

Name
(Signed) **D. R. Crow** **D. R. Crow**

Position
Lead Clerk

Company
Skelly Oil Company

Date
April 2, 1975

I hereby certify that the well location shown on this plat was plotted from field notes of actual surveys made by me or under my supervision, and that the same is true and correct to the best of my knowledge and belief.

Date Surveyed
March 28, 1975

Registered Professional Engineer and/or Land Surveyor

John W. West
Certificate No. **676**

