

UNITED STATES
DEPARTMENT OF THE INTERIOR
GEOLOGICAL SURVEY

APPLICATION FOR PERMIT TO DRILL, DEEPEN, OR PLUG BACK

1a. TYPE OF WORK DRILL <input checked="" type="checkbox"/> DEEPEN <input type="checkbox"/> PLUG BACK <input type="checkbox"/>		5. LEASE DESIGNATION AND SERIAL NO. 0557257		
b. TYPE OF WELL OIL WELL <input checked="" type="checkbox"/> GAS WELL <input type="checkbox"/> OTHER <input type="checkbox"/>		6. IF INDIAN, ALLOTTEE OR TRIBE NAME		
2. NAME OF OPERATOR Texas Pacific Oil Company, Inc.		7. UNIT AGREEMENT NAME		
3. ADDRESS OF OPERATOR P. O. Box 4067, Midland, Texas 79701		8. FARM OR LEASE NAME Elliott B-13		
4. LOCATION OF WELL (Report location clearly and in accordance with any State requirements.)* At surface 510' FWL & 2100' FNL At proposed prod. zone		9. WELL NO. 2		
14. DISTANCE IN MILES AND DIRECTION FROM NEAREST TOWN OR POST OFFICE* 2-1/2 miles SE Eunice, New Mexico		10. FIELD AND POOL, OR WILDCAT Drinkard & Wantz (GW)		
15. DISTANCE FROM PROPOSED* LOCATION TO NEAREST PROPERTY OR LEASE LINE, FT. (Also to nearest drilg. unit line, if any) 510'		11. SEC., T., R., M., OR BLE. AND SURVEY OR AREA Sec. 13, T-22-S, R-37-E		
16. NO. OF ACRES IN LEASE 40'		12. COUNTY OR PARISH Lea		
17. NO. OF ACRES ASSIGNED TO THIS WELL 40		13. STATE New Mexico		
18. DISTANCE FROM PROPOSED LOCATION* TO NEAREST WELL, DRILLING, COMPLETED, OR APPLIED FOR, ON THIS LEASE, FT. 7450'		20. ROTARY OR CABLE TOOLS Rotary		
21. ELEVATIONS (Show whether DF, RT, GR, etc.)		22. APPROX. DATE WORK WILL START* Upon Approval		
23. PROPOSED CASING AND CEMENTING PROGRAM				
SIZE OF HOLE	SIZE OF CASING	WEIGHT PER FOOT	SETTING DEPTH	QUANTITY OF CEMENT
12-1/4"	9-5/8"	32.3#	1250'	600 sxs Class C Circulate
8-3/4"	7"	26 & 23#	7450'	140% of Calipered Volume Base of Salt Section

To drill and complete as dual Drinkard-Wantz (Granite Wash) oil well.

See Attachments:

Development Plan for Surface Use
Drilling Procedure
Casing & Cementing Program
Mud & Logging Program

BOP 10" Shaeffer Type "B" double ram series 900,3000 psi w/hydraulic controls. To be tested when installed and on trips below surface casing.

IN ABOVE SPACE DESCRIBE PROPOSED PROGRAM: If proposal is to deepen or plug back, give data on present productive zone and proposed new productive zone. If proposal is to drill or deepen directionally, give pertinent data on subsurface locations and measured and true vertical depths. Give blowout preventer program, if any.

24. SIGNED B. A. Knight TITLE Drilling Coordinator DATE 10-1-75
(This space for Federal or State office use)

PERMIT NO. _____

APPROVAL DATE

APPROVED BY _____
CONDITIONS OF APPROVAL, IF ANY:

TITLE _____

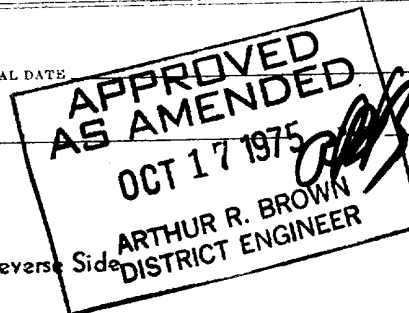

JAN 17 1975

*See Instructions On Reverse Side

NEW MEXICO OIL CONSERVATION COMMISSION
WELL LOCATION AND ACREAGE DEDICATION PLAT

Form C-102
Supersedes C-128
Effective 1-1-65

All distances must be from the outer boundaries of the Section.

Operator Texas Pacific Oil Company, Inc.			Lease Elliot "B" 13		Well No. 2
Unit Letter E	Section 13	Township 22 South	Range 37 East	County Lea	
Actual Footage Location of Well: 510 feet from the West line and 2100 feet from the North line					
Ground Level Elev. 3330	Producing Formation Drinkard & Granite Wash		Pool Drinkard & Wantz Granite Wash		Dedicated Acreage: SW $\frac{1}{4}$ NW $\frac{1}{4}$ 40 Acres

1. Outline the acreage dedicated to the subject well by colored pencil or hachure marks on the plat below.
2. If more than one lease is dedicated to the well, outline each and identify the ownership thereof (both as to working interest and royalty).
3. If more than one lease of different ownership is dedicated to the well, have the interests of all owners been consolidated by communitization, unitization, force-pooling, etc?

☐ Yes ☐ No If answer is "yes," type of consolidation _____

If answer is "no," list the owners and tract descriptions which have actually been consolidated. (Use reverse side of this form if necessary.) _____

No allowable will be assigned to the well until all interests have been consolidated (by communitization, unitization, forced-pooling, or otherwise) or until a non-standard unit, eliminating such interests, has been approved by the Commission.

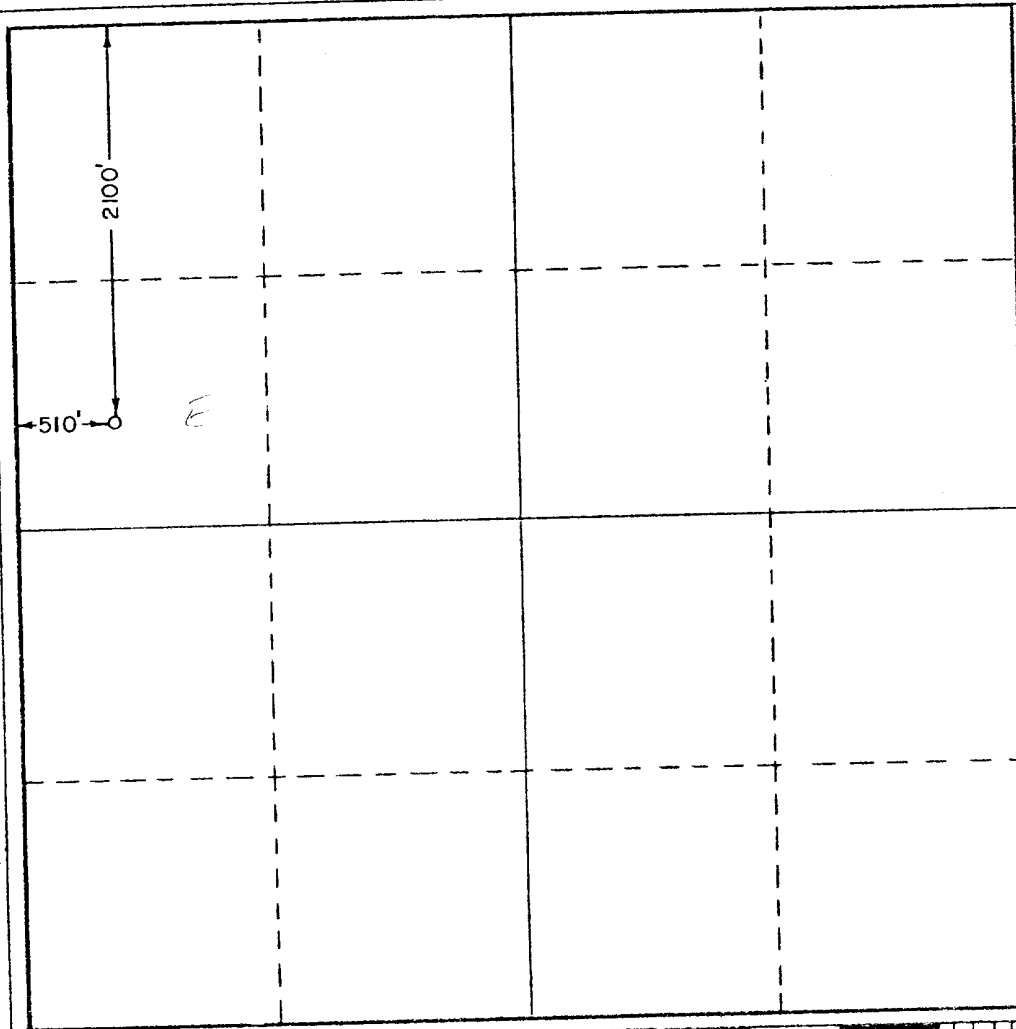

CERTIFICATION

I hereby certify that the information contained herein is true and complete to the best of my knowledge and belief.

B. J. Knight
Name
B. J. Knight

Position
Drilling Coordinator

Company
Texas Pacific Oil Company, Inc.

Date
October 2, 1975

I hereby certify that the well location shown on this plat was plotted from field notes of actual surveys made by me or under my supervision, and that the same is true and correct to the best of my knowledge and belief.

Date of Survey
September 29, 1975
Registered Professional Engineer and Land Surveyor
676

John W. West
Certified
JOHN W. WEST

0 320 640 960 1280 1600 1920 2240 2560 2880 3200 3520 3840 4160 4480 4800 5120 5440 5760 6080 6400

Elliott B-13 Well No. 2
Jtz Granite Wash Field
510' FWL & 2100' FNL, Sec. 13, T-22-S, R-37-E
Lea County, New Mexico

CEMENTING PROGRAM

SURFACE CASING

Hole (Bit) Size:	12-1/4"
Casing Size:	9-5/8"
Approximate Setting Depth:	1250'
Estimated BHT:	800° F
Rate, BPM:	6-8
WOC Time:	24
Test Pressure:	1000 psig - 30 mins.

No caliper. Volume of cmt equivalent to 200% of theoretical hole size. Cmt to circ. Use 600 sx of class "C" cmt w/2% cacl₂, 14.8 ppg, 1.32 ft³/sk.

Equipment:

- Guide Shoe (1)
- EZ-Lok Clamp (1)
- Float Collar (1)
- S-3 Centralizer (3)
- Howco Weld-A-Kit (2)

Threadlock shoe and float collar. Centralizers installed on middle of shoe jt and next two collars above shoe jt.

PRODUCTION CASING

Hole (Bit) Size:	8-3/4"
Casing Size:	7"
Approximate Setting Depth:	7450'
Estimated BHT:	110° F
Rate, BPM:	6-8
WOC Time:	24 hrs.
Test Pressure:	1500 psig - 30 mins.

Volume of cmt equivalent to 140% of calipered hole size (use caliper from open-hole porosity log). Lead slurry should be calculated to fill from 4500' to 2400' and the tail-in slurry should be calculated to fill from TD to 4500'. Displace plug w/fresh water. WOC 8-10 hrs. Run temp survey to determine cmt top.

Lead slurry: _____ sx TLW w/4% gel, 1/4 lb/sk flocele, 12.0 ppg, 1.85 ft³/sk.

Tail-in slurry: _____ sx class "C" w/6 lbs/sk salt, 15.0 ppg, 1.35 ft³/sk.

Equipment:

- Float Shoe (1)
- EZ-Lok Clamp (1)
- Float Collar (1)
- S-3 Centralizer (as req'd thru prospective pay intervals).
- Howco Weld-A-Kit (1)

Threadlock float shoe & float collar. Install centralizer on middle of shoe jt and on every other collar thru the prospective pay intervals.

TEXAS PACIFIC OIL COMPANY

DRILLING PROCEDURE TP-105-B

DISTRICT/AREA
Midland/West

LEASE NAME AND WELL NUMBER
Elliott B-13 No. 2

LOCATION
FWL & 2100' FNL Sec. 13, T-22-S, R-37-E

COUNTY/PARISH
Lea County

DATE
2-13-75

AFE NO.

FIELD
Wantz-Drinkard

STATE
New Mexico

INSTRUCTIONS: List on drilling report each lost circulation zone and amount of mud lost. List on Company reports all mud, chemicals, lost circulation material and oil used in drilling mud each tour. Strap drill pipe on first trip under surface and before logging, testing, or coring. Tool pusher will be responsible to obtain and to check all tallies on tubular goods received at well, as well as check accuracy on delivery tickets of other material delivered to well.

SUPERINTENDENT'S SIGNATURE

ENGR. APPROVAL

GEOL. APPROVAL

CASING PROGRAM	STRING	SIZE	LENGTH OF SECTION	WEIGHT	GRADE	THREAD	HOLE SIZE	ALLOWED CEMENT TIME HRS
	Surface (IN TOP RUSTLER)	9 5/8"	1250'	32.3	H-40	STC 8RD	12 1/4"	24
	Production	7	5500'	23	K55	STC 8RD	8 3/4"	--
		7	1950'	26	K55	STC 8RD		
	All casing to be Range 3 Sandblast 1300' 7" 26#.							

CEMENT PROGRAM	Attached
----------------	----------

MUD PROGRAM	DEPTH	TYPE	MUD WEIGHT	VISCOSITY	PH	WATER LOSS
	0-1250'	Fresh water spud mud				
	1250'-5000'	Brine water w/oil as necessary to drill through San Andres	9.8*		11	
	5000'-TD	Brine water, salt gel, starch and oil as required.	9.8 - 10.0	34-40	11	8-10

DEVIATION FROM VERTICAL NOT TO EXCEED 3 DEGREES PER 1000 FT NOT TO EXCEED 6 DEGREES AT TOTAL DEPTH

EXPECTED FORMATION TOPS	DESCRIPTION*	DEPTH	SUB SEA	LOGGING, CORING & TESTING PROGRAM
	Rustler (anhydrite)	1100	+2245	Dresser Atlas GR-SNP-Caliper from TD to base of surface casing GR to surface
	San Andres	3920	-575	GR-Density from TD to 5000'. GR-Dual
	Blinbry	5492	-2147	Latarolog from TD to base of surface casing.
	Drinkard	6295	-2950	
	Granite Wash	7315	-3970	
	TD	7450		

TOTAL CONTRACT DEPTH	MUD SUPPLIER	MECHANICAL RATE OF PENETRATION	YES	NO
1450		DEVICE REQUIRED	X	

SAMPLE PROCEDURE	EQUIPMENT OR SERVICES MAY BE INSTALLED AT FOLLOWING:
10' drilling times surface to TD 10' samples 1000' to 1150' and 2500' to TD Est. elevation 3345' DF	EQUIPMENT DEPTH Communications Surface Geolograph Surface BOP 1250'

UNUSUAL PROBLEMS AND/OR REMARKS

PERSONNEL	NAME & TITLE	CITY	OFFICE PHONE	RESIDENCE PHONE NUMBER
	R. E. Kenney - Drilling Foreman	Midland	915-684-5584	806-592-22
	B. J. Knight - Drilling Coordinator	Midland	915-684-5534	915-634-62
	T. P. Frizzell - Geologist	Midland	915-684-5584	915-694-79
	M. L. Schroeder - Engineer	Midland	915-684-5584	915-684-90

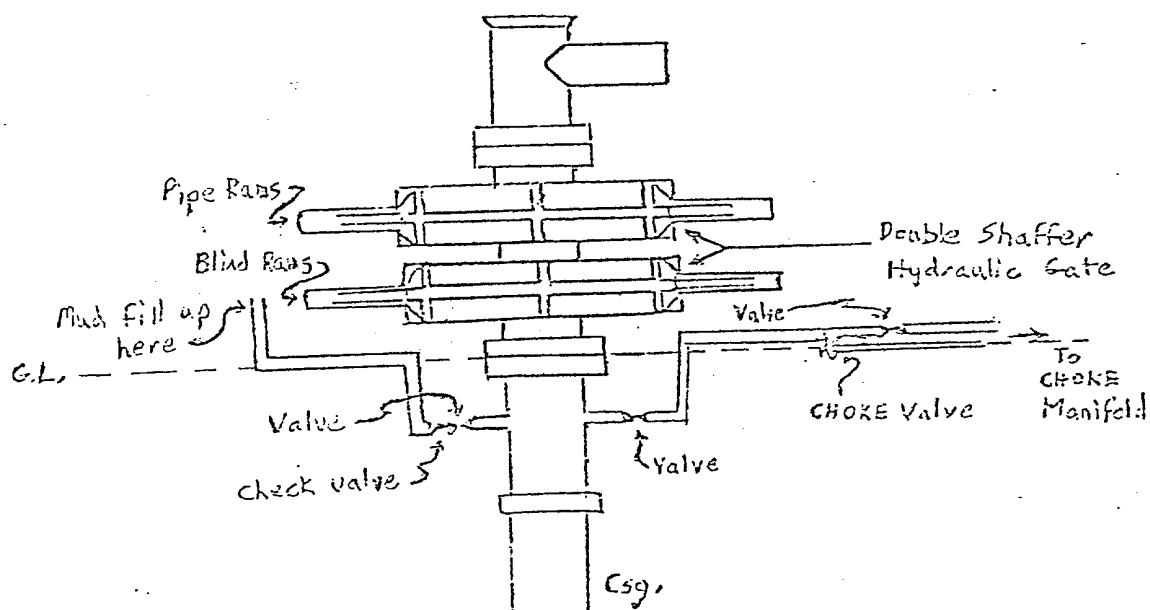
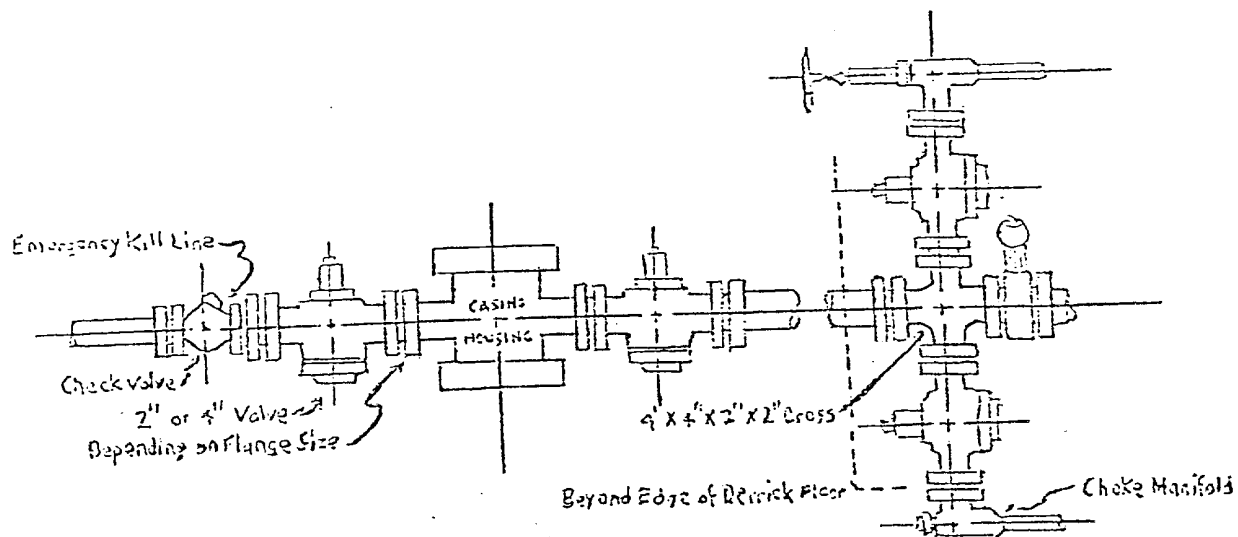

DEVELOPMENT PLAN FOR SURFACE USE

Texas Pacific Oil Company, Inc.
Elliott B-13 Well No. 2
510' FWL & 2100' FNL
Sec. 13, T-22-S, R-37-E
Eddy County, New Mexico

- 1) Existing roads including location of the exit from main highway.
See Attachment No. 1
- 2) Planned access roads: Will use existing roads.
See Attachment No. 1
- 3) Location of existing wells.
See Attachment No. 2
- 4) Lateral roads to well locations.
See Attachment No. 1
- 5) Location of tank batteries and flow lines: Will submit plan
when production established.
- 6) Location and type of water supply: Drilling operations will
utilize fresh water spud mud from surface to 1250'. Brine water
with additives from 1250' to total depth of 7450'. All water will
be purchased from local commercial suppliers, and will be stored
at the drill site during drilling operations.
See Attachment No. 3
- 7) Methods for handling waste disposal: Drill cuttings and associated
drilling fluids will be collected in a plastic lined dirt pit.
After drilling is completed, liquids will be allowed to evaporate
and the pits will be levelled. Unused drilling fluids or brine
water will be hauled away. Trash, garbage, etc. collected during
drilling operations will be buried in a separate trash pit.
- 8) Location of camps.
N/A
- 9) Locations of airstrips.
N/A
- 10) Location of layout to include position of the rig, mud tanks,
reserve pits, burn pits, pipe racks, etc.
See Attachment No. 3

DEVELOPMENT PLAN FOR SURFACE USE

Page 2

- 11) Plans for restoration of surface: Upon completion of drilling operations, the drill site surface will be levelled using a bulldozer. No other action will be taken. Damages have been settled with surface owner and a copy of location damage release attached.
- 12) Any other information that may be used in evaluating the impact on environment: The area around the proposed drill site is deep, sandy rangeland. Vegetation consists primarily of mesquite bushes, oak shrubs. There is no nearby streambeds, water-courses, lakes, or ponds. There is no cropland in the immediate vicinity.
- 13) Company Field Representative; Office Phone 915/684-5584
 - a) Sheldon Ward Drilling Foreman Home: 682-7180
 - b) B. J. Knight Drilling Coordinator Home: 684-6263
 - c) Tom Frizzell Geologist Home: 694-7944

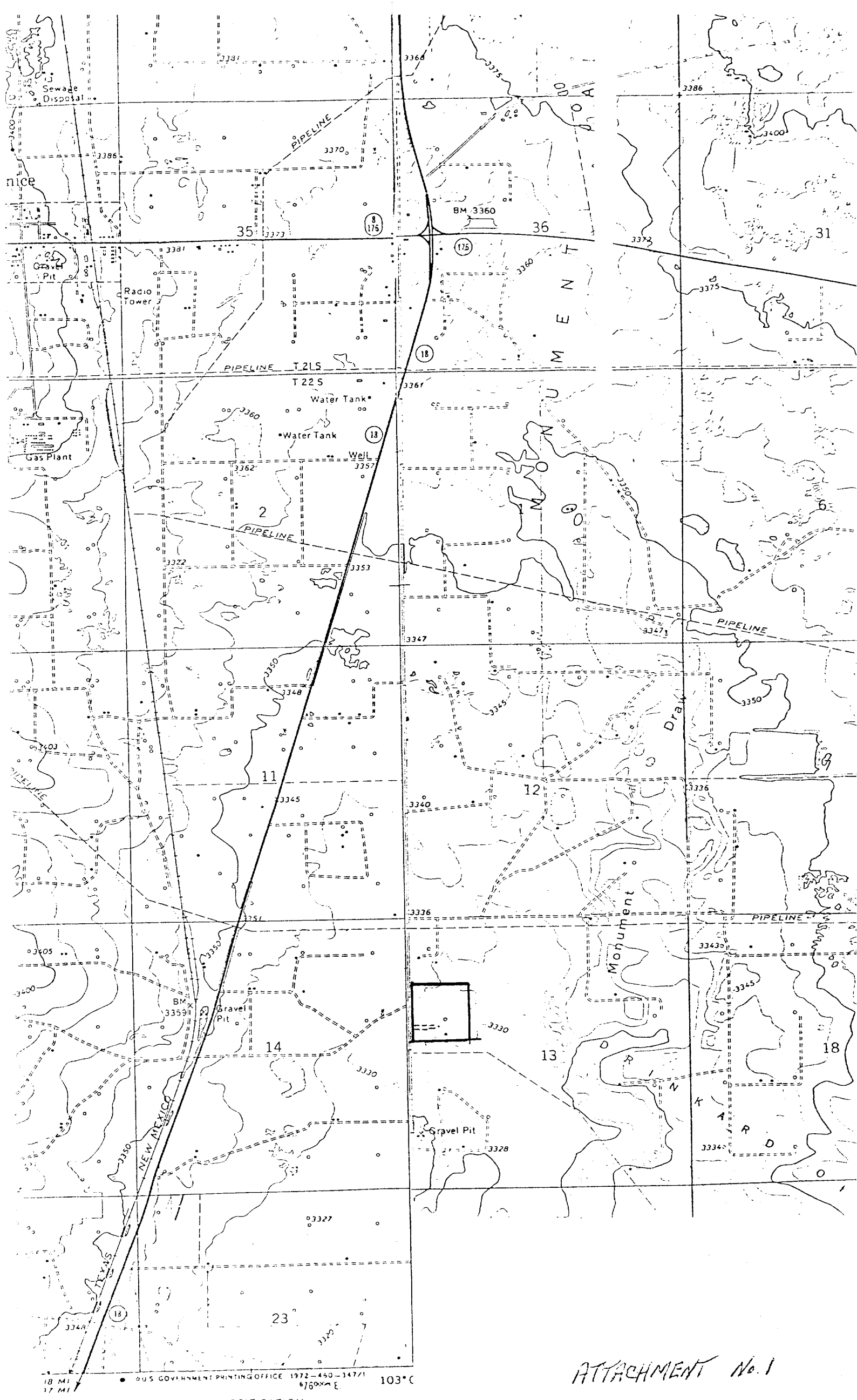

ATTACHMENT No. 1

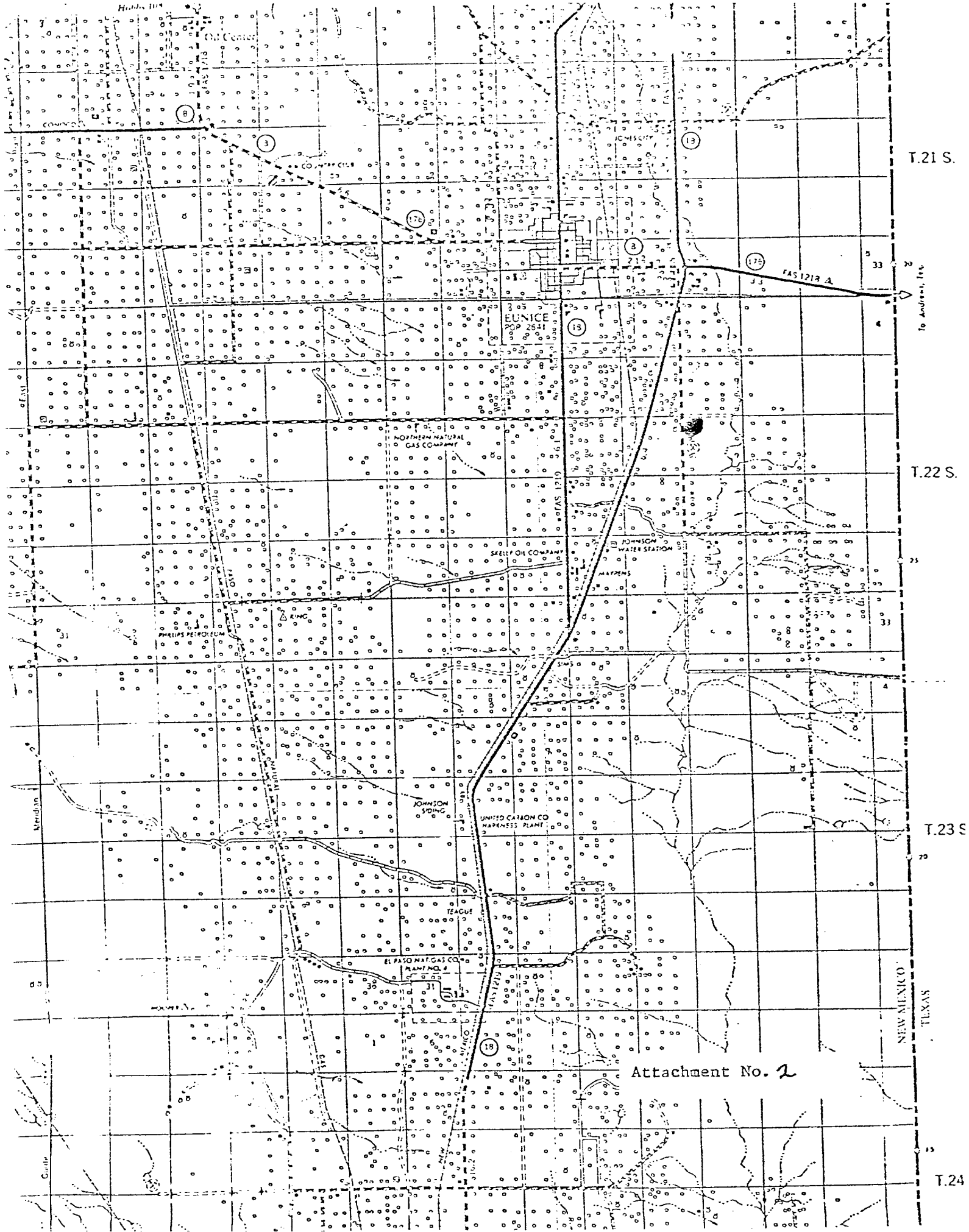

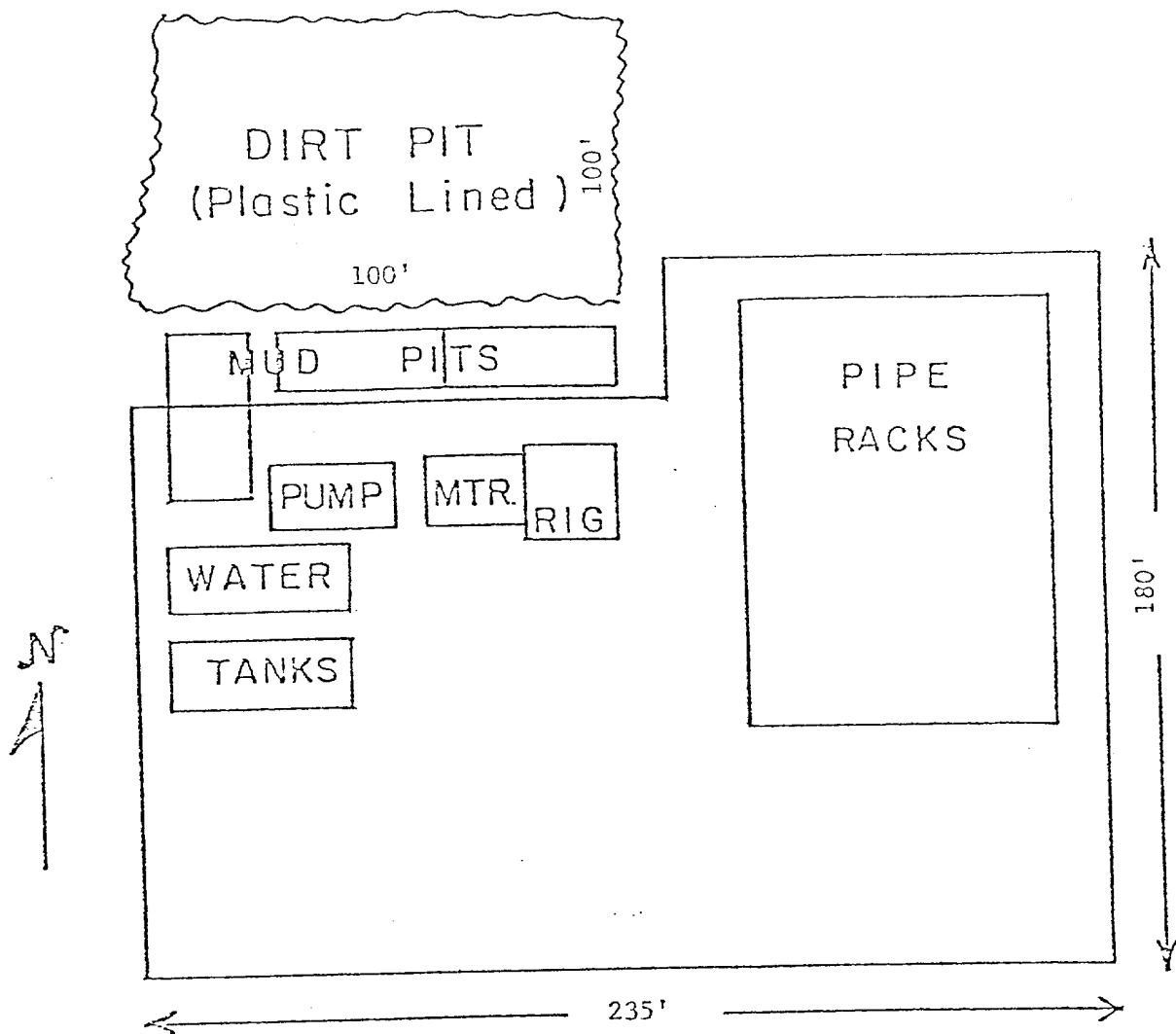

TOPOGRAPHY: Sandy rangeland. No nearby watercourse, streambed, or crops.

TEXAS PACIFIC OIL CO., INC.
 Elliott B-13 No. 2
 T-22-S, R-37-E
 Lea County, New Mexico
 510' FWL & 2100' FNL, Sec. 13