

NO. OF COPIES RECEIVED	
DISTRIBUTION	
SANTA FE	
FILE	
U.S.G.S.	
LAND OFFICE	
OPERATOR	

NEW MEXICO OIL CONSERVATION COMMISSION

Form C-101
Revised 1-1-65

5A. Indicate Type of Lease	
STATE <input type="checkbox"/>	FEE <input checked="" type="checkbox"/>

5. State Oil & Gas Lease No.

APPLICATION FOR PERMIT TO DRILL, DEEPEN, OR PLUG BACK

1a. Type of Work		7. Unit Agreement Name	
b. Type of Well DRILL <input checked="" type="checkbox"/> DEEPEN <input type="checkbox"/> PLUG BACK <input type="checkbox"/> OIL WELL <input type="checkbox"/> GAS WELL <input type="checkbox"/> OTHER <input type="checkbox"/> Disposal SINGLE ZONE <input type="checkbox"/> MULTIPLE ZONE <input type="checkbox"/>		8. Farm or Lease Name Blinebry-Drinkard SWD	
2. Name of Operator AGUA, INC.		9. Well No. A-22	
3. Address of Operator P. O. Box 1978 Hobbs, New Mexico 88240		10. Field and Pool, or Wildcat	
4. Location of Well UNIT LETTER <u>A</u> LOCATED <u>817</u> FEET FROM THE <u>North</u> LINE AND <u>965</u> FEET FROM THE <u>East</u> LINE OF SEC. <u>22</u> TWP. <u>22S</u> RGE. <u>37E</u> NMPM		12. County Lea	
21. Elevations (Show whether DF, RT, etc.) 3352.0' GL		19. Proposed Depth 5000'	19A. Formation San Andres
21A. Kind & Status Plug. Bond Blanket	21B. Drilling Contractor	20. Rotary or C.T. Rotary	
22. Approx. Date Work will start			

PROPOSED CASING AND CEMENT PROGRAM

SIZE OF HOLE	SIZE OF CASING	WEIGHT PER FOOT	SETTING DEPTH	SACKS OF CEMENT	EST. TOP
12-1/4"	9-5/8"	36#	315'	160	Circulated
8-3/4"	7"	20#	4000'	540	315'

- (1) Drill 12-1/4" hole to 320'. Set 9-5/8", 36#, K-55 ST&C csg. @ 315'. Cmt. w/160 sx. cmt. Circulate.
- (2) WOC 24 hrs.
- (3) Drill out from under surface string w/8-3/4" hole to 5000' T.D.
- (4) Swing 7", 20#, K-55 ST&C csg. @ 4000' w/pkr. shoe. Cement w/540 sx. cmt. to tie to surface casing. WOC 24 hrs. RUN TEMP SURELY
- (5) Drill out cement plug.
- (6) Treat OH (4000-5000') w/10,000 gals. 15% HCl.
- (7) Run 5-1/2", 15.50#, K-55, LT&C internally plastic-lined tubing to 4000'. Fill csg.-tbg. annulus w/inhibited oil.

APPROVAL VALID
FOR 90 DAYS UNLESS
DRILLING COMMENCED.

IN ABOVE SPACE DESCRIBE PROPOSED PROGRAM; IF PROPOSAL IS TO DEEPEN OR PLUG BACK, GIVE DATA ON PRESENT PRODUCTIVE ZONE AND PROPOSED NEW PRODUCTION. IF BLOWOUT PREVENTER PROGRAM, IF ANY.

I hereby certify that the information above is true and complete to the best of my knowledge and belief.

Signed W. G. Abbott Title Manager Date 1/7/76

(This space for State Use)

APPROVED BY [Signature] TITLE [Signature] DATE JAN 10 1976

CONDITIONS OF APPROVAL IF ANY:

MP

RECEIVED

JAN 8 1978

FIL CONSERVATION COMM.
HOBBS N. M.

NEW MEXICO OIL CONSERVATION COMMISSION
WELL LOCATION AND ACREAGE DEDICATION PLAT

Form C-102
Supersedes C-128
Effective 1-1-85

All distances must be from the outer boundaries of the Section

Owner Agua, Incorporated		Lease Blinebry-Drinkard SWD		Well A-22
Section A	Township 22	Range 22 South	Section 37 East	County Lea
Acreage of the Location of Well: 964.8 East line and 817 North line				
Original well No. 3352	Disposition Disposal	Formation San Andres	Pool	Estimated Acreage

- Outline the acreage dedicated to the subject well by colored pencil or hatchure marks on the plat below.
- If more than one lease is dedicated to the well, outline each and identify the ownership thereof (both as to working interest and royalty).
- If more than one lease of different ownership is dedicated to the well, have the interests of all owners been consolidated by communization, unitization, force-pooling, etc?

☐ Yes ☐ No If answer is "yes," type of consolidation _____

If answer is "no," list the owners and tract descriptions which have actually been consolidated. (Use reverse side of this form if necessary) _____

No allowable will be assigned to the well until all interests have been consolidated (by communization, unitization, forced-pooling, or otherwise) or until a non-standard unit, eliminating such interests, has been approved by the Commission.

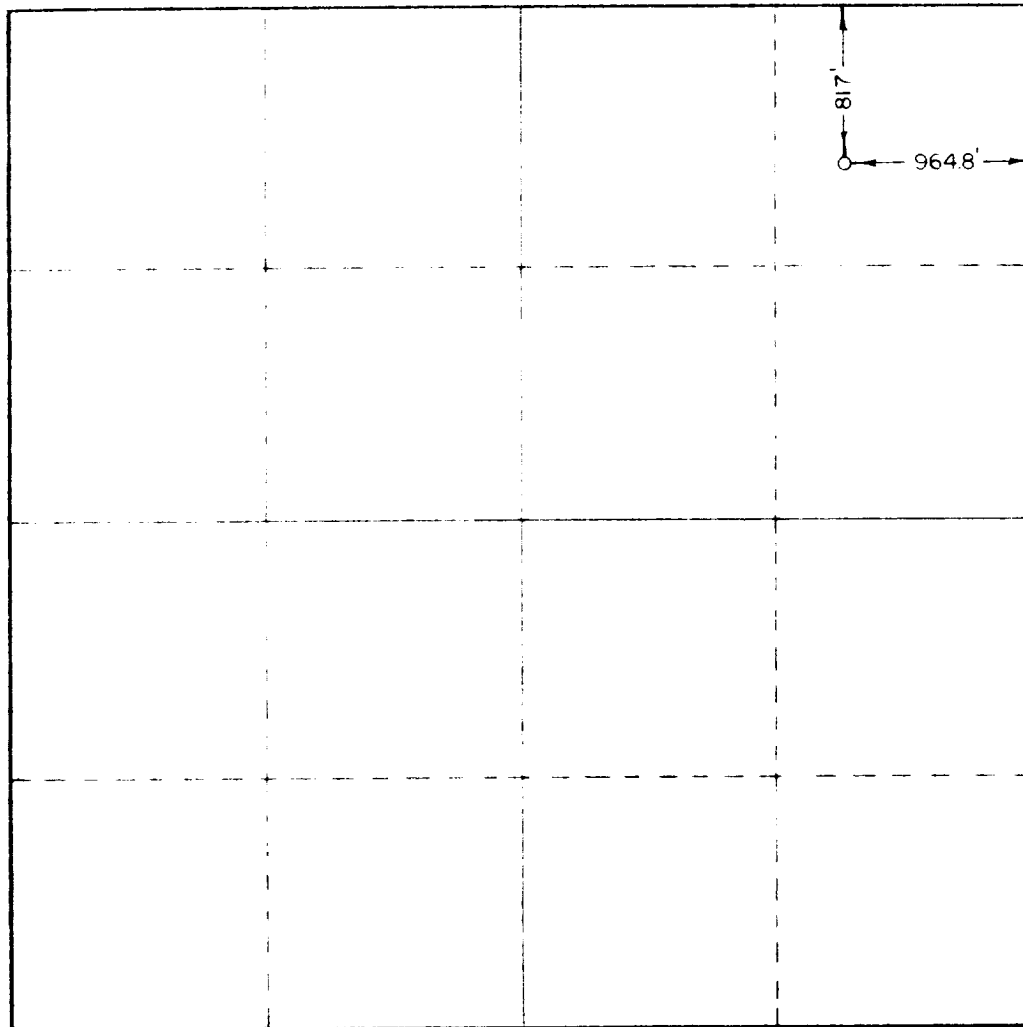

CERTIFICATION

I hereby certify that the information contained herein is true and complete to the best of my knowledge and belief.

W.B. Abbott

Name

Signature

Capacity

Date

I hereby certify that the well location shown on this plat was plotted from field notes of actual surveys made by me or under my supervision, and that the same is true and correct to the best of my knowledge and belief.

Date

October 18, 1975

Registered Professional Engineer and Land Surveyor

676

Certified

John W. West
JOHN W. WEST

RECEIVED

JAN 8 1976

THE CONSERVATION COMM.
WEDNES. R. M.

11
11
11