

NO. OF COPIES RECEIVED	
DISTRIBUTION	
SANTA FE	
FILE	
U.S.G.S.	
LAND OFFICE	
OPERATOR	

NEW MEXICO OIL CONSERVATION COMMISSION

Form C-101
Revised 1-1-65

AMENDED

5A. Indicate Type of Lease
STATE ☒ FEE ☐

5. State Oil & Gas Lease No.

B-934

APPLICATION FOR PERMIT TO DRILL, DEEPEN, OR PLUG BACK

1a. Type of Work b. Type of Well OIL WELL <input checked="" type="checkbox"/> GAS WELL <input type="checkbox"/> OTHER <input type="checkbox"/> SINGLE ZONE <input type="checkbox"/> MULTIPLE ZONE <input checked="" type="checkbox"/>		7. Unit Agreement Name	
2. Name of Operator EXXON CORPORATION		8. Farm or Lease Name New Mexico "S" State	
3. Address of Operator P. O. BOX 1600, MIDLAND, TEXAS 79701		9. Well No. 32	
4. Location of Well UNIT LETTER G LOCATED 2300 FEET FROM THE North LINE AND 1980 FEET FROM THE East LINE OF SEC. 2 TWP 22-S RGE. 37-E NMPM		10. Field and Pool, or Wildcat Drinkard & Wantz Abo	
12. County Lea			
19. Proposed Depth 7,300'		19A. Formation Drinkard & Abo	
20. Rotary or C.T. Rotary			
21. Elevations (Show whether DF, RT, etc.) To be filed later		21A. Kind & Status Plug. Bond Blanket on file	
21B. Drilling Contractor Warton Drilling Co.		22. Approx. Date Work will start September 15, 1976	

23. PROPOSED CASING AND CEMENT PROGRAM

SIZE OF HOLE	SIZE OF CASING	WEIGHT PER FOOT	SETTING DEPTH	SACKS OF CEMENT	EST. TOP
13-3/4"	10-3/4"	40.5#	1,200'	700	Circ. to surface
8-3/4"	7"	23 & 26#	7,200'	1,200	1,200*

* Circulate back into surface casing@ 1,200' to protect from corrosive water.

Howco method of cementing to be used. A diagrammatic sketch and specifications of Blowout Preventer equipment is attached.

Mud Program: 0 - 1,200' Fresh Water or Spud Mud
1,200 - 6,000' 10# Brine Water Mud
6,000 - T.D. 10.0# - 10.2# Brine Water Mud.

This amended permit is to request an extension of time for permit dated May 13, 1976.

IN ABOVE SPACE DESCRIBE PROPOSED PROGRAM: IF PROPOSAL IS TO DEEPEN OR PLUG BACK, GIVE DATA ON PRESENT PRODUCTIVE ZONE AND PROPOSED NEW PRODUCTIVE ZONE. GIVE BLOWOUT PREVENTER PROGRAM, IF ANY.

I hereby certify that the information above is true and complete to the best of my knowledge and belief.

Signed Melba Knippling Title Proration Specialist Date August 24, 1976

(This space for State Use)

APPROVED BY [Signature] TITLE SUPERVISOR DATE [Signature]
CONDITIONS OF APPROVAL, IF ANY:

Operator Exxon Corporation			Lease New Mexico "S" State		Well No. 32
Unit Letter G	Section 2	Township 22 South	Range 37 East	County Lea	
Actual Footage Location of Well: 2300 feet from the North line and 1980 feet from the West East line					
Ground Level Elev. _____	Producing Formation Drinkard and Abo		Pool Drinkard and Wantz Abo		Dedicated Acreage: 40 Acres

1. Outline the acreage dedicated to the subject well by colored pencil or hachure marks on the plat below.
2. If more than one lease is dedicated to the well, outline each and identify the ownership thereof (both as to working interest and royalty).
3. If more than one lease of different ownership is dedicated to the well, have the interests of all owners been consolidated by communitization, unitization, force-pooling, etc?

☐ Yes ☐ No If answer is "yes," type of consolidation _____

If answer is "no," list the owners and tract descriptions which have actually been consolidated. (Use reverse side of this form if necessary.) _____

No allowable will be assigned to the well until all interests have been consolidated (by communitization, unitization, forced-pooling, or otherwise) or until a non-standard unit, eliminating such interests, has been approved by the Commission.

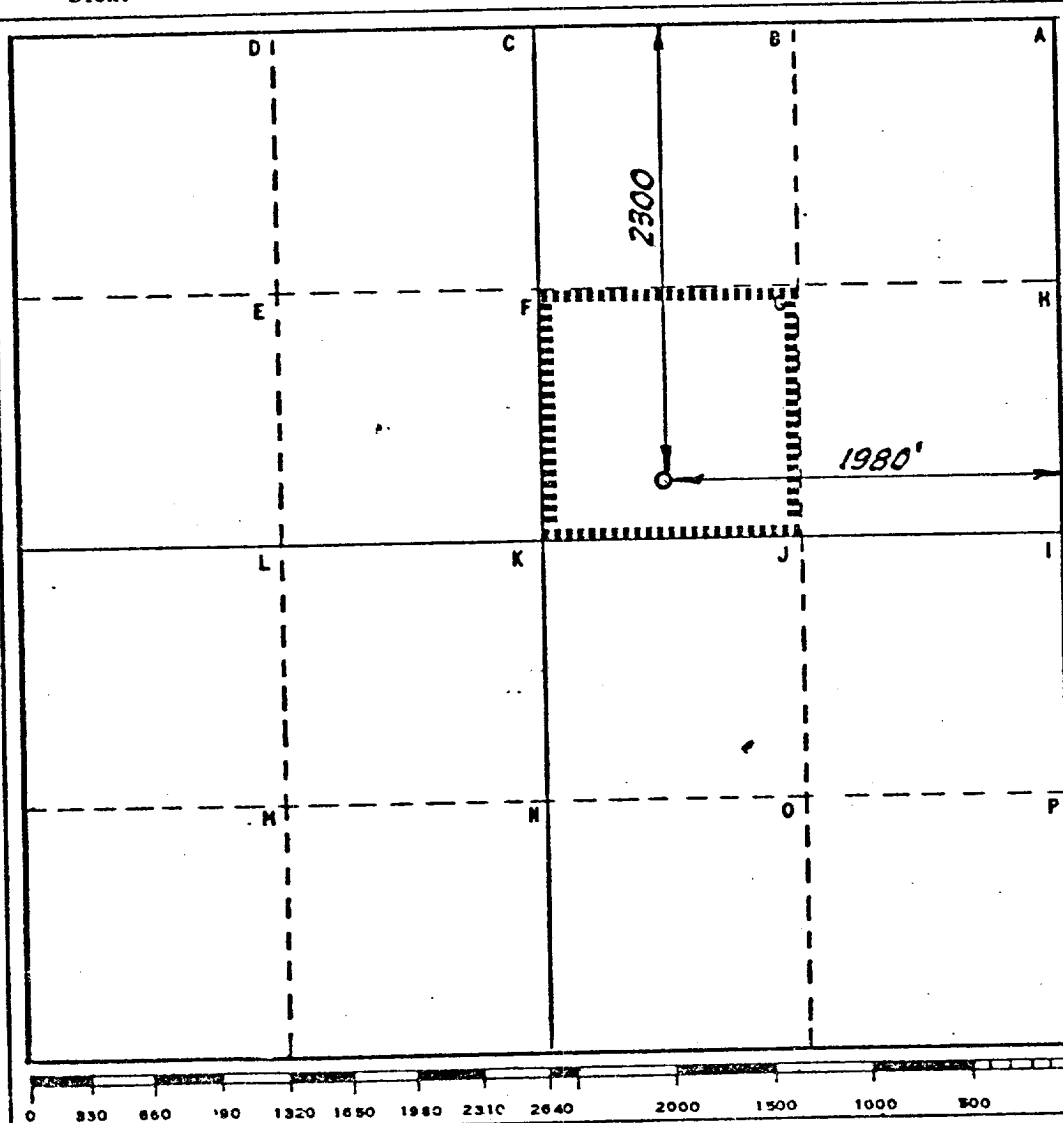

CERTIFICATION

I hereby certify that the information contained herein is true and complete to the best of my knowledge and belief.

Name Dr. Kripling
Position Proration Specialist
Company Exxon Corporation
Box 1600 Midland, Texas
Date 5-11-76

I hereby certify that the well location shown on this plat was plotted from field notes of actual surveys made by me or under my supervision, and that the same is true and correct to the best of my knowledge and belief.

Date Surveyed
5/10/76

Registered Professional Engineer
and/or Land Surveyor

M. S. Winterfeld
Certificate No.
1382

RECEIVED

APR 2 1968

ONE CENTRAL BANK ACCOUNT

BLOWOUT PREVENTER SPECIFICATION
EQUIPMENT DESCRIPTION

TYPE II-C

All equipment should be at least 2000 psi WP or higher unless otherwise specified.

1. Bell nipple.
2. Hydril or Shaffer bag type preventer.
3. Ram type pressure operated blowout preventer with blind rams.
4. Flanged spool with one 4-inch and one 2-inch (minimum) outlet.
5. 2-inch (minimum) flanged plug or gate valve.
6. 2-inch by 2-inch by 2-inch (minimum) flanged tee.
7. 4-inch pressure operated gate valve.
8. 4-inch flanged gate or plug valve.
9. Ram type pressure operated blowout preventer with pipe rams.
10. Flanged type casing head with one side outlet (furnished by Exxon).
11. 2-inch threaded (or flanged) plug or gate valve (furnished by Exxon).
Flanged on 5000# WP, threaded on 3000# WP or less.
12. Needle valve (furnished by Exxon).
13. 2-inch nipple (furnished by Exxon).
14. Tapped bull plug (furnished by Exxon).
15. 4-inch flanged spacer spool.
16. 4-inch by 2-inch by 2-inch by 2-inch flanged cross.
17. 2-inch flanged plug or gate valve.
18. 2-inch flanged adjustable choke.
19. 2-inch threaded flange.
20. 2-inch XXH nipple.
21. 2-inch forged steel 90° Ell.
22. Cameron (or equal.) threaded pressure gage.
23. Threaded flange.

35. 2-inch flanged tee.
36. 3-inch (minimum) hose. (Furnished by Exxon).
37. Trip tank. (Furnished by Exxon).
38. 2-inch flanged plug or gate valve.
39. 2-1/2-inch pipe, 300' to pit, anchored.
40. 2-1/2-inch SE valve.
41. 2-1/2-inch line to steel pit or separator.

NOTES:

1. Items 3, 4 and 9 may be replaced with double ram type preventer with side outlets between the rams.
2. The two valves next to the stack on the fill and kill line to be closed unless drill string is being pulled.
3. Kill line is for emergency use only. This connection shall not be used for filling.
4. Replacement pipe rams and blind rams shall be on location at all times.
5. Only type U, LWS and QRC ram type preventers with secondary seals are acceptable for 5000 psi WP and higher BOP stacks.
6. Type E ram-type BOP's with factory modified side outlets may be used on 3000 psi or lower WP BOP stacks.

RECEIVED

APR 27 1978

OL COMPANY CO.

MIDLAND DRILLING ORGANIZATION
 BLOWOUT PREVENTER SPECIFICATION
 TYPE II - C

