

30-160-1111

NEW MEXICO OIL CONSERVATION COMMISSION

Form C-101
Revised 1-1-65

COPIES RECEIVED	
DISTRIBUTION	
SANITARY	
FILE	
U.S.S.	
LAND OFFICE	
OPERATOR	

APPLICATION FOR PERMIT TO DRILL, DEEPEN, OR PLUG BACK

1. Type of Work DRILL <input checked="" type="checkbox"/> DEEPEN <input type="checkbox"/> PLUG BACK <input type="checkbox"/>		5A. Indicate Type of Lease STATE <input type="checkbox"/> FEE <input checked="" type="checkbox"/>			
2. Name of Well GAS WELL <input type="checkbox"/> OTHER <input type="checkbox"/>		5. State Oil & Gas Lease No. -----			
3. Name of Operator Skelly Oil Company		7. Unit Agreement Name -----			
4. Address of Operator P. O. Box 1351, Midland, Texas 79701		8. Farm or Lease Name E. N. Grizzell			
4. Location of Well UNIT LETTER G LOCATED 1880 FEET FROM THE North LINE AND 2090 FEET FROM THE East LINE OF SEC. 6 T.22S R.35E S.37E NMPM		9. Well No. 2			
21. Elevation (Show whether DF, RT, etc.) 3446' GR		10. Field and Pool, or Wildcat Drinkard			
21A. Kind & Status Plug. Bond Blanket Bond #1253688 \$100,000 w/Fed. Ins. Co.		12. County Lea			
21B. Drilling Contractor		20. Rotary or C.T. Rotary			
22. Approx. Date Work will start 6-24-76					
SIZE OF HOLE	SIZE OF CASING	WEIGHT PER FOOT	SETTING DEPTH	SACKS OF CEMENT	EST. TOP
11"	8-5/8" OD	24#	1200'	250 sacks	Surface
6-1/2"	5-1/2" OD	15.5#	6800'	370 sacks	Surface

It is proposed to drill subject well from surface to a total depth of approximately 6800' with rotary tools to test the Drinkard formation for oil. The pump and plug process will be used for cementing all strings of casing, and cement will be circulated to the surface on the 8-5/8" OD casing and 5-1/2" OD casing which will have a DV tool set at approximately 3800'. The 5-1/2" OD casing will be perforated as indicated by electric logs opposite the Drinkard formation.

The drilling fluid will be brine water and mud of sufficient weight to condition hole for logging and running casing to 6800'. Blow out preventors will be installed and tested to 5000# pressure. (This is not a high pressure gas area.)

APPROVAL VALID
FOR 90 DAYS UNLESS
DRILLING COMMENCED,

EXPIRES 9-14-76

IN ABOVE SPACE DESCRIBE PROPOSED PROGRAM: IF PROPOSAL IS TO DEEPEN OR PLUG BACK, GIVE DATA ON PRESENT PRODUCTIVE ZONE AND PROPOSED NEW PRODUCTIVE ZONE. GIVE BLOWOUT PREVENTER PROGRAM, IF ANY.

I hereby certify that the information above is true and complete to the best of my knowledge and belief.

(SIGNED) LELAND FRANZ

Leland Franz

Title District Production Manager

Date 6-10-76

Signed

(This space for State Use)

APPROVED BY

CONDITIONS OF APPROVAL, IF ANY:

TITLE

DATE

SUPERVISOR

NEW MEXICO OIL CONSERVATION COMMISSION
WELL LOCATION AND ACREAGE DEDICATION PLAT

Form C-104
 Supersedes C-128
 Effective 1-1-65

All distances must be from the outer boundaries of the Section

Operator Skelly Oil Company			Lease E.N. Grizzell		Well No. 2
Unit Letter G	Section 6	Township 22 South	Range 37 East	County Lea	
Actual Footage Location of Well:					
1880	feet from the	North	line and	2090	feet from the East line
Ground Level Elev. 3445.7	Producing Formation Drinkard		Pool Drinkard	Dedicated Acreage 40 Acres	

1. Outline the acreage dedicated to the subject well by colored pencil or hatchure marks on the plat below.
2. If more than one lease is dedicated to the well, outline each and identify the ownership thereof (both as to working interest and royalty).
3. If more than one lease of different ownership is dedicated to the well, have the interests of all owners been consolidated by communization, unitization, force-pooling, etc?

☐ Yes ☐ No If answer is "yes," type of consolidation _____

If answer is "no," list the owners and tract descriptions which have actually been consolidated (Use reverse side of this form if necessary.) _____

No allowable will be assigned to the well until all interests have been consolidated (by communization, unitization, forced-pooling, or otherwise) or until a non-standard unit, eliminating such interests, has been approved by the Commission.

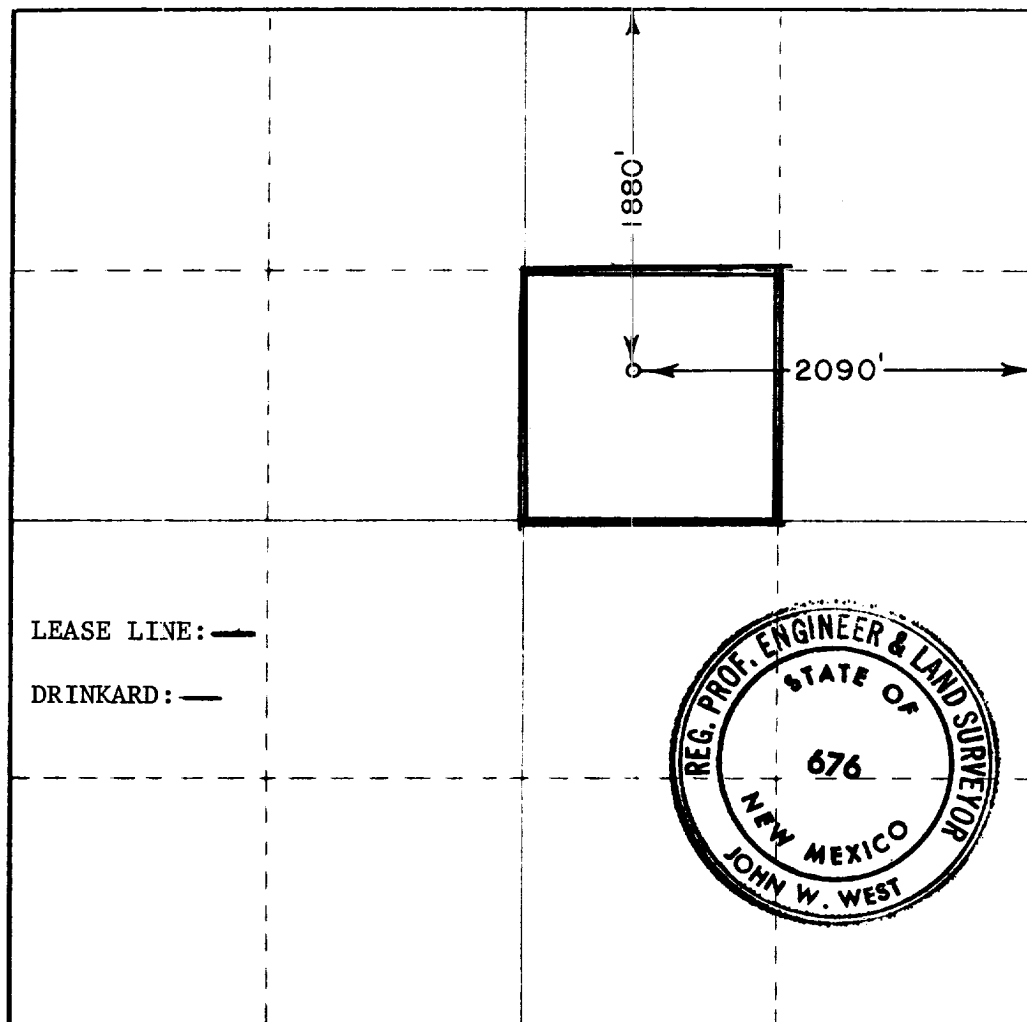

CERTIFICATION

I hereby certify that the information contained herein is true and complete to the best of my knowledge and belief.

(signed) D. R. Crow

Name D. R. Crow
Position Lead Clerk
Company Skelly Oil Company
Date June 10, 1976

I hereby certify that the well location shown on this plat was plotted from field notes of actual surveys made by me or under my supervision, and that the same is true and correct to the best of my knowledge and belief.

Date Surveyed June 8, 1976
Registered Professional Engineer and/or Land Surveyor

John W. West
 Certificate No. _____

676

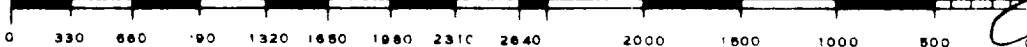

RECEIVED

JUN 11 1964

U.S. CONSERVATION COMMISSION
WASH DC

SKELLY OIL COMPANY
E. N. GRIZZELL NO. 2
5000 PSI WORKING PRESSURE
DRILLING CONTROL HOOK-UP

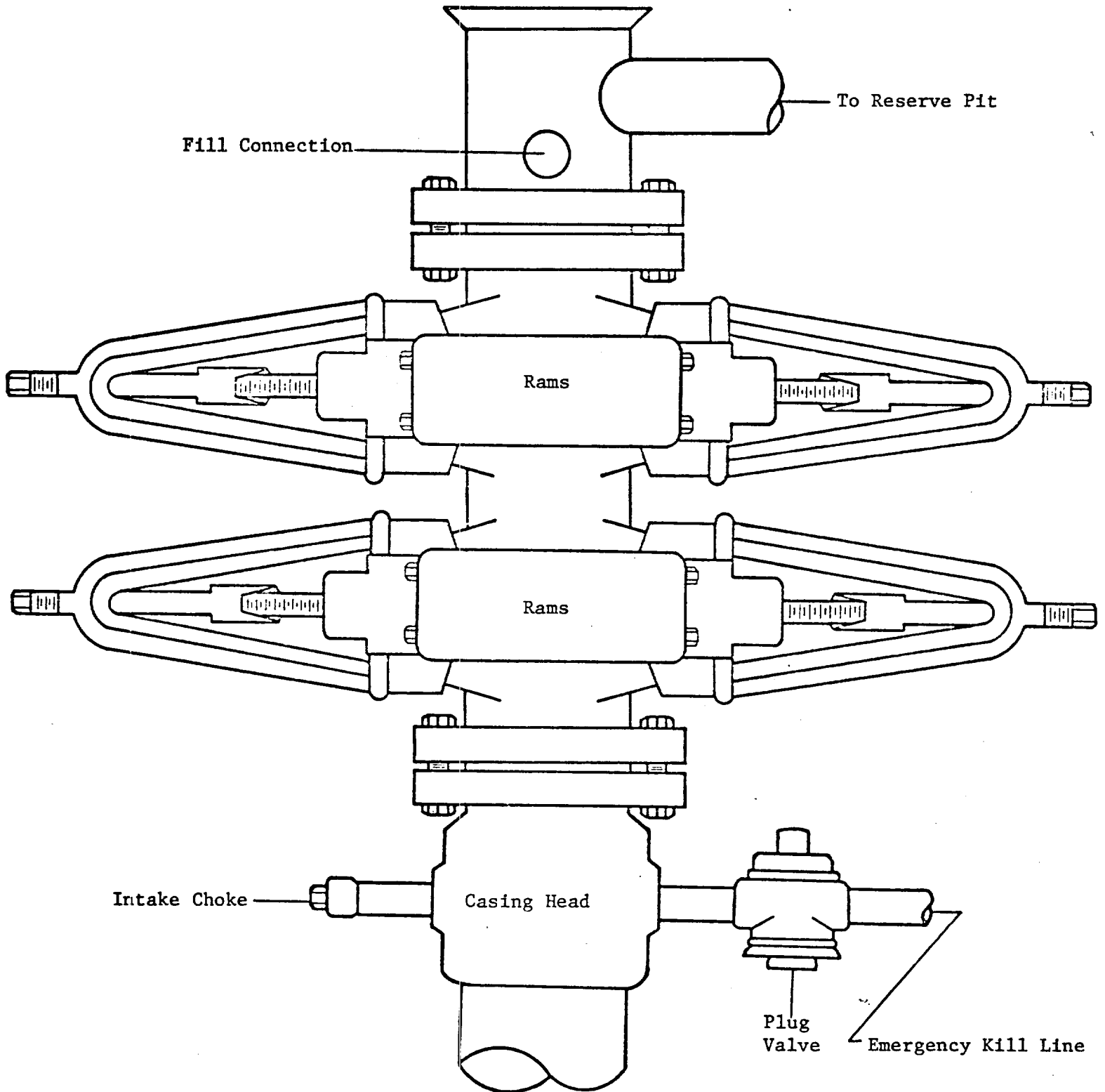

RECEIVED

U.S. CONSERVATION COMMISSION
WASHINGTON, D.C.

173