

NO. OF COPIES RECEIVED	
DISTRIBUTION	
SANTA FE	
FILE	
U.S.G.S.	
LAND OFFICE	
OPERATOR	

NEW MEXICO OIL CONSERVATION COMMISSION

Form C-101
Revised 1-1-65

5A. Indicate Type of Lease
STATE <input checked="" type="checkbox"/> FEE <input type="checkbox"/>
5. State Oil & Gas Lease No.
E 5076

APPLICATION FOR PERMIT TO DRILL, DEEPEN, OR PLUG BACK

1a. Type of Work		7. Unit Agreement Name	
b. Type of Well OIL WELL <input type="checkbox"/> GAS WELL <input checked="" type="checkbox"/> OTHER <input type="checkbox"/>		8. Farm or Lease Name	
2. Name of Operator		9. Well No.	
3. Address of Operator		10. Field and Pool, or Wildcat	
4. Location of Well		12. County	
UNIT LETTER I LOCATED 1980 FEET FROM THE SOUTH LINE		Lea.	
AND 660' FEET FROM THE EAST LINE OF SEC. 36 TWP. 23S RGE. 33E NMPM			
19. Proposed Depth		19A. Formation	
13,650'		MORROW	
20. Rotary or C.T.		ROTARY	
21. Elevations (Show whether DF, RT, etc.)		22. Approx. Date Work will start	
3635.6 GL		8-1-76	

PROPOSED CASING AND CEMENT PROGRAM

SIZE OF HOLE	SIZE OF CASING	WEIGHT PER FOOT	SETTING DEPTH	SACKS OF CEMENT	EST. TOP
20"	16"	65#	600'	600	Circ
14 3/4"	10 3/4"	45.5#	5,400'	2750	Circ
9 1/2"	7 5/8"	33.7#	12,200'	1400	5200'
6 1/2"	5" LINER	18.0#	13,650'	250	12,000'

IT IS PROPOSED to drill a straight hole to a TD OF 13,650' and complete as a Morrow Gas well.

The Acreage is dedicated to a Gas Purchaser.

IN ABOVE SPACE DESCRIBE PROPOSED PROGRAM: IF PROPOSAL IS TO DEEPEN OR PLUG BACK, GIVE DATA ON PRESENT PRODUCTIVE ZONE AND PROPOSED NEW PRODUCTIVE ZONE. GIVE BLOWOUT PREVENTER PROGRAM, IF ANY.

I hereby certify that the information above is true and complete to the best of my knowledge and belief.

Signed Wm. A. Butterfield Title ADMIN. SUPERVISOR Date 6-21-76

(This space for State Use)

APPROVED BY [Signature] TITLE DISTRICT I DATE JUN 25 1976

CONDITIONS OF APPROVAL, IF ANY:

NOM CC-6, Exxon, Lowe, Phillips, Bass, Tripdor, File

RECEIVED

JUN 28 1976

GE CONSERVATION COMM.
HOBBS, R. M.

NEW MEXICO OIL CONSERVATION COMMISSION
WELL LOCATION AND ACREAGE DEDICATION PL.

Form C-102
Supersedes C-128
Effective 1-1-65

All distances must be from the outer boundaries of the Section

Operator CONTINENTAL OIL COMPANY			Lease BELL LAKE		Well No. 18
Unit Letter I	Section 36	Township 23 SOUTH	Range 33 EAST	County LEA	

Actual Footage Location of Well:							
1980	feet from the	SOUTH	line and	660	feet from the	EAST	line
Ground Level Elev. 3635.6	Producing Formation MORROW		Pool SOUTH BELL LAKE MORROW	Estimated Acreage 3.20		Acres	

1. Outline the acreage dedicated to the subject well by colored pencil or hatchure marks on the plat below.
2. If more than one lease is dedicated to the well, outline each and identify the ownership thereof (both as to working interest and royalty).
3. If more than one lease of different ownership is dedicated to the well, have the interests of all owners been consolidated by communitization, unitization, force-pooling, etc?

☐ Yes ☐ No If answer is "yes," type of consolidation _____

If answer is "no," list the owners and tract descriptions which have actually been consolidated (Use reverse side of this form if necessary.) _____

No allowable will be assigned to the well until all interests have been consolidated (by communitization, unitization, forced-pooling, or otherwise) or until a non-standard unit, eliminating such interests, has been approved by the Commission.

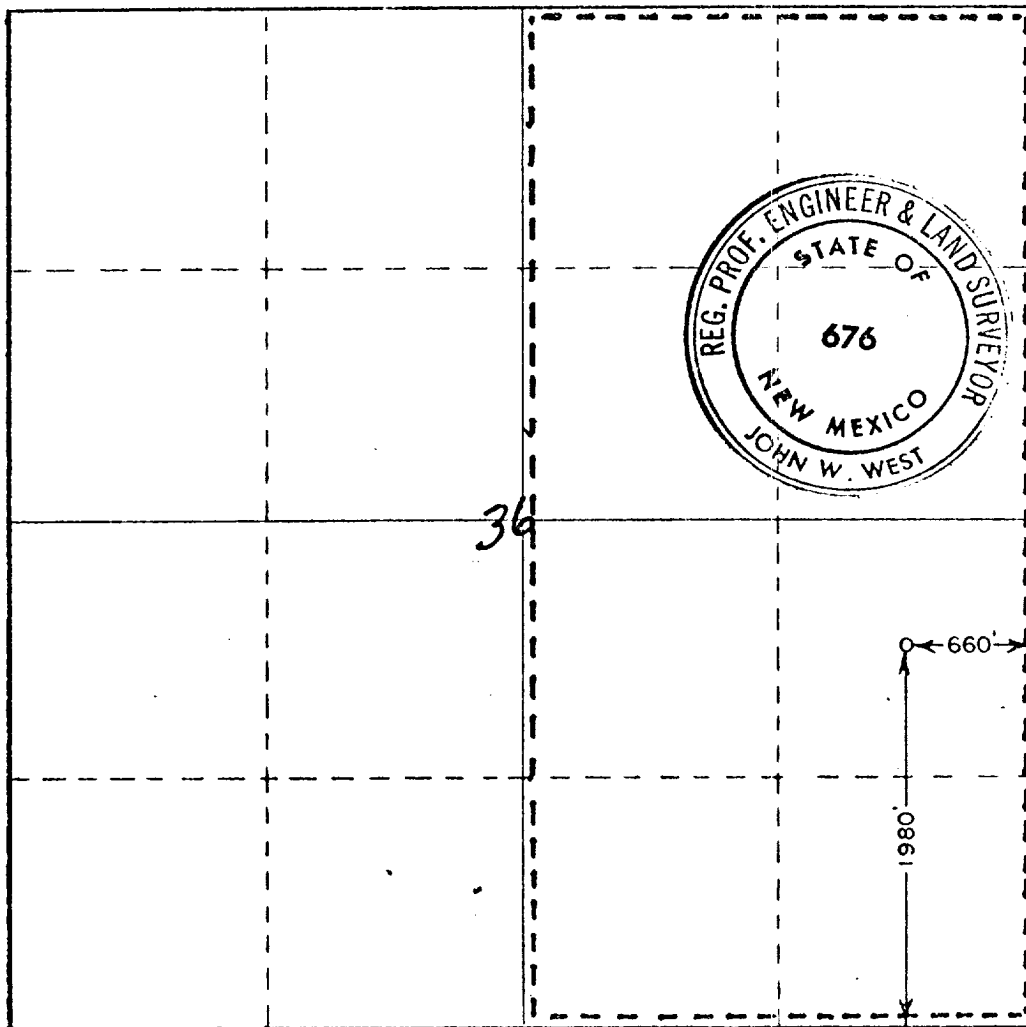

CERTIFICATION

I hereby certify that the information contained herein is true and complete to the best of my knowledge and belief.

Name *Wm. A. Butterfield*
Position *ADMIN. SUPERVISOR*
Company *Continental Oil Co.*
Date *6-21-76*

I hereby certify that the well location shown on this plat was plotted from field notes of actual surveys made by me or under my supervision, and that the same is true and correct to the best of my knowledge and belief.

Date Surveyed

JUNE 15, 1976

Registered Professional Engineer
and/or Land Surveyor

John W. West
676

0 330 660 990 1320 1650 1980 2310 2640 2970 3300 3630 3960 4290 4620 4950 5280 5610 5940 6270 6600

RECEIVED

JUN 26 1976

OIL CONSERVATION COMM.
HOBBS, N. M.

111