

NO. OF COPIES RECEIVED		
DISTRIBUTION		
SANTA FE		
FILE		
U.S.G.S.		
LAND OFFICE		
OPERATOR		

NEW MEXICO OIL CONSERVATION COMMISSION

Form C-101
Revised 14-65

5A. Indicate Type of Lease	
STATE <input type="checkbox"/>	FEE <input checked="" type="checkbox"/>
5. State Oil & Gas Lease No.	

APPLICATION FOR PERMIT TO DRILL, DEEPEN, OR PLUG BACK

1a. Type of Work		7. Unit Agreement Name	
b. Type of Well OIL WELL <input checked="" type="checkbox"/> CAS WELL <input type="checkbox"/> OTHER <input type="checkbox"/>		8. Farm or Lease Name Lou Worthan	
2. Name of Operator Marathon Oil Company		9. Well No. 16	
3. Address of Operator P. O. Box 2409, Hobbs, New Mexico 88240		10. Field and Pool, or Wildcat Wantz Granite Wash	
4. Location of Well UNIT LETTER B LOCATED 330 FEET FROM THE North LINE AND 1980 FEET FROM THE East LINE OF SEC. 11 TWP. 22S RGE. 37E NMPM		12. County Lea	
19. Proposed Depth 7750'		19A. Formation Granite Wash	
20. Rotary or C.T. Rotary		21. Elevations (Show whether DF, RT, etc.) 3357.5 GR	
21A. Kind & Status Plug. Bond Current		21B. Drilling Contractor Capitan	
22. Approx. Date Work will start 11-4-76			

23.

PROPOSED CASING AND CEMENT PROGRAM

SIZE OF HOLE	SIZE OF CASING	WEIGHT PER FOOT	SETTING DEPTH	SACKS OF CEMENT	EST. TOP
12 1/4"	9 5/8"	32.3	1250'	650	Circulate
8 3/4"	7"	23	7750'*	2450	Circulate

Plan to drill to approximately 7750'.

Cement and test all casing by approved methods.

Blow out equipment to be used is 900 Series Cameron or equivalent with pipe and blank rams. Remote BOP controls will be located on derrick floor with closing unit a minimum of 75' from the wellhead.

*With D.V. tool at approximately 4500'.

IN ABOVE SPACE DESCRIBE PROPOSED PROGRAM; IF PROPOSAL IS TO DEEPEN OR PLUG BACK, GIVE DATA ON PRESENT PRODUCTIVE ZONE AND PROPOSED NEW PRODUCTIVE ZONE; GIVE BLOWOUT PREVENTER PROGRAM, IF ANY.

I hereby certify that the information above is true and complete to the best of my knowledge and belief.

Signed William D. Holmes Title Petroleum Engineer Date November 1, 1976

(This space for State Use)

APPROVED BY Gerry Skelton TITLE

DATE

CONDITIONS OF APPROVAL, IF ANY:

RECEIVED

APR 1 1976

OIL CONSERVATION COMM.
HOBBS, N. M.

NEW MEXICO OIL CONSERVATION COMMISSION
WELL LOCATION AND ACREAGE DEDICATION PLAT

Form O-102
Supersedes O-128
Effective 1-1-65

All distances must be from the outer boundaries of the Section

Operator MARATHON OIL COMPANY			Lease Lou Wortham		Well No. 16
Section B	Section 11	Township 22 South	Range 37 East	County Lea	
A. Section Containing Location of Well					
330	feet from the	north	line and	1980	feet from the east line
Ground Level Elev. 3357.5	Existing Formation Granite Wash		Pool Wantz Granite Wash	Dedicated Acreage 40 Acres	

1. Outline the acreage dedicated to the subject well by colored pencil or hatchure marks on the plat below.
2. If more than one lease is dedicated to the well, outline each and identify the ownership thereof (both as to working interest and royalty).
3. If more than one lease of different ownership is dedicated to the well, have the interests of all owners been consolidated by communitization, unitization, force-pooling, etc?

☒ Yes ☐ No If answer is "yes," type of consolidation _____

If answer is "no," list the owners and tract descriptions which have actually been consolidated. (Use reverse side of this form if necessary.) _____

No allowable will be assigned to the well until all interests have been consolidated (by communitization, unitization, forced-pooling, or otherwise) or until a non-standard unit, eliminating such interests, has been approved by the Commission.

R-37E

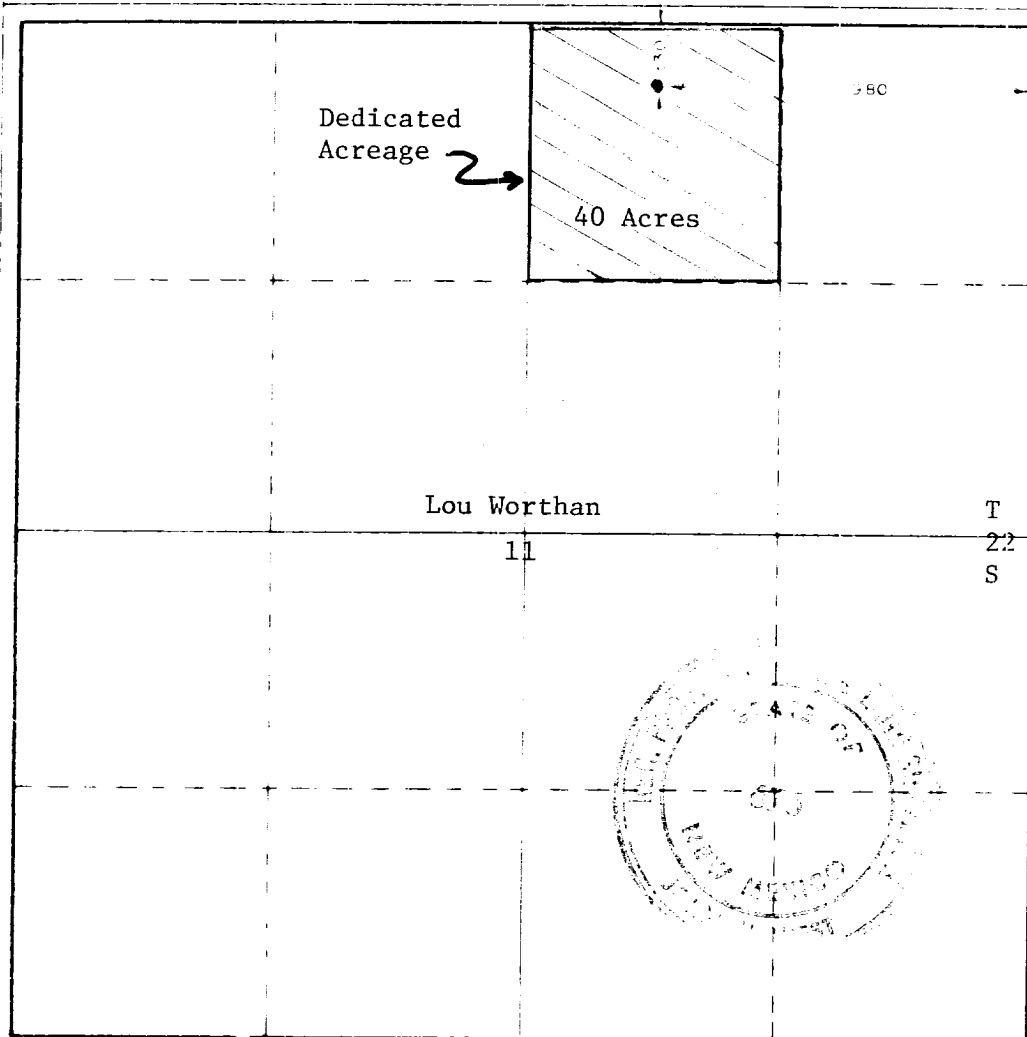

CERTIFICATION

I hereby certify that the information contained herein is true and complete to the best of my knowledge and belief.

William D. Holmes

William D. Holmes

Petroleum Engineer

Marathon Oil Company

November 1, 1976

I hereby certify that the well location shown on this plat was plotted from field notes of actual surveys made by me or under my supervision, and that the same is true and correct to the best of my knowledge and belief.

Oct. 28, 1976

Registered Professional Engineer and Professional Surveyor

John W. West

676

330 660 990 1320 1650 1980 2310 2640 2970 3300 3630 3960 4290 4620 4950 5280 5610 5940 6270 6600 6930 7260 7590 7920 8250 8580 8910 9240 9570 9900

