

Submit to Appropriate
District Office
State Lease - 4 copies
Fee Lease - 3 copies

State of New Mexico
Energy, Minerals and Natural Resources Department

Form C-16
Revised 1-89

OIL CONSERVATION DIVISION

P.O. Box 2088
Santa Fe, New Mexico 87504-2088

DISTRICT I
P.O. Box 1980, Hobbs, NM 88240

DISTRICT II
P.O. Drawer DD, Artesia, NM 88210

DISTRICT III
1000 Rio Brazos Rd., Aztec, NM 87410

WELL LOCATION AND ACREAGE DEDICATION PLAT

All Distances must be from the outer boundaries of the section

Operator Texaco Exploration & Production Inc.			Lease SDE 18 Federal		Well No. 1
Unit Letter C	Section 18	Township 23S	Range 32E	County NMPM	Lea
Actual Footage Location of Well: 990' feet from the North line and 1980' feet from the West line					
Ground level Elev. 3555'		Producing Formation Brushy Canyon		Pool East Sand Dunes-Deleware	Dedicated Acreage: 40 Acres

1. Outline the acreage dedicated to the subject well by colored pencil or hachure marks on the plat below.

2. If more than one lease is dedicated to the well, outline each and identify the ownership thereof (both as to working interest and royalty).

3. If more than one lease of different ownership is dedicated to the well, have the interest of all owners been consolidated by communitization, unitization, force-pooling, etc.?

☐ Yes

☒ No

If answer is "yes" type of consolidation

If answer is "no" list the owners and tract descriptions which have actually been consolidated. (Use reverse side of this form if necessary.)

No allowable will be assigned to the well until all interests have been consolidated (by communitization, unitization, forced-pooling, or otherwise) or until a non-standard unit, eliminating such interest, has been approved by the Division.

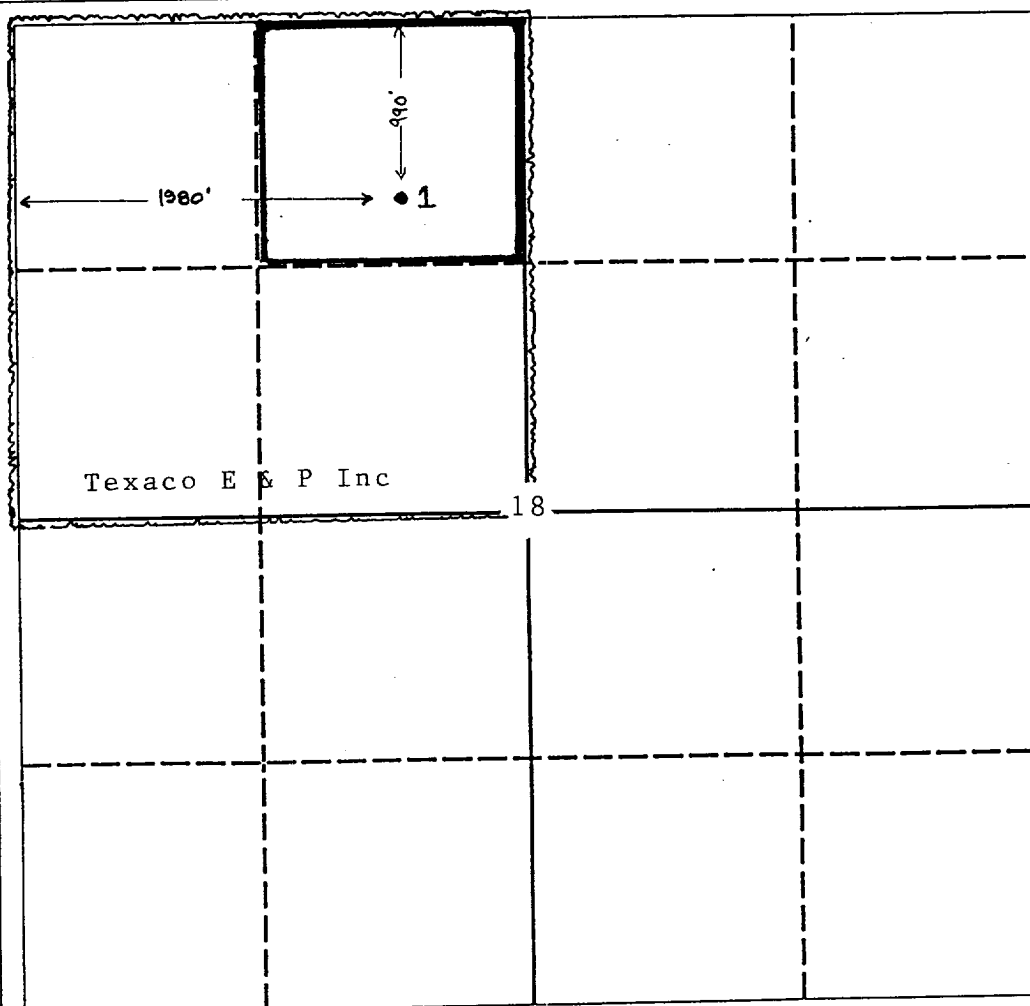

OPERATOR CERTIFICATION

I hereby certify that the information contained herein is true and complete to the best of my knowledge and belief.

Signature

L.W. Johnson

Printed Name

L.W. Johnson

Position

Engr. Asst.

Company

Texaco E & P Inc.

Date

3-1-93

SURVEYOR CERTIFICATION

I hereby certify that the well location shown on this plat was plotted from field notes of actual surveys made by me or under my supervision, and that the same is true and correct to the best of my knowledge and belief.

Date Surveyed

Signature & Seal of
Professional Surveyor

Certificate No.

RECEIVED

MAR 02 1993

OCD HORRIS OFFICE

COUNTY LEA Undesignated STATE NM
 OPR GETTY OIL CO. API 30-025-25622
 NO 1 LEASE SDE-18 Federal MAP
 Sec 18, T23S, R32E CO-ORD
 990 FNL, 1980 FWL of Sec 6-3-40 NM
 15 mi SE/Halfway SPD 11-7-79 CMP 12-27-79

CSG

11 3/4-966-600 SX
 8 5/8-4650-2000 SX
 5 1/2-9300-1600 SX
 2 7/8-8501

WELL CLASS: INIT D FIN DO LSE CODE			
FORMATION	DATUM	FORMATION	DATUM
ID 9300 (WFMP)		PBD	

IP (Bone Spring) Perfs 8602-9098 F 52 BOPD. Pot based on 24
 hr test thru (NR) chk. GOR 692; gty 40; CP Pkr; TP 150

CONTR OPR SELIV 3555 GL sub-s NA

6-15-81 F.S.C. 6-20-81
 PD 9100 RT (Bone Spring)
 (Formerly Aban. Loc. 1-1-79)
 ID 9300; Complete
 Perf (Bone Spring) @ 8602, 8606, 8610, 8628, 8640,
 8644, 8656, 8661, 8671, 8677, 8743, 8747, 8776,
 8780, 8888, 8945, 8950, 8966, 8969, 8976, 8980,
 8990, 8994, 9010, 9014, 9030, 9045, 9058,
 9066, 9074, 9080, 9098 w/l SPI
 Ac10 (8602-9098) 7000 gals
 17.25 (8602-9098) 75,000 gals + 98,250# sd
 LOC WOPS: Rustler 913, Delaware 4580, Cherry
 Canyon 5672, Brushy Canyon 6789, Bone Spring 8501
 LOGS WGN: ONDL, DILL, MICL, SONL, FOCL, BSL, GEND,
 5V1
 6-20-81 COMPLETION ISSUED

6-3-40 NM
 IC 30-025-70307-81