

Submit 3 Copies  
to Appropriate  
District Office

State of New Mexico  
Energy, Minerals and Natural Resources Department  
**OIL CONSERVATION DIVISION**

Form C-103  
Revised 1-1-89

P.O. Box 2088

Santa Fe, New Mexico 87504-2088

DISTRICT I

P.O. Box 1880, Hobbs, NM 88240

DISTRICT II

P.O. Drawer Dd, Artesia, NM 88210

DISTRICT III

1000 Rio Brazos Rd., Aztec, Nm 87410

<b>SUNDRY NOTICES AND REPORTS ON WELLS</b> (DO NOT USE THIS FORM FOR PROPOSALS TO DRILL OR TO DEEPEN OR PLUG BACK DIFFERENT RESERVOIR. USE "APPLICATION FOR PERMIT" (FORM C-101) FOR SUCH PROPOSALS.)	
1. Type of Well: OIL WELL <input checked="" type="checkbox"/> GAS WELL <input type="checkbox"/> OTHER <input type="checkbox"/>	
2. Name of Operator CHEVRON U.S.A. INC.	
3. Address of Operator P.O. BOX 1150 MIDLAND, TX 79702 ATTN: NITA RICE	
4. Well Location Unit Letter <u>D</u> : <u>560</u> Feet From The <u>NORTH</u> Line and <u>810</u> Feet From The <u>WEST</u> Line Section <u>18</u> Township <u>22S</u> Range <u>37E</u> NMPM <u>LEA</u> County	
10. Elevation(Show whether DF, RKB, RT, GR, etc.) <u>3433' GR</u>	

API NO. (assigned by OCD on New Wells) <b>30-025-25645</b>
5. Indicate Type of Lease STATE <input type="checkbox"/> FEE <input checked="" type="checkbox"/>
6. State Oil & Gas Lease No. N/A
7. Lease Name or Unit Agreement Name A. L. CHRISTMAS (NCT-C)
8. Well No. 14
9. Pool name or Wildcat BLINEBRY

11. Check Appropriate Box to Indicate Nature of Notice, Report, or Other Data	
<b>NOTICE OF INTENTION TO:</b> PERFORM REMEDIAL WORK <input type="checkbox"/> PLUG AND ABANDON <input type="checkbox"/> TEMPORARILY ABANDON <input type="checkbox"/> CHANGE PLANS <input type="checkbox"/> PULL OR ALTER CASING <input type="checkbox"/> OTHER: <input type="checkbox"/>	<b>SUBSEQUENT REPORT OF:</b> REMEDIAL WORK <input type="checkbox"/> ALTER CASING <input type="checkbox"/> COMMENCE DRILLING OPNS. <input type="checkbox"/> PLUG AND ABAN. <input type="checkbox"/> CASING TEST AND CMT JOB <input type="checkbox"/> OTHER: <u>PLUG BACK TO BLINEBRY &amp; P&amp;A DRINKARD</u> <input checked="" type="checkbox"/>

12. Describe Proposed or Completed Operations(Clearly state all pertinent details, and give pertinent dates, including estimated date of starting any proposed work) SEE RULE 1103.

MIRU ROD RIC #4, RU WL UT, SET CIBP @ 5850, DUMP 35' CMT ON TOP OF CIBP. LOAD HOLE W/9# BW TST TO 500# F/30 MIN, OK. PERF 2 JHPF 5640-5474, TTL 116 HOLES.  
SET PKR @ 5423, TST TO 2000#, ACDZ W/15 BBLS 15% NEFE HCL. SWB BACK LOAD.  
FRAC PERFS 5474-5640 W.49,000 GAL SPECTRA FRAC G-3000, & 92,000# 16/30 SD & 40,000# AC-FRAC CR SAND.PMP 22,000 GAL PAD W/1100 GAL DIESEL F/FLUID LOSS  
CIRC W/NITROGEN FOAM CIRC & C/O TO 5850'. CIRC CLEAN & UNLOAD W/NITROGEN. RIH W/2-3/8 TBG & PKR, SET @ 5344. CIRC PKR FLUID. TST CSG TO 500# F/30 MN, OK.  
WORK STARTED 8-14-92, COMPLETED 8-27-92. FINAL REPORT

I hereby certify that the information above is true and complete to the best of my knowledge and belief.

SIGNATURE Nita Rice TITLE TECHNICAL ASSISTANT DATE: 9/28/92

TYPE OR PRINT NAME NITA RICE TELEPHONE NO. (915)687-7436

APPROVED BY Paul Kautz TITLE Geologist DATE 9/28/92  
CONDITIONS OF APPROVAL, IF ANY:

3.1.00 b. i. 5

Submit to Appropriate  
District Office  
State Lease-6 copies  
Fee Lease-5 copies

State of New Mexico  
Energy, Minerals and Natural Resources Department

Form C-101  
Revised 1-1-89

OIL CONSERVATION DIVISION

P.O. Box 2088  
Santa Fe, New Mexico 87504-2088

DISTRICT I

P.O. Box 1980, Hobbs, NM 88240

DISTRICT II

P.O. Drawer Dd, Artesia, NM 88210

DISTRICT III

1000 Rio Brazos Rd., Aztec, Nm 87410

API NO. (assigned by OCD on New Wells)	
30-025-25545	
5. Indicate Type of Lease STATE <input type="checkbox"/> FEE <input checked="" type="checkbox"/>	
6. State Oil & Gas Lease No. N/A	
7. Lease Name or Unit Agreement Name A.L. CHRISTMAS (NCT-C)	
8. Well No. 14	
9. Pool name or Wildcat BLINEBRY	
10. Proposed depth	
11. Formation BLINEBRY	
12. Rotary or C.T. ROTARY	
13. Elevation (Show DF, RT, GR, etc.) 3433' GE	14. Kind & Status Plug Bond BLANKET
15. Drig Contractor UNKNOWN	16. Date Work will start 6-10-92

APPLICATION FOR PERMIT TO DRILL, DEEPEN, OF PLUG BACK					
1a. Type of Work: DRILL <input type="checkbox"/> RE-ENTER <input type="checkbox"/> DEEPEN <input type="checkbox"/> PLUG BACK <input checked="" type="checkbox"/>					
b. Type of Well: OIL WELL <input checked="" type="checkbox"/> GAS WELL <input type="checkbox"/> OTHER <input type="checkbox"/> SINGLE ZONE <input checked="" type="checkbox"/> MULTIPLE ZONE <input type="checkbox"/>					
2. Name of Operator CHEVRON U.S.A. INC.					
3. Address of Operator P.O. BOX 1150, MIDLAND, TX 79702 ATTN: P.R. MATTHEW					
4. Well Location Unit Letter D : 560 Feet From The NORTH Line an 810 Feet From The WEST Line Section 18 Township 22S Range 37E NMPM LEA County					
17. EXISTING CASING AND CEMENT PROGRAM					
SIZE OF HOLE	SIZE OF CASING	WEIGHT PER FOOT	SETTING DEPTH	SACKS OF CEMENT	EST. TOP
UNK.	8 5/8"	24	1177'	500	SURFACE
UNK.	5 1/2"	15.5	6700'	2100	SURFACE
NO NEW STRINGS WILL BE SET.					

IT IS PROPOSED TO PLUGBACK DRINKARD AND RECOMPLETE IN THE BLINEBRY.  
POOH WITH PROD. EQUIP. TIH AND SET CIBP AT 5850', CAP WITH 35' CMT. NEW PB AT 5815'.  
PERF AT 5474-5638 WITH 4" GUNS, 2 JHPF. ACDZ AND FRAC PERFS.  
FLOW WELL BACK AND RETURN TO PRODUCTION.

IN ABOVE SPACE DESCRIBE PROPOSE IF PROPOSAL IS TO DEEPEN OR PLUG BACK, GIVE DATA ON PRESENT PRODUCTIVE ZONE AND PROPOSED  
NEW PRODUCTIVE ZONE. GIVE BLOWOUT PREVENTER PROGRAM, IF ANY.

I hereby certify that the information above is true and complete to the best of my knowledge and belief.

SIGNATURE P.R. Matthews TITLE TECHNICAL ASSISTANT DATE 5-21-92

TYPE OR PRINT NAME P.R. MATTHEWS TELEPHONE NO. (915)687-7812

APPROVED BY APPROVED BY DISTRICT SUPERVISOR TITLE DATE MAY 28 '92  
CONDITIONS OF APPROVAL, IF ANY:

Submit to Appropriate  
District Office  
State Lease - 4 copies  
Fee Lease - 3 copies

State of New Mexico  
Energy, Minerals and Natural Resources Department

Form C-102  
Revised 1-1-89

OIL CONSERVATION DIVISION

P.O. Box 2088

Santa Fe, New Mexico 87504-2088

DISTRICT I  
P.O. Box 1980, Hobbs, NM 88240

DISTRICT II  
P.O. Drawer DD, Artesia, NM 88210

DISTRICT III  
1000 Rio Brazos Rd., Aztec, NM 87410

WELL LOCATION AND ACREAGE DEDICATION PLAT

All Distances must be from the outer boundaries of the section

Operator <b>CHEVRON U.S.A. INC.</b>			Lease <b>A.L. CHRISTMAS (ACT-C)</b>		Well No. <b>14</b>
Unit Letter <b>D</b>	Section <b>18</b>	Township <b>22S</b>	Range <b>37E</b>	County <b>LEA</b>	
Actual Footage Location of Well: <b>560</b> feet from the <b>NORTH</b> line and <b>810</b> feet from the <b>WEST</b> line					
Ground level Elev. <b>3433</b>	Producing Formation <b>BLINEBRY</b>		Pool <b>BLINEBRY</b>	Dedicated Acreage: <b>40</b> Acres	

1. Outline the acreage dedicated to the subject well by colored pencil or hatchure marks on the plat below.

2. If more than one lease is dedicated to the well, outline each and identify the ownership thereof (both as to working interest and royalty).

3. If more than one lease of different ownership is dedicated to the well, have the interest of all owners been consolidated by communitization, unitization, force-pooling, etc.?

☐ Yes

☐ No

If answer is "yes" type of consolidation

If answer is "no" list the owners and tract descriptions which have actually been consolidated. (Use reverse side of this form if necessary.)

No allowable will be assigned to the well until all interests have been consolidated (by communitization, unitization, forced-pooling, or otherwise) or until a non-standard unit, eliminating such interest, has been approved by the Division.

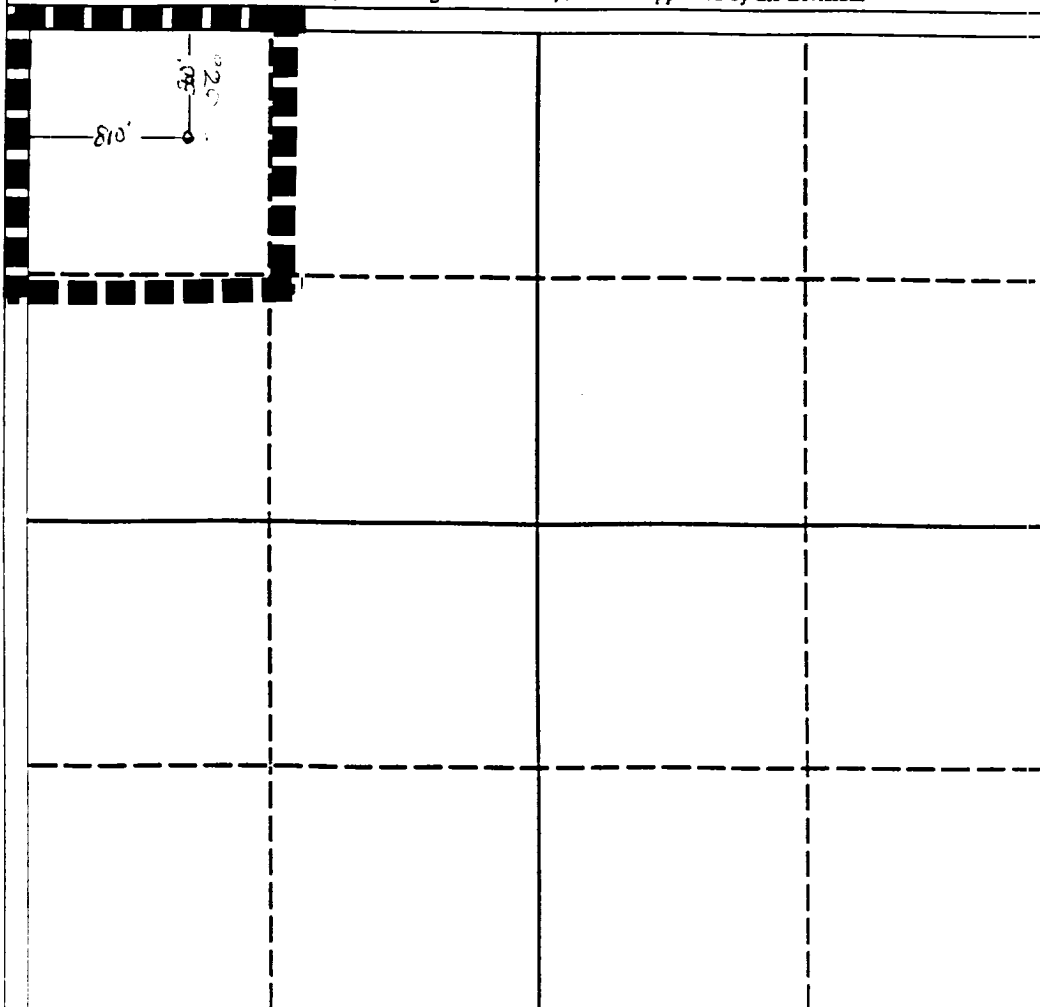

OPERATOR CERTIFICATION

I hereby certify that the information contained herein is true and complete to the best of my knowledge and belief.

Signature

*P.R. Matthews*

Printed Name

P.R. MATTHEWS

Position

TECHNICAL ASSISTANT

Company

CHEVRON U.S.A. INC.

Date

5-26-92

SURVEYOR CERTIFICATION

I hereby certify that the well location shown on this plat was plotted from field notes of actual surveys made by me or under my supervision, and that the same is true and correct to the best of my knowledge and belief.

Date Surveyed

Signature & Seal of  
Professional Surveyor

Certificate No.

0 330 660 990 1320 1650 1980 2310 2640 2000 1500 1000 500 0