

| | | |
|------------------------|--|--|
| NO. OF COPIES RECEIVED | | |
| DISTRIBUTION | | |
| SANTA FE | | |
| FILE | | |
| U.S.G.S. | | |
| LAND OFFICE | | |
| OPERATOR | | |

NEW MEXICO OIL CONSERVATION COMMISSION

Form C-101
Revised 1-1-65

| | |
|--------------------------------|---|
| 5A. Indicate Type of Lease | |
| STATE <input type="checkbox"/> | FEE <input checked="" type="checkbox"/> |
| 5. State Oil & Gas Lease No. | |

APPLICATION FOR PERMIT TO DRILL, DEEPEN, OR PLUG BACK

| | | | |
|---|-------------------------------|---|----------------------------------|
| 1a. Type of Work | | 7. Unit Agreement Name | |
| b. Type of Well OIL WELL <input checked="" type="checkbox"/> GAS WELL <input type="checkbox"/> OTHER <input type="checkbox"/> | | 8. Farm or Lease Name Mark | |
| 2. Name of Operator Gulf Oil Corporation | | 9. Well No. 12 | |
| 3. Address of Operator P. O. Box 670, Hobbs, NM 88240 | | 10. Field and Pool, or Wildcat Wantz Abo | |
| 4. Location of Well UNIT LETTER <u>G</u> LOCATED <u>2227</u> FEET FROM THE <u>North</u> LINE AND <u>1948</u> FEET FROM THE <u>East</u> LINE OF SEC. <u>3</u> TWP. <u>22S</u> RGE. <u>37E</u> NMPM | | 12. County Lea | |
| 19. Proposed Depth | | 19A. Formation | 20. Rotary or C.T. |
| 21. Elevations (Show whether DF, RT, etc.) 3395' GL | 21A. Kind & Status Plug. Bond | 21B. Drilling Contractor | 22. Approx. Date Work will start |

23.

PROPOSED CASING AND CEMENT PROGRAM

| SIZE OF HOLE | SIZE OF CASING | WEIGHT PER FOOT | SETTING DEPTH | SACKS OF CEMENT | EST. TOP |
|---------------|----------------|-----------------|---------------|-----------------|----------|
| No New Casing | | | | | |
| | | | | | |

POH with production equipment. Set CIBP at 7400', cap with 35' Class "C" neat cement to TA Wantz Granite Wash. Test CIBP 1000#. Perf the following intervals with (2) 1/2" JHPF: 6643-45', 6667-69', 6677-79', 6696-98', 6745-47', 6778-80', 6802-04', 6830-32', 6850-52', 6921-23', 6929-31', 6938-40', 6967-69', 6984-86', 6995-97', 7056-58', 7070-72', 7079-81', 7098-7100', 7130-32', 7196-98', 7218-20', 7250-52'. Spot 200 gals 15% NEFE HCL 7056'-7252'. Acidize 7056'-7252' with 107 bbls 15% NEFE HCL, (48) RCNB's. Spot 75 gals 15% NEFE HCL 6921'-6997'. Acidize 6921'-6997' with 80 bbls 15% NEFE HCL, (36) RCNB's. Spot 215 gals 15% NEFE HCL 6643'-6852'. Acidize 6643'-6852' with 119 bbls 15% NEFE HCL, (54) RCNB's. Swab test well. GIH with production equipment.

IN ABOVE SPACE DESCRIBE PROPOSED PROGRAM: IF PROPOSAL IS TO DEEPEN OR PLUG BACK, GIVE DATA ON PRESENT PRODUCTIVE ZONE AND PROPOSED NEW PRODUCTIVE ZONE. GIVE BLOWOUT PREVENTER PROGRAM, IF ANY.

I hereby certify that the information above is true and complete to the best of my knowledge and belief.

Signed Jerry Sexton Title Area Engineer Date 6-20-83

(This space for State Use)

ORIGINAL SIGNED BY JERRY SEXTON
DISTRICT I SUPERVISOR

APPROVED BY _____ TITLE _____ DATE JUN 23 1983

CONDITIONS OF APPROVAL, IF ANY:

**MEXICO OIL CONSERVATION COMMISSION
WELL LOCATION AND ACREAGE DEDICATION PLAT**

Form C-102
Supersedes C-128
Effective 1-1-65

All distances must be from the outer boundaries of the Section.

| | | | | | |
|-------------------------------------|-----------------------------------|-----------------------------|--------------------------|----------------------|---------------------------------------|
| Operator Gulf Oil Corp. | | | Lease Mark | | Well No. 12 |
| Initial Letter G | Section 3 | Township 22 South | Range 37 East | County Lea | |
| Actual Footage Location of Well: | | | | | |
| 2227 | feet from the | North | line and | 1948 | feet from the East line |
| Ground Level Elev. 3395.2 | Producing Formation Abo | | Pool Wantz Abo | | Dedicated Acreage: 40 Acres |

1. Outline the acreage dedicated to the subject well by colored pencil or hachure marks on the plat below.
2. If more than one lease is dedicated to the well, outline each and identify the ownership thereof (both as to working interest and royalty).
3. If more than one lease of different ownership is dedicated to the well, have the interests of all owners been consolidated by communitization, unitization, force-pooling, etc?

☐ Yes ☐ No If answer is "yes," type of consolidation _____

If answer is "no," list the owners and tract descriptions which have actually been consolidated. (Use reverse side of this form if necessary.) _____

No allowable will be assigned to the well until all interests have been consolidated (by communitization, unitization, forced-pooling, or otherwise) or until a non-standard unit, eliminating such interests, has been approved by the Commission.

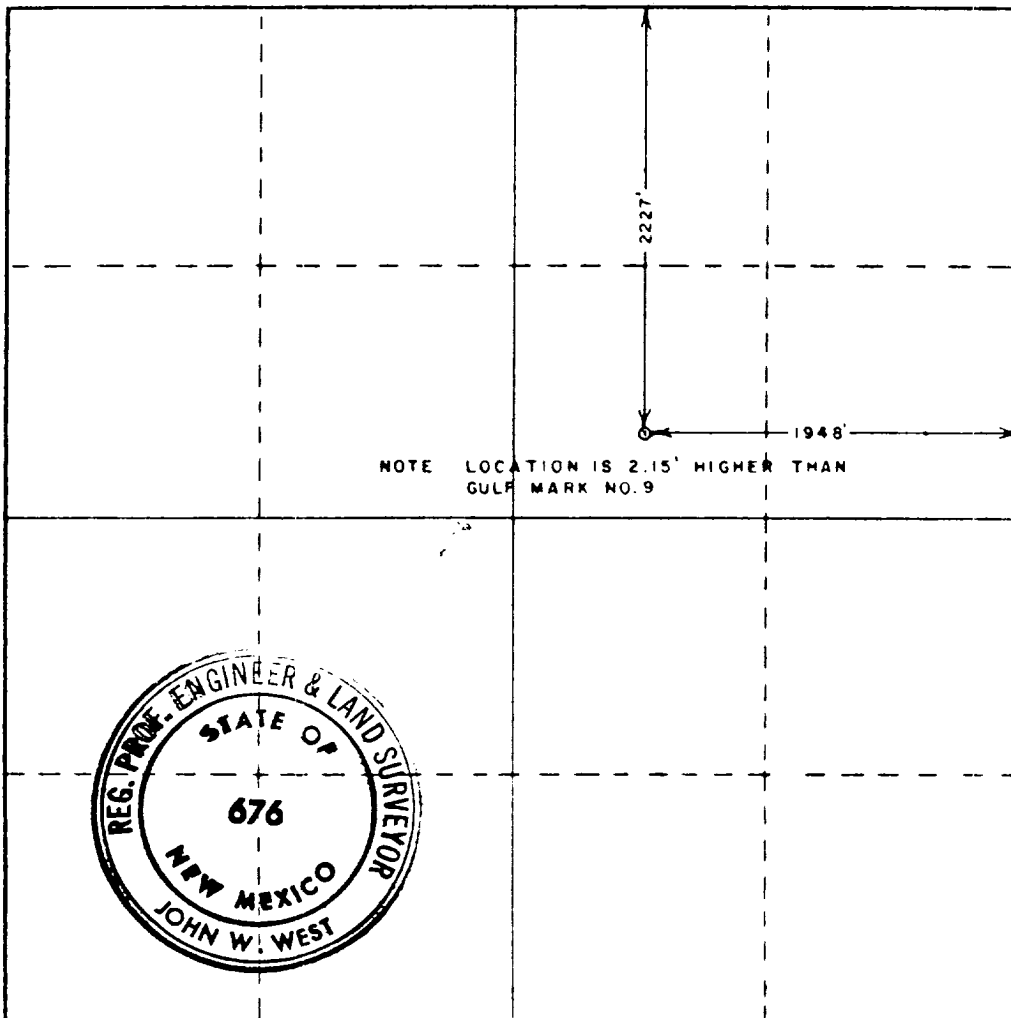

CERTIFICATION

I hereby certify that the information contained herein is true and complete to the best of my knowledge and belief.

James H. Pitre

Name

R. D. Pitre

Position

Area Engineer

Company

Gulf Oil Corporation

Date

6-20-83

I hereby certify that the well location shown on this plat was plotted from field notes of actual surveys made by me or under my supervision, and that the same is true and correct to the best of my knowledge and belief.

Date Surveyed

July 29, 1978

Registered Professional Engineer and/or Land Surveyor

John W. West

Certificate No. John W. West

676

Ronald J. Eidson

3239

330 660 990 1320 1650 1980 2310 2640 2970 3300 3630 3960 4290 4620 4950 5280 5610 5940 6270 6600 6930 7260 7590 7920 8250 8580 8910 9240 9570 9900