

NEW MEXICO OIL CONSERVATION COMMISSION
WELL LOCATION AND ACREAGE DEDICATION PLAT

Form C-102
Supersedes C-128
Effective 1-1-65

All distances must be from the outer boundaries of the Section

Operator Dallas McCasland		Lease Closson B		Well No. 24	
Unit Letter I	Section 30	Township 22 South	Range 36 East	County Lea	
Actual Portage Location of Well: 1980 feet from the South line and 660 feet from the East line					
Ground Level Elev. 3535.5	Producing Formation Yates-Seven Rivers		Pool Jalmat	Dedicated Acreage: 160 Acres	

1. Outline the acreage dedicated to the subject well by colored pencil or hatchure marks on the plat below.
2. If more than one lease is dedicated to the well, outline each and identify the ownership thereof (both as to working interest and royalty).
3. If more than one lease of different ownership is dedicated to the well, have the interests of all owners been consolidated by communitization, unitization, force-pooling, etc?

☐ Yes ☐ No If answer is "yes," type of consolidation _____

If answer is "no," list the owners and tract descriptions which have actually been consolidated. (Use reverse side of this form if necessary.) _____

No allowable will be assigned to the well until all interests have been consolidated (by communitization, unitization, forced-pooling, or otherwise) or until a non-standard unit, eliminating such interests, has been approved by the Commission.

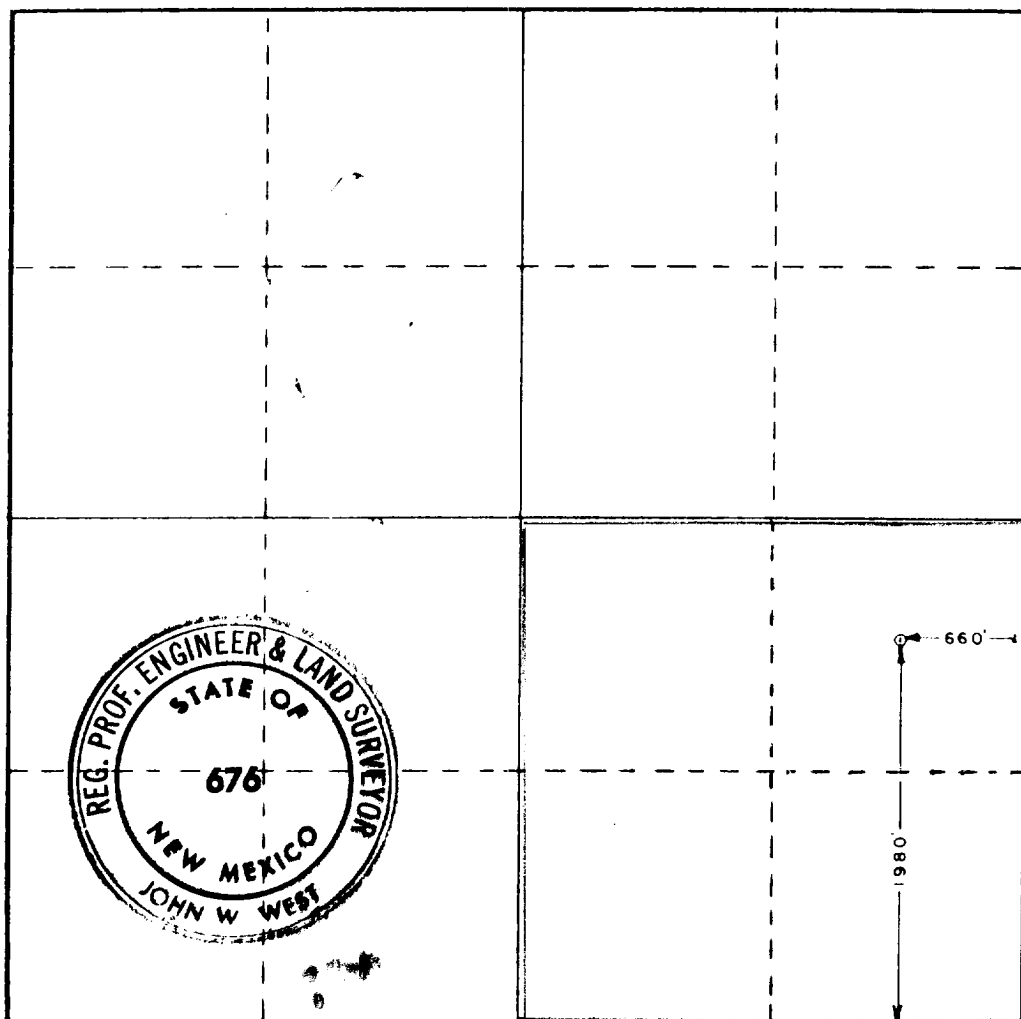

CERTIFICATION

I hereby certify that the information contained herein is true and complete to the best of my knowledge and belief.

Name *John W. West*
Position
Agent
Company
Dallas McCasland
Date
February 27, 1979

I hereby certify that the well location shown on this plat was plotted from field notes of actual surveys made by me or under my supervision, and that the same is true and correct to the best of my knowledge and belief.

Date Surveyed
August 14, 1978
Registered Professional Engineer and/or Land Surveyor

Certificate No. *John W. West*
Ronald J. Eldson 34

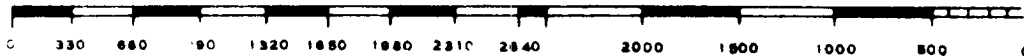



COUNTY LEA FIELD Jalmat STATE NM
 OPR MC CASLAND, DALLAS API 30-025-26143
 NO 24 LEASE Closson "B" MAP
 Sec 30, T22S, R36E (COORD)
 1980' FSL, 660' FEL of Sec 3-1-32 NM
 10 mi SW/Eunice SPD 11-14-78 CMP 12-10-78

CSC	8 5/8" at 428' w/275 sx	WELL CLASS: INIT D FIN DO ELEV L & S			
	5 1/2" at 3905' w/750 sx	FORMATION	DATUM	FORMATION	DATUM
		ID 3915' (QUEN)	PBD 3675'		

IP (Yates) Perfs 3439-3646' P 1 BOPD + 25 BW. Pot based
 on 24 hr test. GOR 450,000; gty 32

CONTR Cactus #66 OPRS ELEV 3535' GL PD 3970' RT

F.R. 11-13-78
 11-20-78 AMEND LEASE NAME: Formerly reported as
 Clossen "B"
 11-28-78 TD 3915'; WOC
 12-5-78 TD 3915'; WOCU
 1-3-79 TD 3915'; PBD 3675'; WOSP
 Perf (Yates) 3439-3646' (overall)
 Acid (3439-3646') 3000 gals (15%)
 Frac (3439-3646') 40,000 gals + 45,000# sd
 3-12-79 TD 3915'; PBD 3675'; Complete
 LOG TOPS: Base Salt 3300', Yates 3438',
 Seven Rivers 3700'
 3-3-79 COMPLETION ISSUED
 3-17-79 RE-ISSUE OF SUSPENDED COMPLETION
 3-1-32 NM
 IC 30-025-70395-78

