

NO. OF COPIES RECEIVED	
DISTRIBUTION	
SANTA FE	
FILL	
U.S.G.S.	
LAND OFFICE	
OPERATOR	

NEW MEXICO OIL CONSERVATION COMMISSION

30-025-26492

Form C-101
Revised 1-1-65

5A. In State Type of Lease	STATE <input checked="" type="checkbox"/> FEE <input type="checkbox"/>
----------------------------	--

5. State Oil & Gas Lease No.

3680

APPLICATION FOR PERMIT TO DRILL, DEEPEN, OR PLUG BACK

1a. Type of Work		
b. Type of Well	DRILL <input checked="" type="checkbox"/>	DEEPEN <input type="checkbox"/>
c. Type of Well	GAS WELL <input checked="" type="checkbox"/>	OTHER <input type="checkbox"/>
d. Type of Well	SINGLE ZONE <input checked="" type="checkbox"/>	MULTIPLE ZONE <input type="checkbox"/>

2. Name of Operator		
Amoco Production Company		
3. Address of Operator		
P. O. Box 68, Hobbs, NM 88240		
4. Location of Well		
UNIT LETTER	LOCATED	FEET FROM THE
L	1980	South
AND	FEET FROM THE	LINE OF SEC.
660	West	2
TWP.	RGE.	NMPM
23-S	33-E	

7. Unit Agreement Name

8. Form or Lease Name

State HL

9. Well No.

1

10. Field and Pool, or Wildcat

Wildcat Morrow (ND)

11. County

Lea

14. Well Description (whether DE, RI, etc.)	15A. Kind & Status of Log, Hole	15B. Drilling Contractor	15C. Formation	16. Rotary or C.T.
3595.5 GL	Blanket-on-File	-----	Morrow	Rotary
22. Approx. Date Work will start				
10-15-79				

PROPOSED CASING AND CEMENT PROGRAM

SIZE OF HOLE	SIZE OF CASING	WEIGHT PER FOOT	SETTING DEPTH	SACKS OF CEMENT	EST. TOP
20"	16"	6.5#	900'	Circ	Surf
14-3/4" or 15"	10-3/4"	40.5#	5400'	Circ	Surf
9-1/2"	7-5/8"	26.4#	13600'	Tie back to 10-3/4"	Btm 10-3/4"
6-1/2"	4-1/2"	9-1/2#	13400 '-15700 '	Tie back to 7-5/8"	Btm 7-5/8"

Propose to drill and equip well in the Morrow Zone. After reaching TD logs will be run and evaluated; perforate and/or stimulate as necessary in attempting commercial production.

Mud Program: 0-900'
900'-5400'
5400'-13600'
13600'-TD

Native mud and fresh water.
Native mud and fresh water.
Commercial mud and brine with fresh water make up.
Commercial mud and brine with minimum properties for safe hole conditions. Reduce to 6% for Morrow Penetration.

BOP Program Attached.
Gas is not dedicated.

IN ABOVE SPACE DESCRIBE PROPOSED PROGRAM: IF PROPOSAL IS TO DEEPEN OR PLUG BACK, GIVE DATA ON PRESENT PRODUCTIVE ZONE AND PROPOSED NEW PRODUCTIVE ZONE. GIVE BLOWOUT PREVENTER PROGRAM, IF ANY.

I hereby certify that the information above is true and complete to the best of my knowledge and belief.

Signed Lay Cox Title Administrative Supervisor Date 10-5-79

(This space for State Use)

SUPERVISOR DISTRICT 1

APPROVED BY [Signature] TITLE DATE OCT 17 1979

CONDITIONS OF APPROVAL, IF ANY:

0+5 NMOC-D-H, 1-Hou, 1-Susp, 1-BD

NEW MEXICO OIL CONSERVATION COMMISSION
WELL LOCATION AND ACREAGE DEDICATION PLAT

Form C-10,
Supersedes C-128
Effective 1-1-75

All distances must be from the outer boundaries of the Section

Lessee AMOCO PRODUCTION CO.			State HI		Well No. 1
Section Letter L	Section 2	Tract 23 South	Tract 33 East	County Lea	
Actual Well Location of Well:					
660		feet from the West	1980	feet from the South	
Section Area 3595.5	Enclosed Acreage Morrow	Well Name Wildcat Morrow		Estimated Acreage 320	Acres

1. Outline the acreage dedicated to the subject well by colored pencil or hatchure marks on the plat below.
2. If more than one lease is dedicated to the well, outline each and identify the ownership thereof (both as to working interest and royalty).
3. If more than one lease of different ownership is dedicated to the well, have the interests of all owners been consolidated by communitization, unitization, force-pooling, etc?

☐ Yes ☐ No If answer is "yes," type of consolidation _____

If answer is "no," list the owners and tract descriptions which have actually been consolidated (Use reverse side of this form if necessary) _____

No allowable will be assigned to the well until all interests have been consolidated (by communitization, unitization, force-pooling, or otherwise) or until a non-standard unit, eliminating such interests, has been approved by the Commission.

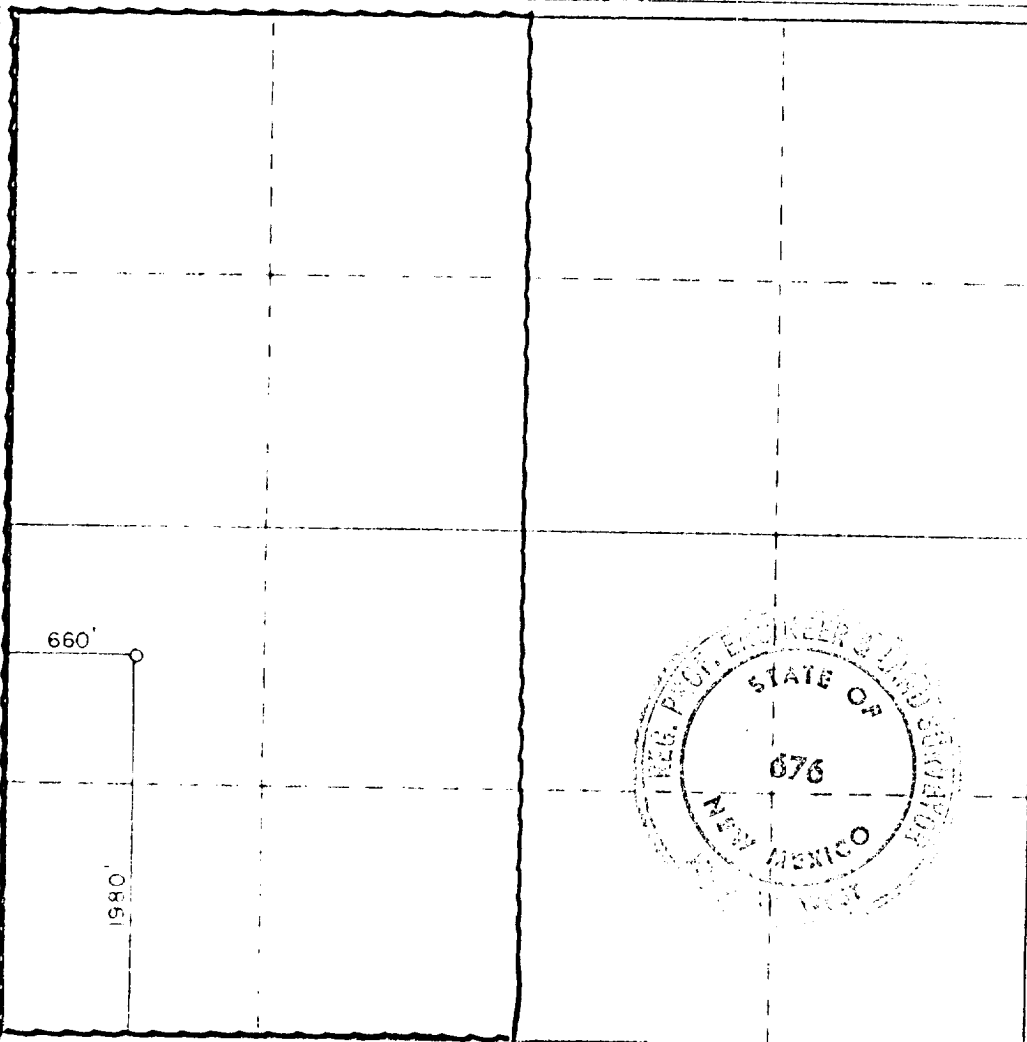

CERTIFICATION

I hereby certify that the information contained herein is true and complete to the best of my knowledge and belief.

Signature: *Ray Cox*
Position: **Administrative Supervisor**
Company: **Amoco Production Company**
Date: **10-5-79**

I hereby certify that the well location shown on this plat was plotted from field notes of actual surveys made by me or under my supervision, and that the same is true and correct to the best of my knowledge and belief.

Date surveyed: **October 5, 1979**

Registered Professional Engineer
New Mexico State Engineer

Signature: *John W. West*

Certificate No. **John W. West 676**
Ronald J. Eifano 3236

1. BOP'S TO BE FLUID OPERATED.
2. BOP'S AND ALL FITTINGS MUST BE IN GOOD CONDITION AND RATED AT 3000 PSI W.P. MINIMUM.
3. EQUIPMENT THROUGH WHICH BIT MUST PASS SHALL BE AT LEAST AS LARGE AS CASING SIZE BEING DRILLED THROUGH.
4. NIPPLE ABOVE BOP'S SHALL BE SAME SIZE AS LAST CASING SET.
5. UPPER KELLY COCK IS REQUIRED AND SHALL BE 3000# W.P. MINIMUM.
6. T. I. W. OR COMPARABLE SAFETY VALVE SHALL BE AVAILABLE ON RIG FLOOR WITH CONNECTION OR SUBS TO FIT ANY TOOL JOINT IN THE STRING. VALVE TO BE FULL BORE 5000# MIN.
7. VALVE NEXT TO SPOOL SHALL BE 4". OTHER EQUIPMENT MAY BE 3" OR 4". ALL CHOKE MANIFOLD EQUIPMENT SHALL BE FLANGED. FLOW LINE FROM MANIFOLD TO BE MINIMUM OF 3" AND STRAIGHT AS POSSIBLE WITH MINIMUM BENDS.
8. FLUID LINES FROM ACCUMULATOR TO BOP'S AND ALL REMOTE CONTROL FLUID LINES SHALL BE STEEL, AND RATED AT OR ABOVE MAXIMUM ACCUMULATOR PRESSURE. LINES SHALL BE ROUTED IN BUNDLES AND ADEQUATELY PROTECTED FROM DAMAGE.
9. USE RAMS IN FOLLOWING POSITIONS:*

	<u>DRILLING</u>	<u>RUNNING CASING</u>
UPPER RAM	DRILL PIPE	CASING
LOWER RAM	BLIND	BLIND

*AMOCO AREA SUPT. MAY REVERSE LOCATION OF RAMS.

10. CHOKE MANIFOLD, BEYOND SECOND VALVE FROM CROSS MAY BE OPTIONALLY POSITIONED OUTSIDE OF SUBSTRUCTURE.
11. EXTENSIONS AND HAND WHEELS TO BE INSTALLED AND BRACED AT ALL TIMES.
12. TWO INCH (2") LINES AND VALVES ARE PERMITTED ON THE KILL LINE.

NOTE: ALL UNMARKED VALVES MAY BE PLUG OR GATE VALVE, METAL TO METAL SEAL.

