

UNITED STATES
DEPARTMENT OF THE INTERIOR
BUREAU OF LAND MANAGEMENT

APPLICATION FOR PERMIT TO DRILL, DEEPEN, OR PLUG BACK

1a. TYPE OF WORK

DRILL ☐

DEEPEN ☐

PLUG BACK ☒

b. TYPE OF WELL

OIL
WELL ☒

GAS
WELL ☐

OTHER RECOMPLETION

SINGLE
ZONE ☐

MULTIPLE
ZONE ☐

2. NAME OF OPERATOR

YATES PETROLEUM CORPORATION

3. ADDRESS OF OPERATOR

105 South 4th St., Artesia, NM 88120

4. LOCATION OF WELL (Report location clearly and in accordance with any State requirements.*)

At surface

1980' FNL & 1980' FEL, Sec. 6-23S-33E

At proposed prod. zone

API #30-025-26496

14. DISTANCE IN MILES AND DIRECTION FROM NEAREST TOWN OR POST OFFICE*

15. DISTANCE FROM PROPOSED*

LOCATION TO NEAREST
PROPERTY OR LEASE LINE, FT.
(Also to nearest drlg. unit line, if any)

16. NO. OF ACRES IN LEASE

19. PROPOSED DEPTH

16160'

17. NO. OF ACRES ASSIGNED
TO THIS WELL

20. ROTARY OR CABLE TOOLS

Pulling Unit

21. ELEVATIONS (Show whether DF, RT, GR, etc.)

3735' KB- 3715.5' GR

22. APPROX. DATE WORK WILL START*

When approved

23. PROPOSED CASING AND CEMENTING PROGRAM

SIZE OF HOLE	SIZE OF CASING	WEIGHT PER FOOT	SETTING DEPTH	QUANTITY OF CEMENT
24"	20"		121'	4 yds Redi-Mix
17 1/2"	13-3/8"	54.5#	736'	750 sx (in place)
12 1/4"	10-3/4"	51,45.5,40.5#	5026'	1400 sx (in place)
9 1/2"	7-5/8"	29.7, 33.7#	12174'	815 sx (in place)

Well is currently producing from Strawn perms 13804-13905' and is uneconomical. Propose to temporarily abandon Strawn by setting RBP @ 13700' in the 5" liner and perforate the Bone Springs from 10572-10653' w/10 holes, acidize w/1500 gal 15% acid and swab test for production. If not economic, the 1st Bone Springs will be perforated 9921-9939' and 10003-10050', and each zone will be acidized and swab tested individually. If necessary, both zones will be fracture treated together. If successful, pumping equipment will be installed.

IN ABOVE SPACE DESCRIBE PROPOSED PROGRAM: If proposal is to deepen or plug back, give data on present productive zone and proposed new productive zone. If proposal is to drill or deepen directionally, give pertinent data on subsurface locations and measured and true vertical depths. Give blowout preventer program, if any.

24.

SIGNED

TITLE Production Supervisor

DATE 1-29-91

(This space for Federal or State office use)

PERMIT NO.

APPROVAL DATE

APPROVED BY

TITLE

DATE

CONDITIONS OF APPROVAL, IF ANY:

*See Instructions On Reverse Side

OIL CONSERVATION DIVISION

P.O. Box 2088

Santa Fe, New Mexico 87504-2088

DISTRICT I

P.O. Box 1980, Hobbs, NM 88240

DISTRICT II

P.O. Drawer DD, Artesia, NM 88210

DISTRICT III

1000 Rio Brazos Rd., Aztec, NM 87410

WELL LOCATION AND ACREAGE DEDICATION PLAT

All Distances must be from the outer boundaries of the section

Operator YATES PETROLEUM CORPORATION			Lease Pronghorn Unit		Well No. 1
Unit Letter G	Section 6	Township 23S	Range 33E	County NMPM	Lea
Actual Footage Location of Well: 1980 feet from the North line and 1980 feet from the East line					
Ground level Elev. 3715.5'	Producing Formation Bone Springs		Pool Undes. Bone Springs		Dedicated Acreage: Acres

- Outline the acreage dedicated to the subject well by colored pencil or hatchure marks on the plat below.
- If more than one lease is dedicated to the well, outline each and identify the ownership thereof (both as to working interest and royalty).
- If more than one lease of different ownership is dedicated to the well, have the interest of all owners been consolidated by communitization, unitization, force-pooling, etc.?
☐ Yes ☐ No If answer is "yes" type of consolidation _____
If answer is "no" list the owners and tract descriptions which have actually been consolidated. (Use reverse side of this form if necessary). _____
No allowable will be assigned to the well until all interests have been consolidated (by communitization, unitization, forced-pooling, or otherwise) or until a non-standard unit, eliminating such interest, has been approved by the Division.

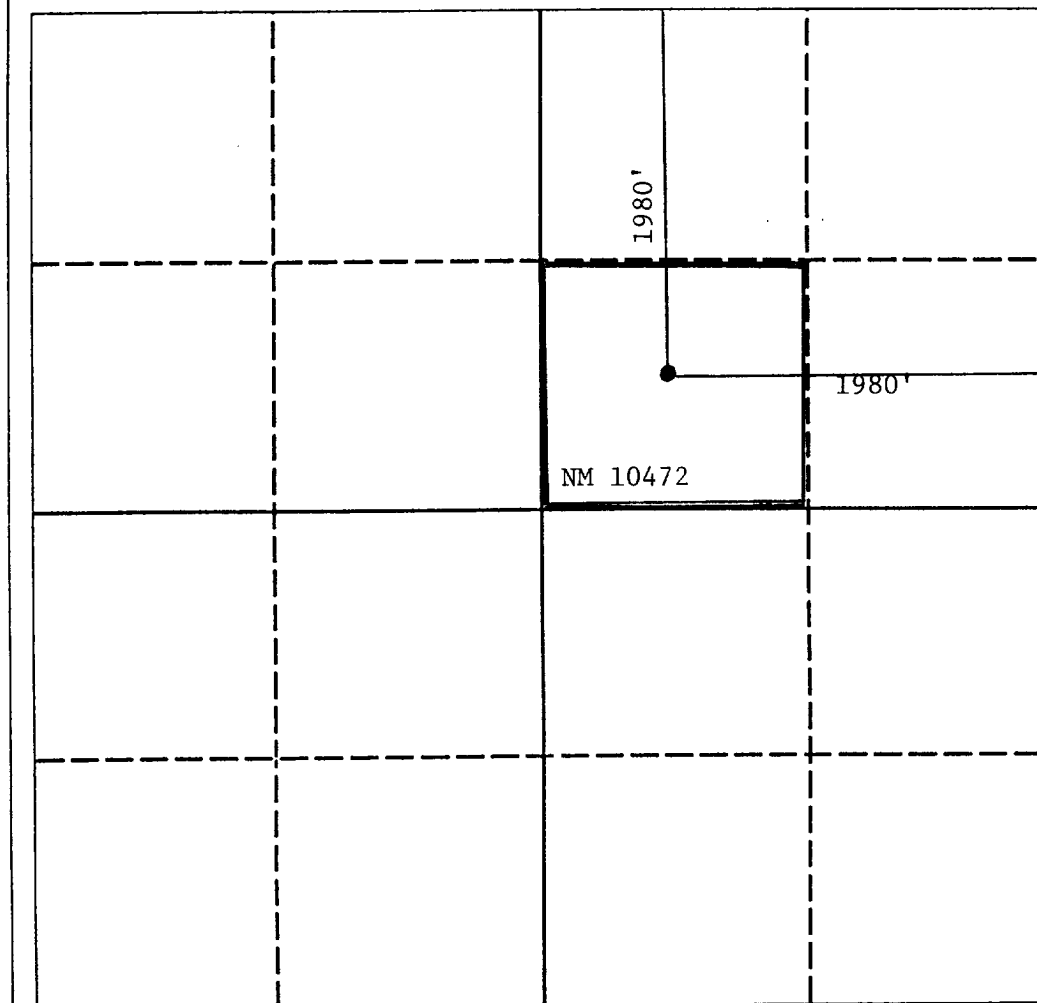

OPERATOR CERTIFICATION

I hereby certify that the information contained herein is true and complete to the best of my knowledge and belief.

Signature

Printed Name

JUANITA GOODLETT

Position

PRODUCTION SUPERVISOR

Company

YATES PETROLEUM CORPORATION

Date

1-29-91

SURVEYOR CERTIFICATION

I hereby certify that the well location shown on this plat was plotted from field notes of actual surveys made by me or under my supervision, and that the same is true and correct to the best of my knowledge and belief.

Date Surveyed

Refer to original plat

Signature & Seal of dated 9-19-79
Professional Surveyor

Certificate No.

