

30-025-26508

NEW MEXICO OIL CONSERVATION COMMISSION

Form C-101
Revised 1-1-65

NO. OF COPIES RECEIVED		
DISTRIBUTION		
SANTA FE		
FILE		
U.S.G.S.		
LAND OFFICE		
OPERATOR		

5A. Indicate Type of Lease	
STATE <input type="checkbox"/>	FEE <input checked="" type="checkbox"/>
5. State Oil & Gas Lease No.	

APPLICATION FOR PERMIT TO DRILL, DEEPEN, OR PLUG BACK

1a. Type of Work DRILL <input checked="" type="checkbox"/> DEEPEN <input type="checkbox"/> PLUG BACK <input type="checkbox"/>				7. Unit Agreement Name	
b. Type of Well OIL WELL <input type="checkbox"/> GAS WELL <input checked="" type="checkbox"/> OTHER <input type="checkbox"/> SINGLE ZONE <input checked="" type="checkbox"/> MULTIPLE ZONE <input type="checkbox"/>				8. Farm or Lease Name Bell Lake, 7907 JV-P	
2. Name of Operator BTA OIL PRODUCERS				9. Well No. 1	
3. Address of Operator 104 South Pecos Midland, Texas 79701				10. Field and Pool, or Wildcat Undesignated (D)	
4. Location of Well UNIT LETTER "C" LOCATED 1650 FEET FROM THE North LINE AND 2510 FEET FROM THE West LINE OF SEC. 18 TWP. 23-S RGE. 34-E NMPM				12. County Lea	
19. Proposed Depth 14,750'				19A. Formation Devonian	
20. Rotary or C.T. Rotary					
21. Elevations (Show whether DT, KI, etc.) 3497'		21A. Kind & Status Plug. Bond Blanket on File		21B. Drilling Contractor Santa Fe Drlg. Co.	
				22. Approx. Date Work will start 1-1-80	

23.

PROPOSED CASING AND CEMENT PROGRAM

SIZE OF HOLE	SIZE OF CASING	WEIGHT PER FOOT	SETTING DEPTH	SACKS OF CEMENT	EST. TOP
26"	20"	94#	600'	2000	Circ.
17-1/2"	13-3/8"	68#	5900'	6000	"
12-1/4"	9-5/8"	47#	12200'	5400	"
8-1/2"	7-5/8"*	39#	14000'	400	"
6-1/2"	5" **	23.2#	TD	200	"

* Liner - 11,800' - 14,000'.

** Liner - 13,800' - 14,700'

BOP on 13-3/8" csg; 12" 3000#, Double Ram & Annular Hydraulic

BOP on 9-5/8" csg; 11" 10,000#, One Double Ram, One Single Ram & Annular Hydraulic

AMENDED LOCATION

IN ABOVE SPACE DESCRIBE PROPOSED PROGRAM: IF PROPOSAL IS TO DEEPEN OR PLUG BACK, GIVE DATA ON PRESENT PRODUCTIVE ZONE AND PROPOSED NEW PRODUCTIVE ZONE. GIVE BLOWOUT PREVENTER PROGRAM, IF ANY.

I hereby certify that the information above is true and complete to the best of my knowledge and belief.

Signed Bob K. Newland BOB K. NEWLAND Title Regulatory Supervisor Date 11/26/79

(This space for State Use)

APPROVED BY

TITLE

SUPERVISOR DISTRICT

DATE

DEC 27 1979

CONDITIONS OF APPROVAL, IF ANY:

NEW MEXICO OIL CONSERVATION COMMISSION
WELL LOCATION AND ACREAGE DEDICATION PLAT

Form C-102
Supersedes C-128
Effective 1-1-65

All distances must be from the outer boundaries of the Section.

Operator BTA OIL PRODUCERS			Lease BELL LAKE, 7910 JV-P		Well No. 1
Unit Letter "F"	Section -18	Township -23-S	Range -34-E	County LEA	
Actual Footage Location of Well: 1650 feet from the NORTH line and 2510 feet from the WEST line					
Ground Level Elev. 3497	Producing Formation DEVONIAN		Pool UNDESIGNATED		Dedicated Acreage: 320 Acres

1. Outline the acreage dedicated to the subject well by colored pencil or hachure marks on the plat below.
2. If more than one lease is dedicated to the well, outline each and identify the ownership thereof (both as to working interest and royalty).
3. If more than one lease of different ownership is dedicated to the well, have the interests of all owners been consolidated by communitization, unitization, force-pooling, etc?

☐ Yes ☐ No If answer is "yes," type of consolidation _____

If answer is "no," list the owners and tract descriptions which have actually been consolidated. (Use reverse side of this form if necessary.) _____

No allowable will be assigned to the well until all interests have been consolidated (by communitization, unitization, forced-pooling, or otherwise) or until a non-standard unit, eliminating such interests, has been approved by the Commission.

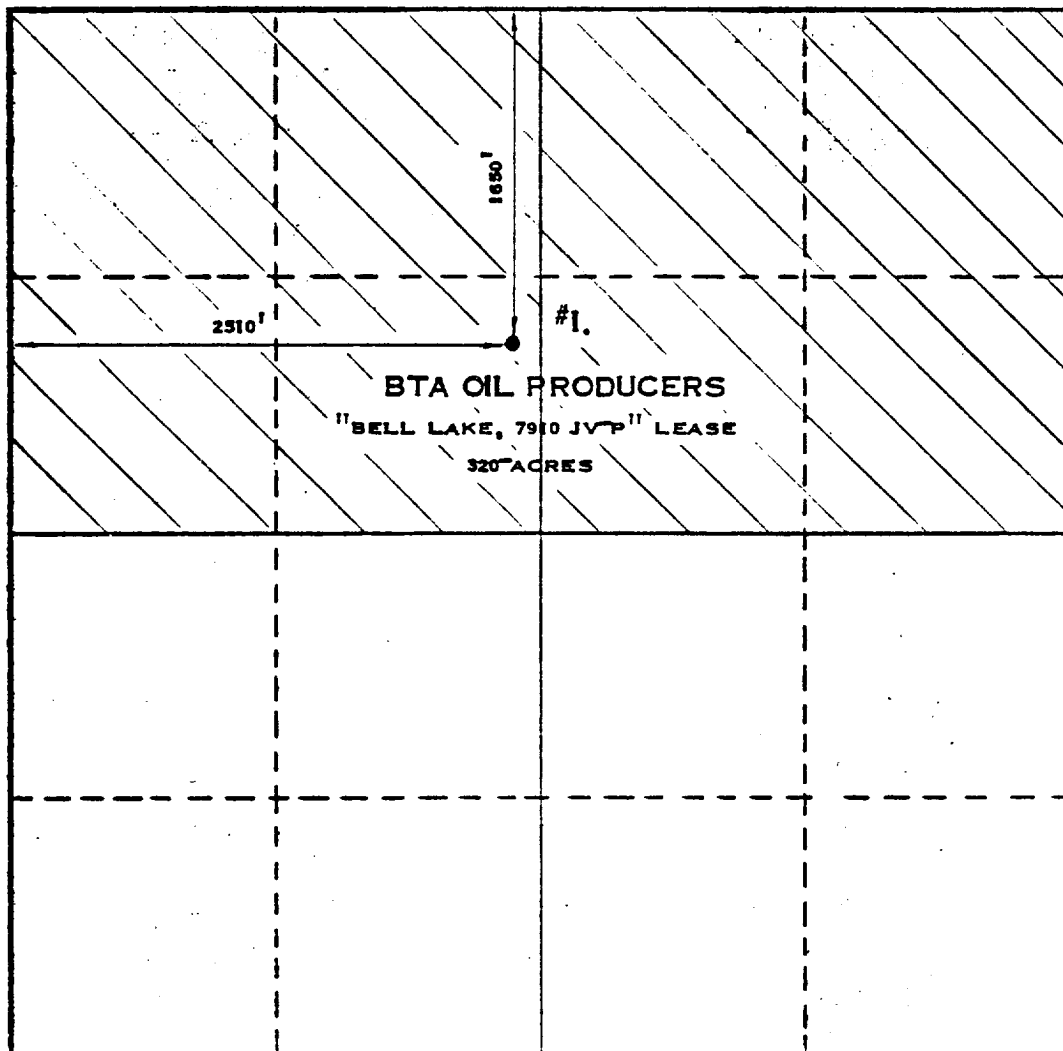

CERTIFICATION

I hereby certify that the information contained herein is true and complete to the best of my knowledge and belief.

Bob K. Newland

Name

BOB K. NEWLAND

Position

Regulatory Supervisor

Company

BTA OIL PRODUCERS

Date

November 26, 1979

I hereby certify that the well location shown on this plat was plotted from field notes of actual surveys made by me or under my supervision, and that the same is true and correct to the best of my knowledge and belief.

Date Surveyed

NOVEMBER 21, 1979

Registered Professional Engineer and/or Land Surveyor

Max A. Schumann Jr.
MAX A. SCHUMANN JR.

Certificate No.

1510

0 330 660 990 1320 1650 1980 2310 2640 2000 1500 1000 500 0

NEW MEXICO OIL CONSERVATION COMMISSION

NO. OF COPIES RECEIVED	
DISTRIBUTION	
SANTA FE	
FILE	
U.S.G.S.	
LAND OFFICE	
OPERATOR	

5a. Indicate Type of Lease
State ☐ Fee ☒
5. State Oil & Gas Lease No.

SUNDRY NOTICES AND REPORTS ON WELLS
(DO NOT USE THIS FORM FOR PROPOSALS TO DRILL OR TO DEEPEN OR PLUG BACK TO A DIFFERENT RESERVOIR.
USE "APPLICATION FOR PERMIT -" (FORM C-101) FOR SUCH PROPOSALS.)

1. <input type="checkbox"/> OIL WELL <input checked="" type="checkbox"/> GAS WELL <input type="checkbox"/> OTHER	7. Unit Agreement Name
2. Name of Operator BTA OIL PRODUCERS	8. Farm or Lease Name Bell Lake, 7909 JV-P
3. Address of Operator 104 South Pecos Midland, Texas 79701	9. Well No. 1
4. Location of Well UNIT LETTER 'C' 660 FEET FROM THE North LINE AND 2310 FEET FROM THE West LINE, SECTION 18 TOWNSHIP 23-S RANGE 34-E NMPM.	10. Field and Pool, or Wildcat Undesignated
15. Elevation (Show whether DF, RT, GR, etc.) 3496 GR	12. County Lea

16. Check Appropriate Box To Indicate Nature of Notice, Report or Other Data

NOTICE OF INTENTION TO:		SUBSEQUENT REPORT OF:	
PERFORM REMEDIAL WORK <input type="checkbox"/>	PLUG AND ABANDON <input type="checkbox"/>	REMEDIAL WORK <input type="checkbox"/>	ALTERING CASING <input type="checkbox"/>
TEMPORARILY ABANDON <input type="checkbox"/>	CHANGE PLANS <input checked="" type="checkbox"/>	COMMENCE DRILLING CPNS. <input type="checkbox"/>	PLUG AND ABANDONMENT <input type="checkbox"/>
PULL OR ALTER CASING <input type="checkbox"/>	OTHER <input type="checkbox"/>	CASING TEST AND CEMENT JOBS <input type="checkbox"/>	OTHER <input type="checkbox"/>

17. Describe Proposed or Completed Operations (Clearly state all pertinent details, and give pertinent dates, including estimated date of starting any proposed work) SEE RULE 1103.

Upon inspection of the above location, BTA discovered that it was under a power line - no work done at this location.

Amended Form C-101 filed on 11/26/79 showing new location.

18. I hereby certify that the information above is true and complete to the best of my knowledge and belief.

SIGNED Gereth Neuston TITLE Production Clerk DATE 12/6/79

APPROVED BY John Ruby DATE DEC 10 1979

CONDITIONS OF APPROVAL, IF ANY: