

* AM ED APPLICATION

NO. OF COPIES RECEIVED	
DISTRIBUTION	
SANTA FE	
FILE	
U.S.G.S.	
LAND OFFICE	
OPERATOR	

NEW MEXICO OIL CONSERVATION COMMISSION

Fern C-101
Revised 1-1-65

5A. Indicate Type of Lease
STATE ☐ FEE ☒
5. State Oil & Gas Lease No.

APPLICATION FOR PERMIT TO DRILL, DEEPEN, OR PLUG BACK

1a. Type of Work b. Type of Well OIL WELL <input checked="" type="checkbox"/> GAS WELL <input type="checkbox"/> OTHER <input type="checkbox"/> DEEPEN <input type="checkbox"/> PLUG BACK <input type="checkbox"/> SINGLE ZONE <input type="checkbox"/> MULTIPLE ZONE <input type="checkbox"/>				7. Unit Agreement Name	
2. Name of Operator Cities Service Company				8. Farm or Lease Name BRUNSON C	
3. Address of Operator P.O. Box 1919 Midland, TX 79702				9. Well No. 13	
4. Location of Well UNIT LETTER <u>I</u> LOCATED <u>2080</u> FEET FROM THE <u>South</u> LINE AND <u>760</u> FEET FROM THE <u>East</u> LINE OF SEC. <u>3</u> TWP. <u>22S</u> RGE. <u>37E</u> NMPM				10. Field and Pool, or Wildcat Wantz Granite Wash	
				11. County Lea	
12. Proposed Depth 7500'		13A. Formation Granite Wash		20. Rotary or C.T. 7500'	
21. Elevations (Show whether DF, RT, etc.) 3383'		21A. Kind & Status Plug. Bond Required/Approved		21B. Drilling Contractor Not Released	
				22. Approx. Date Work will start 1/28/80	

PROPOSED CASING AND CEMENT PROGRAM

SIZE OF HOLE	SIZE OF CASING	WEIGHT PER FOOT	SETTING DEPTH	SACKS OF CEMENT	EST. TOP
17½" (conductor)	13-3/8"	48	30'	5 sx Redi-Mix	Surface
12½"	8-5/8"	24	1200'	620	Surface
7-7/8"	5½"	14 & 15.5	7500'	830	Surface

THE BLOWOUT PREVENTION PROGRAM IS AS FOLLOWS:

1. one set of blind rams.
2. one set of drill pipe rams.
3. one Hydril.

* THIS APPLICATION SUBMITTED TO CHANGE SETTING DEPTH & SACKS OF CEMENT FOR 8-5/8" casing.

IN ABOVE SPACE DESCRIBE PROPOSED PROGRAM: IF PROPOSAL IS TO DEEPEN OR PLUG BACK, GIVE DATA ON PRESENT PRODUCTIVE ZONE AND PROPOSED NEW PRODUCTIVE ZONE. GIVE BLOWOUT PREVENTER PROGRAM, IF ANY.

I hereby certify that the information above is true and complete to the best of my knowledge and belief.

Signed [Signature] Title Region Operations Mgr. Date 1/24/80

(This space for State Use)

APPROVED BY [Signature] TITLE

SUPERVISOR DISTRICT 14

JAN 28 1980

CONDITIONS OF APPROVAL, IF ANY:

NEW MEXICO OIL CONSERVATION COMMISSION
WELL LOCATION AND ACREAGE DEDICATION PLAT

Form C-102
Supersedes C-128
Effective 1-1-65

All distances must be from the outer boundaries of the Section

Operator Cities Service Co.		Lease Brunson "C"		Well No. 13
Section 3	Township 22 South	Range 37 East	Locality Lee	
Approximate Location of Well: 2030 feet from the South line and 760 feet from the East line				
Ground Level Elev. 3383	Producing Formation Granite Wash	Foot Wantz Granite Wash	Estimated Acreage: 40	

1. Outline the acreage dedicated to the subject well by colored pencil or hatchure marks on the plat below.
2. If more than one lease is dedicated to the well, outline each and identify the ownership thereof (both as to working interest and royalty).
3. If more than one lease of different ownership is dedicated to the well, have the interests of all owners been consolidated by communitization, unitization, force-pooling, etc?

☐ Yes ☐ No If answer is "yes," type of consolidation _____

If answer is "no," list the owners and tract descriptions which have actually been consolidated (Use reverse side of this form if necessary.) _____

No allowable will be assigned to the well until all interests have been consolidated (by communitization, unitization, forced-pooling, or otherwise) or until a non-standard unit, eliminating such interests, has been approved by the Commission.

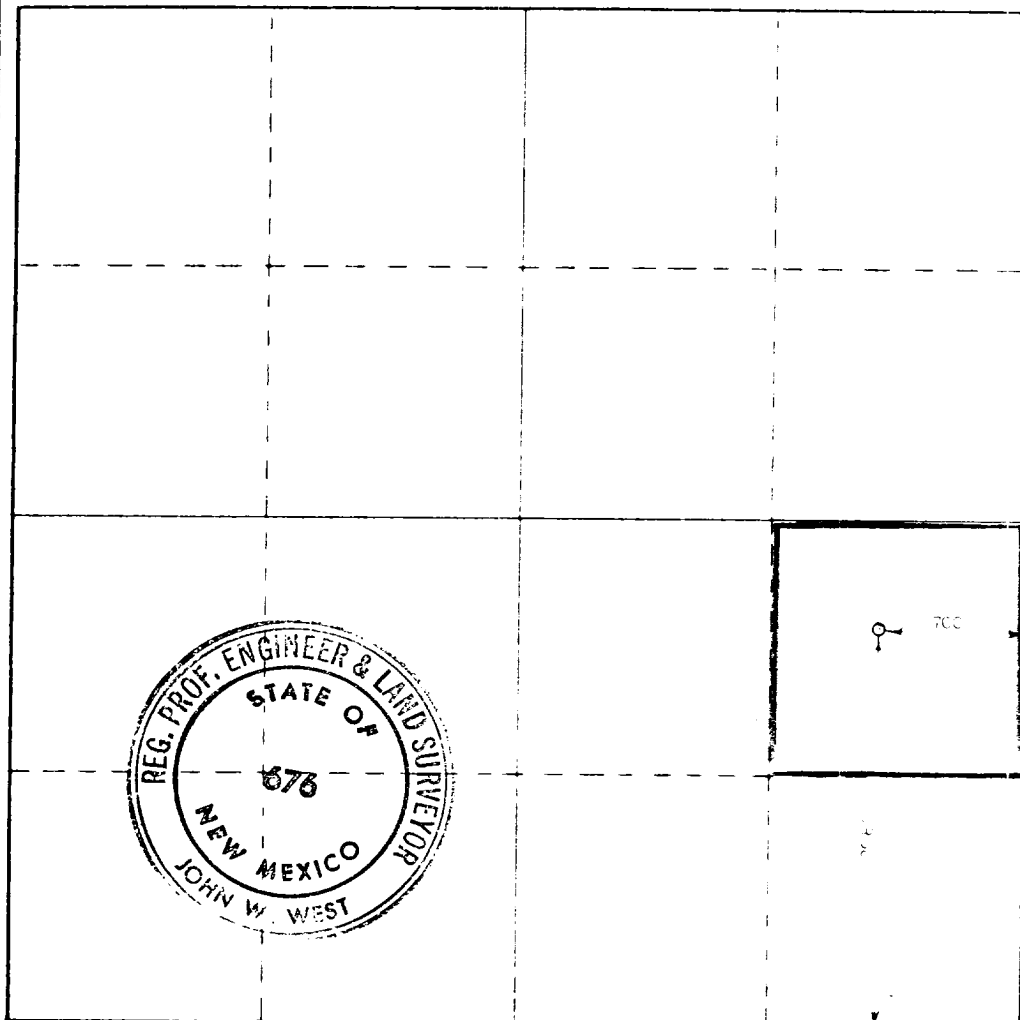

CERTIFICATION

I hereby certify that the information contained herein is true and complete to the best of my knowledge and belief.

E. P. Miller

Region Operation Manager

Cities Service Company

January 24, 1980

I hereby certify that the well location shown on this plat was plotted from field notes of actual surveys made by me or under my supervision, and that the same is true and correct to the best of my knowledge and belief.

1-14-1980

Registered Professional Engineer and Land Surveyor

John W. West

Certified by:	JOHN W. WEST	676
	PATRICK A. ROMERO	6868
	Ronald J. Eidson	3239

0 330 660 990 1320 1650 1980 2310 2640 2970 3300 3630 3960 4290 4620 4950 5280 5610 5940 6270 6600