

COUNTY LEA FIELD Jalmar STATE NM
OPR ARCO OIL & GAS CO. API 30-025-26728
6 LEASE Jones, Rodman MAP
Sec 35, T22S, R36E COORD
1980' ENL, 990' FWL of Sec 6-3-25 NM
8 mi SW/Eunice SPD 3-21-80 CMP 5-6-80

CNG
8 5/8" at 1200' w/550 sx
5 1/2" at 3700' w/725 sx
2 3/8" at 3590'

WELL CLASS: INIT D FIN DG LSE. CODE			
FORMATION	DATUM	FORMATION	DATUM
ID 3704' (SVRV)		PBD 3648'	

IP (Yates-Seven Rivers) 3172-3596' F 331 MCFGPD. Pot based
on 24 hr test thru 3/4" chk. GOR (NR); gty (NR); CP 120#; TP
20#

CONTR Hillin #3 OPRSELEV 3514'GL, 3529'KB PD 3700' RT

F.R. 3-24-80
(Yates-Seven Rivers)
3-27-80 TD 3704'; WOCT
4-28-80 TD 3704'; PBD 3648'; Swbg
Perf (Yates-Seven Rivers) @ 3172', 3175', 3227',
3237', 3239', 3255', 3265', 3302', 3304', 3309',
3318', 3327', 3329', 3332', 3334', 3337', 3357',
3363', 3379', 3385', 3387', 3390', 3413', 3435',
3487', 3489', 3500', 3514', 3530', 3592', 3596'
w/1 SPI
Acid (3172-3596') 4000 gals (15%)
Frac (3172-3596') 30,000 gals + 84,000# sd
+ 30,000 gals CO2
5-9-80 TD 3704'; PBD 3684'; Flwg
Flwd @ 330 MCFGPD + mist oil & wtr in 6 hrs thru
3/4" chk, TP 100-20# (3172-3596')
5-21-80 TD 3704'; PBD 3648'; Tstg
Flwd @ 342 MCFGPD + 3 BW in 24 hrs (3172-3596')
5-30-80 TD 3704'; PBD 3648'; Tstg
Flwd @ 416 MCFGPD (3172-3596') 6-3-25 NM

LEA
ARCO OIL & GAS CO.

Jalmat
6 Jones, Rodman
Sec 35, T22S, R36E

NM
Page #2

6-16-80 TD 3704'; PSD 3648'; Complete
LOG TOPS: Yates 3120', Seven Rivers 3345'
LOGS RUN: CNL, FDC, CALP, CBND, GRL, DILL
BHT 90 deg
Rig Released 3-27-80
6-21-80 COMPLETION ISSUED

6-3-25 NM
IC 30-025-70150-80

NEW MEXICO OIL CONSERVATION COMMISSION
WELL LOCATION AND ACREAGE DEDICATION PLAT

Form O-102
Supersedes C-128
Effective 1-1-65

All distances must be from the outer boundaries of the Section

Operator Division of Atlantic Richfield Co., ARCO Oil & Gas Co.		Lease Rodman Jones		Well No. 6
Unit Letter E	Section 35	Township 22 South	Range 36 East	County Leo
Actual Well Location of Well: 1980 feet from the North line and 990 feet from the West line				
Ground Level Elev. 3513.6	Producing Formation Yates 7Rivers	Pool Jalmat	Dedicated Acreage: 160 Acres	

- Outline the acreage dedicated to the subject well by colored pencil or hachure marks on the plat below.
- If more than one lease is dedicated to the well, outline each and identify the ownership thereof (both as to working interest and royalty).
- If more than one lease of different ownership is dedicated to the well, have the interests of all owners been consolidated by communitization, unitization, force-pooling, etc?

☐ Yes ☐ No If answer is "yes," type of consolidation _____

If answer is "no," list the owners and tract descriptions which have actually been consolidated. (Use reverse side of this form if necessary.) _____

No allowable will be assigned to the well until all interests have been consolidated (by communitization, unitization, forced-pooling, or otherwise) or until a non-standard unit, eliminating such interests, has been approved by the Commission.

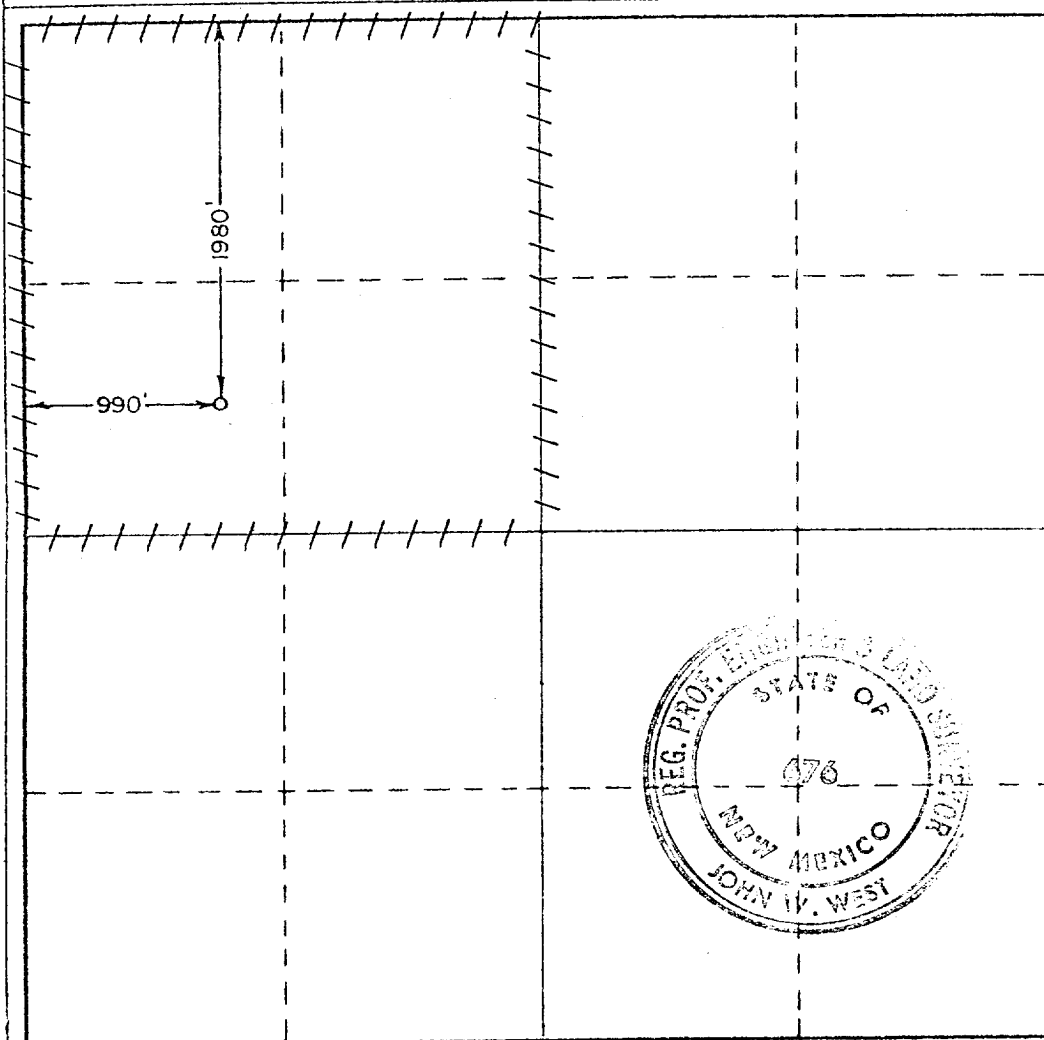

CERTIFICATION

I hereby certify that the information contained herein is true and complete to the best of my knowledge and belief.

W.D. Madame

Position For: **LEROY LANE**

Dist. Drlg. Supt.

ARCO Oil and Gas Company
Division of Atlantic Richfield Company

Date
3/13/80

I hereby certify that the well location shown on this plat was plotted from field notes of actual surveys made by me or under my supervision, and that the same is true and correct to the best of my knowledge and belief.

Date Surveyed

March 5, 1980

Registered Professional Engineer
and/or Land Surveyor

John W. West

Certificate No **JOHN W. WEST 676**
PATRICK A. ROMERO 6663
Ronald J. Eidson 3239

0 330 660 990 1320 1650 1980 2310 2640 2970 3300

RECEIVED

MAR 14 1980

RECEIVED

113