

District I
PO Box 1980, Hobbs, NM 88241-1980
District II
PO Drawer DD, Artesia, NM 88211-0719
District III
1000 Rio Brazos Rd., Aztec, NM 87410
District IV
PO Box 2088, Santa Fe, NM 87504-2088

State of New Mexico
Energy, Minerals & Natural Resources Department

OIL CONSERVATION DIVISION
PO Box 2088
Santa Fe, NM 87504-2088

Form C-101
Revised February 10, 1994
Instructions on back
Submit to Appropriate District Office
State Lease - 6 Copies
Fee Lease - 5 Copies

☒ AMENDED REPORT

APPLICATION FOR PERMIT TO DRILL, RE-ENTER, DEEPEN, PLUGBACK, OR ADD A ZONE

¹ Operator Name and Address. ROC Energy, Inc. P. O. Box 51008 Midland, TX 79710		² OGRID Number 019513
		³ API Number 30 - 0 25-26765
⁴ Property Code 26874	⁵ Property Name L. E. Grizzell	⁶ Well No. 4

⁷ Surface Location

UL or lot no.	Section	Township	Range	Lot Idn	Feet from the	North/South line	Feet from the	East/West line	County
A	8	22S	37E		810	North	410	East	Lea

⁸ Proposed Bottom Hole Location If Different From Surface

UL or lot no.	Section	Township	Range	Lot Idn	Feet from the	North/South line	Feet from the	East/West line	County
A	8	22S	37E		810	North	410	East	Lea
⁹ Proposed Pool 1 Drinkard					¹⁰ Proposed Pool 2				

¹¹ Work Type Code EP	¹² Well Type Code O	¹³ Cable/Rotary Rotary	¹⁴ Lease Type Code P	¹⁵ Ground Level Elevation 3438 KB
¹⁶ Multiple	¹⁷ Proposed Depth 7000	¹⁸ Formation Drinkard	¹⁹ Contractor	²⁰ Spud Date

²¹ Proposed Casing and Cement Program

Hole Size	Casing Size	Casing weight/foot	Setting Depth	Sacks of Cement	Estimated TOC

²² Describe the proposed program. If this application is to DEEPEN or PLUG BACK give the data on the present productive zone and proposed new productive zone. Describe the blowout prevention program, if any. Use additional sheets if necessary.

Present Zone: Fusselman, Perfs @ 7174-7186

Proposed Plugback:

1. Set CIBP @ 7000'. Dump 20' cement on top
2. Perforate Drinkard porosity zones 6440-6664
3. Selectively acidize, swab test, frac if necessary
4. Put on pump

Note: No. 4 is 355' from L. E. Grizzell No. 3 which produces from the Drinkard Gas Zone. These wells will share Drinkard allowable.

Permit Expires 1 Year From Approval
Date Unless Drilling-Underway

Plug-Back

²³ I hereby certify that the information given above is true and complete to the best of my knowledge and belief.

Signature:

Linda Johnston

Printed name: Linda Johnston

Title: Agent

Date: 12/6/00

Phone: (915) 686-8120

OIL CONSERVATION DIVISION

Approved by:

Title:

Approval Date: DEC 18 2000

Expiration Date:

Conditions of Approval:

Attached ☐

District I
PO Box 1980, Hobbs, NM 88241-1980

District II
911 South First, Artesia, NM 88210

District III
1000 Rio Brazos Rd., Aztec, NM 87410

District IV
2040 South Pacheco, Santa Fe, NM 87505

State of New Mexico
Energy, Minerals & Natural Resources Department

OIL CONSERVATION DIVISION
2040 South Pacheco
Santa Fe, NM 87505

Form C-102

Revised October 18, 1994

Instructions on back

Submit to Appropriate District Office

State Lease - 4 Copies

Fee Lease - 3 Copies

☐ AMENDED REPORT

WELL LOCATION AND ACREAGE DEDICATION PLAT

1. API Number 30-0-25-26765	2. Pool Code 19190	3. Pool Name Drinkard
4. Property Code 26874	5. Property Name L. E. Grizzell	6. Well Number 4
7. OGRID No. 019513	8. Operator Name ROC ENERGY, Inc.	9. Elevation 3438 KB

10. Surface Location

UL or lot no. A	Section 8	Township 22S	Range 37E	Lot Idn	Feet from the 810	North/South line North	Feet from the 410	East/West Line East	County Lea
--------------------	--------------	-----------------	--------------	---------	----------------------	---------------------------	----------------------	------------------------	---------------

11. Bottom Hole Location If Different From Surface

UL or lot no.	Section	Township	Range	Lot Idn	Feet from the	North/South line	Feet from the	East/West Line	County
12. Dedicated Acres 40	13. Joint or Infill	14. Consolidation Code	15. Order No.						

NO ALLOWABLE WILL BE ASSIGNED TO THIS COMPLETION UNTIL ALL INTERESTS HAVE BEEN CONSOLIDATED
OR A NON-STANDARD UNIT HAS BEEN APPROVED BY THE DIVISION

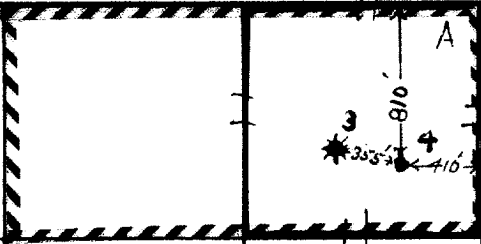
16					17. OPERATOR CERTIFICATION I hereby certify that the information contained herein is true and complete to the best of my knowledge and belief. Signature: <i>Richard C. Bott</i> Printed Name: Richard C. Bott Title: President Date: 12/4/00
	18. SURVEYOR CERTIFICATION I hereby certify that the well location shown on this plat was plotted from field notes of actual surveys made by me or under my supervision, and that the same is true and correct to the best of my belief. Date of Survey: Signature and Seal of Professional Surveyer:				
	Certificate Number				

NEW MEXICO OIL CONSERVATION COMMISSION WELL LOCATION AND ACREAGE DEDICATION

Form No. 1
Revised 1-78
Distribution 1-78

All dedications must be made on maps and maps submitted at the Bureau.

Owner <u>W. D. Yarbrough</u>		Lease <u>ROC ENERGY</u>		Well No. <u>L. E. Grizzell</u>	
Unit Lease	Section	Township	Range	County	
<u>A</u>	<u>8</u>	<u>22 South</u>	<u>37 East</u>	<u>Lea</u>	
Actual Footage Location of Well					
<u>810</u>	feet from the	<u>North</u>	<u>410</u>	feet from the	<u>East</u>
Ground Level Elev.	Producing Formation		Depth	Dedicated Acreage	
<u>9422.6</u>	<u>Fuselman</u>		<u>Brinson Fuselman</u>	<u>40</u>	

- Outline the acreage dedicated to the subject well by colored pencil or hatchure marks on the plat below.
- If more than one lease is dedicated to the well, outline each and identify the ownership thereof (both as to well interest and royalty).
- If more than one lease of different ownership is dedicated to the well, have the interests of all owners been consolidated by communitization, unitization, lease-pooling, etc?

☐ Yes ☐ No If answer is "yes," type of consolidation _____

If answer is "no," list the owners and tract descriptions which have actually been consolidated. (Use reverse side of this form if necessary.) _____

No allowable will be assigned to the well until all interests have been consolidated (by communitization, unitization, lease-pooling, or otherwise) or until a non-standard unit, eliminating such interests, has been approved by the Commission.

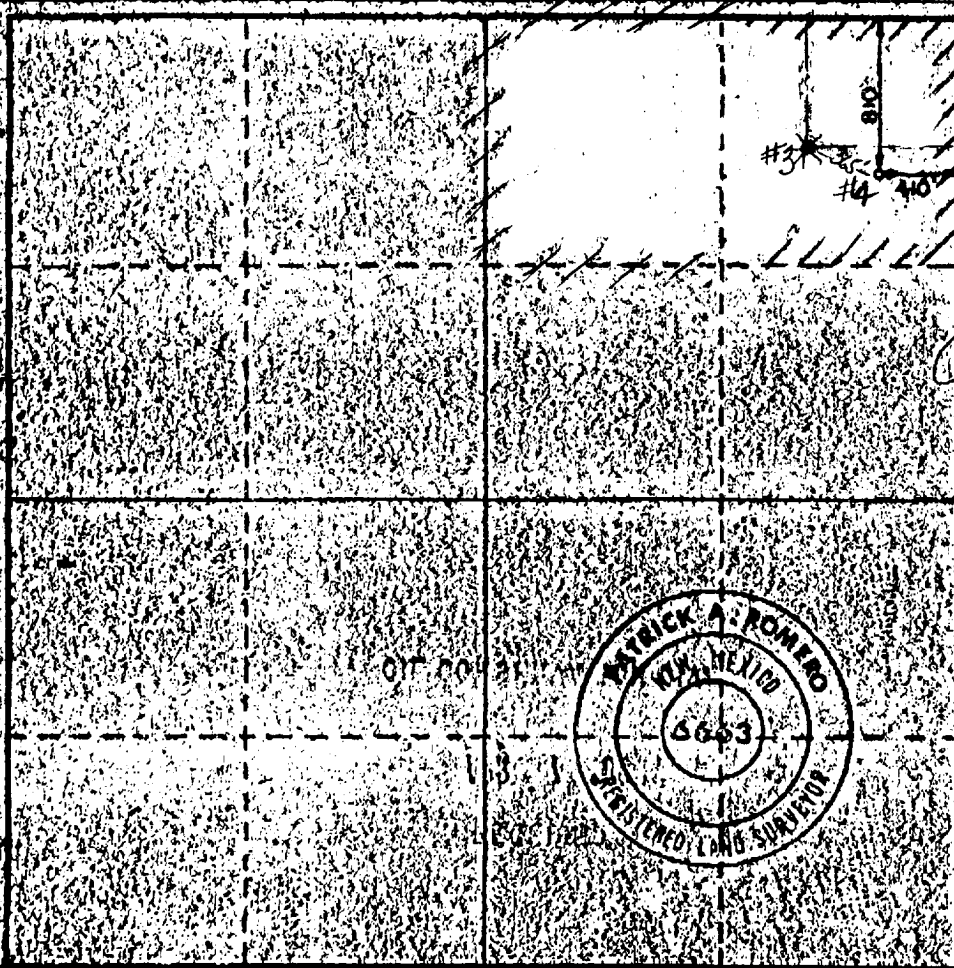

CERTIFICATION

I hereby certify that the information related herein is true and correct to the best of my knowledge and belief.

Name John A. White

Position Surveyor

County Lea

Date 4-7-1980

I hereby certify that the well location shown on this plat was located in accordance with the rules of survey and that the well is true and correct to the best of my knowledge and belief.

Date Surveyed 4-3-1980

Registered Professional Engineer Patrick A. Romero

Commissioner Patrick A. Romero

Consent Patrick A. Romero