

NEW MEXICO OIL CONSERVATION COMMISSION
WELL LOCATION AND ACREAGE DEDICATION PLAT

Form 10-1
Supersedes 6-10-78
Effective 1-1-80

All distances must be from the outer boundaries of the Section

ESTORIL PRODUCING CORPORATION			Lease Belco Federal		Acres 1
Section 15	Township 23 South	Range 34 East	County Lea		
Approximate Location of Well:					
760 feet from the	South line and	1980 feet from the	East line		
Ground Level Elev. 3428.6	Producing Formation MORROW	Pool UNDESIG. ANTELOPE RIDGE-MORROW GAS	Estimated Acreage 320		

1. Outline the acreage dedicated to the subject well by colored pencil or hatchure marks on the plat below.
2. If more than one lease is dedicated to the well, outline each and identify the ownership thereof (both as to working interest and royalty).
3. If more than one lease of different ownership is dedicated to the well, have the interests of all owners been consolidated by communitization, unitization, force-pooling, etc?

☐ Yes ☐ No If answer is "yes," type of consolidation TO BE COMMUNITIZED

If answer is "no," list the owners and tract descriptions which have actually been consolidated. (Use reverse side of this form if necessary.) _____

No allowable will be assigned to the well until all interests have been consolidated (by communitization, unitization, forced-pooling, or otherwise) or until a non-standard unit, eliminating such interests, has been approved by the Commission.

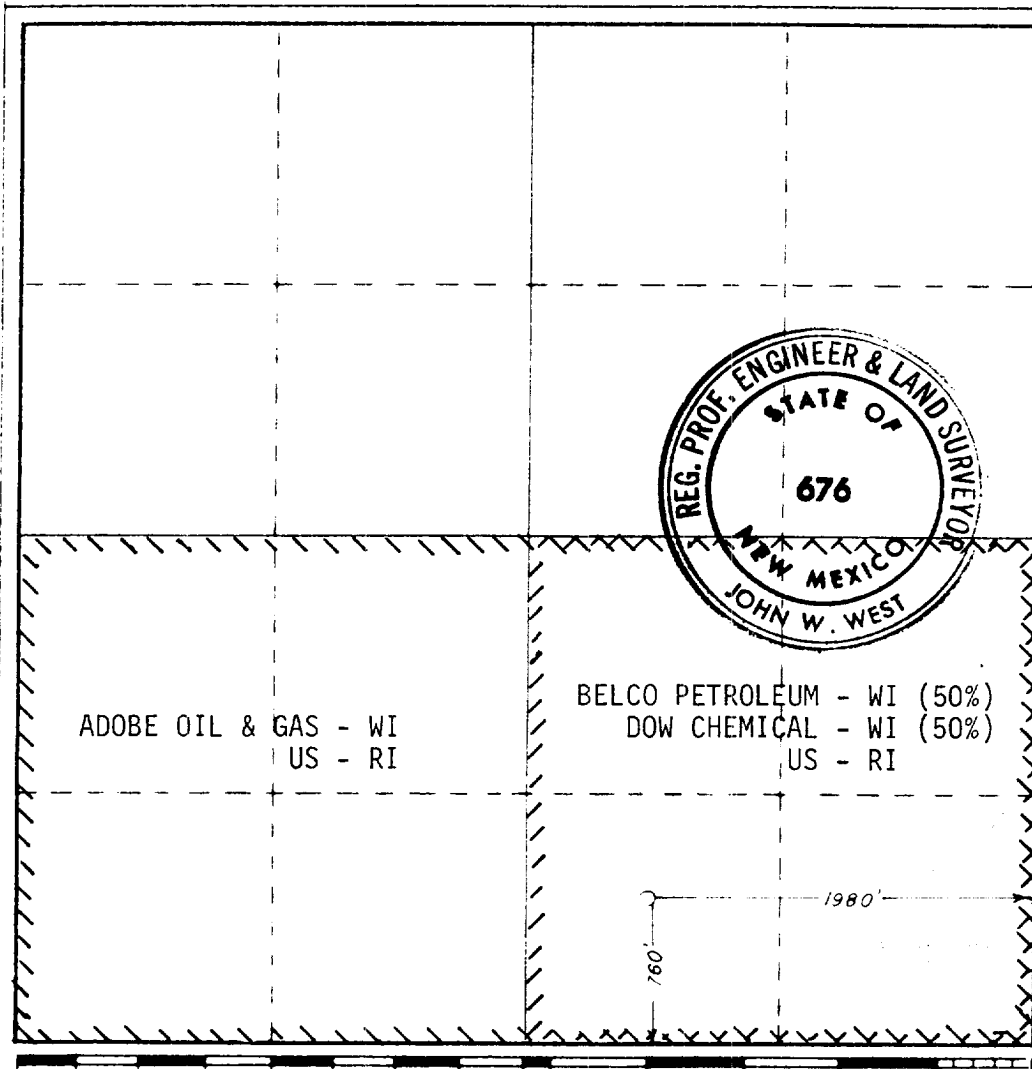

CERTIFICATION

I hereby certify that the information contained herein is true and complete to the best of my knowledge and belief.

Arthur R. Brown
Name

Arthur R. Brown

Position

AGENT FOR

Company

ESTORIL PRODUCING CORP.

Date

MAY 30, 1980

I hereby certify that the well location shown on this plat was plotted from field notes of actual surveys made by me or under my supervision, and that the same is true and correct to the best of my knowledge and belief.

Date Surveyed

May 27, 1980

Registered Professional Engineer and/or Land Surveyor

John W. West

Certificate No. JOHN W. WEST 676
PATRICK A. ROMERO 6663

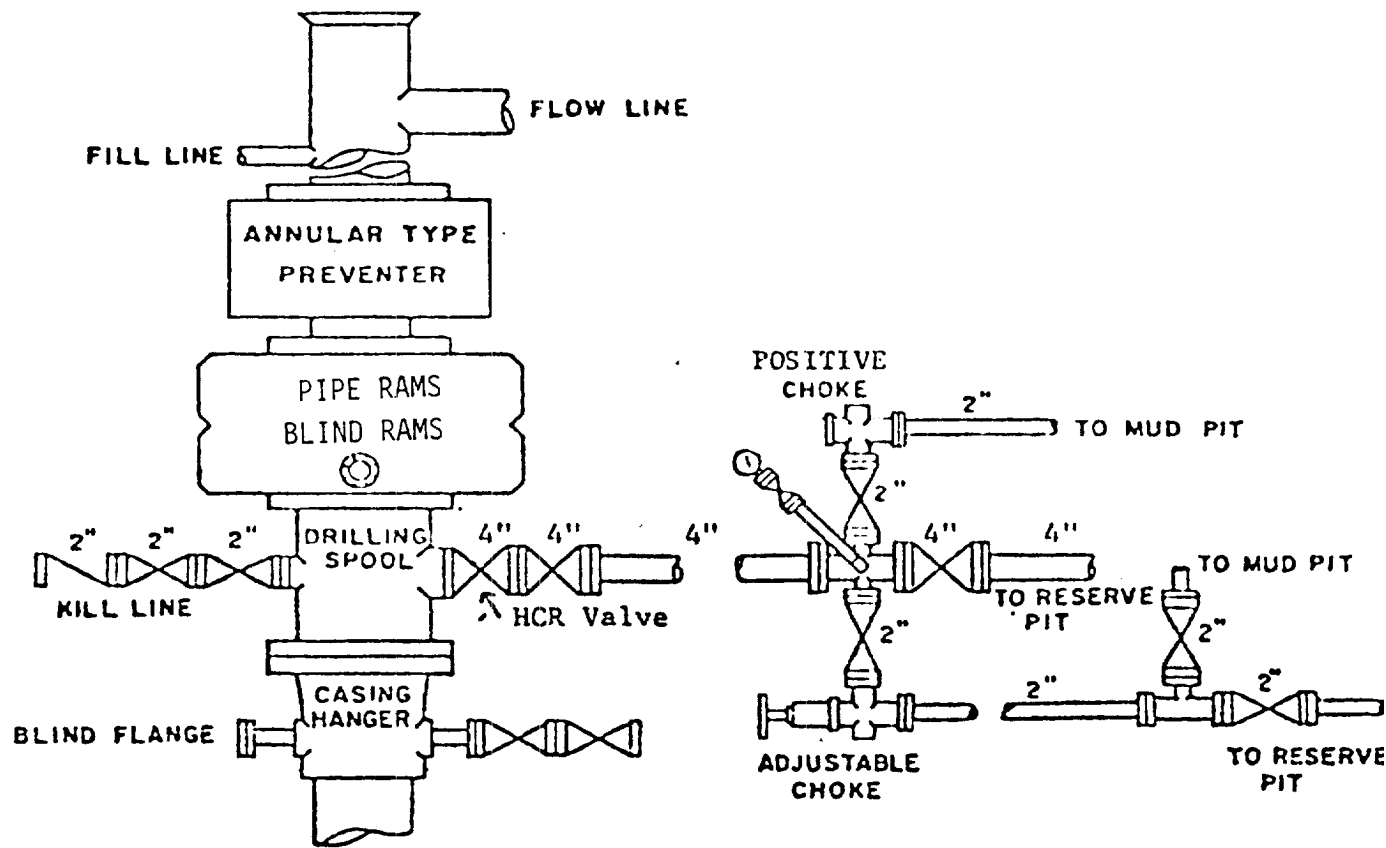

BOP STACK

5000 PSI WORKING PRESSURE ABOVE 11,900 FEET

10,000 PSI WORKING PRESSURE BELOW 11,900 FEET

RECEIVED
JUN 24 1980
OBSERVATION DIV.



Invest. Substation
6/24/80