

30-025-27185

NO. OF COPIES RECEIVED		
DISTRIBUTION		
SANTA FE		
FILE		
U.S.G.S.		
LAND OFFICE		
OPERATOR		

NEW MEXICO OIL CONSERVATION COMMISSION

Form C-101
Revised 1-1-65

5A. Indicate Type of Lease	
STATE <input type="checkbox"/>	FEC <input checked="" type="checkbox"/>
5. State Oil & Gas Lease No.	

APPLICATION FOR PERMIT TO DRILL, DEEPEN, OR PLUG BACK

1a. Type of Work		7. Unit Agreement Name	
b. Type of Well		8. Farm or Lease Name	
DRILL <input checked="" type="checkbox"/> DEEPEN <input type="checkbox"/> PLUG BACK <input type="checkbox"/>		J. W. Grizzell	
OIL WELL <input checked="" type="checkbox"/> GAS WELL <input type="checkbox"/> OTHER <input type="checkbox"/>		9. Well No.	
2. Name of Operator		3	
Marathon Oil Company		10. Field and Pool	
3. Address of Operator		UNDESIGNATED	
P. O. Box 2409, Hobbs, New Mexico 88240		Brunson Fusselman	
4. Location of Well		12. County	
UNIT LETTER 0 LOCATED 330 FEET FROM THE South LINE		Lea	
AND 1650 FEET FROM THE East LINE OF SEC. 5 TWP. 22S RGE. 37E NMDM			
19. Proposed Depth		19A. Formation	20. Rotary or C.T.
7500'		Brunson Fusselman	Rotary
21. Elevations (Show whether DE, RT, etc.)	21A. Kind & Status Plug. Head	21B. Drilling Contractor	22. Approx. Date Work will start
GL 3424.6'	Current	Cherokee - Rig #4	January 10, 1981

23.

PROPOSED CASING AND CEMENT PROGRAM

SIZE OF HOLE	SIZE OF CASING	WEIGHT PER FOOT	SETTING DEPTH	SACKS OF CEMENT	EST. TOP
12 1/4"	9 5/8"	32.3	1225'	510	Circulate
8 3/4"	5 1/2"	15.5 + 17.0	7500'	3150	Circulate

Intend to drill to approximately 7500'.

Cement and test all casing by approved methods.

Blowout equipment to be used is 900 Series Cameron or equivalent with pipe and blank rams. Remote controls will be located on the derrick floor with the closing unit a minimum of 75 ft. from the wellhead.

APPROVAL VALID
FOR 90 DAYS UNLESS
DRILLING COMMENCED,
EXPIRES 3/15/81

IN ABOVE SPACE DESCRIBE PROPOSED PROGRAM: IF PROPOSAL IS TO DEEPEN OR PLUG BACK, GIVE DATA ON PRESENT PRODUCTIVE ZONE AND PROPOSED NEW PRODUCTIVE ZONE. GIVE BLOWOUT PREVENTER PROGRAM, IF ANY.

I hereby certify that the information above is true and complete to the best of my knowledge and belief.

Signed C. C. Sasseff Title Operations Superintendent Date December 11, 1980

(This space for State Use)

SUPERVISOR DISTRICT #

DEC 15 1980

APPROVED BY [Signature] TITLE

DATE

CONDITIONS OF APPROVAL, IF ANY:

NEW MEXICO OIL CONSERVATION COMMISSION
WELL LOCATION AND ACREAGE DEDICATION PLAT

Form C-102
Supersedes C-128
Effective 1-1-65

All distances must be from the outer boundaries of the Section.

Operator Marathon Oil Co.			Lease J.W. Grizzell		Well No. 3
Unit Letter 0	Section 5	Township 22S	Range 37E	County Lea	
Actual Footage Location of Well: 1650 feet from the East line and 330 feet from the South line					
Ground Level Elev. 3424.6	Producing Formation Brunson Fusselman		Pool Brunson Fusselman		Dedicated Acreage: 40 Acres

1. Outline the acreage dedicated to the subject well by colored pencil or hachure marks on the plat below.
2. If more than one lease is dedicated to the well, outline each and identify the ownership thereof (both as to working interest and royalty).
3. If more than one lease of different ownership is dedicated to the well, have the interests of all owners been consolidated by communitization, unitization, force-pooling, etc?

☐ Yes ☐ No If answer is "yes," type of consolidation _____

If answer is "no," list the owners and tract descriptions which have actually been consolidated. (Use reverse side of this form if necessary.) _____

No allowable will be assigned to the well until all interests have been consolidated (by communitization, unitization, forced-pooling, or otherwise) or until a non-standard unit, eliminating such interests, has been approved by the Commission.

R-37E

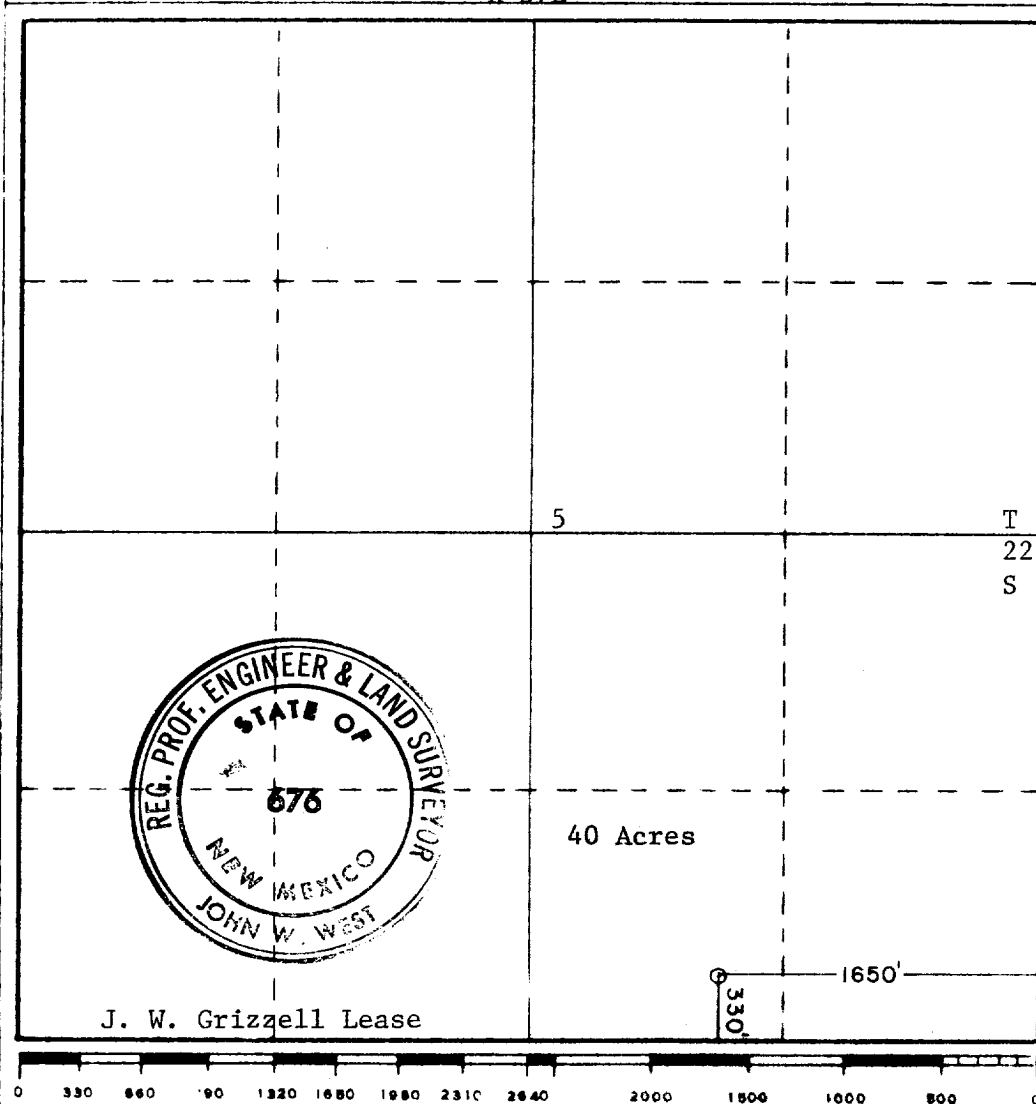

CERTIFICATION

I hereby certify that the information contained herein is true and complete to the best of my knowledge and belief.

C.C. Saathoff

Name
Calvin C. Saathoff
Position
Operations Superintendent

Company
Marathon Oil Company

Date
December 11, 1980

I hereby certify that the well location shown on this plat was plotted from field notes of actual surveys made by me or under my supervision, and that the same is true and correct to the best of my knowledge and belief.

Date Surveyed
December 9, 1980

Registered Professional Engineer and/or Land Surveyor

John W. West

Certificate No. **JOHN W. WEST 676**
PATRICK A. ROMERO 6883
Ronald J. Eidson 3239

DEC 15 1980

U.S. DEPARTMENT OF JUSTICE

177

1/12/81
Conrad R. Brown, Jr.
D