

NO. OF COPIES RECEIVED	
DISTRIBUTION	
SANTA FE	
FILE	
U.S.G.S.	
LAND OFFICE	
OPERATOR	

NEW MEXICO OIL CONSERVATION COMMISSION

Form C-101
Revised 1-1-65

30-025-27756

5A. Indicate Type of Lease
STATE ☐ FEE ☒

5. State Oil & Gas Lease No.

7. Unit Agreement Name

8. Farm or Lease Name
E.W. Walden

9. Well No.
12

10. Field and Pool, or Wildcat
Penrose - Skelly

12. County
Lea

19. Proposed Depth
4,000'

19A. Formation
Grayburg SA

20. Rotary or C.T.
Rotary

21B. Drilling Contractor
Warton

22. Approx. Date Work will start
March 7, 1982

APPLICATION FOR PERMIT TO DRILL, DEEPEN, OR PLUG BACK

1a. Type of Work

b. Type of Well
DRILL ☒ DEEPEN ☐ PLUG BACK ☐
OIL WELL ☒ GAS WELL ☐ OTHER ☐
SINGLE ZONE ☐ MULTIPLE ZONE ☐

2. Name of Operator
Anadarko Production Company

3. Address of Operator
P.O. Box 806 Eunice, New Mexico 88231

4. Location of Well
UNIT LETTER F LOCATED 2250 FEET FROM THE North LINE
AND 1350 FEET FROM THE West LINE OF SEC. 15 TWP. 22S RGE. 37E NMPM

1. Elevations (Show whether DF, RT, etc.)
3402.6 GR

21A. Kind & Status Plug. Bond
Blanket

PROPOSED CASING AND CEMENT PROGRAM

SIZE OF HOLE	SIZE OF CASING	WEIGHT PER FOOT	SETTING DEPTH	SACKS OF CEMENT	EST. TOP
11"	8-5/8"	24#	1,150'	450 Δx	Circ
7-7/8"	5 1/2"	15.5#	4,600'	570 Δx	1,000'

1. Move in and RU Rotary Tools.
2. Drill 11" hole to 1,150' or top of Anhydrite.
3. Run 8-5/8" 24# csg. Cement w/sufficient Class C cement, containing 2% CACL, to circulate.
4. Nipple up, set BOP. Drill out after 12 hrs. w/7-7/8" bit.
5. Drill to approx. 4,000' or 100' into top of San Andres.
6. Run OH Logs.
7. Run 5 1/2" 15.5# csg. to TD. Cement w/Class C cement, using sufficient cement to put TOC @ approx. 1,000' from surface.
8. Complete as Grayburg SA producer.
9. POP.

APPROVAL VALID FOR 180 DAYS
PERMIT EXPIRES 11/6/82
UNLESS DRILLING UNDERWAY

R-6959 NSL

ABOVE SPACE DESCRIBE PROPOSED PROGRAM: IF PROPOSAL IS TO DEEPEN OR PLUG BACK, GIVE DATA ON PRESENT PRODUCTIVE ZONE AND PROPOSED NEW PRODUCTION ZONE. GIVE BLOWOUT PREVENTER PROGRAM, IF ANY.

I hereby certify that the information above is true and complete to the best of my knowledge and belief.

Original signed by: John C. English Title Area Supervisor
(This space for State Use)

Date 2/12/82

ORIGINAL SIGNED BY

PROVED BY JERRY SEXTON

TITLE

DATE MAY 6 1982

CONDITIONS OF APPROVAL: IF ANY

**NEW MEXICO OIL CONSERVATION COMMISSION
WELL LOCATION AND ACREAGE DEDICATION PLAT**

Form C-102
Supersedes C-128
Effective 1-1-65

All distances must be from the outer boundaries of the Section

Operator ANADARKO PRODUCTION CO.			Lease E. W. WALDEN		Well No. 12
Unit Letter F	Section 15	Township 22 SOUTH	Range 37 EAST	County LEA	
Actual Footage Location of Well:					
2250		feet from the NORTH	line and 1350	feet from the WEST	line
Ground Level Elev. 3402.6	Producing Formation Grayburg SA	Pool Penrose Skelly		Dedicated Acreage: 40 Acres	

1. Outline the acreage dedicated to the subject well by colored pencil or hachure marks on the plat below.
2. If more than one lease is dedicated to the well, outline each and identify the ownership thereof (both as to working interest and royalty).
3. If more than one lease of different ownership is dedicated to the well, have the interests of all owners been consolidated by communitization, unitization, force-pooling, etc?

☐ Yes ☒ No If answer is "yes," type of consolidation _____

If answer is "no," list the owners and tract descriptions which have actually been consolidated. (Use reverse side of this form if necessary.) _____

No allowable will be assigned to the well until all interests have been consolidated (by communitization, unitization, forced-pooling, or otherwise) or until a non-standard unit, eliminating such interests, has been approved by the Commission.

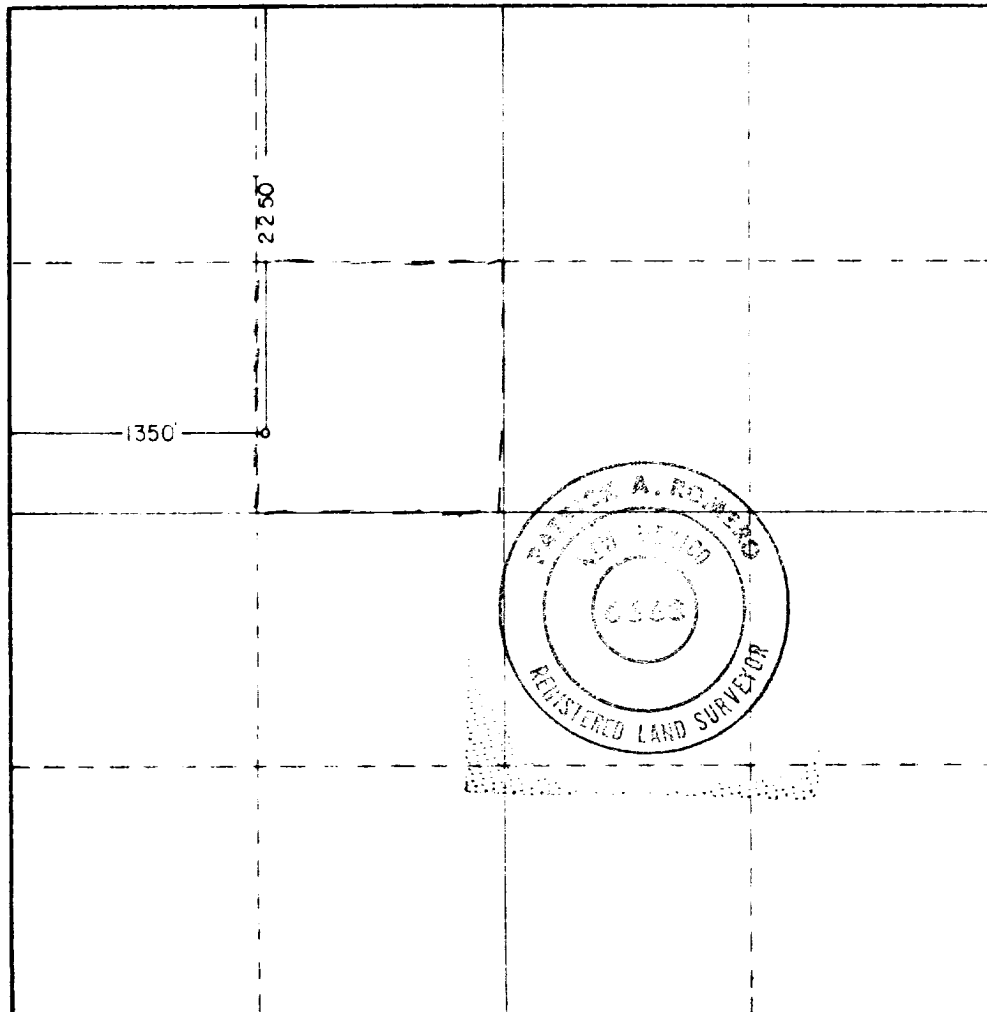

CERTIFICATION

I hereby certify that the information contained herein is true and complete to the best of my knowledge and belief.

John C. English
John C. English

Area Supervisor

Anadarko Production Company

February 17, 1982

I hereby certify that the well location shown on this plat was plotted from field notes of actual surveys made by me or under my supervision, and that the same is true and correct to the best of my knowledge and belief.

Date Surveyed

2-11-82

Registered Professional Engineer
and/or Land Surveyor

Patrick A. Romero

Certificate No **JOHN W. WEST 676**
PATRICK A. ROMERO 6663
Donald J. Eide 7230



RECEIVED

FEB 19 1932

HOME OFFICE

473