

NEW MEXICO OIL CONSERVATION COMMISSION  
WELL LOCATION AND ACREAGE DEDICATION PLAT

Form C-128  
Supersedes C-128  
Effective 1-1-85

All distances must be from the outer boundaries of the Section

Division of Atlantic Richfield Co. Arco Oil & Gas Co.		Lease McDonald <sup>WN</sup> State		Well No. 29
Section B	25	Township 22 South	Range 36 East	County Lea
Distance from the north line and 990 feet from the east line		1980		
Distance from the south line and 990 feet from the west line		3444.7'		
Formulating Formation Yates 7Rivers		Pool Jalmat Gas		Dedicated Acreage: 320 Acres

- Outline the acreage dedicated to the subject well by colored pencil or hachure marks on the plat below.
- If more than one lease is dedicated to the well, outline each and identify the ownership thereof (both as to working interest and royalty).
- If more than one lease of different ownership is dedicated to the well, have the interests of all owners been consolidated by communitization, unitization, force-pooling, etc?

☐ Yes ☐ No If answer is "yes," type of consolidation \_\_\_\_\_  
If answer is "no," list the owners and tract descriptions which have actually been consolidated. (Use reverse side of this form if necessary.) \_\_\_\_\_  
No allowable will be assigned to the well until all interests have been consolidated (by communitization, unitization, forced-pooling, or otherwise) or until a non-standard unit, eliminating such interests, has been approved by the Commission.

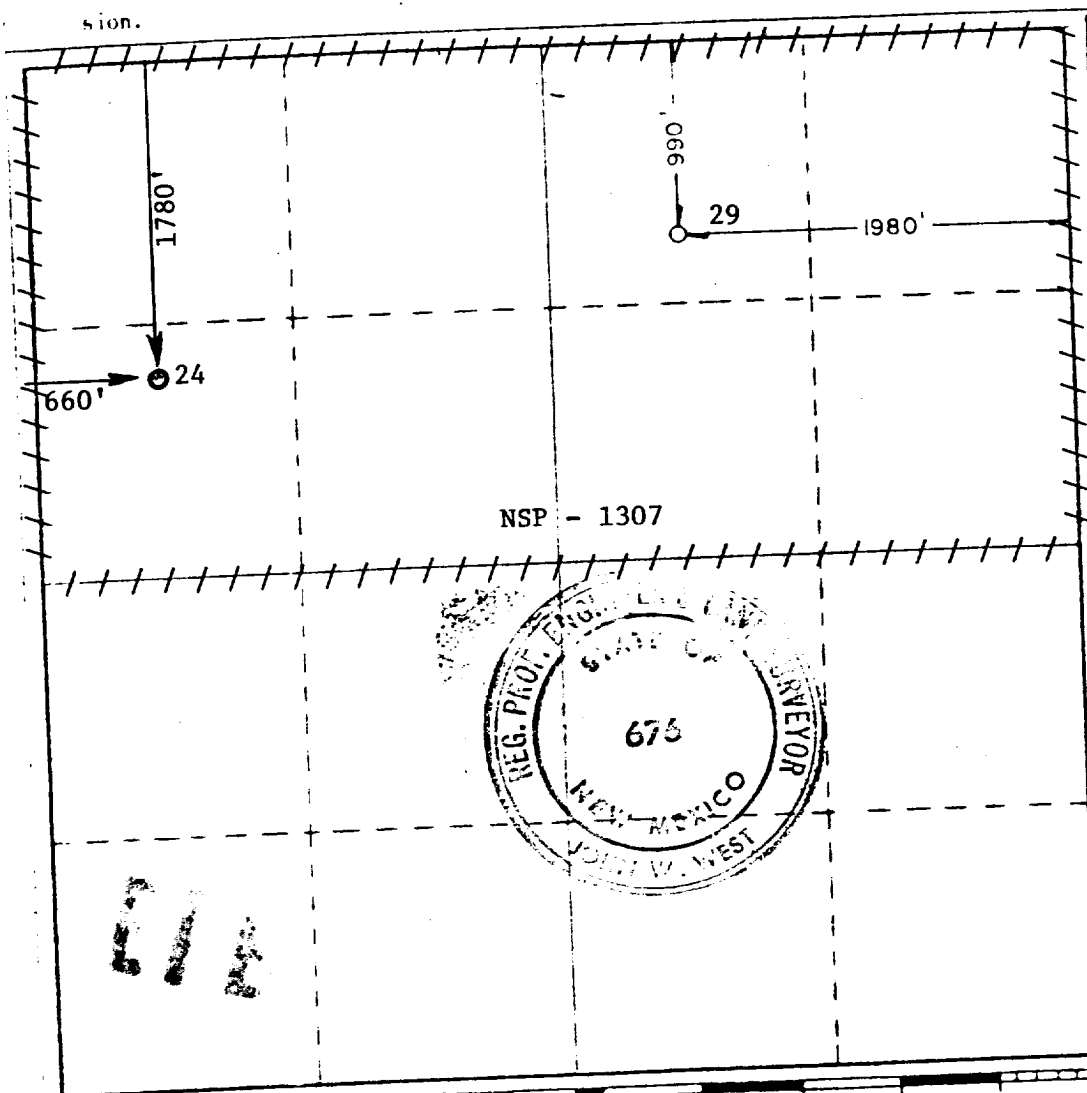

CERTIFICATION

I hereby certify that the information contained herein is true and complete to the best of my knowledge and belief.

Name Elizabeth L. Bush  
Position Drilling Engineer  
Company ARCO Oil and Gas Co.  
Div. of Atlantic Richfield Co.  
Date 6/08/82

I hereby certify that the well location shown on this plat was plotted from field notes of actual surveys made by me or under my supervision, and that the same is true and correct to the best of my knowledge and belief.

Date surveyed 5-24-82  
Registered Professional Engineer and Land Surveyor

John W. West  
Certificate No. JOHN W. WEST 878  
PATRICK A. ROMERO 6883  
Ronald J. Eidson 3239