

NEW MEXICO OIL CONSERVATION COMMISSION
WELL LOCATION AND ACREAGE DEDICATION PLAT

Form C-102
Supersedes C-128
Effective 1-1-65

All distances must be from the outer boundaries of the Section.

Operator C.W. STUMHOFFER		Lease Shipman		Well No. 1	
Map Letter C	Section 35	Township 22 South	Range 37 East	County Lea	
Actual Distance Location of Well: 2310 feet from the North line and 2310 feet from the East line					
Ground Level Elev. 3297.2'	Producing Formation Penrose (Lower Queen) Sand		Pool Langlie Mattix 7 Rvrs Q Grayburg		Dedicated Acreage: 40 Acres

1. Outline the acreage dedicated to the subject well by colored pencil or hatchure marks on the plat below.
2. If more than one lease is dedicated to the well, outline each and identify the ownership thereof (both as to working interest and royalty).
3. If more than one lease of different ownership is dedicated to the well, have the interests of all owners been consolidated by communitization, unitization, force-pooling, etc?

☐ Yes ☐ No If answer is "yes," type of consolidation _____

If answer is "no," list the owners and tract descriptions which have actually been consolidated. (Use reverse side of this form if necessary.) _____

No allowable will be assigned to the well until all interests have been consolidated (by communitization, unitization, forced-pooling, or otherwise) or until a non-standard unit, eliminating such interests, has been approved by the Commission.

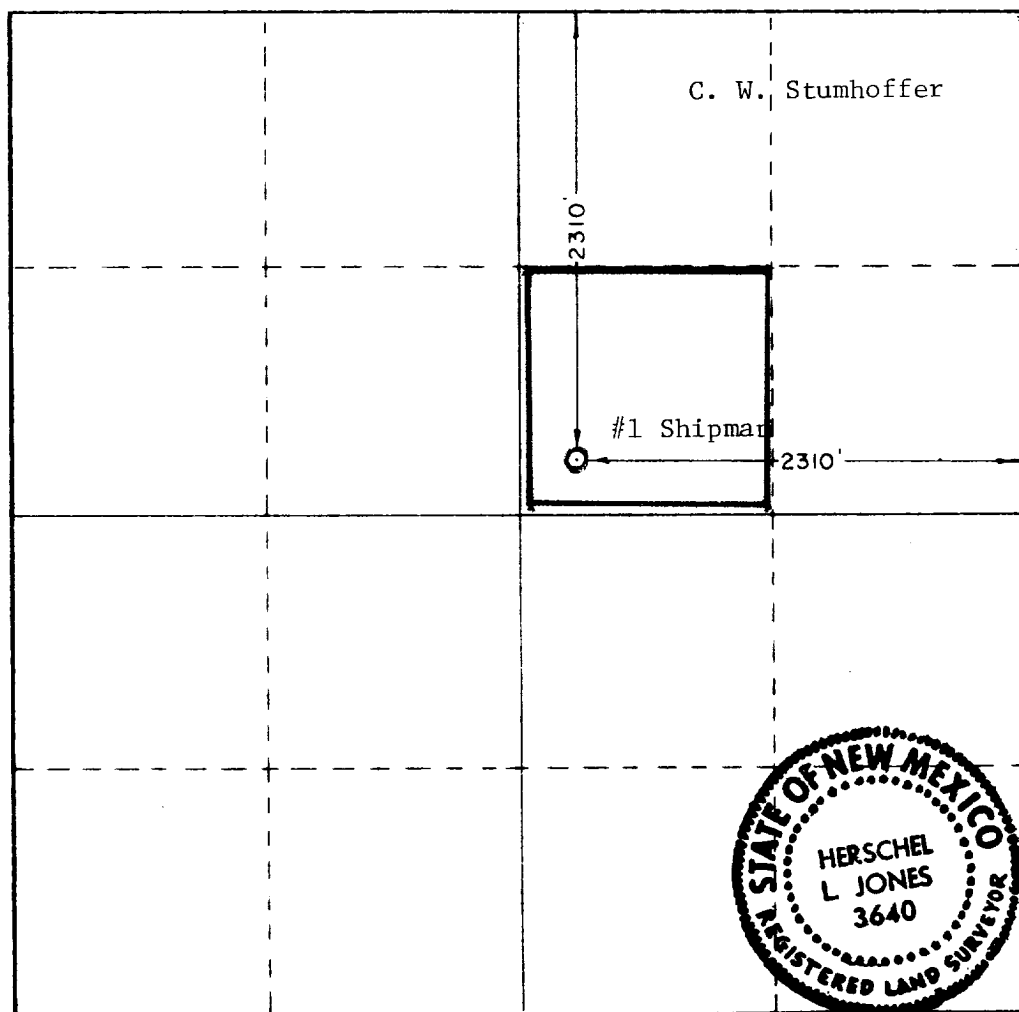

CERTIFICATION

I hereby certify that the information contained herein is true and complete to the best of my knowledge and belief.

Name
C.W. Stumhoffer

Position
Operator

Company
Individual

Date
July 1, 1982

I hereby certify that the well location shown on this plat was plotted from field notes of actual surveys made by me or under my supervision, and that the same is true and correct to the best of my knowledge and belief.

Date Surveyed
June 1, 1982

Registered Professional Engineer and/or Land Surveyor

Certificate No.

3640

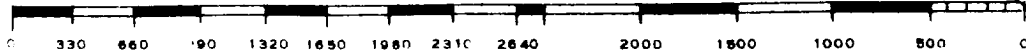

RECEIVED

JUL 6 1982

G.C.D.
HOBBS OFFICE

1982 JUL 6 11 11 AM
FBI



Petrochem Information

© - Copyright - Reproduction Prohibited

COUNTY	LEA	FIELD	Langlie-Mattix	STATE	NM
OPR	STUMHOFFER, C.W.			AFI	30-025-27882
NO	1	LEASE	Shipman	MAP	
	Sec 35, T22S, R37E			CO-ORD	
	2310 FNL, 2310 FEL of Sec				
	6 mi S/Eunice				
		SPD		CMP	
CSG	WELL CLASS: INIT D		FIN	LSE. CODE	
	FORMATION	DATUM		FORMATION	DATUM
	TD			PBD	

CONTR	OPRSELEV 3297 GL	sub-s
F.R. 7-12-82		
PD 3670 RT (Queen)		

IC 30-025-70554-82

COUNTY LEA FIELD Langlie-Mattix STATE NM
 OPER STUMHOFFER, C. W. API 30-025-27882
 LEASE Shipman MAP
 Sec 35, T22S, R37E (CORD)
2310 FNL, 2310 FEL of Sec 10-1-35 NM
6 mi S/Eunice SPD 7-6-82 CMP 9-1-82

8 5/8-1177-600 sx
 4 1/2-3654-2600 sx
 2 3/8-3578

WELL CLASS INIT D FINDO LSE CODE			
FORMATION	DATUM	FORMATION	DATUM
TD 3685 (QUEN)		PBD 3636	

IP (Queen) Perfs 3561-3632 P 7 BOPD + 20 BW. Pot based
 on 24 hr test. GOR 2143; gty 36

CONTR WEK #1 OPERSTEV 3297 GL sub-s 7

F.R. 7-12-82
 PD 3670 RT (Queen)
 7-20-82 TD 3685; WOCU
 7-26-82 TD 3685; PBD 3654; SI
 Perf (Queen) 3642-50 w/1 SPF
 Acid (3642-50) 750 gals
 8-3-82 TD 3685; PBD 3636; WOPU
 PB to 3636
 Perf (Queen) 3561-3632
 Acid (3561-3632) 2000 gals
 Frac (3561-3632) 40,000 gals + 58,000# sd
 9-8-82 TD 3685; PBD 3636; WOSE
 Ppd 7 BO + 20 BW in 24 hrs (3561-3632)
 9-27-82 TD 3685; PBD 3636; Complete
 LOG TOPS: Base Salt 2454, Yates 2600,
 Seven Rivers 2870, Queen 3410
 10-2-82 COMPLETION ISSUED
 10-1-35 NM
 IC 30-025-70554-82