

NEW MEXICO OIL CONSERVATION COMMISSION
WELL LOCATION AND ACREAGE DEDICATION PLAT

Form C-102
Supersedes C-128
Effective 1-1-65

All distances must be from the outer boundaries of the Section

| | | | | |
|--|-------------------------------------|-------------------------------|---------------------------------------|------------------------|
| Operator Sun Exploration & Production Co. | | Lease State A AC 1 | | Well No. 115 |
| Unit Letter F | Section 9 | Township 23S | Range 36E | County LEA |
| Actual Footage Location of Well: 1700 feet from the North line and 1980 feet from the West line | | | | |
| Ground Level Elev 3465.6 | Producing Formation Queen | Pool Langlie Mattix | Dedicated Acreage: 40 Acres | |

1. Outline the acreage dedicated to the subject well by colored pencil or hachure marks on the plat below
2. If more than one lease is dedicated to the well, outline each and identify the ownership thereof (both as to working interest and royalty).
3. If more than one lease of different ownership is dedicated to the well, have the interests of all owners been consolidated by communitization, unitization, force-pooling, etc?

☐ Yes ☐ No If answer is "yes," type of consolidation _____

If answer is "no," list the owners and tract descriptions which have actually been consolidated (Use reverse side of this form if necessary.) _____

No allowable will be assigned to the well until all interests have been consolidated (by communitization, unitization, forced-pooling, or otherwise) or until a non-standard unit, eliminating such interests, has been approved by the Commission.

CERTIFICATION

I hereby certify that the information contained herein is true and complete to the best of my knowledge and belief

Name
Maria L. Perez
Position
Sr. Accounting Asst.
Company
Sun Exploration & Production Co
Date
9-28-82

I hereby certify that the well location shown on this plat was plotted from field notes of actual surveys made by me or under my supervision, and that the same is true and correct to the best of my knowledge and belief.

9/11/82

Date Surveyed

Registered Professional Engineer and/or Land Surveyor

John W. West

Certificate No **JOHN W. WEST 676**
PATRICK A. ROMERO 6868
Ronald J. Edison 3239

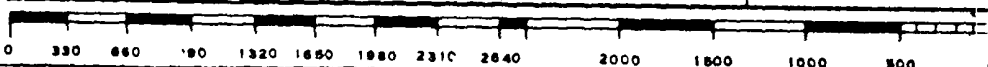
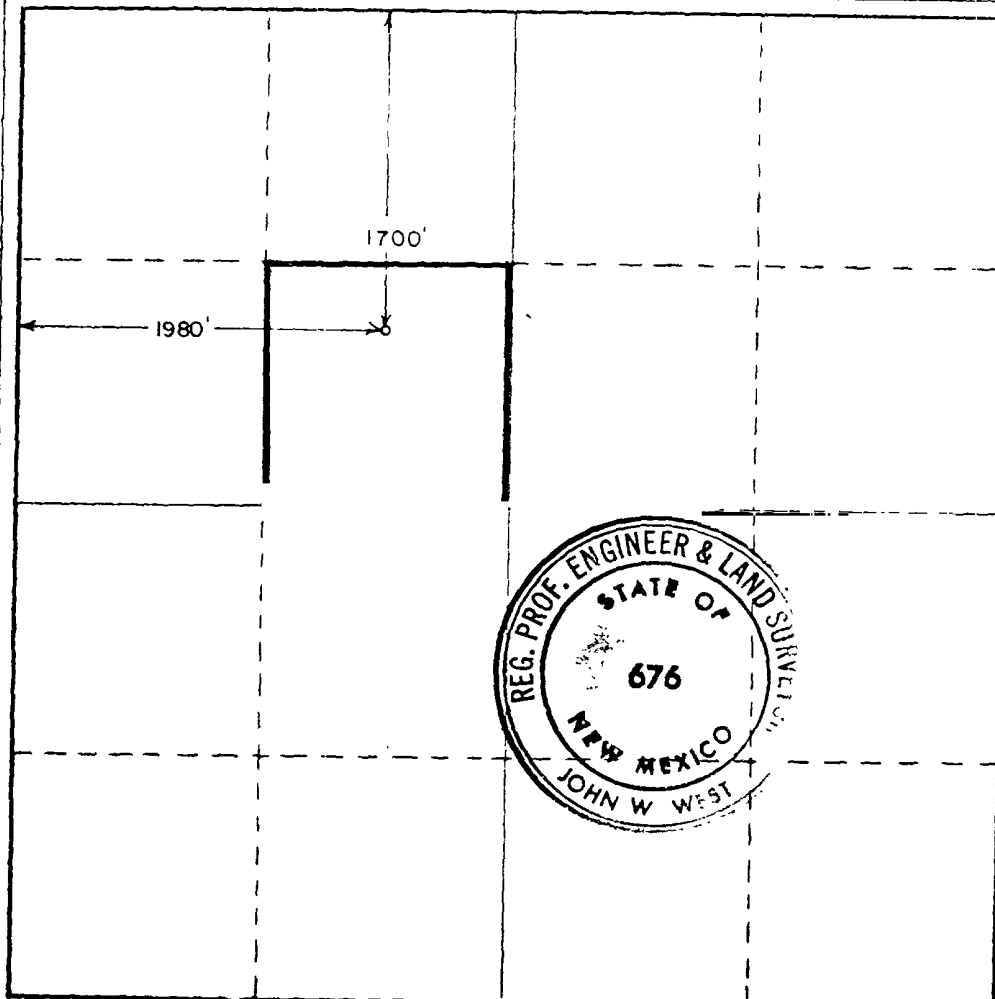
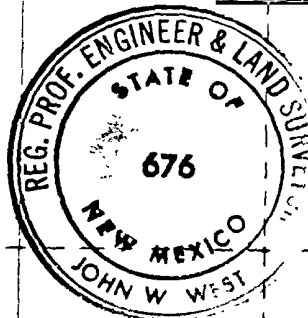

COUNTY LEA FIELD Langlie-Mattix STATE NM
 OPR SUN EXPLORATION & PRODUCTION CO. API-30-05-27962
 15 LEASE State "A" A/C-1 MAP
 Sec 9, T23S, R36E CO-ORD
 1700 FNL, 1980 FWL of Sec 4-2-30 NM
 11 mi SW/Eunice SPD 11-19-82 CMP 3-4-83

| | | | | |
|--|-------------------------------------|-------|-----------|-------|
| CSC 8 5/8-572-375 sx 5 1/2-3850-950 sx 2 7/8-2501 | WELL CLASS: INIT D FIN DO LSE. CODE | | | |
| | FORMATION | DATUM | FORMATION | DATUM |
| | | | | |
| | | | | |
| | | | | |
| | TD 3850 (QUEN) | | PBD 3817 | |

IP (Seven Rivers) Perfs 3708-68 P 17 BOPD + 517 BW. Pot
 based on 24 hr test. GOR 4588; gty 33.4

CONTR Kenai #10 OPRS ELEV 3480 GL sub-s 10

F.R. 10-4-82
 PD 3950 RT (Queen)
 11-29-82 TD 3850; WOCT
 1-4-83 TD 3850; PBD 3817; Tstg
 Perf (Seven Rivers) 3708-18, 3742-46,
 3762-68 w/2 SPF
 Acid (3708-68) 3000 gals
 Swbd 30 BLW w/tr oil in 2 hrs (3708-68)
 1-18-83 TD 3850; PBD 3817; Tstg
 Frac (3708-68) 12,500 gals + 12,500 gals
 CO2 + 46,500# sd
 Flwd 39 BW in 4 1/2 hrs (3708-68)
 2-14-83 TD 3850; PBD 3817; Tstg
 Ppd 8 BO + 328 BW in 24 hrs (3708-68)
 4-4-83 TD 3850; PBD 3817; Complete
 LOG TOPS: Salt 1327, Base Salt 2933,
 Yates 3136, Seven Rivers 3145, Queen 3147
 4-2-80

~~LEA~~
SUN EXPLORATION &
PRODUCTION CO.

Langlie-Mattix
15 State "A" A/C-1
Sec 9, T23S, R36E

NM
Page #2

4-4-83

Continued
LOGS RUN: CCL, GRL
Rig Released 11-28-82
COMPLETION ISSUED

4-9-83

4-2-30 NM
IC 30-025-70755-82