

Submit to Appropriate
District Office
State Lease - 6 copies
Fee Lease - 5 copies

State of New Mexico
Energy, Minerals and Natural Resources Department

Form C-101
Revised 1-1-89

OIL CONSERVATION DIVISION

DISTRICT I
P.O. Box 1980, Hobbs, NM 88240

DISTRICT II
P.O. Drawer DD, Artesia, NM 88210

DISTRICT III
1000 Rio Brazos Rd., Aztec, NM 87410

P.O. Box 2088
Santa Fe, New Mexico 87504-2088

API NO. (assigned by OCD on New Wells)
30-025-28310

5. Indicate Type of Lease

STATE ☐

FEE ☒

6. State Oil & Gas Lease No.

APPLICATION FOR PERMIT TO DRILL, DEEPEN, OR PLUG BACK

1a. Type of Work:

DRILL ☐

RE-ENTER ☐

DEEPEN ☐

PLUG BACK ☒

b. Type of Well:

OIL

WELL ☒

GAS

WELL ☐

OTHER ☐

SINGLE
ZONE ☒

MULTIPLE
ZONE ☐

7. Lease Name or Unit Agreement Name

Sims

2. Name of Operator

Phillips Petroleum Company

8. Well No.

10

3. Address of Operator

4001 Penbrook Street, Odessa, TX 79762

9. Pool name or Wildcat

*Tubb Oil & Undesignated

4. Well Location

Unit Letter E

: 1980

Feet From The North

Line and 550

Feet From The West

Line

Section 24

Township 22-S

Range 37-E

NMPM Lea

County

10. Proposed Depth
8107'

11. Formation

Tubb or Glorieta

12. Rotary or C.T.
Rotary

13. Elevations (Show whether DF, RT, GR, etc.)
3317.5' GR

14. Kind & Status Plug. Bond
Blanket

15. Drilling Contractor
NA

16. Approx. Date Work will start
Upon Approval

17.

PROPOSED CASING AND CEMENT PROGRAM

SIZE OF HOLE	SIZE OF CASING	WEIGHT PER FOOT	SETTING DEPTH	SACKS OF CEMENT	EST. TOP
17-1/2"	13-3/8"	54.5#	1130'	800 sx.	Surface
11"	8-5/8"	32# & 24#	2997'	1400 sx.	Surface
7-7/8"	5-1/2"	15.5#	8107'	1600 sx.	Surface

* Will test both zones.

1. MI&RU DDU. COOH w/rods and pump. Install Class II BOP.
2. COOH w/2-3/8" tubing.
3. Perforate the Tubb w/1 SPF using a 4" csg. gun with 23 gram premium charges. 6015'-6089' =17 holes.
4. GIH w/5-1/2" 15.5# CIBP and set at +/- 6,200'. Dump 3 sx. of cement on top of CIBP.
5. RIH w/pkr on 2-7/8" workstring. Swab.
6. Set pkr. at 5,940'. Load backside with 2% KCL brine and pressure to 500 psi.
7. Acidize the Tubb w/2100 gallons 15% NeFe HCL acid.
8. Swab.

(Over)

IN ABOVE SPACE DESCRIBE PROPOSED PROGRAM: IF PROPOSAL IS TO DEEPEN OR PLUG BACK, GIVE DATA ON PRESENT PRODUCTIVE ZONE AND PROPOSED NEW PRODUCTIVE ZONE. GIVE BLOWOUT PREVENTER PROGRAM, IF ANY.

I hereby certify that the information above is true and complete to the best of my knowledge and belief.

SIGNATURE

L. M. Sanders

TITLE

Supv., Regulatory Affairs

DATE 08-13-93

TYPE OR PRINT NAME L. M. Sanders

(915)

TELEPHONE NO. 368-1488

(This space for State Use)

Orig. Signed by
Paul Kautz
Geologist

APPROVED BY

TITLE

DATE AUG 18 1993

CONDITIONS OF APPROVAL, IF ANY:

Sims No. 10
Tubb Oil & Undesignated Glorieta
API No. 30-025-28310
Lea County, New Mexico
Form C-101

9. Frac well with 24,000 gallons CO2 foam carrying 64,000 lbs. 16/30 Ottawa Sand @12 BPM.
10. Flow/swab well to production. Evaluate. Decision will be made to either produce the Tubb or to abandon in favor of testing the Glorieta.
11. Release pkr. and COOH w/2-7/8" tubing.
12. Perforate the Glorieta w/4 SPF using a 4" csg. gun with 23 gram premium charges 5023' - 5050' = 112 Holes.
13. RIH w/pkr. on 2-7/8" workstring. Swab.
14. Test surface lines to 4,000 psi.
15. Set pkr. at $\pm 4,948'$. Load backside with 2% KCL brine and pressure to 500 psi.
16. Acidize the Glorieta with 2800 gallons 15% HCL acid.
17. Swab back load. If well is non-productive, it will be temporarily abandoned.
18. COOH w/2-7/8" workstring.
19. GBIH w/prod. equip. as before. Decision to upgrade lift equipment will be based upon production results.

08-13-93
AF:Ehg

RegPro:AFran:Sims10.101

Submit to Appropriate
District Office
State Lease - 4 copies
Fee Lease - 3 copies

State of New Mexico
Energy, Minerals and Natural Resources Department

Form C-102
Revised 1-1-89

OIL CONSERVATION DIVISION

DISTRICT I
P.O. Box 1980, Hobbs, NM 88240

P.O. Box 2088
Santa Fe, New Mexico 87504-2088

DISTRICT II
P.O. Drawer DD, Artesia, NM 88210

DISTRICT III
1000 Rio Brazos Rd., Aztec, NM 87410

WELL LOCATION AND ACREAGE DEDICATION PLAT

All Distances must be from the outer boundaries of the section

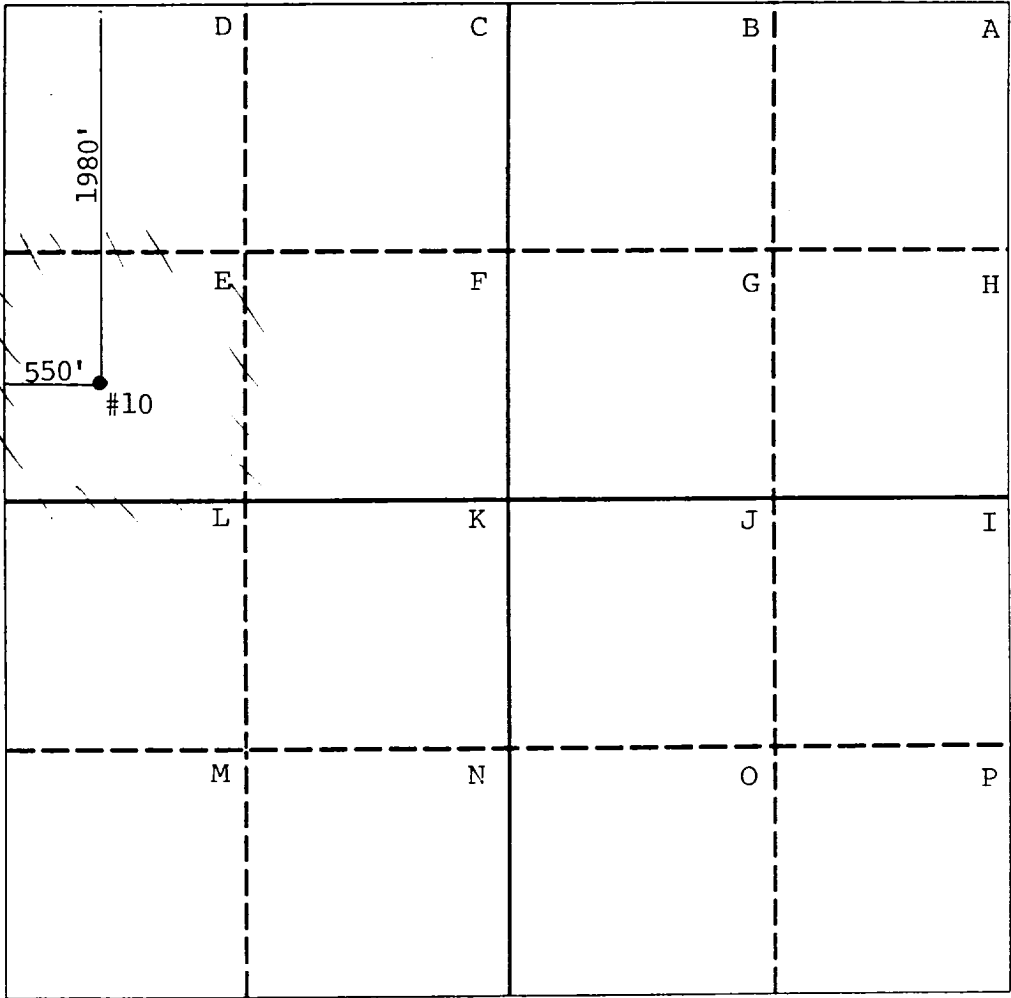
Operator Phillips Petroleum Company			Lease Sims		Well No. 10
Unit Letter E	Section 24	Township 22-S	Range 37-E	County Lea	
Actual Footage Location of Well: 1980 feet from the North line and 550 feet from the West line					
Ground level Elev. 3317.5' GL		Producing Formation Glorieta		Pool Undesignated (Glorieta)	Dedicated Acreage: 40 Acres
<p>1. Outline the acreage dedicated to the subject well by colored pencil or hatchure marks on the plat below.</p> <p>2. If more than one lease is dedicated to the well, outline each and identify the ownership thereof (both as to working interest and royalty).</p> <p>3. If more than one lease of different ownership is dedicated to the well, have the interest of all owners been consolidated by communitization, unitization, force-pooling, etc.? <input type="checkbox"/> Yes <input type="checkbox"/> No If answer is "yes" type of consolidation _____</p> <p>If answer is "no" list the owners and tract descriptions which have actually been consolidated. (Use reverse side of this form if necessary.) _____</p> <p>No allowable will be assigned to the well until all interests have been consolidated (by communitization, unitization, forced-pooling, or otherwise) or until a non-standard unit, eliminating such interest, has been approved by the Division.</p>					
				OPERATOR CERTIFICATION I hereby certify that the information contained herein is true and complete to the best of my knowledge and belief. Signature: <i>L. M. Sanders</i> Printed Name: L. M. Sanders Position: Supv., Reg. Affairs Company: Phillips Petroleum Co. Date: 8/13/93	
				SURVEYOR CERTIFICATION I hereby certify that the well location shown on this plat was plotted from field notes of actual surveys made by me or under my supervision, and that the same is true and correct to the best of my knowledge and belief. Date Surveyed: _____ Signature & Seal of Professional Surveyor: _____ Certificate No.: _____	

Submit to Appropriate
District Office
State Lease - 4 copies
Fee Lease - 3 copies

State of New Mexico
Energy, Minerals and Natural Resources Department

Form C-102
Revised 1-1-89

OIL CONSERVATION DIVISION

P.O. Box 2088

Santa Fe, New Mexico 87504-2088

DISTRICT I

P.O. Box 1980, Hobbs, NM 88240

DISTRICT II

P.O. Drawer DD, Artesia, NM 88210

DISTRICT III

1000 Rio Brazos Rd., Aztec, NM 87410

WELL LOCATION AND ACREAGE DEDICATION PLAT

All Distances must be from the outer boundaries of the section

Operator Phillips Petroleum Company			Lease Sims		Well No. 10
Unit Letter E	Section 24	Township 22-S	Range 37-E	County Lea	
Actual Footage Location of Well: 1980 feet from the North line and 550 feet from the West line					
Ground level Elev. 3317.5' GL		Producing Formation Tubb		Pool Tubb Oil	
				Dedicated Acreage: 40 Acres	

- Outline the acreage dedicated to the subject well by colored pencil or hatchure marks on the plat below.
- If more than one lease is dedicated to the well, outline each and identify the ownership thereof (both as to working interest and royalty).
- If more than one lease of different ownership is dedicated to the well, have the interest of all owners been consolidated by communitization, unitization, force-pooling, etc?
☐ Yes ☐ No If answer is "yes" type of consolidation _____
If answer is "no" list the owners and tract descriptions which have actually been consolidated. (Use reverse side of this form if necessary). _____
No allowable will be assigned to the well until all interests have been consolidated (by communitization, unitization, forced-pooling, or otherwise) or until a non-standard unit, eliminating such interest, has been approved by the Division.

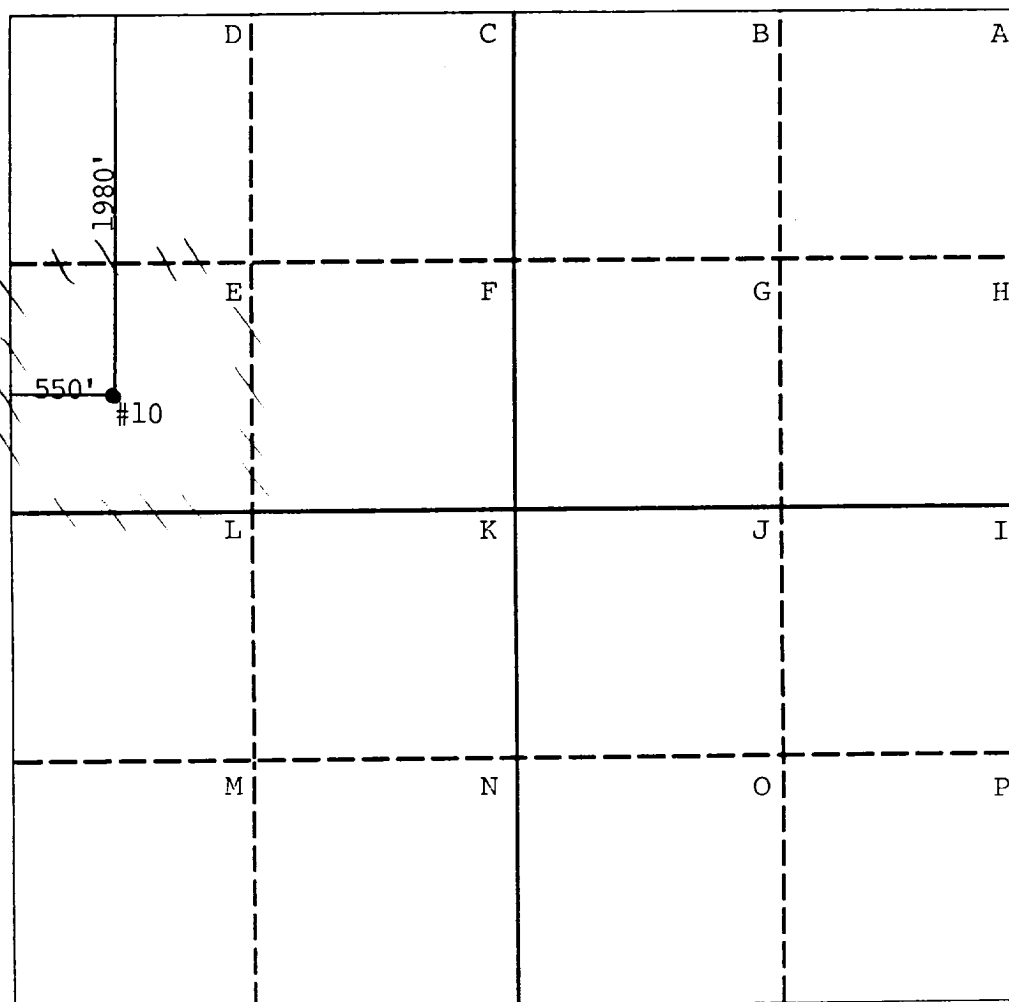

OPERATOR CERTIFICATION

I hereby certify that the information contained herein is true and complete to the best of my knowledge and belief.

Signature

L. M. Sanders

Printed Name

L. M. Sanders

Position

Supv., Reg. Affairs

Company

Phillips Petroleum Co.

Date

8/13/93

SURVEYOR CERTIFICATION

I hereby certify that the well location shown on this plat was plotted from field notes of actual surveys made by me or under my supervision, and that the same is true and correct to the best of my knowledge and belief.

Date Surveyed

Signature & Seal of
Professional Surveyor

Certificate No.