

UNITED STATES  
DEPARTMENT OF THE INTERIOR  
GEOLOGICAL SURVEY

**SUNDRY NOTICES AND REPORTS ON WELLS**

(Do not use this form for proposals to drill or to deepen or plug back to a different reservoir. Use Form 9-331-C for such proposals.)

1. oil well ☐ gas well ☐ other, Dry Hole ☒  
2. NAME OF OPERATOR Belco Development Corporation  
3. ADDRESS OF OPERATOR One Petroleum Center,  
Building 6, Suite 201 Midland, Texas 79705  
4. LOCATION OF WELL (REPORT LOCATION CLEARLY. See space 17  
below.)  
AT SURFACE: 990' FSL & 1940' FEL  
AT TOP PROD. INTERVAL:  
AT TOTAL DEPTH:

16. CHECK APPROPRIATE BOX TO INDICATE NATURE OF NOTICE,  
REPORT, OR OTHER DATA

REQUEST FOR APPROVAL TO:

SUBSEQUENT REPORT OF:

TEST WATER SHUT-OFF ☐  
FRACTURE TREAT ☐  
SHOOT OR ACIDIZE ☐  
REPAIR WELL ☐  
PULL OR ALTER CASING ☐  
MULTIPLE COMPLETE ☐  
CHANGE ZONES ☐  
ABANDON\* ☐  
(other) Drilling to TD.

☐  
☐  
☐  
☐  
☐  
☐  
☐  
☐  
☐

17. DESCRIBE PROPOSED OR COMPLETED OPERATIONS (Clearly state all pertinent details, and give pertinent dates, including estimated date of starting any proposed work. If well is directionally drilled, give subsurface locations and measured and true vertical depths for all markers and zones pertinent to this work.)\*

Spud @ 7 PM 12-31-83. Drill 17-1/2" hole to 656'. Run 13-3/8", 54.5#, K-55, STC casing as follows: shoe, 1 jt casing, float collar, 16 jts casing. Total of 659.02', set @ 645'. Cement w/500 sx Lite + 3% salt + 1/4#/sk celloflakes. Tail in w/200 sx Class "C" + 2% CaCl<sub>2</sub>. Circulate 55 sks to surface. Bump plug with 800 psi @ 11 PM 1-11-84. Float held OK. WOC 16-1/2 hrs. Drill float collar and cement. Test casing to 600 psi. OK. Drill 12-1/4" hole to 3500'. Run 10-3/4", 45.5#, K-55, STC casing as follows: shoe, 1 joint casing, float collar, 89 joints casing. Total of 3526.94'. Set @ 3498'. Cement w/800 sxs Lite + 3% salt + 1/4#/sk Celloflake. Tail in w/200 sxs Class "C" + 1% CaCl<sub>2</sub> + 1/4#/sk Celloflake. Circulate 185 sks to surface. Bump plug w/1500 psi @ 8:30 AM 1-25-84. Float held OK. NU BOP's. Test BOP's to 2000 psi. OK. WOC 47-1/2 hrs. Drill float collar and cement. Test casing to 1000 psi. OK. Drill 9-7/8" hole to 4992'. Run 7-5/8" casing as follows: float shoe, 1 jt 33.70#, P110, flush joint casing, (con't on back)  
Subsurface Safety Valve: Manu. and Type \_\_\_\_\_ Set @ \_\_\_\_\_ Ft.

18. I hereby certify that the foregoing is true and correct

SIGNED L. W. Helms, Jr TITLE Drilling Engineer DATE 11-6-84

(This space for Federal or State office use)

APPROVED BY [Signature] TITLE \_\_\_\_\_ DATE \_\_\_\_\_  
CONDITIONS OF APPROVAL IF ANY: NOV 27 1984

Carlson

5. LEASE NM - 13641	
6. IF INDIAN, ALLOTTEE OR TRIBE NAME	
7. UNIT AGREEMENT NAME	
8. FARM OR LEASE NAME APD Federal	
9. WELL NO. 1	
10. FIELD OR WILDCAT NAME Antelope Ridge - Cherry Canyon	
11. SEC., T., R., M. OR BLK. AND SURVEY OR AREA Sec 10, T-23-S, R-34-E	
12. COUNTY OR PARISH Lea	13. STATE New Mexico
14. API NO. 30-025-28554	
15. ELEVATIONS (SHOW DF, KDB, AND WD) KB 3403, DF 3402, GL 3387	

(NOTE: Report results of multiple completion or zone change on Form 9-330.)

## Instructions

**General:** This form is designed for submitting proposals to perform certain well operations, and reports of such operations when completed, as indicated, on Federal and Indian lands pursuant to applicable Federal law and regulations, and, if approved or accepted by any State, on all lands in such State, pursuant to applicable State law and regulations. Any necessary special instructions concerning the use of this form and the number of copies to be submitted, particularly with regard to local, area, or regional procedures and practices, either are shown below or will be issued by, or may be obtained from, the local Federal and/or State office.

**Item 4:** If there are no applicable State requirements, locations on Federal or Indian land should be described in accordance with Federal requirements. Consult local State or Federal office for specific instructions.

**Item 17:** Proposals to abandon a well and subsequent reports of abandonment should include such special information as is required by local Federal and/or State offices. In addition, such proposals and reports should include reasons for the abandonment; data on any former or present productive zones, or other zones with present significant fluid contents not sealed off by cement or otherwise; depths (top and bottom) and method of placement of cement plugs; mud or other material placed below, between and above plugs; amount, size, method of parting of any casing, liner or tubing pulled and the depth to top of any left in the hole; method of closing top of well; and date well site conditioned for final inspection looking to approval of the abandonment.

GPO : 1976 O - 214-149

40 jts 26.40#, N-80, LTC casing. Total of 4920.34'. Set @ 4917'. Cement w/1330 sxs pacesetter Lite C + 5% salt + 0.2% AFS. Tail in w/200 sxs Class "C" + 1% CaCl<sub>2</sub>. Bump plug w/1500 psi @ 7:49 PM 2-2-84. WOC 34-1/2 hrs. Drill float collar. Test casing to 1000 psi. OK. Drill 6-1/2" hole to 7188'. TD @ 3 PM 2-8-84. Run following logs: GR/CNL/FDC, DIL/SFL, EPT. Prep to P&A. Spot 40 sxs Class "H" cement from 4970-4870'. Cut 7 5/8" casing @ 3310'. POH w/3310' of 7 5/8" casing. Spot 50 sxs Class "H" cement w/3% CaCl<sub>2</sub> from 3360 to 3250'. WOC 5 hrs. Tag cement plug with wireline @ 3250'. Spot 10 sxs Class "H" cement @ surface. Weld steel plate on top of cutoff. Erect dry hole marker. Well P & A'd 2-11-84.

per Telcon w/ Bill Helms  
11/13/84 JWS Q

NOV 15 1984

DEPARTMENT OF THE INTERIOR  
GEOLOGICAL SURVEY

SUNDRY NOTICES AND REPORTS ON WELLS

(Do not use this form for proposals to drill or to deepen or plug back to a different reservoir. Use Form 9-331-C for such proposals.)

1. oil well ☒ gas well ☐ other ☐

2. NAME OF OPERATOR  
Belco Development Corporation

3. ADDRESS OF OPERATOR  
411 Petroleum Bldg.  
Midland, Texas 79701

4. LOCATION OF WELL (REPORT LOCATION CLEARLY. See space 17 below.)  
AT SURFACE: 990' FSL \$ 1940' E Section 7  
AT TOP PROD. INTERVAL:  
AT TOTAL DEPTH:

16. CHECK APPROPRIATE BOX TO INDICATE NATURE OF NOTICE, REPORT, OR OTHER DATA

REQUEST FOR APPROVAL TO:

SUBSEQUENT REPORT OF:

TEST WATER SHUT-OFF ☐  
FRACTURE TREAT ☐  
SHOOT OR ACIDIZE ☐  
REPAIR WELL ☐  
PULL OR ALTER CASING ☐  
MULTIPLE COMPLETE ☐  
CHANGE ZONES ☐  
ABANDON\* ☐  
(other) Spud ☐

☐  
☐  
☐  
☐  
☐  
☐  
☐  
☐

5. LEASE NM 13641

6. IF INDIAN, ALLOTTEE OR TRIBE NAME

7. UNIT AGREEMENT NAME

8. FARM OR LEASE NAME  
~~300~~ Federal APD

9. WELL NO. #1

10. FIELD OR WILDCAT NAME  
Antelope Ridge-Cherry Canyon

11. SEC., T., R., M., OR BLK. AND SURVEY OR AREA  
Sec. 10, T23S, R34E

12. COUNTY OR PARISH Lea 13. STATE NM

14. API NO.  
30-025-28554

15. ELEVATIONS (SHOW DF, KDB, AND WD)  
3387' GR

(NOTE: Report results of multiple completion or zone change on Form 9-330.)

17. DESCRIBE PROPOSED OR COMPLETED OPERATIONS (Clearly state all pertinent details, and give pertinent dates, including estimated date of starting any proposed work. If well is directionally drilled, give subsurface locations and measured and true vertical depths for all markers and zones pertinent to this work.)\*

1. Spudded 12-31-1983, at 7:PM MST.
2. Set 20" conductor to 40'. Cmt w/redimix.  
Drld 10' of 8½" hole to 50'.

Subsurface Safety Valve: Manu. and Type \_\_\_\_\_ Set @ \_\_\_\_\_ Ft.

18. I hereby certify that the foregoing is true and correct

SIGNED Adel B. Johnson TITLE Receptionist DATE 1-5-84

(This space for Federal or State office use)

APPROVED BY \_\_\_\_\_ TITLE \_\_\_\_\_ DATE \_\_\_\_\_  
CONDITIONS OF APPROVAL, IF ANY:

ACCEPTED FOR RECORD

RAJ  
JAN 10 1984

\*See Instructions on Reverse Side

ROSWELL, NEW MEXICO

1990年12月22日  
 中国科学院植物研究所  
 北京 100871

RECEIVED  
JAN 13 1984  
O.C.D.  
HOBBS OFFICE

30-025-28554

RECEIVED  
DEC 27 1983  
OIL & GAS  
ROSEWELL, NEW MEXICO

## APPLICATION FOR PERMIT TO DRILL, DEEPEN, OR PLUG BACK

## 1a. TYPE OF WORK

DRILL ☒DEEPEN ☐PLUG BACK ☐

## b. TYPE OF WELL

OIL  
WELL ☒GAS  
WELL ☐OTHER ☐

## 2. NAME OF OPERATOR

Belco Development Corporation

## 3. ADDRESS OF OPERATOR

10,000 Old Katy Road, Suite 100, Houston, Texas 77055

## 4. LOCATION OF WELL (Report location clearly and in accordance with any State requirements.)\*

At surface

990' FSL &amp; 1940' FEL Section 7

At proposed prod. zone

990' FSL &amp; 1940' FEL Section 7

## 14. DISTANCE IN MILES AND DIRECTION FROM NEAREST TOWN OR POST OFFICE\*

21 miles NW of Jal, N.M.

## 15. DISTANCE FROM PROPOSED\*

LOCATION TO NEAREST  
PROPERTY OR LEASE LINE, FT.  
(Also to nearest drlg. unit line, if any)

990'

## 16. NO. OF ACRES IN LEASE

400

17. NO. OF ACRES ASSIGNED  
TO THIS WELL

40

## 18. DISTANCE FROM PROPOSED LOCATION\*

TO NEAREST WELL, DRILLING, COMPLETED,  
OR APPLIED FOR, ON THIS LEASE, FT.

1000'

## 19. PROPOSED DEPTH

7500'

## 20. ROTARY OR CABLE TOOLS

Rotary

## 21. ELEVATIONS (Show whether DF, RT, GR, etc.)

3387' GR

## 22. APPROX. DATE WORK WILL START\*

12-30-83

## 23.

## PROPOSED CASING AND CEMENTING PROGRAM

SIZE OF HOLE	SIZE OF CASING	WEIGHT PER FOOT	SETTING DEPTH	QUANTITY OF CEMENT
26"	20" New	94#	40'	Redi Mix <b>CIRCULATE</b>
17½"	13-3/8" New	54.50#	600'	500 sx <b>CIRCULATE</b>
12¼"	10-3/4"	45.50#	3500'	950 sx <i>See Start</i>
9-7/8"	7-5/8" Liner	26.40#	5000'	600 sx
6-3/4"	5" Liner	18#		

1. The formation @ surface is Quaternary Alluvium, mainly sand dunes.
2. Est tops: Rustler 213', Cherry Canyon 5721', Brushy Canyon 7152'.
3. Oil in Cherry Canyon & Brushy Canyon.
4. Casing Design: new casing as shown above.
5. BOP Program: 3 BOP 5000#; 1 Hydril, 1 pipe ram, 1 blind ram for shallow depths & deeper depths. Tested upon installation & periodically tested; operated daily. (See schematic).
6. Mud Program: 0-600' fresh, 600'-3400' brine 10.0; 3500'-5000' cut brine 9.0; 5000-7500' non-dispersed to 9.0.
7. Auxiliary: Rotating stripper head below intermediate; lower Kelly cock valve, 5000# choke and choke manifold, drillstring safety valve on floor.
8. Drillstem testings as required; Logging: Guard Forxo; Acou-Neut-Gr.
9. Anticipated startup 12-30-83 will take 35 days to drill to TD.

IN ABOVE SPACE DESCRIBE PROPOSED PROGRAM: If proposal is to deepen or plug back, give data on present productive zone and proposed new productive zone. If proposal is to drill or deepen directionally, give pertinent data on subsurface locations and measured and true vertical depths. Give blowout preventer program, if any.

24.

SIGNED

P. E. Ilavia

TITLE Division Drilling Engineer

DATE 12-22-83

(This space for Federal or State office use)

PERMIT NO.

APPROVAL DATE

APPROVED BY

S/Richard Bastin

TITLE Associate District Manager

DATE DEC 30 1983

CONDITIONS OF APPROVAL, IF ANY:

APPROVAL SUBJECT TO  
GENERAL REQUIREMENTS AND  
SPECIAL STIPULATIONS  
ATTACHED

\*See Instructions On Reverse Side

**MEXICO OIL CONSERVATION COMMISSION  
WELL LOCATION AND ACREAGE DEDICATION PLAT**

Form C-102  
Supersedes C-128  
Effective 1-4-65

All distances must be from the outer boundaries of the Section.

Operator <b>BELCO DEVELOPMENT</b>			Lease <b><del>APD</del> FEDERAL APD</b>		Well No. <b>1</b>
Unit Letter	Section <b>10</b>	Township <b>23-S</b>	Range <b>34-E</b>	County <b>LEA COUNTY, NEW MEXICO</b>	
Actual Footage Location of Well: <div style="display: flex; justify-content: space-between;"> <span><b>990</b> feet from the <b>SOUTH</b> line and</span> <span><b>1940</b> feet from the <b>EAST</b> line</span> </div>					
Ground Level Elev. <b>3387</b>	Producing Formation <b>Cherry Canyon</b>		Pool	Dedicated Acreage: <b>40</b> Acres	

1. Outline the acreage dedicated to the subject well by colored pencil or hatchure marks on the plat below.
2. If more than one lease is dedicated to the well, outline each and identify the ownership thereof (both as to working interest and royalty).
3. If more than one lease of different ownership is dedicated to the well, have the interests of all owners been consolidated by communitization, unitization, force-pooling, etc?

☐ Yes    ☐ No    If answer is "yes," type of consolidation \_\_\_\_\_

If answer is "no," list the owners and tract descriptions which have actually been consolidated. (Use reverse side of this form if necessary.) \_\_\_\_\_

No allowable will be assigned to the well until all interests have been consolidated (by communitization, unitization, forced-pooling, or otherwise) or until a non-standard unit, eliminating such interests, has been approved by the Commission.

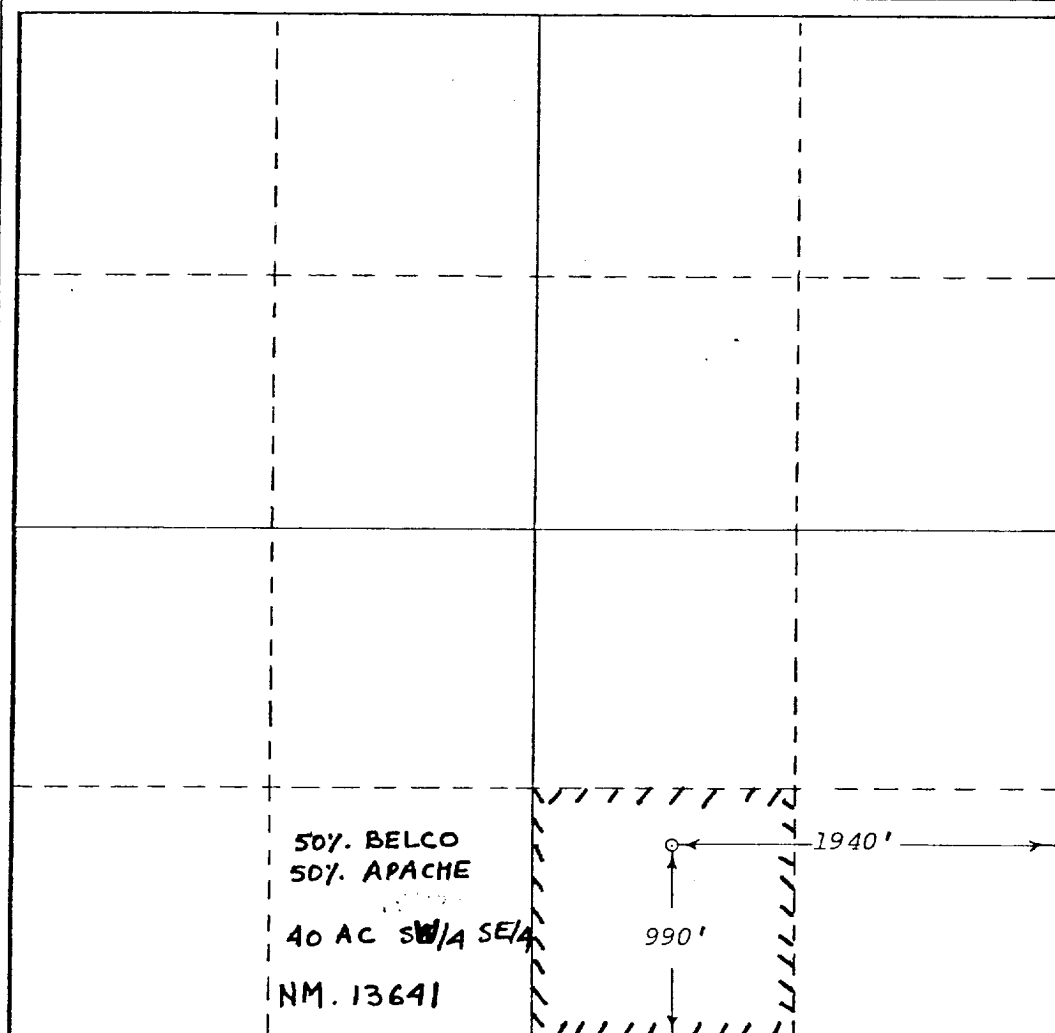

**CERTIFICATION**

I hereby certify that the information contained herein is true and complete to the best of my knowledge and belief.

*ps. Stana*

Name  
Division Drilling Engineer  
Position  
BELCO DEVELOPMENT CORP.  
Company  
December 27, 1983  
Date

I hereby certify that the well location shown on this plat was plotted from field notes of actual surveys made by me or under my supervision and that the same is true and correct to the best of my knowledge and belief.

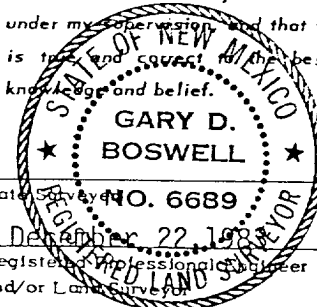

Date Surveyed  
December 22, 1983  
Registered Professional Engineer and/or Land Surveyor

*Gary D. Boswell*  
Certificate No.

6689

0 330 660 990 1320 1650 1980 2310 2640 2000 1500 1000 500 0

NEW MEXICO OIL CONSERVATION COMMISSION  
WELL LOCATION AND ACREAGE DEDICATION PLAT

Form C-102  
Supersedes C-128  
Effective 1-4-65

All distances must be from the outer boundaries of the Section.

Operator <b>BELCO DEVELOPMENT</b>			Lease <b><del>A P D</del> FEDERAL <i>APD</i></b>		Well No. <b>1</b>
Unit Letter	Section <b>10</b>	Township <b>23-S</b>	Range <b>34-E</b>	County <b>LEA COUNTY, NEW MEXICO</b>	
Actual Footage Location of Well: <b>990</b> feet from the <b>SOUTH</b> line and <b>1940</b> feet from the <b>EAST</b> line					
Ground Level Elev. <b>3387</b>	Producing Formation		Pool	Dedicated Acreage:  Acres	

1. Outline the acreage dedicated to the subject well by colored pencil or hatchure marks on the plat below.
2. If more than one lease is dedicated to the well, outline each and identify the ownership thereof (both as to working interest and royalty).
3. If more than one lease of different ownership is dedicated to the well, have the interests of all owners been consolidated by communitization, unitization, force-pooling, etc?  
  
☐ Yes    ☐ No    If answer is "yes," type of consolidation \_\_\_\_\_

If answer is "no," list the owners and tract descriptions which have actually been consolidated. (Use reverse side of this form if necessary.) \_\_\_\_\_

No allowable will be assigned to the well until all interests have been consolidated (by communitization, unitization, forced-pooling, or otherwise) or until a non-standard unit, eliminating such interests, has been approved by the Commission.

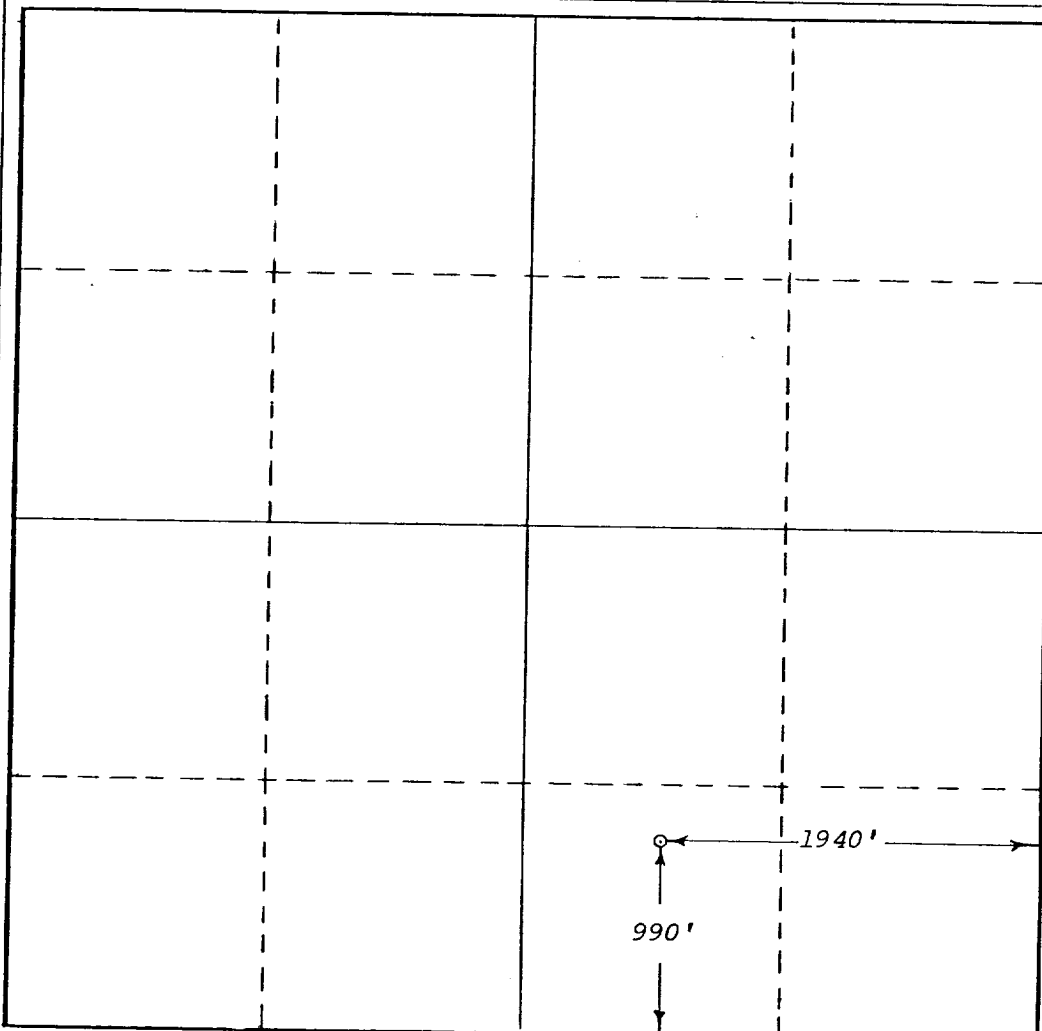

CERTIFICATION

I hereby certify that the information contained herein is true and complete to the best of my knowledge and belief.

Name

Position

Company

Date

I hereby certify that the well location shown on this plat was plotted from field notes of actual surveys made by me or under my supervision, and that the same is true and correct to the best of my knowledge and belief.

Date Surveyed

**December 22, 1983**

Registered Professional Engineer  
and/or Land Surveyor

*Ray D. Bousnell*  
Certificate No.

**6689**

78-20-E

RECEIVED

JAN 3 1984

O.C.D.  
HOBBS OFFICE