

OIL CONSERVATION DIVISION  
P. O. BOX 2088  
SANTA FE, NEW MEXICO 87501

Form C-103  
Revised 10-1-78

NO. OF COPIES RECEIVED	
DISTRIBUTION	
SANTA FE	
FILE	
U.S.G.S.	
LAND OFFICE	
OPERATOR	

5a. Indicate Type of Lease  
State ☐ Fee ☐  
5. State Oil & Gas Lease No.

SUNDRY NOTICES AND REPORTS ON WELLS  
(DO NOT USE THIS FORM FOR PROPOSALS TO DRILL OR TO DEEPEN OR PLUG BACK TO A DIFFERENT RESERVOIR.  
USE "APPLICATION FOR PERMIT -" (FORM C-101) FOR SUCH PROPOSALS.)

OIL WELL ☐ GAS WELL ☐ OTHER-

Name of Operator

Address of Operator

Location of Well

UNIT LETTER \_\_\_\_\_ FEET FROM THE \_\_\_\_\_ LINE AND \_\_\_\_\_ FEET FROM

THE \_\_\_\_\_ LINE, SECTION \_\_\_\_\_ TOWNSHIP \_\_\_\_\_ RANGE \_\_\_\_\_ NMPM.

15. Elevation (Show whether DF, RT, GR, etc.)

7. Unit Agreement Name

8. Farm or Lease Name  
Metex Supply "A"

9. Well No.  
4

10. Field and Pool, or Wildcat

12. County

6. Check Appropriate Box To Indicate Nature of Notice, Report or Other Data  
NOTICE OF INTENTION TO: SUBSEQUENT REPORT OF:

PERFORM REMEDIAL WORK ☐  
TEMPORARILY ABANDON ☐  
PULL OR ALTER CASING ☐  
OTHER ☐

PLUG AND ABANDON ☐  
CHANGE PLANS ☐  
OTHER ☐

REMEDIAL WORK ☐  
COMMENCE DRILLING OPNS. ☐  
CASING TEST AND CEMENT JOBS ☐  
OTHER ☐

ALTERING CASING ☐  
PLUG AND ABANDONMENT ☐  
OTHER ☐

7. Describe Proposed or Completed Operations (Clearly state all pertinent details, and give pertinent dates, including estimated date of starting any proposed work) SEE RULE 1705. Continued from Page 1:

9. 10-2-84 RURU Drilled out 1233' of cement in 5½" csg.
10. 10-4-84 RU B.J. Hughes. Pumped 200 SX BJ Lite cement thru D.V. tool followed w/ 100 SX thickset cement. Held cement in balance for 3 hrs. Flow up thru braidenhead quit.
11. 10-5-84 RU BJ Hughes. Pumped 300 SX Class "C" cement & 60 SX thickset cement in 2 stages to try to shut off braidenhead flow. After 6 hrs. pressured up on 5½" csg to @ 1200#. Cement remained static until sometime during night when it flowed back to pit.
12. 10-6-84 RU B.J. Hughes. Pumped 100 SX Class "C" cement w/ 2% A7 & 60 SX surefill. Shut off both flow thru D.V. tool and flow up thru braidenhead.
13. TIH w/ bit. Drilled out @ 10' of cement above D.V. tool (2947'). Trip to bottom Circ clean. TOH w/bit.
14. Prepare to complete as Penrose Producer.

18. I hereby certify that the information above is true and complete to the best of my knowledge and belief.

SIGNED [Signature] TITLE Field Foreman DATE October 12, 1984

OCT 17 1984

APPROVED BY \_\_\_\_\_ TITLE \_\_\_\_\_ DATE \_\_\_\_\_  
CONDITIONS OF APPROVAL, IF ANY:

O CONSERVATION DIVISION  
P. O. BOX 2088  
SANTA FE, NEW MEXICO 87501

Form C-103  
Revised 10-1-78

NO. OF COPIES RECEIVED	
DISTRIBUTION	
SANTA FE	
FILE	
U.S.G.S.	
LAND OFFICE	
OPERATOR	

5a. Indicate Type of Lease  
State ☐ Fee ☒

5. State Oil & Gas Lease No.

SUNDRY NOTICES AND REPORTS ON WELLS  
(DO NOT USE THIS FORM FOR PROPOSALS TO DRILL OR TO DEEPEN OR PLUG BACK TO A DIFFERENT RESERVOIR.  
USE "APPLICATION FOR PERMIT -" (FORM C-101) FOR SUCH PROPOSALS.)

OIL WELL <input checked="" type="checkbox"/> GAS WELL <input type="checkbox"/> OTHER- Name of Operator Anadarko Production Company Address of Operator P. O. Box 806 Eunice, New Mexico 88231 Location of Well UNIT LETTER <u>C</u> <u>1650</u> FEET FROM THE <u>West</u> LINE AND <u>660</u> FEET FROM THE <u>North</u> LINE, SECTION <u>35</u> TOWNSHIP <u>22S</u> RANGE <u>R37E</u> NMPM. 15. Elevation (Show whether DF, RT, GR, etc.) 3312.1 GR.		7. Unit Agreement Name 8. Farm or Lease Name Metex Supply "A" 9. Well No. 4 10. Field and Pool, or Wildcat Langlie Mattix-Penrose 12. County Lea
--	--	--

16. Check Appropriate Box To Indicate Nature of Notice, Report or Other Data

NOTICE OF INTENTION TO:	SUBSEQUENT REPORT OF:
PERFORM REMEDIAL WORK <input type="checkbox"/> TEMPORARILY ABANDON <input type="checkbox"/> PULL OR ALTER CASING <input type="checkbox"/> OTHER <input type="checkbox"/>	REMEDIAL WORK <input type="checkbox"/> COMMENCE DRILLING OPNS. <input type="checkbox"/> CASING TEST AND CEMENT JOBS <input checked="" type="checkbox"/> OTHER <input type="checkbox"/>
PLUG AND ABANDON <input type="checkbox"/> CHANGE PLANS <input type="checkbox"/>	ALTERING CASING <input type="checkbox"/> PLUG AND ABANDONMENT <input type="checkbox"/>

17. Describe Proposed or Completed Operations (Clearly state all pertinent details, and give pertinent dates, including estimated date of starting any proposed work) SEE RULE 1103.

1. MIRURT. Spudded 12 $\frac{1}{4}$ " Hole @ 2:00 P.M. 5-2-84.
2. Drilled 12 $\frac{1}{4}$ " Hole to 1127' @ 1:30 A.M. 5-4-84.
3. Ran 28 Jts. (1118') 8 5/8" 24# J-55 ST&C R-3 (New) Csg. w/Guide Shoe & Insert Float & 5 Centralizers.
4. R.W. B. J. Hughes & Cemented w/360 SX Light Cement, followed w/200 SX Class "C" cement w/2% CaCL. Plug down @ 11:00 A.M. 5-4-84. Circulated 130 SX to Pit.
5. WOC 16 hrs. Nipple Up & Tested BOP. O.K. & Resumed Drlg 7 7/8" hole.

18. I hereby certify that the information above is true and complete to the best of my knowledge and belief.

SIGNED Eddie W. Seay TITLE Field Foreman DATE May 9, 1984  
 APPROVED BY Eddie W. Seay TITLE Oil & Gas Inspector DATE MAY 14 1984  
 CONDITIONS OF APPROVAL, IF ANY:

RECEIVED

MAY 11 1984

CCC  
HALL CHART

30-025-28691

NO. OF COPIES RECEIVED	
DISTRIBUTION	
SANTA FE	
FILE	
U.S.G.S.	
LAND OFFICE	
OPERATOR	

NEW MEXICO OIL CONSERVATION COMMISSION

Form C-101  
Revised 1-1-65

5A. Indicate Type of Lease	
STATE <input type="checkbox"/>	FEE <input checked="" type="checkbox"/>

5. State Oil & Gas Lease No.

APPLICATION FOR PERMIT TO DRILL, DEEPEN, OR PLUG BACK

1a. Type of Work b. Type of Well OIL WELL <input checked="" type="checkbox"/> GAS WELL <input type="checkbox"/> OTHER <input type="checkbox"/> SINGLE ZONE <input checked="" type="checkbox"/> MULTIPLE ZONE <input type="checkbox"/>		DRILL <input checked="" type="checkbox"/> DEEPEN <input type="checkbox"/> PLUG BACK <input type="checkbox"/>	
2. Name of Operator Anadarko Production Co.		7. Unit Agreement Name	
3. Address of Operator P. O. Box 806 1321 N. Main Eunice, N. M. 88231		8. Farm or Lease Name Metex Supply "A"	
4. Location of Well UNIT LETTER C LOCATED 660 FEET FROM THE North LINE AND 1650 FEET FROM THE West LINE OF SEC. 35 TWP. 22S RSE. 37E NMPM		9. Well No. 4	
		10. Field and Pool, or Wildcat Langlie Mattix-Penrose	
		12. County Lea	
		19. Proposed Depth 3700'	
		19A. Formation Penrose	
		20. Rotary or C.T. Rotary	
21. Elevations (Show whether DP, RT, etc.) 3312.1 GR.		21A. Kind & Status Plug. Bond Blanket	
		21B. Drilling Contractor Salazar Bros.	
		22. Approx. Date Work will start	

PROPOSED CASING AND CEMENT PROGRAM

SIZE OF HOLE	SIZE OF CASING	WEIGHT PER FOOT	SETTING DEPTH	SACKS OF CEMENT	EST. TOP
12 1/4"	8 5/8"	24	1200	650	Surface
7 7/8"	5 1/2"	15.5	3700	950	900'

1. MT & RURT. Drill 12 1/4" Hole to 1200' or top of Anhydrite.
2. Run 8 5/8" Csg & Use sufficient cement to circulate.
3. Install BOP & Test.
4. Drill 7 7/8" Hole to 3700' Run 3700' of 5 1/2" Csg Using enough cement to bring TOC to @ 900'.
5. Complete as a Producer. POP.

APPROVAL VALID FOR 180 DAYS  
PERMIT EXPIRES 10/16/84  
UNLESS DRILLING UNDERWAY

IN ABOVE SPACE DESCRIBE PROPOSED PROGRAM; IF PROPOSAL IS TO DEEPEN OR PLUG BACK, GIVE DATA ON PRESENT PRODUCTIVE ZONE AND PROPOSED NEW PRODUCTIVE ZONE. GIVE BLOWOUT PREVENTER PROGRAM, IF ANY.

I hereby certify that the information above is true and complete to the best of my knowledge and belief.

Signed Jerry Sexton Title Area Supervisor Date April 16, 1984

(This space for State Use)

ORIGINAL SIGNED BY JERRY SEXTON  
DISTRICT 1 SUPERVISOR

APPROVED BY \_\_\_\_\_ TITLE \_\_\_\_\_ DATE \_\_\_\_\_

CONDITIONS OF APPROVAL, IF ANY:

APR 16 1984

RECEIVED

APR 16 1984

O.C.D.  
HOLDS OFFICE

**NEW MEXICO OIL CONSERVATION COMMISSION  
WELL LOCATION AND ACREAGE DEDICATION PLAT**

Form C-102  
Supersedes C-128  
Effective 1-1-65

All distances must be from the outer boundaries of the Section.

Operator <b>ANADARKO PRODUCTION COMPANY</b>			Lease <b>METEX SUPPLY A</b>		Well No. <b>4</b>
Unit Letter <b>C</b>	Section <b>35</b>	Township <b>22 South</b>	Range <b>37 East</b>	County <b>Lea</b>	
Actual Footage Location of Well: <b>1650</b> feet from the <b>West</b> line and <b>660</b> feet from the <b>North</b> line					
Ground Level Elev. <b>3312.1</b>	Producing Formation <b>Langlie</b> <b>Mattix, 7 rivers, Queens</b>		Pool <b>Langlie, Mattix</b>		Dedicated Acreage: <b>40</b> Acres

1. Outline the acreage dedicated to the subject well by colored pencil or hachure marks on the plat below.
2. If more than one lease is dedicated to the well, outline each and identify the ownership thereof (both as to working interest and royalty).
3. If more than one lease of different ownership is dedicated to the well, have the interests of all owners been consolidated by communitization, unitization, force-pooling, etc?

☐ Yes    ☐ No    If answer is "yes," type of consolidation \_\_\_\_\_

If answer is "no," list the owners and tract descriptions which have actually been consolidated. (Use reverse side of this form if necessary.) \_\_\_\_\_

No allowable will be assigned to the well until all interests have been consolidated (by communitization, unitization, forced-pooling, or otherwise) or until a non-standard unit, eliminating such interests, has been approved by the Commission.

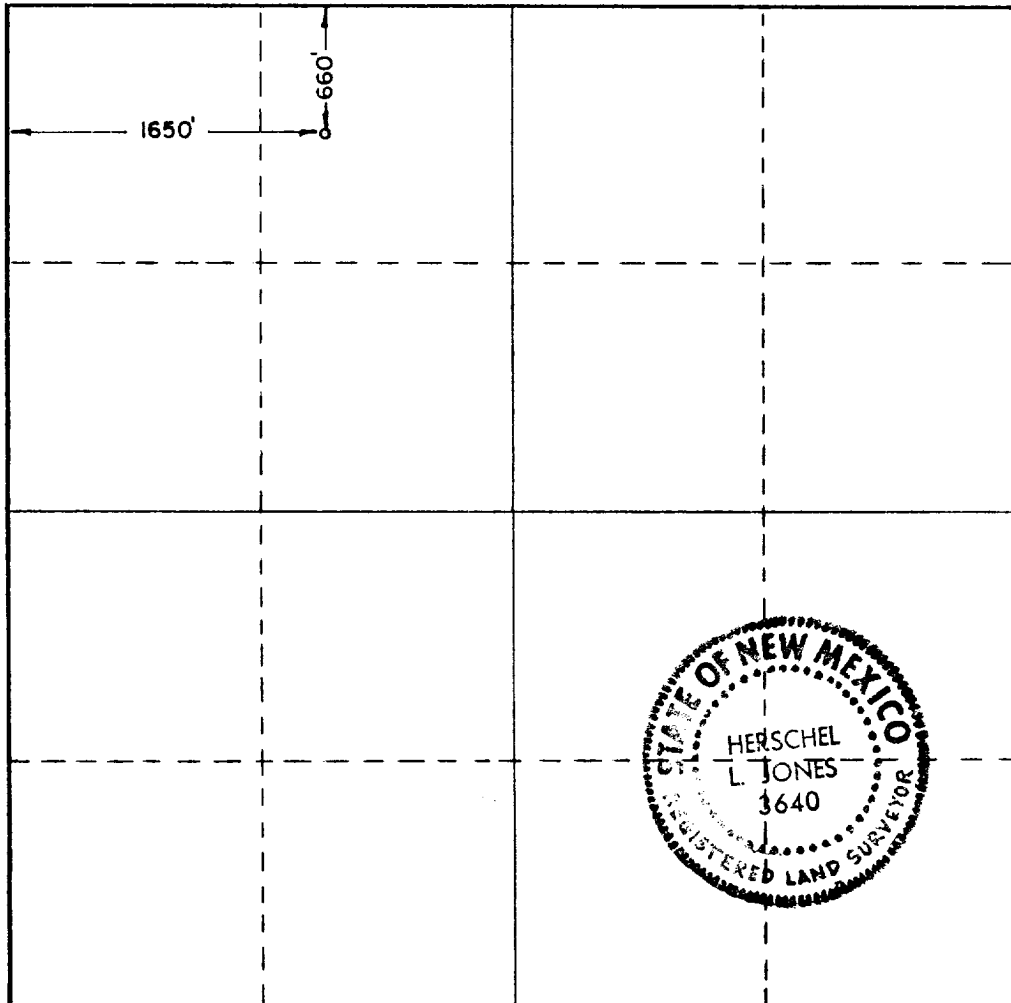

**CERTIFICATION**

*I hereby certify that the information contained herein is true and complete to the best of my knowledge and belief.*

Name: John English  
 Position  
**Area Supervisor**

Company  
**Anadarko Production Co.**

Date \_\_\_\_\_

*I hereby certify that the well location shown on this plat was plotted from field notes of actual surveys made by me or under my supervision, and that the same is true and correct to the best of my knowledge and belief.*

Date Surveyed  
**4/11/84**

Registered Professional Engineer and/or Land Surveyor

Certificate No. 3640

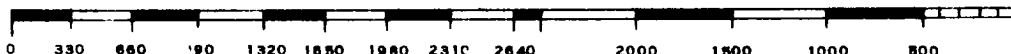

RECEIVED

APR 15 1984

O.C.D.  
HARRIS OFFICE

17