

**NEW MEXICO OIL CONSERVATION COMMISSION
WELL LOCATION AND ACREAGE DEDICATION PLAT**

Form C-102
Supersedes C-1
Effective 1-1-65

All distances must be from the outer boundaries of the Section.

Operator J.C. WILLIAMSON Curry Resources			Lease Curry Federal		Well No. 3
Unit Letter I	Section 22	Township 23 South	Range 34 East	County Lea	
Actual Footage Location of Well: 1680 feet from the South line and 760 feet from the East line					
Ground Level Elev. 3415.5	Producing Formation ATOKA		Pool ANTELOPE RIDGE ATOKA		Dedicated Acreage: 320 Acres

1. Outline the acreage dedicated to the subject well by colored pencil or hachure marks on the plat below.
2. If more than one lease is dedicated to the well, outline each and identify the ownership thereof (both as to working interest and royalty).
3. If more than one lease of different ownership is dedicated to the well, have the interests of all owners been consolidated by communitization, unitization, force-pooling, etc?

☐ Yes ☐ No If answer is "yes," type of consolidation _____

If answer is "no," list the owners and tract descriptions which have actually been consolidated. (Use reverse side of this form if necessary.) _____

No allowable will be assigned to the well until all interests have been consolidated (by communitization, unitization, forced-pooling, or otherwise) or until a non-standard unit, eliminating such interests, has been approved by the Commission.

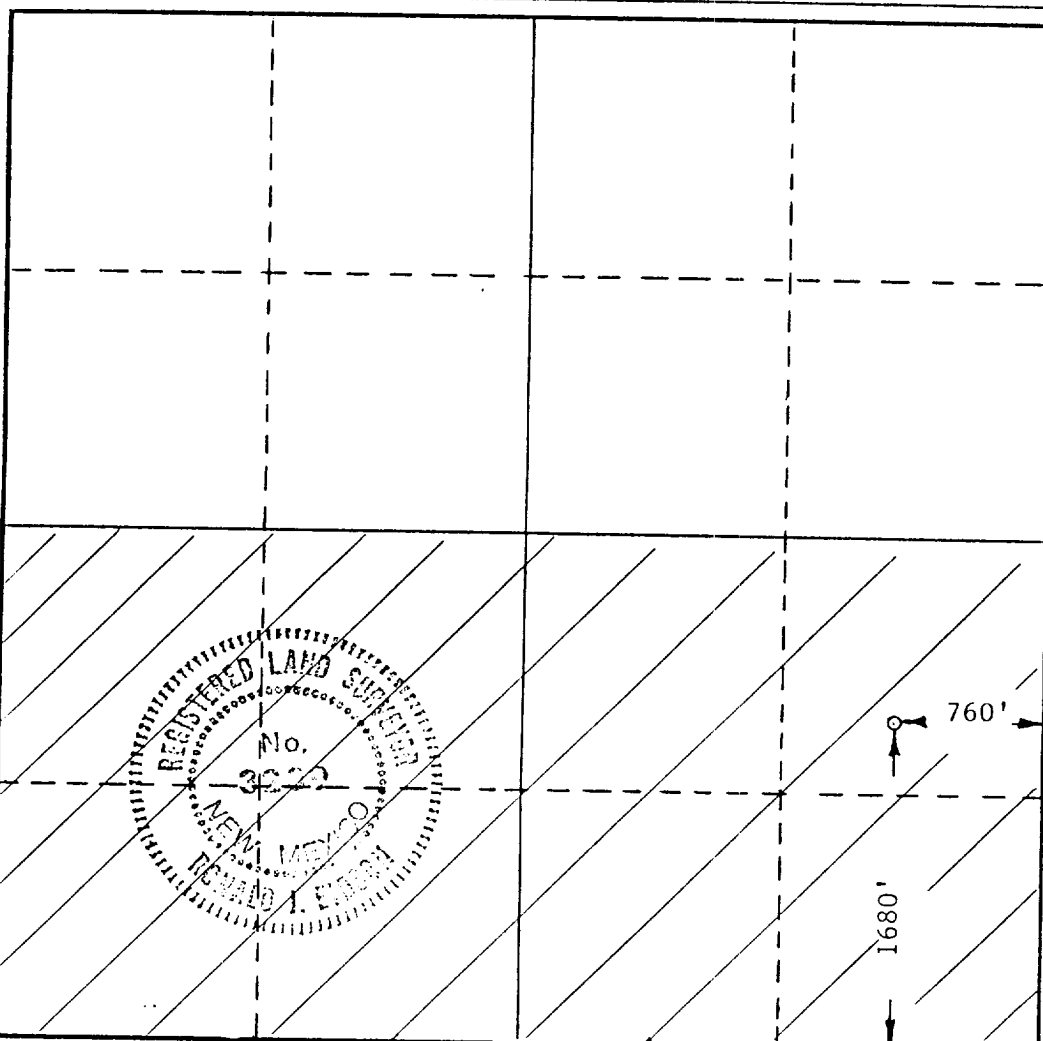

CERTIFICATION

I hereby certify that the information contained herein is true and complete to the best of my knowledge and belief.

[Signature]
Name

JAN LIVINGSTON

Position

PRODUCTION

Company

J.C. WILLIAMSON

Date

03/09/90

I hereby certify that the well location shown on this plat was plotted from field notes of actual surveys made by me or under my supervision, and that the same is true and correct to the best of my knowledge and belief.

Date Surveyed

6-26-84

Registered Professional Engineer
and/or Land Surveyor

[Signature]
Certificate No. **JOHN W. WEST** **676**

WRS COMPLETION REPORT

REISSUES
PI# 30-T-0004 03/16/90 SEC 22 TWP 23S RGE 34E
30-025-28797-0000 PAGE 1

NMEX LEA * 1680FSL 760FEL SEC
STATE COUNTY FOOTAGE
WILLIAMSON J C
OPERATOR D DO
3 CURRY FEDERAL WELL CLASS INIT FIN

WELL NO. 3416GR
OPER ELEV ANTELOPE RIDGE
FIELD/POOL/AREA

LEASE NO. API 30-025-28797-0000
07/16/1984 10/20/1988 ROTARY VERT OIL
SPUD DATE COMP. DATE TYPE TOOL HOLE TYPE STATUS
13600 MORROW SONS DRLG 3
PROJ. DEPTH PROJ. FORM CONTRACTOR
DTD 13359 PB 12990 FM/TD MORROW
DRILLERS T.D. LOG T.D. PLUG BACK TD OLD T.D. FORM T.D.

LOCATION DESCRIPTION

25 MI SE HALFWAY, NM

WELL IDENTIFICATION/CHANGES

OPER CHGD FROM CURRY RESOURCES
FINAL CLASS CHGD FROM D
FINAL STATUS CHGD FROM TA

CASING/LINER DATA

CSG 20 @ 61 W/ 100 SACKS
CSG 13 3/8 @ 610 W/ 750 SACKS
CSG 10 3/4 @ 4836 W/ 1750 SACKS
LNR 7 4104-11780
LNR 5 1/2 11518-13295
W/ 2470S
W/ 175S

TUBING DATA

TBG 2 7/8 AT 11210

INITIAL POTENTIAL

IPG 3BOPD 150 MCFD 36BW 48/64CK 24HRS
ATOKA PERF W/ 30/IT 12019-12188
PERF 12019-12188
ACID 12019-12188 357BBLs
15%

GTY, GOR-NO DETAIL

CONTINUED IC# 300257032984

Copyrighted 1990
Reproduction
Prohibited

Petroleum Information

BB a company of
The Bank & Bradstreet Corporation

PI-WRS-GEJ
Form No 187

REISSUES
PI# 30-T-0004 03/16/90 SEC 22 TWP 23S RGE 34E
30-025-28797-0000 PAGE 2

WILLIAMSON J C
3 CURRY FEDERAL

D DO

TYPE	FORMATION	LTH	TOP	DEPTH/SUB	BSE	DEPTH/SUB
LOG	BELL CYN		5030	-1614		
LOG	RAMSEY	SS	5080	-1664		
LOG	CHER CYN		5860	-2444		
LOG	BRSH CYN		7180	-3764		
LOG	BN SP LM		8530	-5114		
LOG	WOLFCAMP		11460	-8044		
LOG	STRAWN		12040	-8624		
LOG	ATOKA		12200	-8784		
LOG	MORROW		12900	-9484		
LOG	MORRW SD		13265	-9849		

SUBSEA MEASUREMENTS FROM GR

LOGS AND SURVEYS /INTERVAL,TYPE/

LOGS GRN

DRLG SHOWS OR POROSITY ZONES /INTERVAL,FORMATION,DESC

9630- 9670 BONE SPG OIL 10054-10054 BONE SPG GAS

DRILLING BREAKS

09630-09670 OIL STN (BONE SPRING)

S

DRILLING PROGRESS DETAILS

WILLIAMSON J C
BOX 16
MIDLAND, TX 79702
915-682-1797

07/09	LOC/1984/
07/17	DRLG 717
07/24	DRLG 4275
07/31	DRLG 5585
08/07	DRLG 7730
08/13	DRLG 8936
08/21	DRLG 10055
08/21	HAD GAS KICK @ 10054 (BONE SPRING)
08/28	DRLG 10945
09/05	11780 TD, RNG 7 5/8 LNR
09/11	DRLG 11890
09/20	DRLG 12860

CONTINUED

REISSUES SEC 22 TWP 23S RGE 34E
PI# 30-T-0004 03/16/90 30-025-28797-0000 PAGE 3

WILLIAMSON J C D DO
3 CURRY FEDERAL

DRILLING PROGRESS DETAILS

09/25 DRLG 13220
10/02 DRLG 13255
10/09 13295 TD, DOC
10/16 13295 TD, SI
10/18 13295 TD, FSG
10/30 13295 TD, CIRC
10/30 DV TOOL LEAKING @ 900
ATT TO RUN 2 7/8 TBG, HIT 5500 FT & WELL BLEW
OUT
11/06 13359 TD, PREP TREAT OH
11/06 CIRC HOLE CLEAN
11/12 13359 TD, TOH
11/15 13359 TD, FSG
11/28 13359 TD, SI
03/27 13359 TD, WOCT
06/20 13359 TD, WOCT
07/16 13359 TD, WOCT
08/29 13359 TD, TEMP ABND
03/14 13359 TD, PB 12990
COMP 10/20/88, IPG 3 BO, 150 MCFG, 36 BWPD
48/64 CK, GOR (NR), GTY
(NR)
PROD ZONE - ATOKA 12019-12188
NO CORES OR DSTS RPTD
REISSUED TO CORRECT OPER, DRLG BREAK, COMP
DATE, CSGS, FINAL CLASS/STATUS & ADD PBD,
TBG, LOG TOPS, LOG RUN, IP
REPLACEMENT FOR TCT ISSUED 9/13/86