

NO. OF COPIES RECEIVED		
DISTRIBUTION		
SANTA FE		
FILE		
U.S.G.S.		
LAND OFFICE		
OPERATOR		

OIL CONSERVATION DIVISION

P. O. BOX 2088

SANTA FE, NEW MEXICO 87501

Form C-103
Revised 10-1-78

5a. Indicate Type of Lease

State ☒ Fee ☐

5. State Oil & Gas Lease No.

SUNDRY NOTICES AND REPORTS ON WELLS

(DO NOT USE THIS FORM FOR PROPOSALS TO DRILL OR TO DEEPEN OR PLUG BACK TO A DIFFERENT RESERVOIR.
USE "APPLICATION FOR PERMIT -" (FORM C-101) FOR SUCH PROPOSALS.)

1. OIL WELL <input checked="" type="checkbox"/> GAS WELL <input type="checkbox"/> OTHER <input type="checkbox"/>	7. Unit Agreement Name
2. Name of Operator Chevron U.S.A. Inc.	8. Farm or Lease Name Lea "ACL" State
3. Address of Operator P.O. Box 670, Hobbs, NM 88240	9. Well No. #1
4. Location of Well UNIT LETTER B 600 FEET FROM THE North LINE AND 2080 FEET FROM THE East LINE, SECTION 36 TOWNSHIP 22S RANGE 37E NMPM.	10. Field and Pool, or Wildcat Blinebry Oil & Gas
15. Elevation (Show whether DF, RT, GR, etc.) 3307.4 GL	12. County Lea

16. Check Appropriate Box To Indicate Nature of Notice, Report or Other Data
NOTICE OF INTENTION TO:

PERFORM REMEDIAL WORK ☐
TEMPORARILY ABANDON ☐
PULL OR ALTER CASING ☐

PLUG AND ABANDON ☐
CHANGE PLANS ☐

OTHER Change in location ☒

SUBSEQUENT REPORT OF:

REMEDIAL WORK ☐
COMMENCE DRILLING OPNS. ☐
CASING TEST AND CEMENT JOBS ☐
OTHER ☐

ALTERING CASING ☐
PLUG AND ABANDONMENT ☐

17. Describe Proposed or Completed Operations (Clearly state all pertinent details, and give pertinent dates, including estimated date of starting any proposed work) SEE RULE 1103.

Form C-103 is being filed to show a change in the legal description. The new legal is 600' FNL and 2080' FEL. Location was moved 40' South during construction due to underground line.

18. I hereby certify that the information above is true and complete to the best of my knowledge and belief.

SIGNED M. E. Abum

TITLE Staff Drilling Engineer

DATE 4/24/87

ORIGINAL SIGNED BY JERRY SEXTON
DISTRICT I SUPERVISOR

DATE APR 27 1987

NEW MEXICO OIL CONSERVATION COMMISSION
WELL LOCATION AND ACREAGE DEDICATION PLAT

Form C-102
Supersedes C-128
Effective 1-1-65

All distances must be from the outer boundaries of the Section

Operator Chevron USA Inc.		Lease Lea ACL State		Well No. #1
Unit Letter B	Section 36	Township 22 South	Range 37 East	County Lea
Actual Plotage Location of Well: 660 feet from the North line and 2080 feet from the East line				
Ground Level Elev. 3307.40	Producing Formation	Pool Blinebry Oil & Gas	Dedicated Acreage: 40 Acres	

1. Outline the acreage dedicated to the subject well by colored pencil or hachure marks on the plat below.
2. If more than one lease is dedicated to the well, outline each and identify the ownership thereof (both as to working interest and royalty).
3. If more than one lease of different ownership is dedicated to the well, have the interests of all owners been consolidated by communitization, unitization, force-pooling, etc?

☐ Yes ☐ No If answer is "yes," type of consolidation _____

If answer is "no," list the owners and tract descriptions which have actually been consolidated. (Use reverse side of this form if necessary.) _____

No allowable will be assigned to the well until all interests have been consolidated (by communitization, unitization, forced-pooling, or otherwise) or until a non-standard unit, eliminating such interests, has been approved by the Commission.

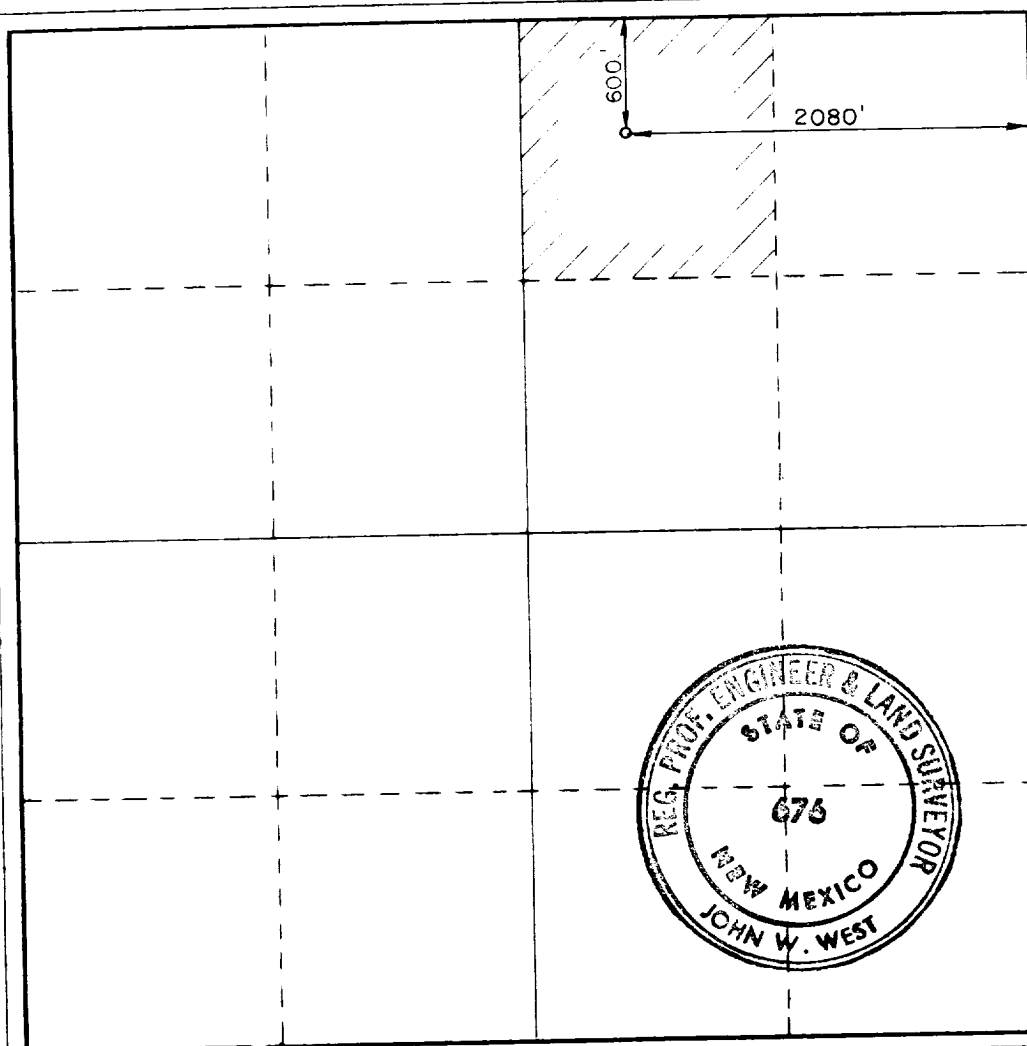

CERTIFICATION

I hereby certify that the information contained herein is true and complete to the best of my knowledge and belief.

Name
Position Staff Engineer
Company Chevron USA, Inc.
Date April 27, 1987

I hereby certify that the well location shown on this plat was plotted from field notes of actual surveys made by me or under my supervision, and that the same is true and correct to the best of my knowledge and belief.

Date Surveyed April 25, 1987
Registered Professional Engineer and/or Land Surveyor

Certificate No. JOHN W. WEST, 676
RONALD J. EIDSON, 3239

RECEIVED
APR 27 1987
OCD
HOBBS OFFICE