

NO. OF COPIES RECEIVED	
DISTRIBUTION	
SANTA FE	
ILE	
U.S.G.S.	
LAND OFFICE	
OPERATOR	

APPLICATION FOR PERMIT TO DRILL, DEEPEN, OR PLUG BACK

Type of Work: DRILL ☒ DEEPEN ☐ PLUG BACK ☐

Type of Well: OIL ☒ GAS WELL ☐ OTHER ☐

Single Zone ☒ Multiple Zone ☐

Name of Operator: CURRY RESOURCES

Address of Operator: P.O. Box 5596 Midland Texas

Location of Well: UNIT LETTER F LOCATED 1980 FEET FROM THE NORTH LINE
1980 FEET FROM THE WEST LINE OF SEC. 9 TWP. 23 S RGE. 34 E NMPM

5A. Indicate Type of Lease: STATE ☒ FEDERAL ☐

5. State Oil & Gas Lease No. _____

7. Unit Agreement Name _____

8. Farm or Lease Name: Phillips "A" State

9. Well No. 1

10. Field and Pool, or Wildcat: Undesignated

12. County: Lea

19. Proposed Depth: 11,950' 19A. Formation: Bone Springs 20. Rotary or C.T.: Rotary

21A. Kind & Status Plug. Bond: Blanket 21B. Drilling Contractor: N.A. at this time 22. Approx. Date Work will start: By Jan 15, 1985

Elevations (show whether DF, KI, etc.): 3413 GL

PROPOSED CASING AND CEMENT PROGRAM

SIZE OF HOLE	SIZE OF CASING	WEIGHT PER FOOT	SETTING DEPTH	SACKS OF CEMENT	EST. TOP
17 1/4"	13 3/8"	58	6000	Circ.	
12 1/4"	10 3/4"	51.655	5000	Circ.	
9 5/8"	7 7/8" (Liner)	33 # 39 #	8500'-5000'	Circ.	3500'
	5 1/2" (Liner)		11,950'-8400'	Circ.	8400'

complete as an oil producer from the Bone Springs formation between 11,950' and 8500' by setting casing through formation, cementing, and perforating 5 1/2" OD casing. Well will require stimulation.

Blow-out preventer equipment of Soco psi WP will be used.
Casing dedicated to Gas Co. of N.M.

Permit Expires 6 Months From Approval
Date Unless Drilling Underway.

ABOVE SPACE DESCRIBE PROPOSED PROGRAM; IF PROPOSAL IS TO DEEPEN OR PLUG BACK, GIVE DATA ON PRESENT PRODUCTIVE ZONE AND PROPOSED NEW PRODUCTIVE ZONE. GIVE BLOWOUT PREVENTER PROGRAM, IF ANY.

I hereby certify that the information above is true and complete to the best of my knowledge and belief.

Signed: Max Curry Title: Owner Date: 12-31-85

(This space for State Use)

ORIGINAL SIGNED BY JERRY SEXTON

PROVED BY: DISTRICT SUPERVISOR TITLE: _____ DATE: JAN - 3 1985

CONDITIONS OF APPROVAL, IF ANY:

RECEIVED

JAN - 2 1985

O.C.R.
HOBBS OFFICE

NEW MEXICO OIL CONSERVATION COMMISSION
WELL LOCATION AND ACREAGE DEDICATION FORM

Form C-102
 Supersedes C-128
 Effective 1-1-65

All distances must be from the outer boundaries of the Section.

Operator CURRY RESOURCES			Lease Phillips State A <i>State</i>		Well No. Well No. 1
Unit Letter F	Section 9	Township 23 SOUTH	Range 34 EAST	County LEA	
Actual Footage Location of Well:					
1980 feet from the NORTH line and		1980 feet from the WEST line			
Ground Level Elev. 3413.1 FEET	Producing Formation Bone Springs	Pool Undesignated		Dedicated Acreage: 40 Acres	

1. Outline the acreage dedicated to the subject well by colored pencil or hatchure marks on the plat below.
2. If more than one lease is dedicated to the well, outline each and identify the ownership thereof (both as to working interest and royalty).
3. If more than one lease of different ownership is dedicated to the well, have the interests of all owners been consolidated by communitization, unitization, force-pooling, etc?

Not Applicable

☐ Yes ☐ No If answer is "yes," type of consolidation _____

If answer is "no," list the owners and tract descriptions which have actually been consolidated. (Use reverse side of this form if necessary.) _____

No allowable will be assigned to the well until all interests have been consolidated (by communitization, unitization, forced-pooling, or otherwise) or until a non-standard unit, eliminating such interests, has been approved by the Commission.

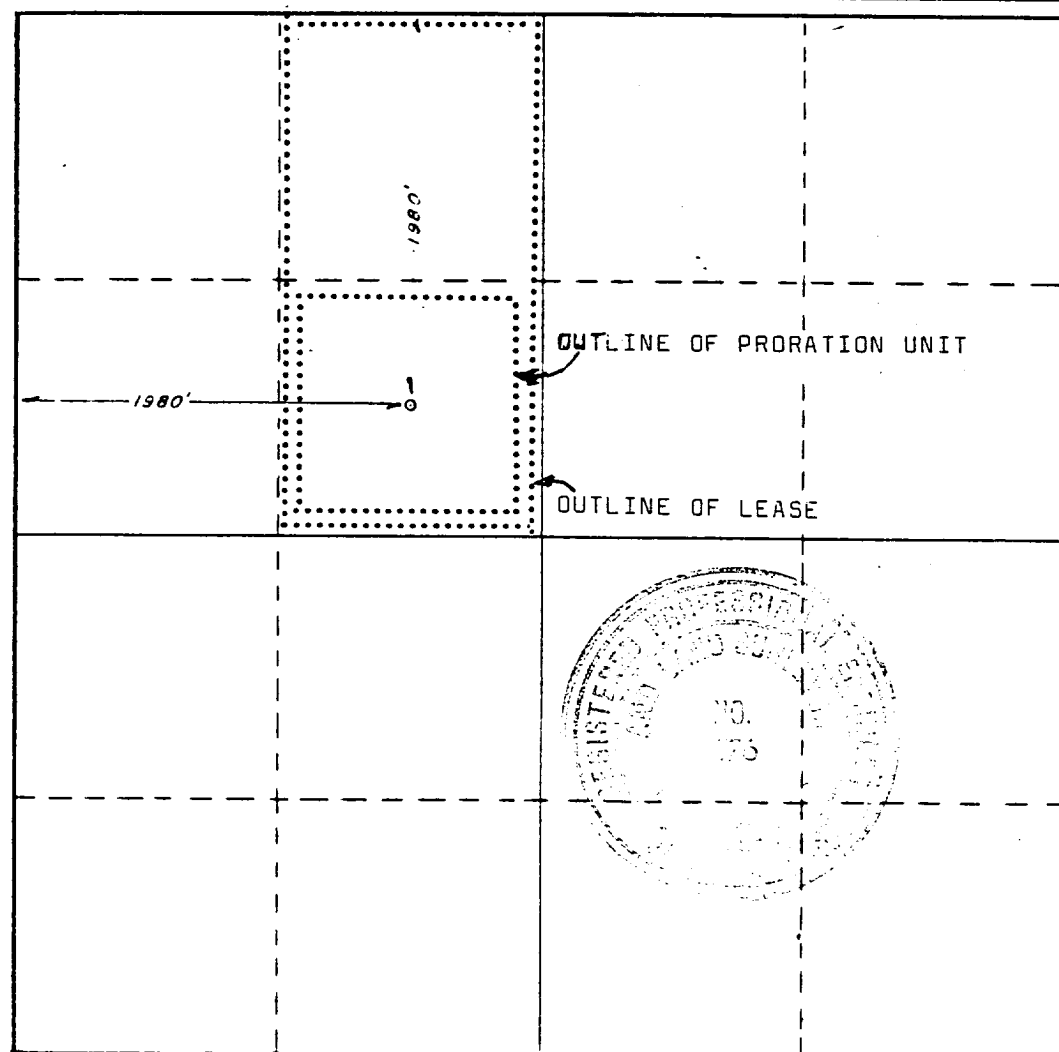

CERTIFICATION

I hereby certify that the information contained herein is true and complete to the best of my knowledge and belief.

Name *Max Curry*
 Position **Owner**
 Company **CURRY RESOURCES**
 Date **10-15-84**

I hereby certify that the well location shown on this plat was plotted from field notes of actual surveys made by me or under my supervision, and that the same is true and correct to the best of my knowledge and belief.

Date Surveyed **10/8/84**
 Registered Professional Engineer and/or Land Surveyor
Ronald J. Eidson
 Certificate No. **JOHN W. WEST, 676**
RONALD J. EIDSON, 3239

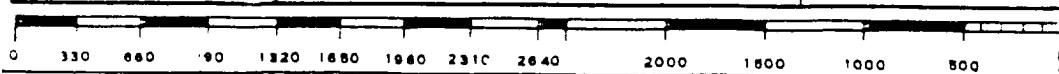

RECEIVED

JAN -2 1985

O.C.P.
HOBBS OFFICE