



STATE OF NEW MEXICO
ENERGY, MINERALS AND NATURAL RESOURCES DEPARTMENT

OIL CONSERVATION DIVISION
HOBBS DISTRICT OFFICE

12-29-92

BRUCE KING
GOVERNOR

POST OFFICE BOX 1980
HOBBS, NEW MEXICO 88241-1980
(505) 393-6161

OIL CONSERVATION DIVISION
P. O. BOX 2088
SANTA FE, NEW MEXICO 87501

RE: Proposed:

MC _____
DHC X _____
NSL _____
NSP _____
SWD _____
WFX _____
PMX _____

Gentlemen:

I have examined the application for the:

Marathon Oil Co J L Muncy #6-I 24-22-37
Operator Lease & Well No. Unit S-T-R

and my recommendations are as follows:

OK

Yours very truly,

Jerry Sexton
Jerry Sexton
Supervisor, District 1

/ed



**Marathon
Oil Company**

P.O. Box 2409
Hobbs, New Mexico 88240
Telephone 505/393-7106

December 21, 1992

Mr. David Catanach
Energy and Mineral Department
Oil Conservation Division
PO Box 2088
Santa Fe, NM 87501

RE: Request for Exception to Rule 303-A
Downhole Commingling
Marathon Oil Company
J.L. Muncy Well No. 6
Unit I, 330' FEL and 1920' FSL
Section 24, T-22-S, R-37-E
Tubb Gas and Blinbry Oil Formations
Drinkard Field
Lea County, New Mexico

Dear Mr. Catanach:

Marathon Oil Company requests administrative approval for an exception to Rule 303-A to permit the downhole commingling of production in the above subject well from the Tubb Gas and Blinbry Oil Pools in Lea County, New Mexico.

Currently, the well is dual completed with the Tubb Gas flowing up the long string and Blinbry pumping up the short string. Allowing the commingling of the two zones, would extend the economic life of the well by maximizing production, and minimizing any associated waste.

Enclosed is pertinent data supporting this application as outlined in Rule 303-C. If additional information is necessary, please contact me at (505) 393-7106.

Sincerely,

A handwritten signature in cursive script that reads 'S.P. Guidry'.

S.P. Guidry
Northwest Operations
Area Superintendent

SPG:RDG/9245/dw

xc: R.W. Tracy

REQUEST FOR EXCEPTION TO RULE 303-C
J.L. MUNCY WELL NO. 6
DRINKARD FIELD

- (a) Marathon Oil Company
PO Box 2409
Hobbs, New Mexico 88240
- (b) J.L. Muncy Well No. 6
Unit I, 330' FEL and 1920' FSL
Section 24, T-22-S, R-37-E
Lea County, New Mexico
Commingled Zones: Tubb Gas
and Blinebry Oil
- (c) Plats (2) of area attached.
- (d) The Form C-116 for the Tubb Gas and Blinebry Oil are attached.
The allocated production for each pool will be based on the
current production decline and the latest GOR test.
- (e) Production decline curves for both the Tubb Gas and Blinebry
Oil are attached.
- (f) Estimated bottom hole pressure for each zone:
Tubb Gas - 400 psi
Blinebry Oil - 400 psi
- (g) Marathon has surface commingled the liquids from these zones
without any compatibility problems.
- (h) If the downhole commingling is approved, the artificial lift
system will extend the economic life of the well by maximizing
production and thus avoid waste. The value of the produced
hydrocarbons will not be altered by commingling the
production.
- (i) Production from the latest GOR test shows as follows:

<u>Name</u>	<u>Oil (BOPD)</u>	<u>GAS (MCFD)</u>	<u>Water (BWPD)</u>
Tubb	0	245	0
Blinebry Oil	3	50	1
Total	3	295	1

Allocated percentages should be:

<u>Name</u>	<u>Oil (%)</u>	<u>Gas (%)</u>	<u>Water (%)</u>
Tubb	0	83	0
Blinebry Oil	100	17	100

- (j) Ownership of the two pools to be commingled in common and
correlative rights will not be violated.
- (k) By copy of this letter, we are notifying all offset operators
of the proposed commingling by certified mail.

OFFSET OPERATORS

J.L. MUNCY LEASE
LEA COUNTY, NEW MEXICO

Chevron Oil Company
PO Box 670
Hobbs, NM 88240

Hanson Operating company
PO Box 1515
Roswell, NM 88202-1515

Phillips Petroleum Company
4001 Penbrook
Odessa, TX 79762

John Hendrix
525 Midland Tower
Midland, TX 79701

Crown Central Petroleum
Building K, Suite 200
731 West Wadley
Midland, TX 79701

Sun Exploration & Production Company
PO Box 1861
Midland, TX 79702

Submit 3 Copies
to Appropriate
District Office

State of New Mexico
Energy, Minerals and Natural Resources Department

Form C-103
Revised 1-1-89

DISTRICT I
P.O. Box 1980, Hobbs, NM 88240

DISTRICT II
P.O. Drawer DD, Artesia, NM 88210

DISTRICT III
1000 Rio Brazos Rd., Aztec, NM 87410

OIL CONSERVATION DIVISION
P.O. Box 2088
Santa Fe, New Mexico 87504-2088

WELL API NO. 30-025-29218
5. Indicate Type of Lease STATE <input type="checkbox"/> FEE <input checked="" type="checkbox"/>
6. State Oil & Gas Lease No.

SUNDRY NOTICES AND REPORTS ON WELLS (DO NOT USE THIS FORM FOR PROPOSALS TO DRILL OR TO DEEPEN OR PLUG BACK TO A DIFFERENT RESERVOIR. USE "APPLICATION FOR PERMIT" (FORM C-101) FOR SUCH PROPOSALS.)	
1. Type of Well: OIL WELL <input type="checkbox"/> GAS WELL <input type="checkbox"/> OTHER Dual Oil & Gas Well	7. Lease Name or Unit Agreement Name J.L. Muncy
2. Name of Operator Marathon Oil Company	8. Well No. 6
3. Address of Operator P.O. Box 2409, Hobbs, NM 88240	9. Pool name or Wildcat Drinkard*
4. Well Location Unit Letter I : 330' Feet From The East Line and 1920' Feet From The South Line Section 24 Township 22-S Range 37-E NMPM Lea County	
10. Elevation (Show whether DF, RKB, RT, GR, etc.) 3323' 6L	

11. Check Appropriate Box to Indicate Nature of Notice, Report, or Other Data	
NOTICE OF INTENTION TO:	SUBSEQUENT REPORT OF:
PERFORM REMEDIAL WORK <input type="checkbox"/>	REMEDIAL WORK <input type="checkbox"/>
TEMPORARILY ABANDON <input type="checkbox"/>	ALTERING CASING <input type="checkbox"/>
PULL OR ALTER CASING <input type="checkbox"/>	COMMENCE DRILLING OPNS. <input type="checkbox"/>
OTHER: Downhole Commingling <input checked="" type="checkbox"/>	PLUG AND ABANDONMENT <input type="checkbox"/>
	CASING TEST AND CEMENT JOB <input type="checkbox"/>
	OTHER: <input type="checkbox"/>

12. Describe Proposed or Completed Operations (Clearly state all pertinent details, and give pertinent dates, including estimated date of starting any proposed work) SEE RULE 1103.

Request authorization to downhole commingle the Tubb Gas and Brunson, South (Drinkard Abo)

*Tubb Gas and Blinebry Oil.

I hereby certify that the information above is true and complete to the best of my knowledge and belief.

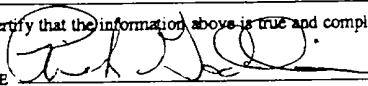
SIGNATURE 	TITLE Production Engineer	DATE 12/21/92
TYPE OR PRINT NAME Rick Gaddis		505- TELEPHONE NO. 393-7106

(This space for State Use)

APPROVED BY _____ TITLE _____ DATE _____

CONDITIONS OF APPROVAL, IF ANY:

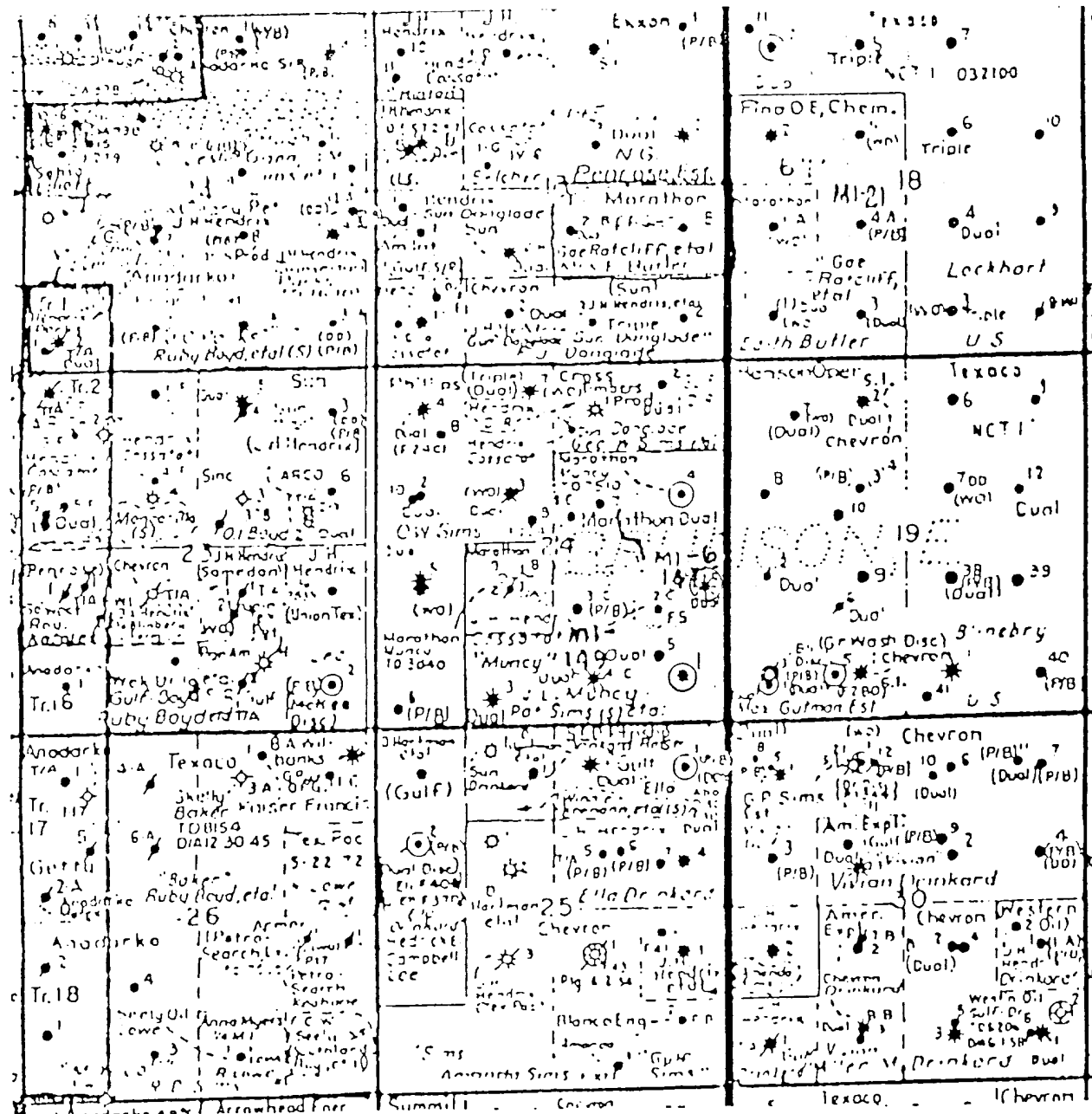

R-37-E

DRINKARD FIELD

J.L. Muncy Lease
Lea County, New Mexico

Land Plat

RDG- 11/30/92

Submit to Appropriate
District Office
State Lease - 4 copies
Fee Lease - 3 copies

State of New Mexico
Energy, Minerals and Natural Resources Department

Form C-102
Revised 1-1-89

OIL CONSERVATION DIVISION

P.O. Box 2088
Santa Fe, New Mexico 87504-2088

DISTRICT I
P.O. Box 1980, Hobbs, NM 88240

DISTRICT II
P.O. Drawer DD, Artesia, NM 88210

DISTRICT III
1000 Rio Brazos Rd., Aztec, NM 87410

WELL LOCATION AND ACREAGE DEDICATION PLAT

All Distances must be from the outer boundaries of the section

Operator Marathon Oil Company			Lease J.L. Muncy		Well No. 6
Unit Letter I	Section 24	Township 22-S	Range 37-E	County Lea	

Actual Footage Location of Well:

330	feet from the	East	line and	1920	feet from the	South	line
Ground level Elev. 3323'	Producing Formation Blinebry Oil		Pool Drinkard - Blinebry		Dedicated Acreage: 40 Acres		

1. Outline the acreage dedicated to the subject well by colored pencil or hatchure marks on the plat below.
2. If more than one lease is dedicated to the well, outline each and identify the ownership thereof (both as to working interest and royalty).
3. If more than one lease of different ownership is dedicated to the well, have the interest of all owners been consolidated by communitization, unitization, force-pooling, etc.?
☐ Yes ☐ No If answer is "yes" type of consolidation _____
If answer is "no" list the owners and tract descriptions which have actually been consolidated. (Use reverse side of this form if necessary. _____
No allowable will be assigned to the well until all interests have been consolidated (by communitization, unitization, forced-pooling, or otherwise) or until a non-standard unit, eliminating such interest, has been approved by the Division.

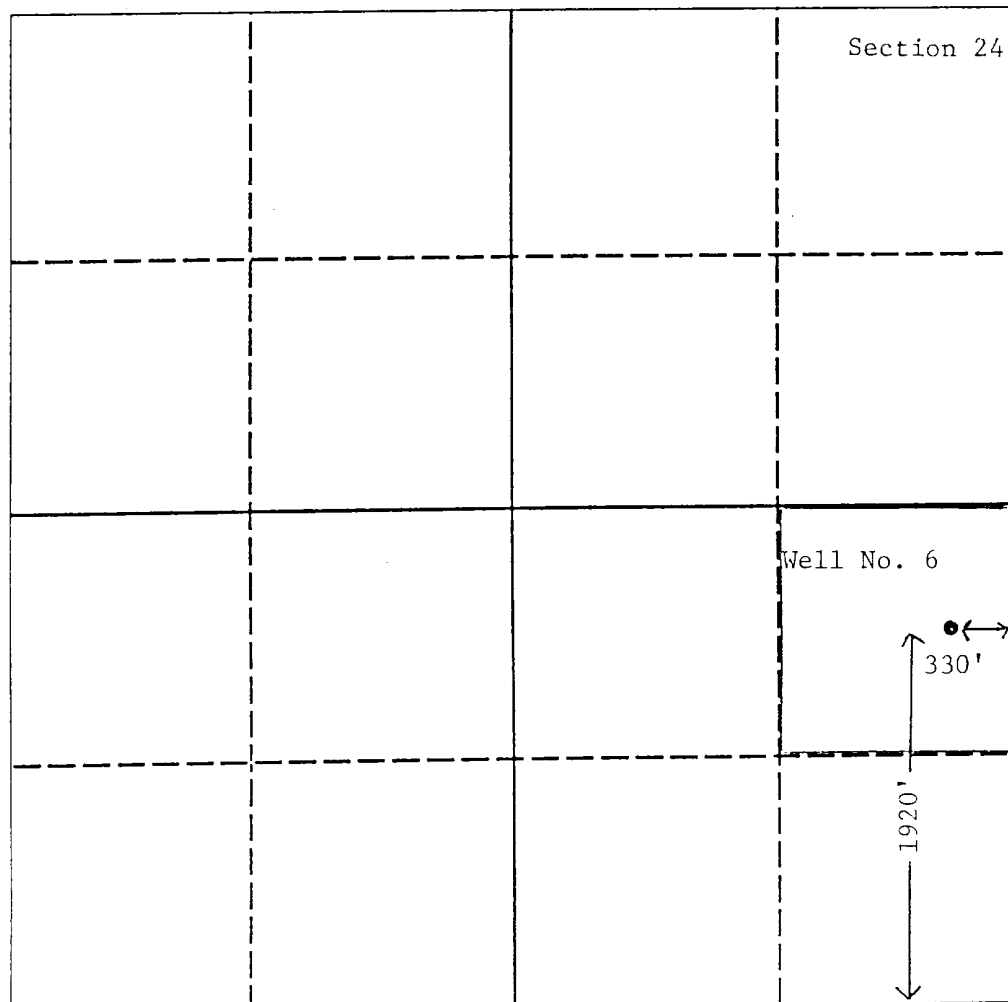

OPERATOR CERTIFICATION

I hereby certify that the information contained herein is true and complete to the best of my knowledge and belief.

Signature
Printed Name Rick Gaddis
Position Production Engineer
Company Marathon Oil Company
Date December 01, 1992

SURVEYOR CERTIFICATION

I hereby certify that the well location shown on this plat was plotted from field notes of actual surveys made by me or under my supervision, and that the same is true and correct to the best of my knowledge and belief.

Date Surveyed
Signature & Seal of Professional Surveyor
Certificate No.

0 330 650 990 1320 1650 1980 2310 2640 2000 1500 1000 500 0

Submit to Appropriate
District Office
State Lease - 4 copies
Fee Lease - 3 copies

State of New Mexico
Energy, Minerals and Natural Resources Department

Form C-102
Revised 1-1-89

OIL CONSERVATION DIVISION

DISTRICT I
P.O. Box 1980, Hobbs, NM 88240

DISTRICT II
P.O. Drawer DD, Artesia, NM 88210

DISTRICT III
1000 Rio Brazos Rd., Aztec, NM 87410

P.O. Box 2088
Santa Fe, New Mexico 87504-2088

WELL LOCATION AND ACREAGE DEDICATION PLAT

All Distances must be from the outer boundaries of the section

Operator Marathon Oil Company			Lease J.L. Muncy		Well No. 6
Unit Letter I	Section 24	Township 22-S	Range 37-E	County Lea	
Actual Footage Location of Well: 330 feet from the East line and 1920 feet from the South line					
Ground level Elev. 3323'	Producing Formation Tubb		Pool Drinkard - Tubb		Dedicated Acreage: 160 Acres

1. Outline the acreage dedicated to the subject well by colored pencil or hatchure marks on the plat below.

2. If more than one lease is dedicated to the well, outline each and identify the ownership thereof (both as to working interest and royalty).

3. If more than one lease of different ownership is dedicated to the well, have the interest of all owners been consolidated by communitization, unitization, force-pooling, etc.?

☐ Yes ☐ No If answer is "yes" type of consolidation _____
If answer is "no" list the owners and tract descriptions which have actually been consolidated. (Use reverse side of this form if necessary.)

No allowable will be assigned to the well until all interests have been consolidated (by communitization, unitization, forced-pooling, or otherwise) or until a non-standard unit, eliminating such interest, has been approved by the Division.

Section 24

Well No. 6

300'

1920'

OPERATOR CERTIFICATION

I hereby certify that the information contained herein in true and complete to the best of my knowledge and belief.

Signature

Printed Name

Rick Gaddis

Position

Production Engineer

Company

Marathon Oil Company

Date

December 21, 1992

SURVEYOR CERTIFICATION

I hereby certify that the well location shown on this plat was plotted from field notes of actual surveys made by me or under my supervision, and that the same is true and correct to the best of my knowledge and belief.

Date Surveyed

Signature & Seal of
Professional Surveyor

Certificate No.

0 330 660 990 1320 1650 1980 2310 2640 2000 1500 1000 500 0

Submit 2 copies to Appropriate
District Office.
DISTRICT I
P.O. Box 1980, Hobbs, NM 88240
DISTRICT II
P.O. Drawer DD, Artesia, NM 88210
DISTRICT III
1000 Rio Brazos Rd., Aztec, NM 87410

State of New Mexico
Energy, Minerals and Natural Resources Department

Form C-116
Revised 1/1/89

OIL CONSERVATION DIVISION

P.O. Box 2088
Santa Fe, New Mexico 87504-2088

GAS - OIL RATIO TEST

Operator Marathon Oil Company		Pool Blinebry Oil		County Lea											
Address P.O. Box 2409, Hobbs, NM 88240		TYPE OF TEST - (X)		Completion <input type="checkbox"/> Special <input checked="" type="checkbox"/>											
LEASE NAME	WELL NO.	LOCATION			DATE OF TEST	CHOKE SIZE	TBG. PRESS.	DAILY ALLOW- ABLE	LENGTH OF TEST HOURS	PROD. DURING TEST			GAS - OIL		
		U	S	T						R	WATER BBLs.	GRAV. OIL	OIL BBLs.	GAS M.C.F.	GAS RA ⁺ CU.F.
J.L. Muncy	6	I	24	22	37	11-11-92	P	N/A	45 psi	N/A	1	N/A	3	50	16,667

Instructions:

During gas-oil ratio test, each well shall be produced at a rate not exceeding the top unit allowable for the pool in which well is located by more than 25 percent. Operator is encouraged to take advantage of this 25 percent tolerance in order that well can be assigned increased allowables when authorized by the Division.

Gas volumes must be reported in MCF measured at a pressure base of 15.025 psia and a temperature of 60° F. Specific gravity base will be 0.60.

Report casing pressure in lieu of tubing pressure for any well producing through casing.

(See Rule 301, Rule 1116 & appropriate pool rules.)

I hereby certify that the above information is true and complete to the best of my knowledge and belief.



Signature

Rick Gaddis, Production Engineer

Printed name and title

12-21-92 505-393-7106

Date

Telephone No.

Submit 2 copies to Appropriate
District Office.

1. O. Box 1980, Hobbs, NM 88240

2. O. Drawer DD, Artesia, NM 88210

3. 000 Rio Brazos Rd., Aztec, NM 87410

State of New Mexico
Energy, Minerals and Natural Resources Department

Form C-116
Revised 1/1/89

OIL CONSERVATION DIVISION

P.O. Box 2088

Santa Fe, New Mexico 87504-2088

GAS - OIL RATIO TEST

Operator		Pool		County		Lea										
Marathon Oil Company		Tubbs Gas		Completion		Special										
Address		TYPE OF TEST - (X)		Scheduled		Special										
P.O. Box 2409, Hobbs, NM 88240		Scheduled		Completion		Special										
LEASE NAME	WELL NO.	LOCATION				DATE OF TEST	CHOKE SIZE	TBG. PRESS.	DAILY ALLOW-ABLE	LENGTH OF TEST HOURS	PROD. DURING TEST			GAS - OIL RATIO CU FT./BBL.		
		U	S	T	R						WATER BBL.S.	GRAV. OIL	OIL BBL.S.		GAS MCF.	
J.L. Muncy	6	I	24	22	37	11/10/92	F	Open	40	Gas	24	0	N/A	0	245	N/A

Instructions:

During gas-oil ratio test, each well shall be produced at a rate not exceeding the top unit allowable for the pool in which well is located by more than 25 percent. Operator is encouraged to take advantage of this 25 percent tolerance in order that well can be assigned increased allowables when authorized by the Division.

Gas volumes must be reported in MCF measured at a pressure base of 15.025 psia and a temperature of 60° F. Specific gravity base will be 0.60.

Report casing pressure in lieu of tubing pressure for any well producing through casing.

(See Rule 301, Rule 1116 & appropriate pool rules.)

I hereby certify that the above information is true and complete to the best of my knowledge and belief.

Signature

Printed name and title

Rick Gaddis, Production Engineer

12-21-92

Date

505-393-7106

Telephone No.

FIELD - DRINKARD
RESERVOIR - BLINEBRY
LEASE - MUNCY J L
WELL - J. L. MUNCY-NO. 6

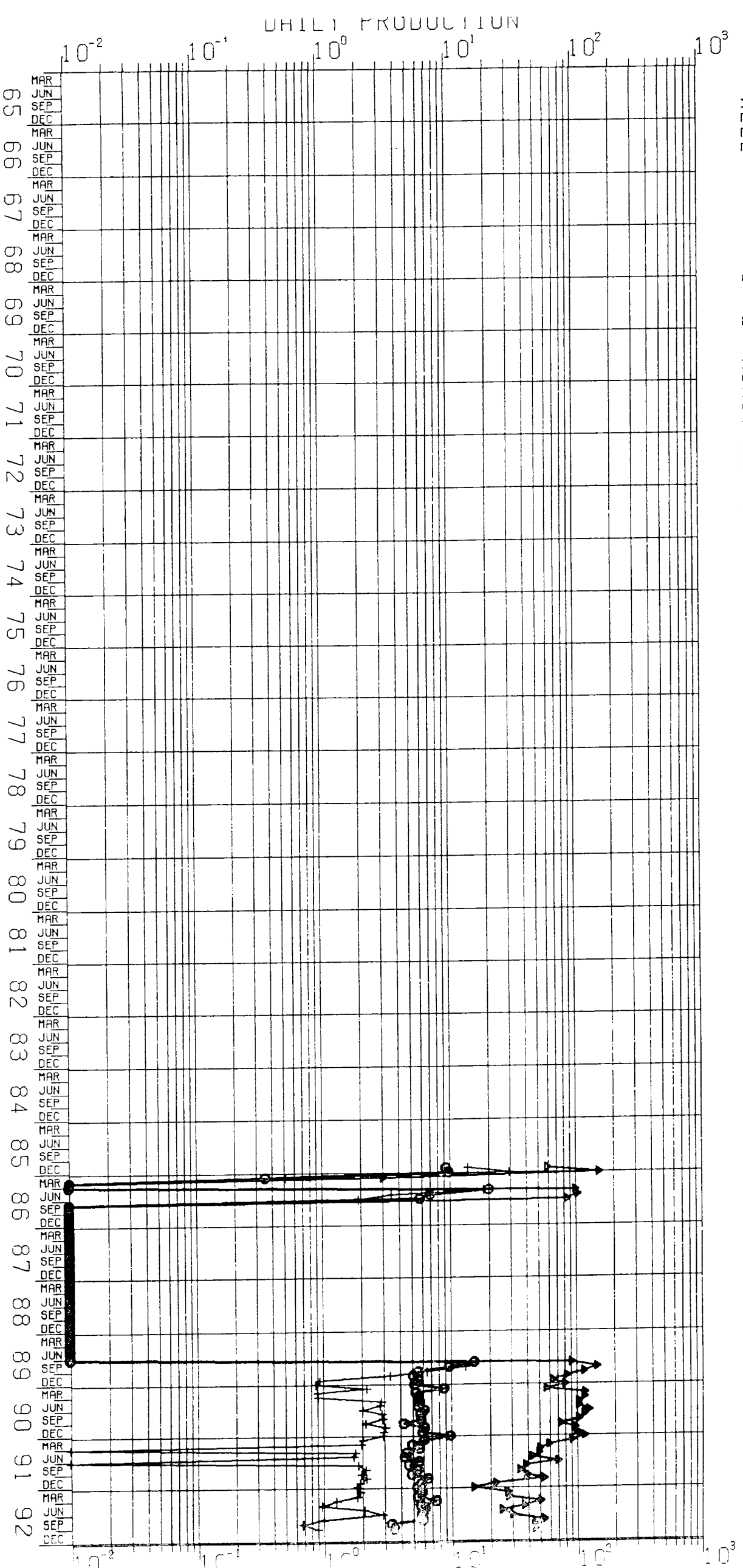

O+C CALENDAR DLY AVG —●—
GAS CALENDAR DLY AVG —▲—
WTR CALENDAR DLY AVG —+—

J.L. MUNCY NO.6

DRINKARD AREA
LEA COUNTY, NEW MEXICO

SEC. 24, T22S, R37E
1920' FSL, 330' FEL
T.D.-7525', P.B.T.D.-7250'
GL.-3323', KB.-3335'

HISTORY - COMPLETED 11/85, DUAL BLINEBRY-OIL & TUBB-GAS. BLINEBRY HAS BEEN T/A SINCE 6/86. ACIDIZED TUBB WITH 1832 GALLONS 15% HCL. SAND FRAC 30,000 GAL. OF PUR-GEL 30-20% CO₂ CONTAINING 44,000# OF 20/40 MESH SAND. BLINEBRY WAS ACIDIZED WITH 3000 GAL. 15% HCL. SAND FRAC WITH 60,000 GAL. OF PUR-GEL 30 CONTAINING 122,000# OF 20/40 MESH SAND.

ATTEMPT MADE TO COMPLETE GRANITE WASH 7308' TO 7400', BUT WAS UNPRODUCTIVE.

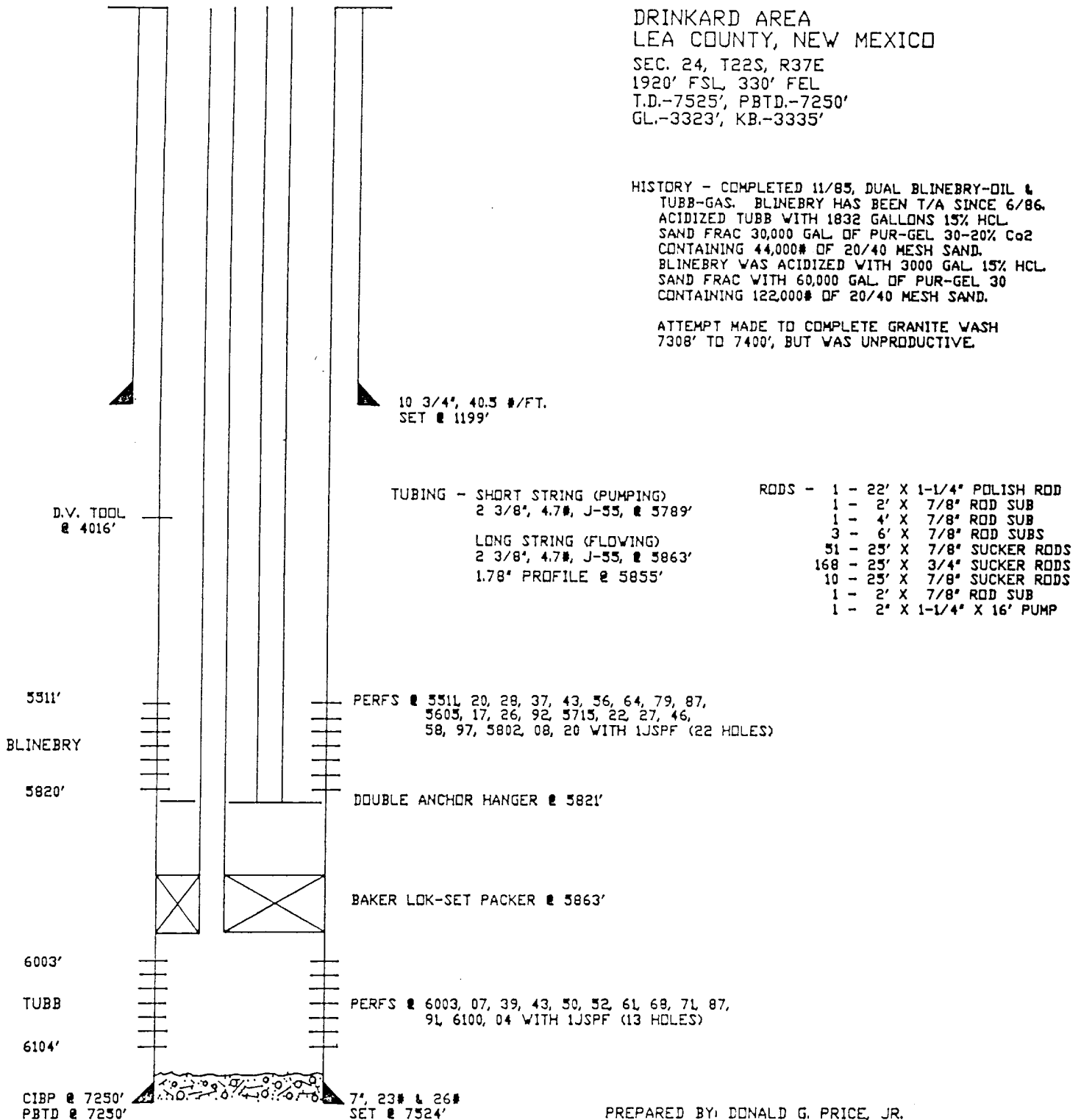

PREPARED BY: DONALD G. PRICE, JR.

* DRAWING NOT SCALE



**Marathon
Oil Company**

P.O. Box 2409
Hobbs, New Mexico 88240
Telephone 505/393-7106

December 21, 1992

OFFSET OPERATORS
J.L. MUNCY WELL NO. 6
(Mailing List Attached)

RE: Request for Exception to Rule 303-A
Downhole Commingling
Marathon Oil Company
J.L. Muncy Well No. 6
Unit I, 330' FEL & 1920' FSL
Section 24, T-22-S, R-37-E
Tubb Gas and Blinbry Oil
Drinkard Field
Lea County, New Mexico

Gentlemen:

Marathon Oil Company has filed an application with the New Mexico Oil Conservation Division to downhole commingle the above captioned well. Enclosed, please find a copy of the application as outlined in Rule 303-C.

If you are in agreement and waive all objections to the downhole commingling, please sign below and return one copy to Marathon.

Sincerely,

A handwritten signature in cursive script that reads 'S.P. Guidry'.

S.P. Guidry
Northwest Operation
Production Superintendent

Agreed and accepted this _____ day of _____, 1992
by _____ as representative of _____

RDG/9234/kc

OFFSET OPERATORS

J.L. MUNCY LEASE
LEA COUNTY, NEW MEXICO

Chevron Oil Company
PO Box 670
Hobbs, NM 88240

Hanson Operating company
PO Box 1515
Roswell, NM 88202-1515

Phillips Petroleum Company
4001 Penbrook
Odessa, TX 79762

John Hendrix
525 Midland Tower
Midland, TX 79701

Crown Central Petroleum
Building K, Suite 200
731 West Wadley
Midland, TX 79701

Sun Exploration & Production Company
PO Box 1861
Midland, TX 79702



**Marathon
Oil Company**

P.O. Box 2409
Hobbs, New Mexico 88240
Telephone 505/393-7106

December 21, 1992

OFFSET OPERATORS
J.L. MUNCY WELL NO. 6
(Mailing List Attached)

RE: Request for Exception to Rule 303-A
Downhole Commingling
Marathon Oil Company
J.L. Muncy Well No. 6
Unit I, 330' FEL & 1920' FSL
Section 24, T-22-S, R-37-E
Tubb Gas and Blinbry Oil
Drinkard Field
Lea County, New Mexico

Gentlemen:

Marathon Oil Company has filed an application with the New Mexico Oil Conservation Division to downhole commingle the above captioned well. Enclosed, please find a copy of the application as outlined in Rule 303-C.

If you are in agreement and waive all objections to the downhole commingling, please sign below and return one copy to Marathon.

Sincerely,

A handwritten signature in cursive script that reads 'S. P. Guidry'.

S.P. Guidry
Northwest Operation
Production Superintendent

Agreed and accepted this _____ day of _____, 1992

by _____ as representative of _____

RDG/9234/kc

OFFSET OPERATORS

J.L. MUNCY LEASE
LEA COUNTY, NEW MEXICO

Chevron Oil Company
PO Box 670
Hobbs, NM 88240

Hanson Operating company
PO Box 1515
Roswell, NM 88202-1515

Phillips Petroleum Company
4001 Penbrook
Odessa, TX 79762

John Hendrix
525 Midland Tower
Midland, TX 79701

Crown Central Petroleum
Building K, Suite 200
731 West Wadley
Midland, TX 79701

Sun Exploration & Production Company
PO Box 1861
Midland, TX 79702



**Marathon
Oil Company**

P.O. Box 2409
Hobbs, New Mexico 88240
Telephone 505/393-7106

December 21, 1992

OFFSET OPERATORS
J.L. MUNCY WELL NO. 6
(Mailing List Attached)

RE: Request for Exception to Rule 303-A
Downhole Commingling
Marathon Oil Company
J.L. Muncy Well No. 6
Unit I, 330' FEL & 1920' FSL
Section 24, T-22-S, R-37-E
Tubb Gas and Blinebry Oil
Drinkard Field
Lea County, New Mexico

Gentlemen:

Marathon Oil Company has filed an application with the New Mexico Oil Conservation Division to downhole commingle the above captioned well. Enclosed, please find a copy of the application as outlined in Rule 303-C.

If you are in agreement and waive all objections to the downhole commingling, please sign below and return one copy to Marathon.

Sincerely,

A handwritten signature in cursive script that reads 'S. P. Guidry'.

S.P. Guidry
Northwest Operation
Production Superintendent

Agreed and accepted this _____ day of _____, 1992

by _____ as representative of _____

RDG/9234/kc

