



© Copyrighted Reproduction: Prohibited

SC. 8 5/8-1497-725 SX 5 1/2-3600-250 SX 2 3/8-31 0	WELL CLASS: INIT D FIN DG LSE CODE			
	FORMATION	DATUM	FORMATION	DATUM
TL 3600 (YTES)			PBL	

P.L.C. El Paso Natural Gas
CONTR Rod Ric Corp #2 OPER 11113468 GR, 3479 RB SUB 10

9-2-53 NM
IC 30-025-70261-85

**NEW MEXICO OIL CONSERVATION COMMISSION
WELL LOCATION AND ACREAGE DEDICATION PLAT**

Form 1-1
Supersedes C-128
Effective 1-1-65

All distances must be from the outer boundaries of the Section

Operator LEWIS B. BURLERSON, INC.			Lease STATE #35		Well No. 1
Unit Letter A	Section 35	Township 22S	Range 36E	County LEA	
Actual Footage Location of Well: 860 feet from the NORTH line and 660 feet from the EAST line					
Ground Level Elev. 3467.7	Producing Formation Yates-Seven Rivers		Pool Jalpat (Gas)		Dedicated Acreage 160

1. Outline the acreage dedicated to the subject well by colored pencil or hachure marks on the plat below.
2. If more than one lease is dedicated to the well, outline each and identify the ownership thereof (both as to working interest and royalty).
3. If more than one lease of different ownership is dedicated to the well, have the interests of all owners been consolidated by communitization, unitization, force-pooling, etc?

☐ Yes ☐ No If answer is "yes," type of consolidation _____

If answer is "no," list the owners and tract descriptions which have actually been consolidated. (Use reverse side of this form if necessary.) _____

No allowable will be assigned to the well until all interests have been consolidated (by communitization, unitization, forced-pooling, or otherwise) or until a non-standard unit, eliminating such interests, has been approved by the Commission.

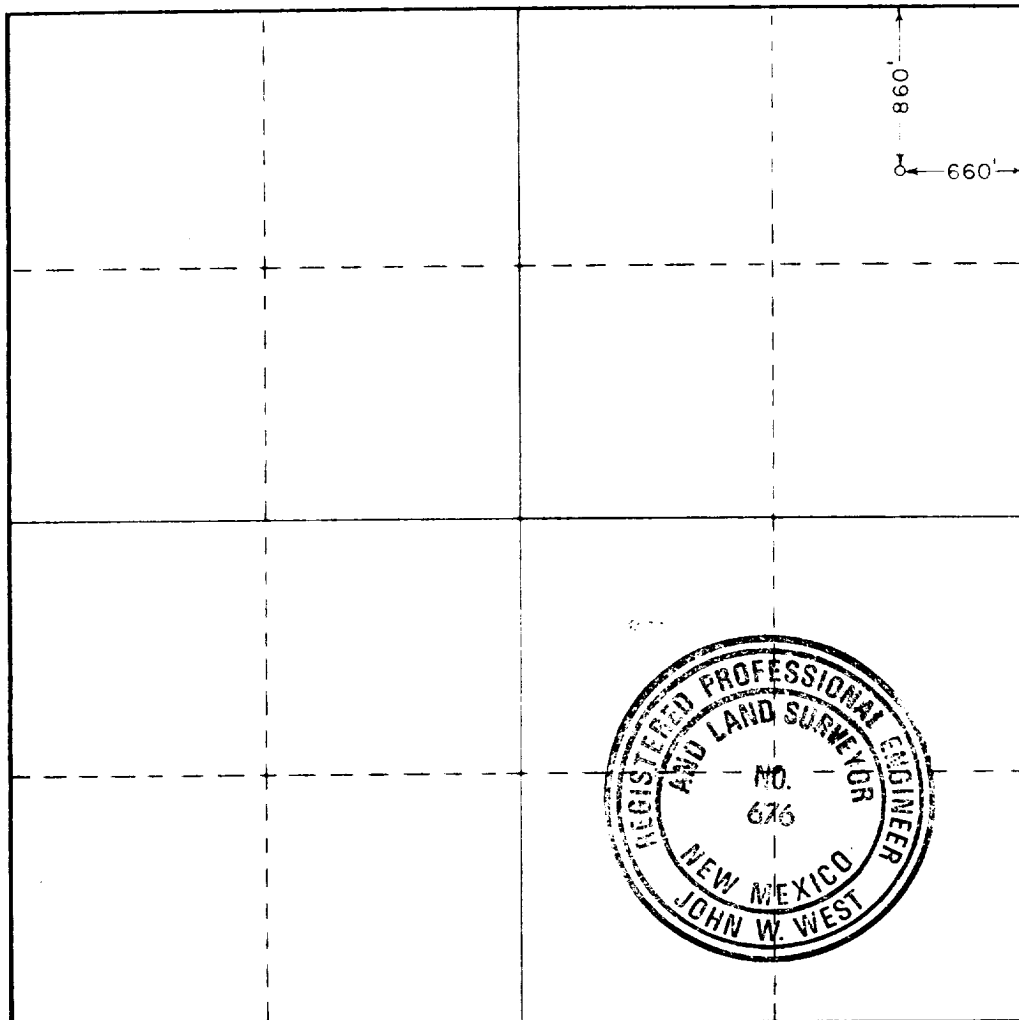

CERTIFICATION

I hereby certify that the information contained herein is true and complete to the best of my knowledge and belief.

Steven Burlerson
Name

Position **Steven L. Burlerson
V. P. Exploration**

Company
Lewis B. Burlerson, Inc.

Date
5/6/85

I hereby certify that the well location shown on this plat was plotted from field notes of actual surveys made by me or under my supervision, and that the same is true and correct to the best of my knowledge and belief.

John W. West
Date Surveyed
5/2/85

Registered Professional Engineer
and/or Land Surveyor

John W. West
Certificate No. **JOHN W. WEST, 676**
RONALD J. EIDSON, 3239

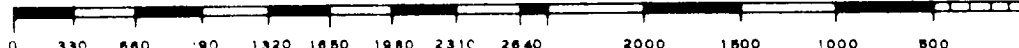

RECEIVED

MAY 15 1985

O.C.C.
HOBBS OFFICE

RECEIVED

MAY 8 1985

O.C.C.
HOBBS OFFICE

173