

UNITED STATES
DEPARTMENT OF THE INTERIOR
BUREAU OF LAND MANAGEMENT

SUBMIT IN TRIPL-TE
(Other instructions re-
verse side)

Form approved
Budget Bureau No. 1004-0135
Expires August 31, 1985

5. LEASE DESIGNATION AND SERIAL NO.

NA 19143

6. IF INDIAN, ALLOTTEE OR TRIBE NAME

SUNDRY NOTICES AND REPORTS ON WELLS

(Do not use this form for proposals to drill or to deepen or plug back to a different reservoir.
Use "APPLICATION FOR PERMIT" for such proposals.)

1. OIL WELL ☐ GAS WELL ☒ OTHER

2. NAME OF OPERATOR

Diamond Shamrock Exploration Company

3. ADDRESS OF OPERATOR

P. O. Box 400, Amarillo, Texas 79188-0001

4. LOCATION OF WELL (Report location clearly and in accordance with any State requirements.*
See also space 17 below.)
At surface

1980' FNL & 1980' FEL

14. PERMIT NO.

N/A

15. ELEVATIONS (Show whether DF, RT, GR, etc.)

3389' GR

7. UNIT AGREEMENT NAME

8. FARM OR LEASE NAME

Federal

9. WELL NO.

#1

10. FIELD AND POOL, OR WILDCAT

Antelope Ridge - Atoka

11. SEC., T., R., M., OR BLK. AND
SURVEY OR AREA

Sec. 3, T23S, R34E

12. COUNTY OR PARISH

Lea

13. STATE

NM

16. Check Appropriate Box To Indicate Nature of Notice, Report, or Other Data

NOTICE OF INTENTION TO:

TEST WATER SHUT-OFF

☐
☐
☐
☐
☐

PULL OR ALTER CASING

☐
☐
☐
☐
☐

FRACTURE TREAT

MULTIPLE COMPLETE

SHOOT OR ACIDIZE

ABANDON*

REPAIR WELL

CHANGE PLANE

(Other)

SUBSEQUENT REPORT OF:

WATER SHUT-OFF

☐
☐
☐
☐
☐

FRACTURE TREATMENT

REPAIRING WELL

☐
☐
☐
☐
☐

SHOOTING OR ACIDIZING

ALTERING CASING

(Other) Potential Test

ABANDONMENT*

(NOTE: Report results of multiple completion on Well
Completion or Recompletion Report and Log form.)

17. DESCRIBE PROPOSED OR COMPLETED OPERATIONS (Clearly state all pertinent details, and give pertinent dates, including estimated date of starting any proposed work. If well is directionally drilled, give subsurface locations and measured and true vertical depths for all markers and zones pertinent to this work.)*

3-18-86: Ran 4 point potential test.

3-19-86: Rig down test equipment and sell condensate in order to release temporary test tanks.
This well is shut-in waiting on gas pipeline connection.

3-20-86: Diamond Shamrock is preparing to set production equipment within the approved location boundaries. Attached is a proposed revision to the configuration of this equipment.

ACCEPTED FOR RECORD

MAR 28 1986

CARLSBAD, NEW MEXICO

18. I hereby certify that the foregoing is true and correct

SIGNED

Greg Drwenski

TITLE Production Engineer

DATE 3-20-86

(This space for Federal or State office use)

APPROVED BY

TITLE

DATE

CONDITIONS OF APPROVAL, IF ANY:

*See Instructions on Reverse Side

RECEIVED
APR 21 1986
O.C.D.
HOBBS OFFICE

DIAGRAM B

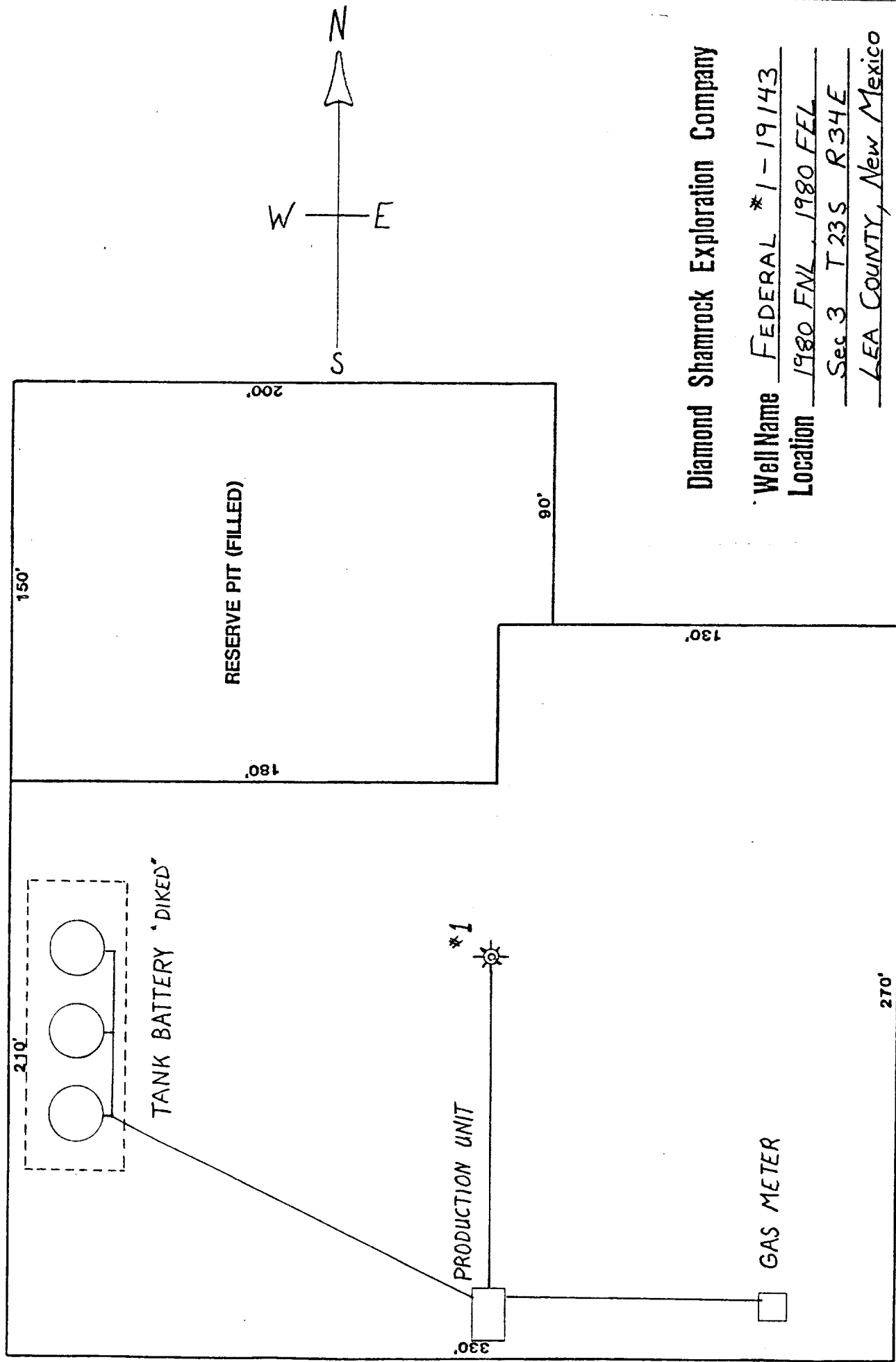

Diamond Shamrock Exploration Company

Well Name FEDERAL *1-19143
Location 1980 FNL 1980 FEL
Sec 3 T23S R34E
LEA COUNTY, New Mexico

SCALE: 1" = 50'

RECEIVED
APR 21 1986
O.C.D.
HOBBS OFFICE