

UNITED STATES
DEPARTMENT OF THE INTERIOR
BUREAU OF LAND MANAGEMENT

SUBMIT IN TRIPlicate
(Other instructions on reverse side)

30-025-21710
Budget Unit No. 100-501
Expires August 31, 1985

SUNDRY NOTICES AND REPORTS ON WELLS

(Do not use this form for proposals to drill or to deepen or plug back to a different reservoir. Use "APPLICATION FOR PERMIT" for such proposals.)

1. OIL WELL <input checked="" type="checkbox"/> GAS WELL <input type="checkbox"/> OTHER <input type="checkbox"/>		7. UNIT AGREEMENT NAME
2. NAME OF OPERATOR Harvard Petroleum Corporation		8. FARM OR LEASE NAME James Federal
3. ADDRESS OF OPERATOR P. O. Box 936 Roswell, NM 88202		9. WELL NO. 2
4. LOCATION OF WELL (Report location clearly and in accordance with any State requirements.* See also space 17 below.) At surface 660' FSL & 1830' FWL		10. FIELD AND POOL, OR WILDCAT Sand Dunes Bone Sprg So.
14. PERMIT NO.		11. SEC., T., R., M., OR BLK. AND SURVEY OR AREA Sec. 29-T23S-R32E
15. ELEVATIONS (Show whether DF, RT, OK, etc.) 3650' GL		12. COUNTY OR PARISH Lea
		13. STATE New Mexico

Check Appropriate Box To Indicate Nature of Notice, Report, or Other Data

NOTICE OF INTENTION TO:

TEST WATER SHUT-OFF <input type="checkbox"/>	PULL OR ALTER CASING <input type="checkbox"/>
FRACTURE TREAT <input type="checkbox"/>	MULTIPLE COMPLETE <input type="checkbox"/>
SHOOT OR ACIDIZE <input type="checkbox"/>	ABANDON* <input type="checkbox"/>
REPAIR WELL <input type="checkbox"/>	CHANGE PLANS <input type="checkbox"/>
(Other) Re-enter P&A well	

SUBSEQUENT REPORT OF:

WATER SHUT-OFF <input type="checkbox"/>	REPAIRING WELL <input type="checkbox"/>
FRACTURE TREATMENT <input type="checkbox"/>	ALTERING CASING <input type="checkbox"/>
SHOOTING OR ACIDIZING <input type="checkbox"/>	ABANDONMENT* <input type="checkbox"/>
(Other) <input type="checkbox"/>	

(NOTE: Report results of multiple completion on Well Completion or Recompletion Report and Log form.)

17. DESCRIBE PROPOSED OR COMPLETED OPERATIONS (Clearly state all pertinent details, and give pertinent dates, including estimated date of starting any proposed work. If well is directionally drilled, give subsurface locations and measured and true vertical depths for all markers and zones pertinent to this work.)*

Propose to re-enter plugged and abandoned well as per attached reports.

18. I hereby certify that the foregoing is true and correct

Agent for:

SIGNED [Signature]

TITLE Harvard Petroleum Corp.

DATE April 27, 1992

(This space for Federal or State office use)

APPROVED BY _____

TITLE _____

DATE 4-28-92

CONDITIONS OF APPROVAL, IF ANY:

*See Instructions on Reverse Side

UNITED STATES
DEPARTMENT OF THE INTERIOR
BUREAU OF LAND MANAGEMENT

APPLICATION FOR PERMIT TO DRILL, DEEPEN, OR PLUG BACK

1a. TYPE OF WORK

DRILL ☒ re-entry

DEEPEN ☒

PLUG BACK ☐

b. TYPE OF WELL

OIL
WELL ☒

GAS
WELL ☐

OTHER

SINGLE
ZONE ☐

MULTIPLE
ZONE ☐

2. NAME OF OPERATOR

Harvard Petroleum Corporation

3. ADDRESS OF OPERATOR

P. O. Box 936

Roswell, NM 88202

4. LOCATION OF WELL (Report location clearly and in accordance with any State requirements.)*

At surface 660' FSL & 1830' FWL

At proposed prod. zone

Same

14. DISTANCE IN MILES AND DIRECTION FROM NEAREST TOWN OR POST OFFICE*

37 miles SE of Carlsbad, NM

15. DISTANCE FROM PROPOSED*

LOCATION TO NEAREST
PROPERTY OR LEASE LINE, FT. 660'
(Also to nearest drlg. unit line, if any)

16. NO. OF ACRES IN LEASE

1440

17. NO. OF ACRES ASSIGNED

TO THIS WELL 40

18. DISTANCE FROM PROPOSED LOCATION*

TO NEAREST WELL, DRILLING, COMPLETED,
OR APPLIED FOR, ON THIS LEASE, FT. 1627'

19. PROPOSED DEPTH

9900'

20. ROTARY OR CABLE TOOLS

Rotary

21. ELEVATIONS (Show whether DF, RT, GR, etc.)

3650' GL

22. APPROX. DATE WORK WILL START*

April 27, 1992

23.

PROPOSED CASING AND CEMENTING PROGRAM

Controlled Water Basin

	SIZE OF HOLE	SIZE OF CASING	WEIGHT PER FOOT	SETTING DEPTH	QUANTITY OF CEMENT
Existing	12 1/4"	8 5/8"	24#	1208'	500 sx "C" to surface
2nd stage	7 7/8"	5 1/2"	15.5#	9900'	530 sx "H"
3rd stage	7 7/8"	5 1/2"	15.5#	4906'	100 sx "C"

Mud Program:

1208' - 4906': Saturated Brine mud:

Mud Wt.

10.0 ppg

Vis.

28

W/L Control

No W/L cont.

4906' - 9500': Saturated Brine Mud:

10.0 ppg

28

No W/L cont.

9500' - 9900': Salt water, gel w/LCM:

10.0 ppg

31-32

W/L Cont. 15cc

Forming: R.E. Hubert, Amoco 24 Feb. #1

BOP Program:

A 10" 3000 psi wp Shaffer Series 900 BOP will be installed on the 8 5/8" casing. Casing and BOP will be tested before drilling out with 7 7/8" at the 4906' depth. A 2000 psi wp BOP will be used on the workover rig. See exhibit "E" for 3000 psi BOP.

Note: Propose to re-enter well with a workover/pulling unit rig and drill out plugs to current T.D. of 4906'. Will test and set 5 1/2" production casing if well is commercial. If well is not commercial at this depth, will drill out with 7 7/8" bit to depth of 9900' to test lower Delaware and Bone Spring formations. Will run 5 1/2" casing if well is commercial.

IN ABOVE SPACE DESCRIBE PROPOSED PROGRAM: If proposal is to deepen or plug back, give data on present productive zone and proposed new productive zone. If proposal is to drill or deepen directionally, give pertinent data on subsurface locations and measured and true vertical depths. Give blowout preventer program, if any.

24.

SIGNED

Subiraj S. Smith

Agent for:

TITLE Harvard Pet. Corp.

DATE April 16, 1992

DATE

(This space for Federal or State office use)

PERMIT NO.

APPROVAL DATE

APPROVED BY

TITLE

DATE

CONDITIONS OF APPROVAL, IF ANY:

ALL REQUIREMENTS AND
STIPULATIONS
ATTACHED

*See Instructions On Reverse Side

[RE-ENTRY]

NEW MEXICO OIL CONSERVATION COMMISSION
WELL LOCATION AND ACREAGE DEDICATION PLAT

Form C-107
Supersedes C-129
Effective 1-1-85

All distances must be from the outer boundaries of the Section

Operator (R. E. HIBBERT) Harvard Pet. Corp.		Lease James Federal, (Amoco 29 Federal)		Well No. 1) 2
Unit Letter N	Section 29	Township 23 South	Range 32 East	County Lea
Actual Footage Location of Well: 660 feet from the South line and 1830 feet from the West line				
Ground Level Elev. 3650.	Producing Formation Bone Spring Delaware	Pool Sand Dunes Bone Spring So. Wildcat	Estimated Acreage 40 Acres	

1. Outline the acreage dedicated to the subject well by colored pencil or hatchure marks on the plat below.
2. If more than one lease is dedicated to the well, outline each and identify the ownership thereof (both as to working interest and royalty).
3. If more than one lease of different ownership is dedicated to the well, have the interests of all owners been consolidated by communitization, unitization, force-pooling, etc?

☐ Yes ☐ No If answer is "yes," type of consolidation _____

If answer is "no," list the owners and tract descriptions which have actually been consolidated. (Use reverse side of this form if necessary.) _____

No allowable will be assigned to the well until all interests have been consolidated (by communitization, unitization, forced-pooling, or otherwise) or until a non-standard unit, eliminating such interests, has been approved by the Commission.

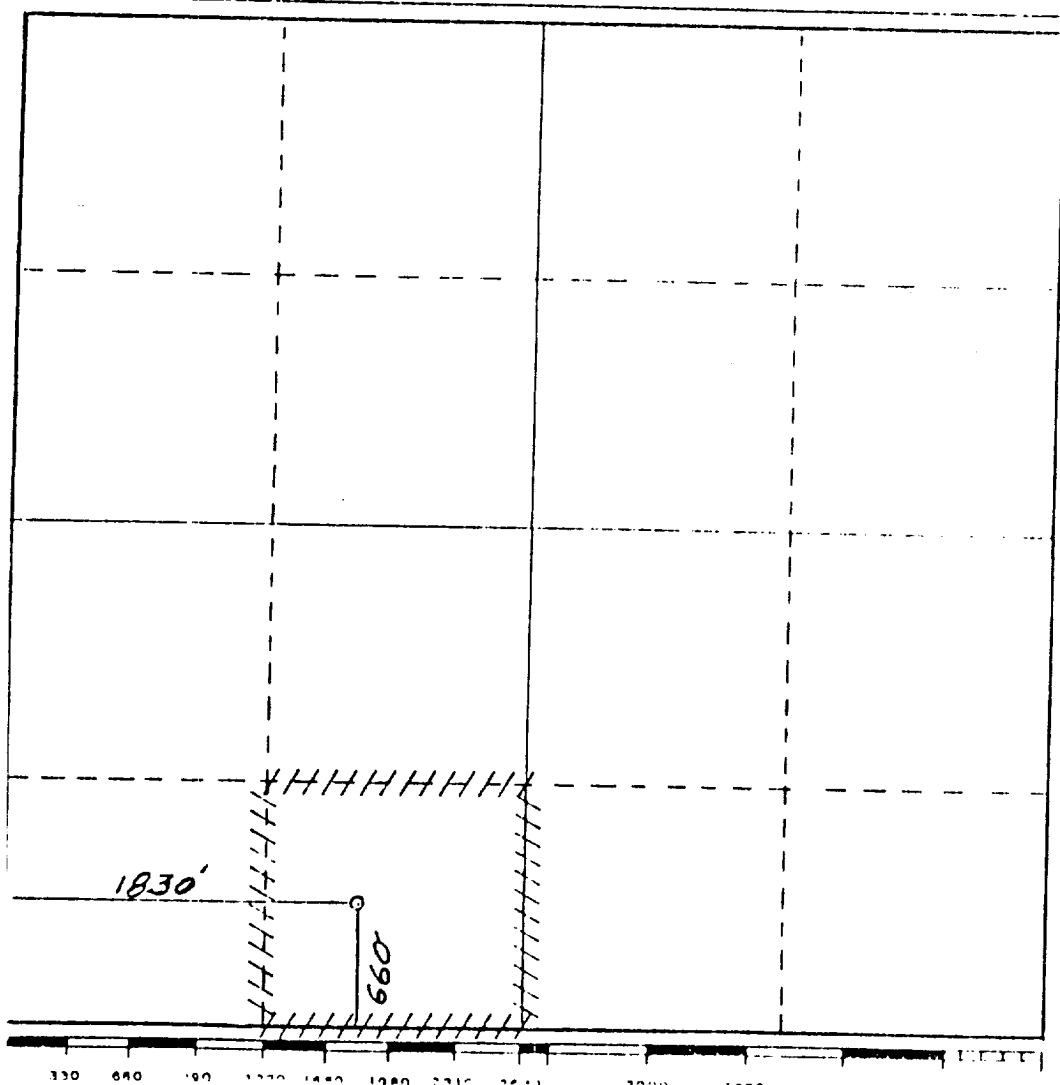

CERTIFICATION

I hereby certify that the information contained herein is true and complete to the best of my knowledge and belief.

Terry W. Franklin
Name

Terry W. Franklin

Agent

Company

R.E. Hibbert

Date

11/04/85

Dan R. Reddy
I have surveyed the well location shown on this plat and plotted from field notes of survey made by me or under my supervision, and that the same is true and correct to the best of my knowledge and belief.
DAN R. REDDY
NEW MEXICO
REGISTERED PROFESSIONAL ENGINEER
No. 5412

Date Surveyed

October 31, 1985

Registered Professional Engineer and a Licensed Surveyor

Dan R. Reddy
Signature

Certifies to:

NM PE&LS NO. 5412

RIG #301

BLOWOUT PREVENTOR ARRANGEMENT

10" SHAFFER TYPE "E", 3000 psi WP

80 GALLON, 4 STATION KOOMEY ACCUMULATOR

3000 psi WP CHOKE MANIFOLD

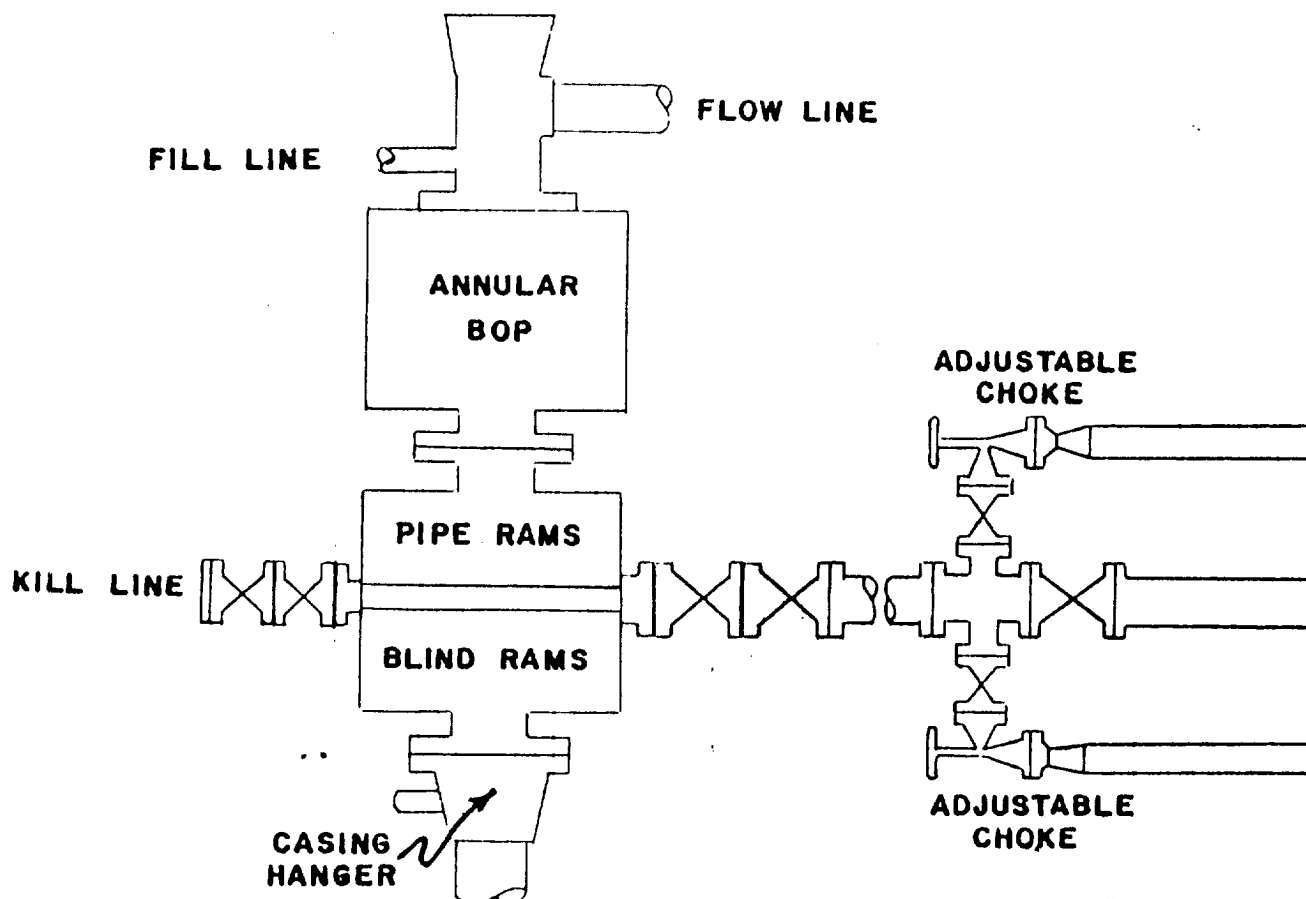

EXHIBIT "E"
HARVARD PETROLEUM CORPORATION
James Federal, Well No. 2
BOP Specifications